

Zimní údržba chodníků Zlín - klad listů

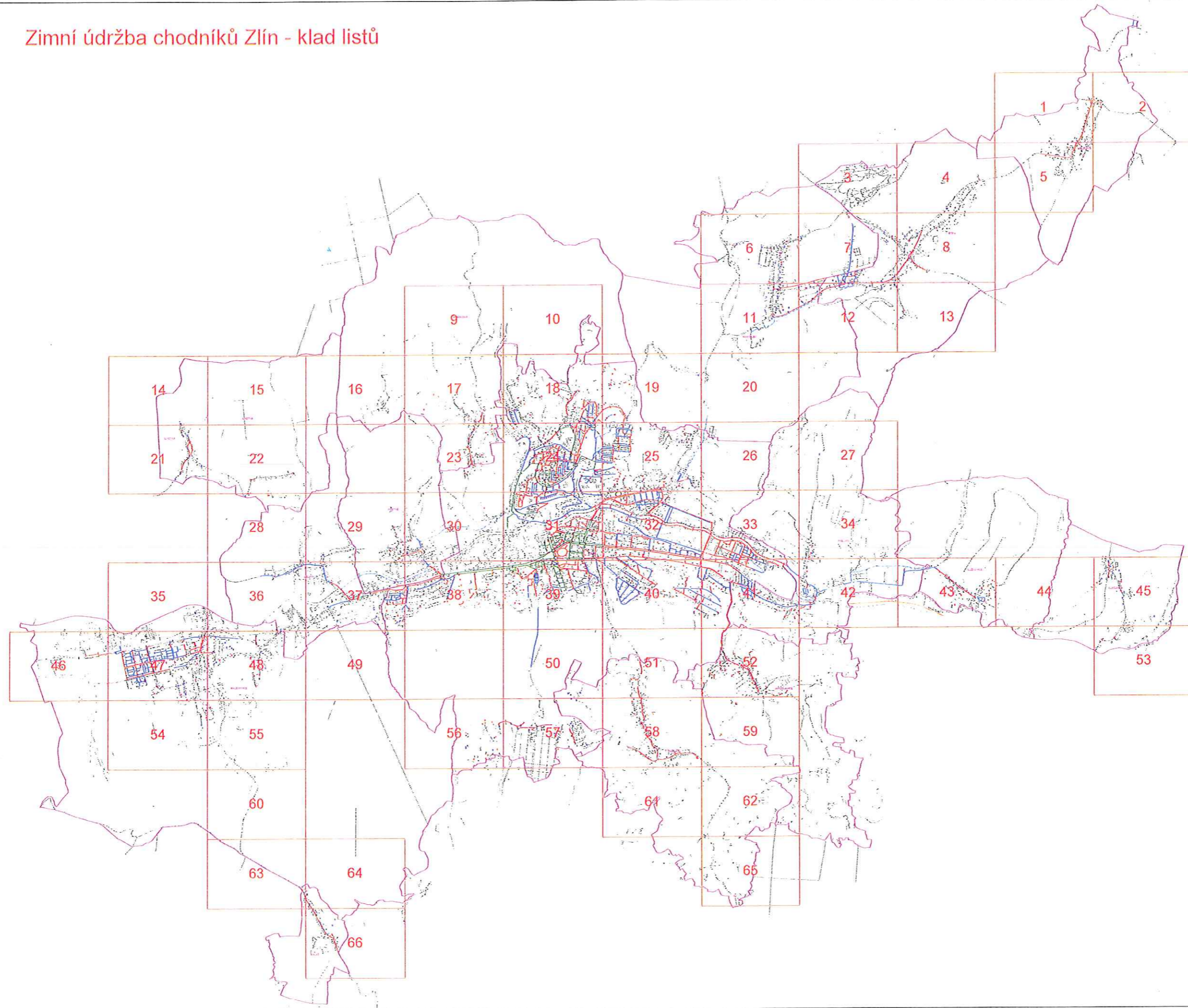

1

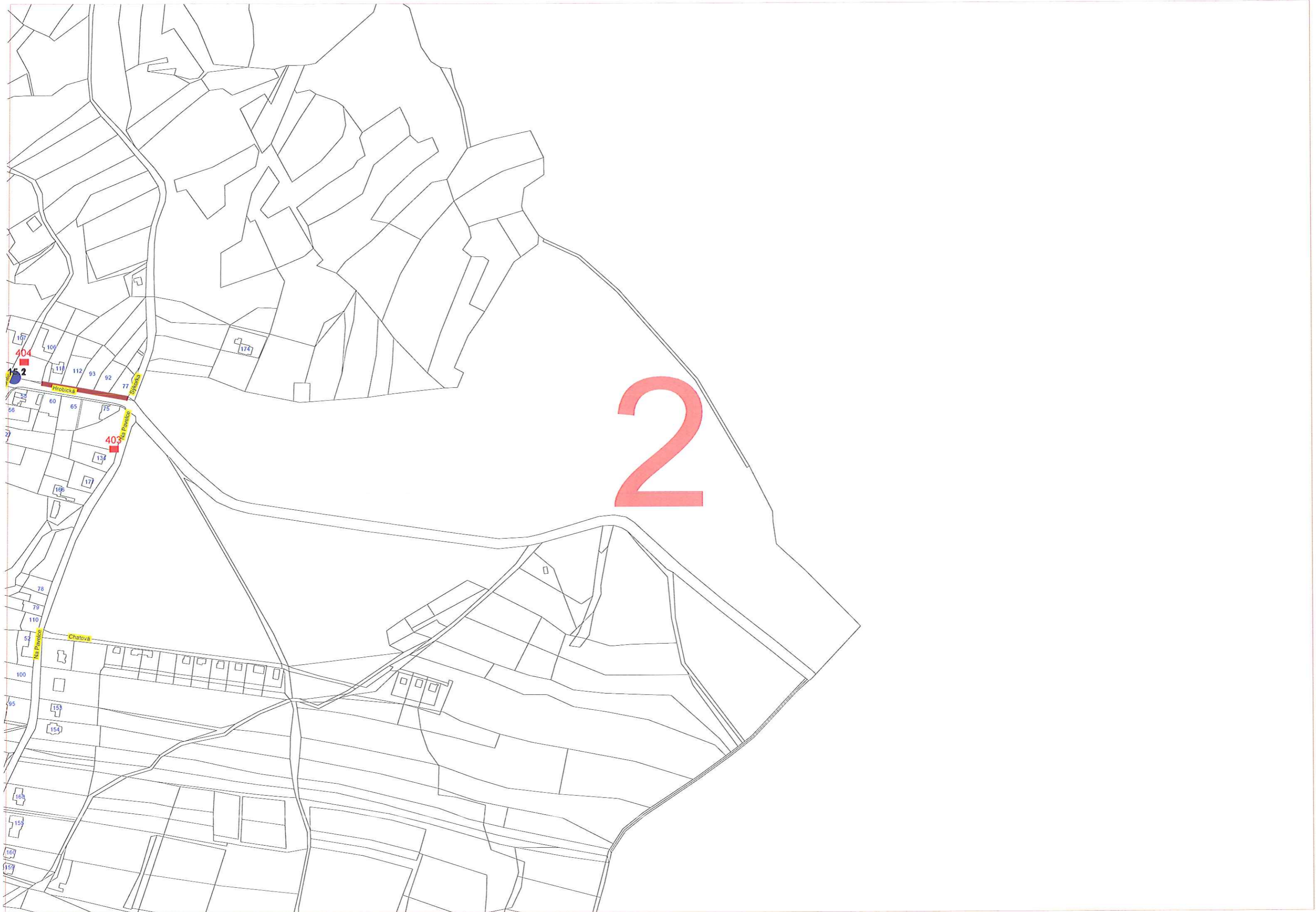





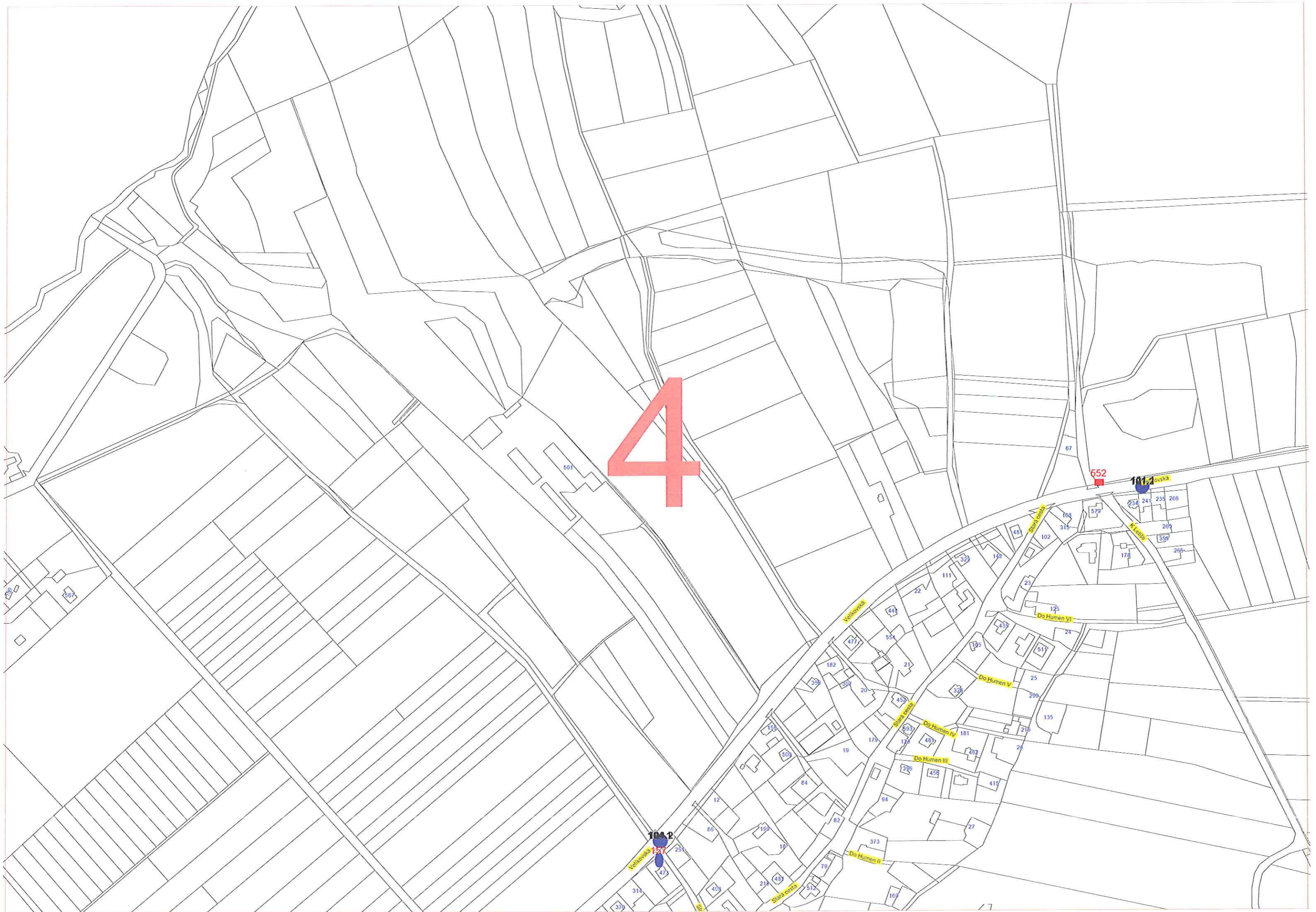

4

552

101.2

ovská

K. L. L. L.

Do Humen VI

Do Humen V

Do Humen IV

Do Humen III

Do Humen II

Veterná

Stará cesta

Stará cesta

Stará cesta

101.2

1577

Veterná

501

67

234

241

235

266

168

579

315

102

48

178

125

269

23

24

25

290

111

142

105

511

44

554

21

24

477

182

307

20

338

453

179

19

158

509

84

94

182

136

491

181

328

297

29

306

458

419

135

27

373

79

169

12

66

199

18

314

409

218

487

379

512

512

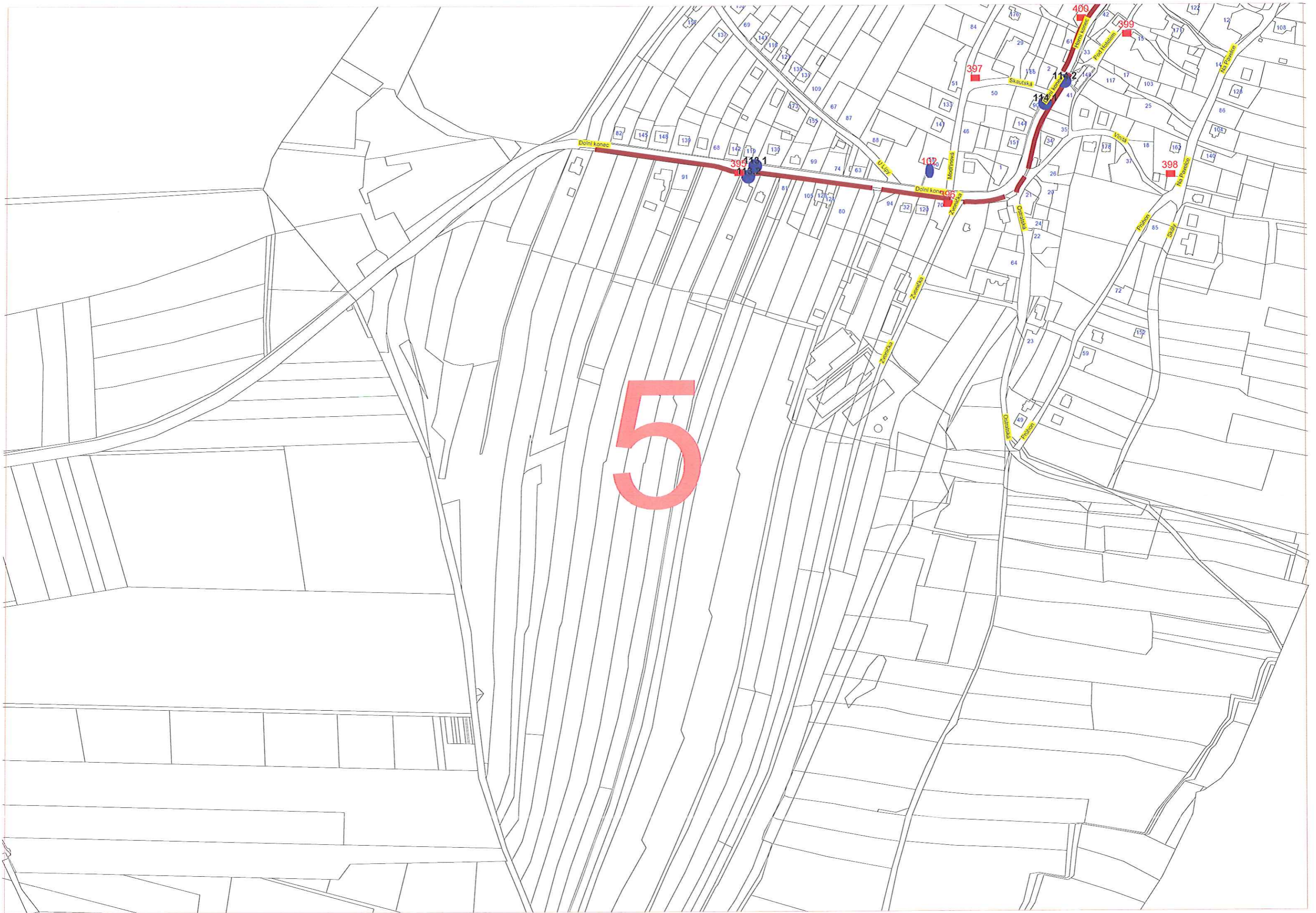



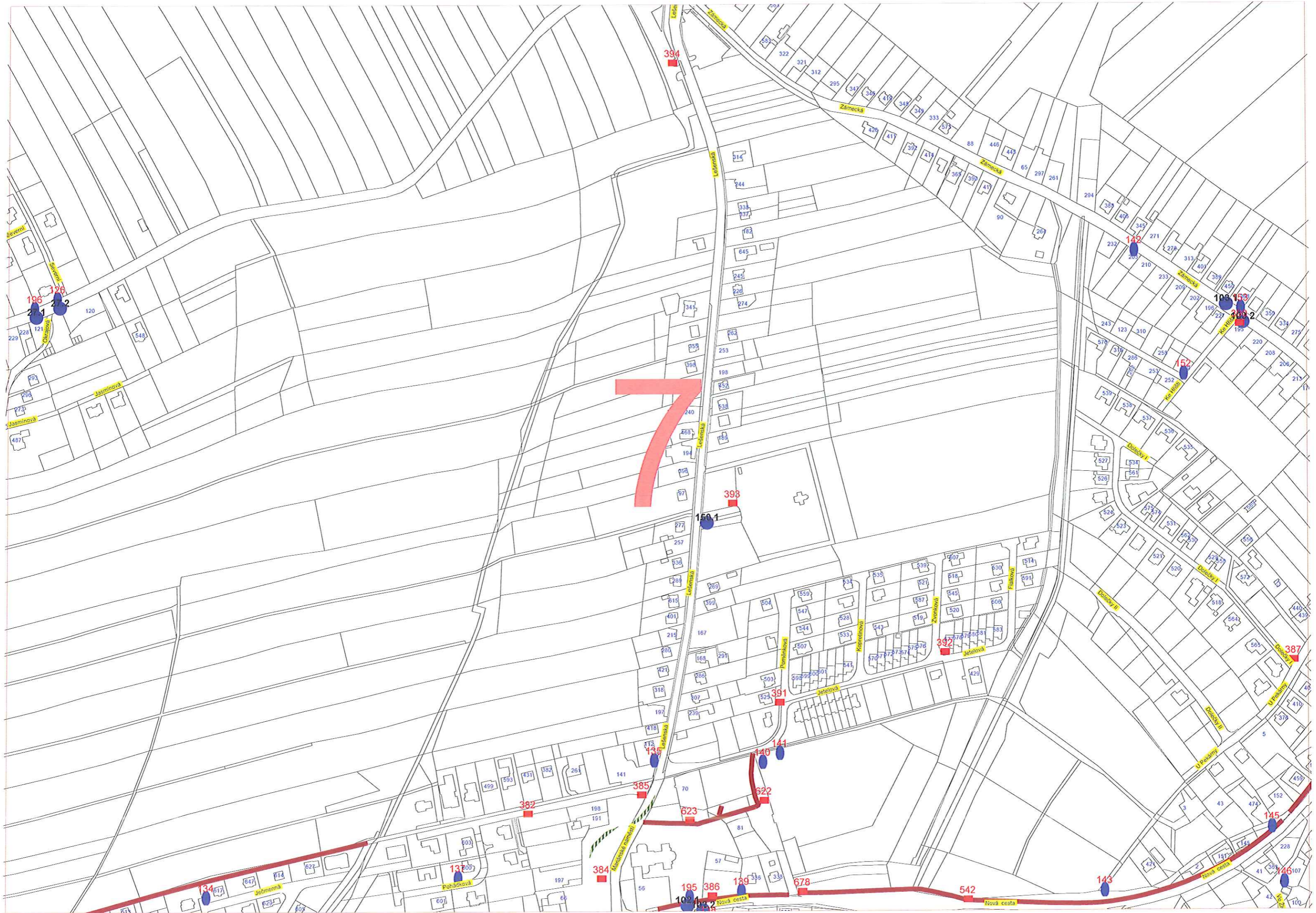

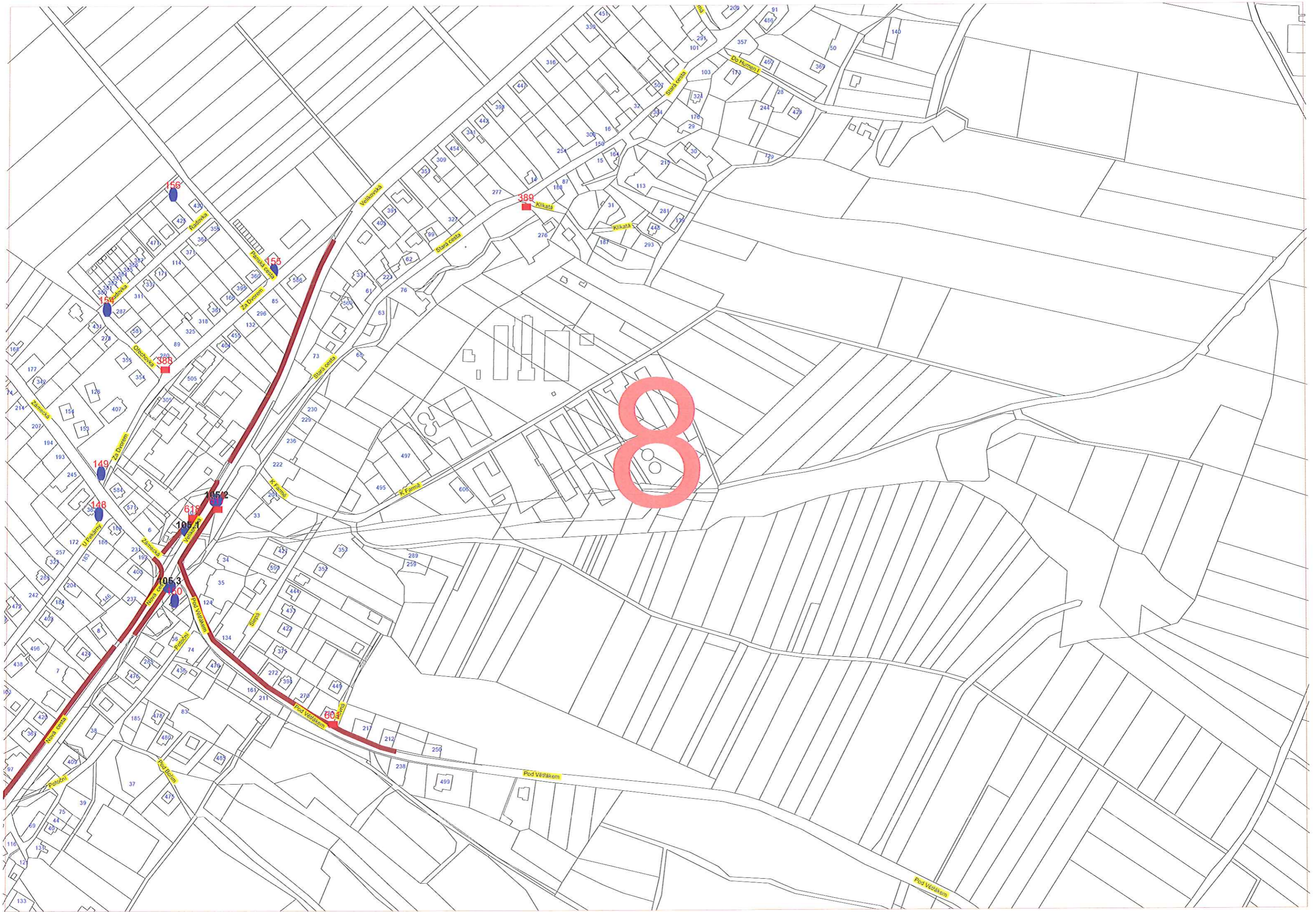



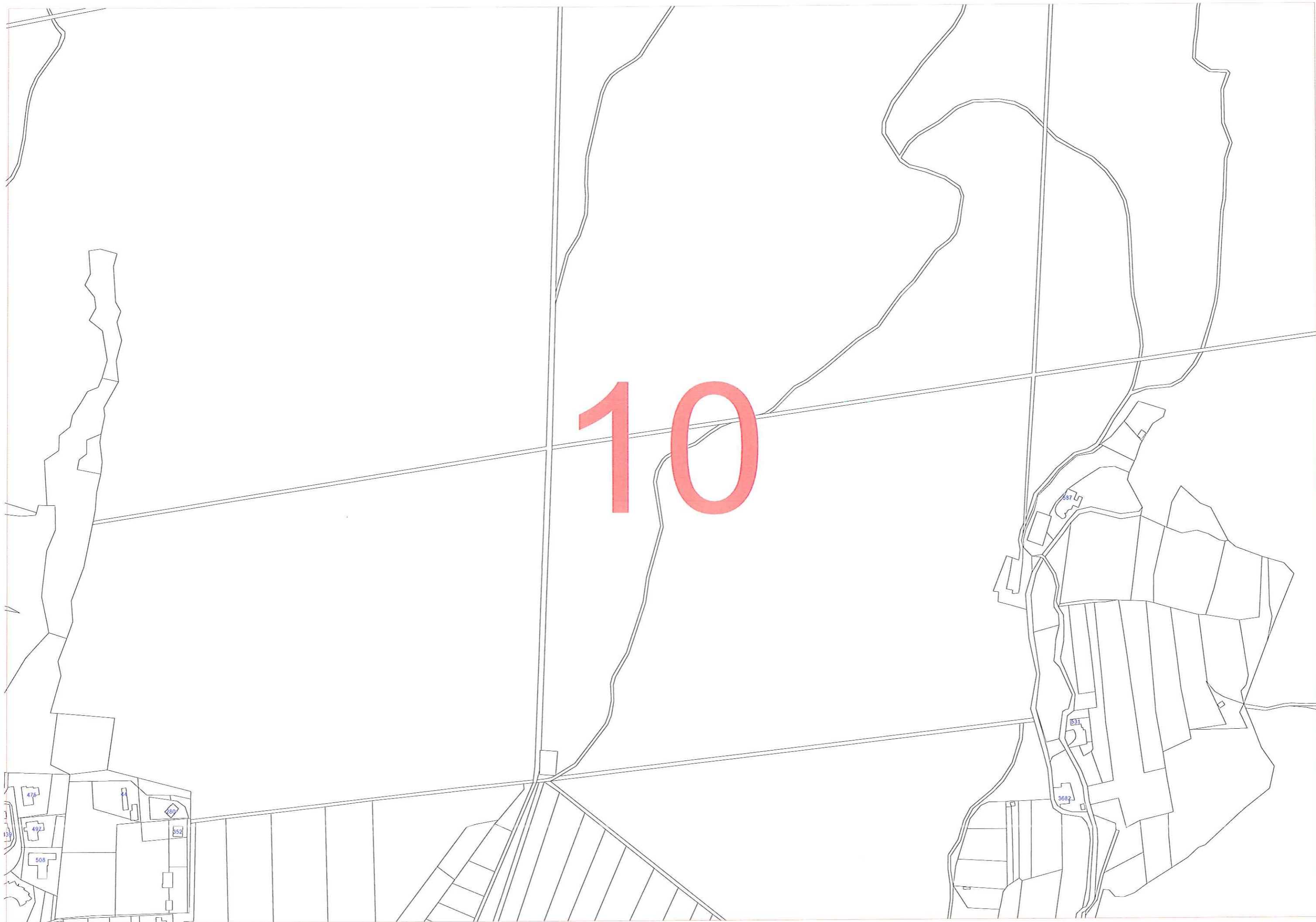

10

475
492
508
280
552

531
3682

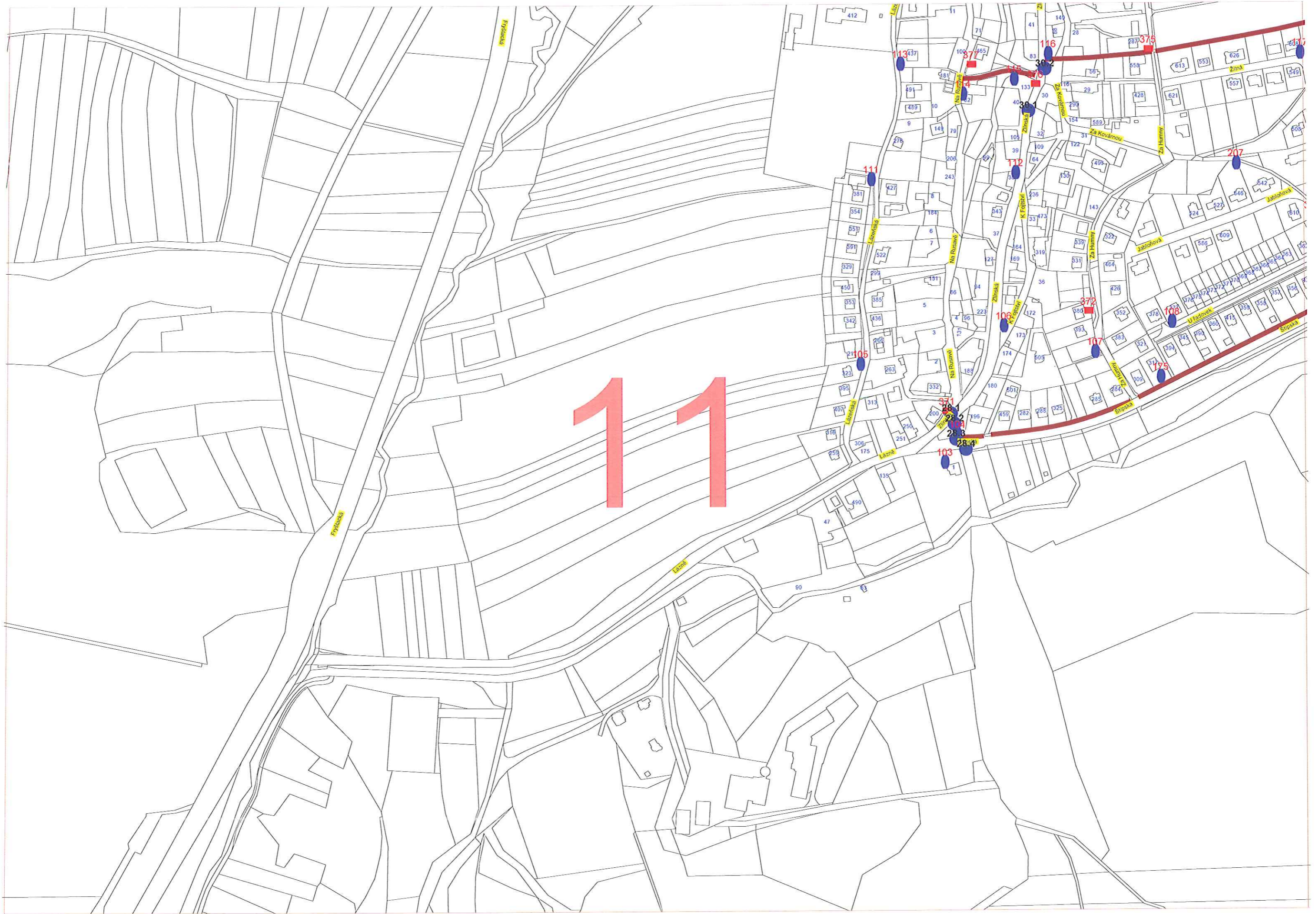

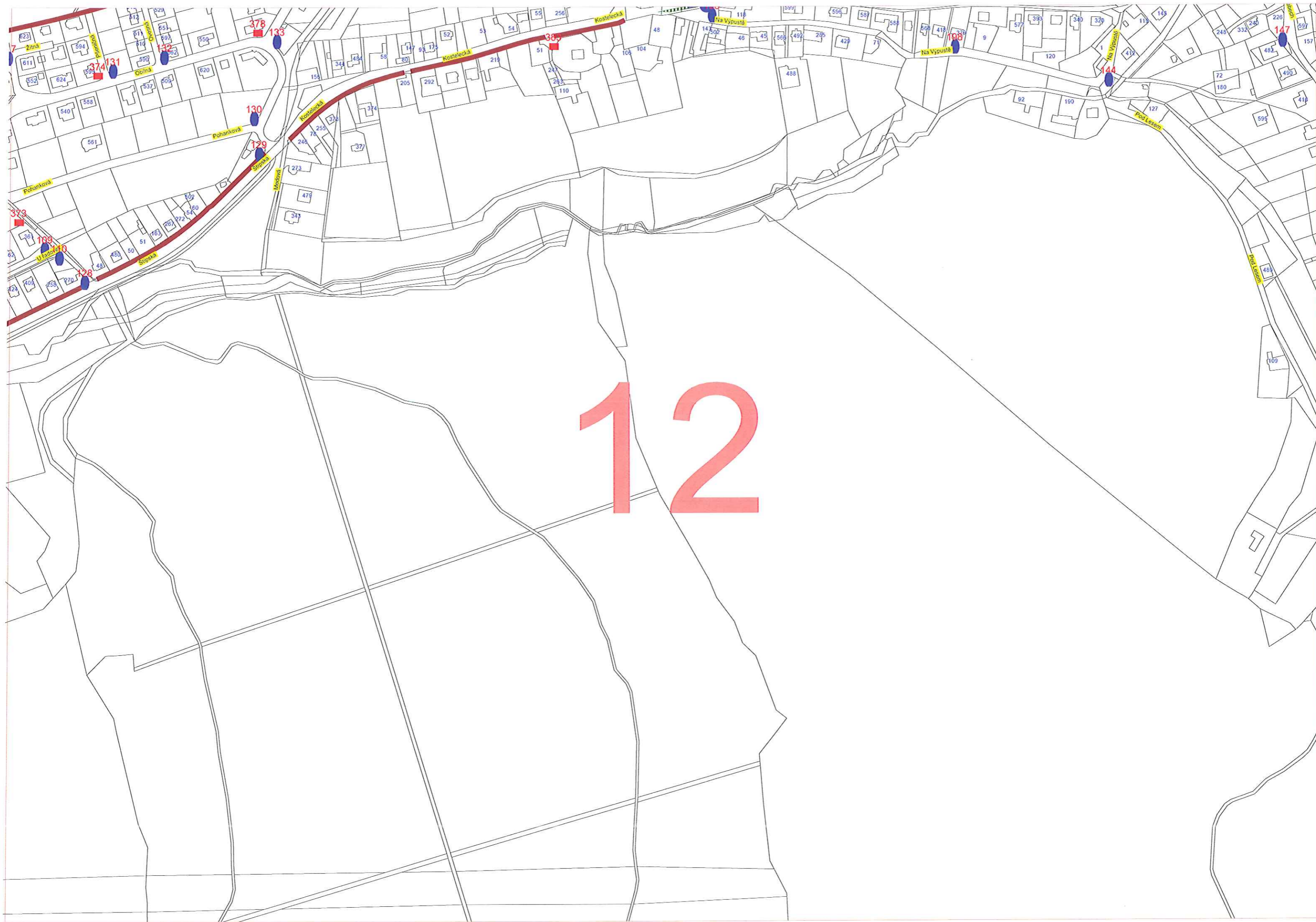

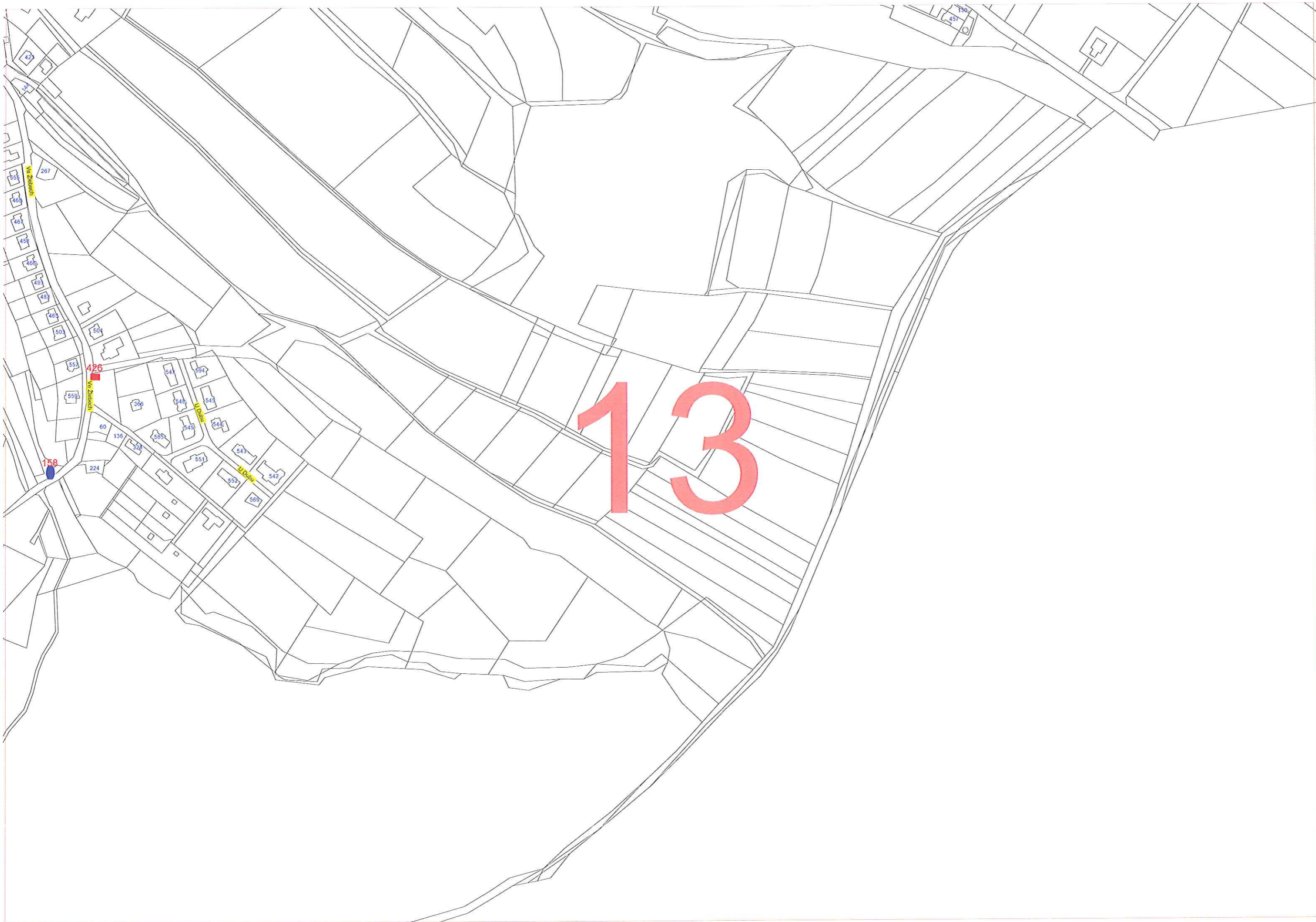

13

42

267

55

469

467

458

465

493

463

463

503

504

553

550

158

60

136

224

541

594

548

543

543

543

551

552

542

559

457

457

14

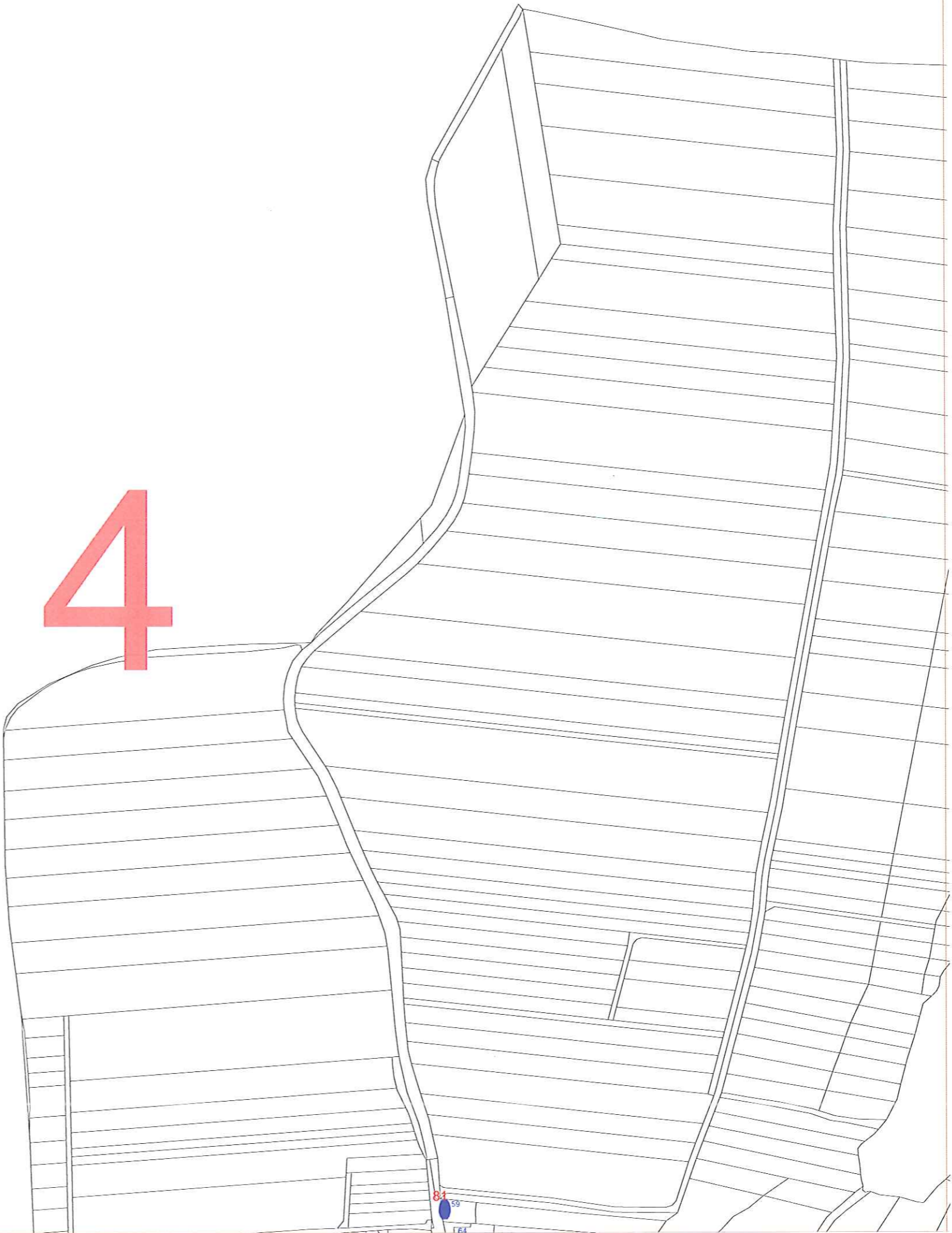

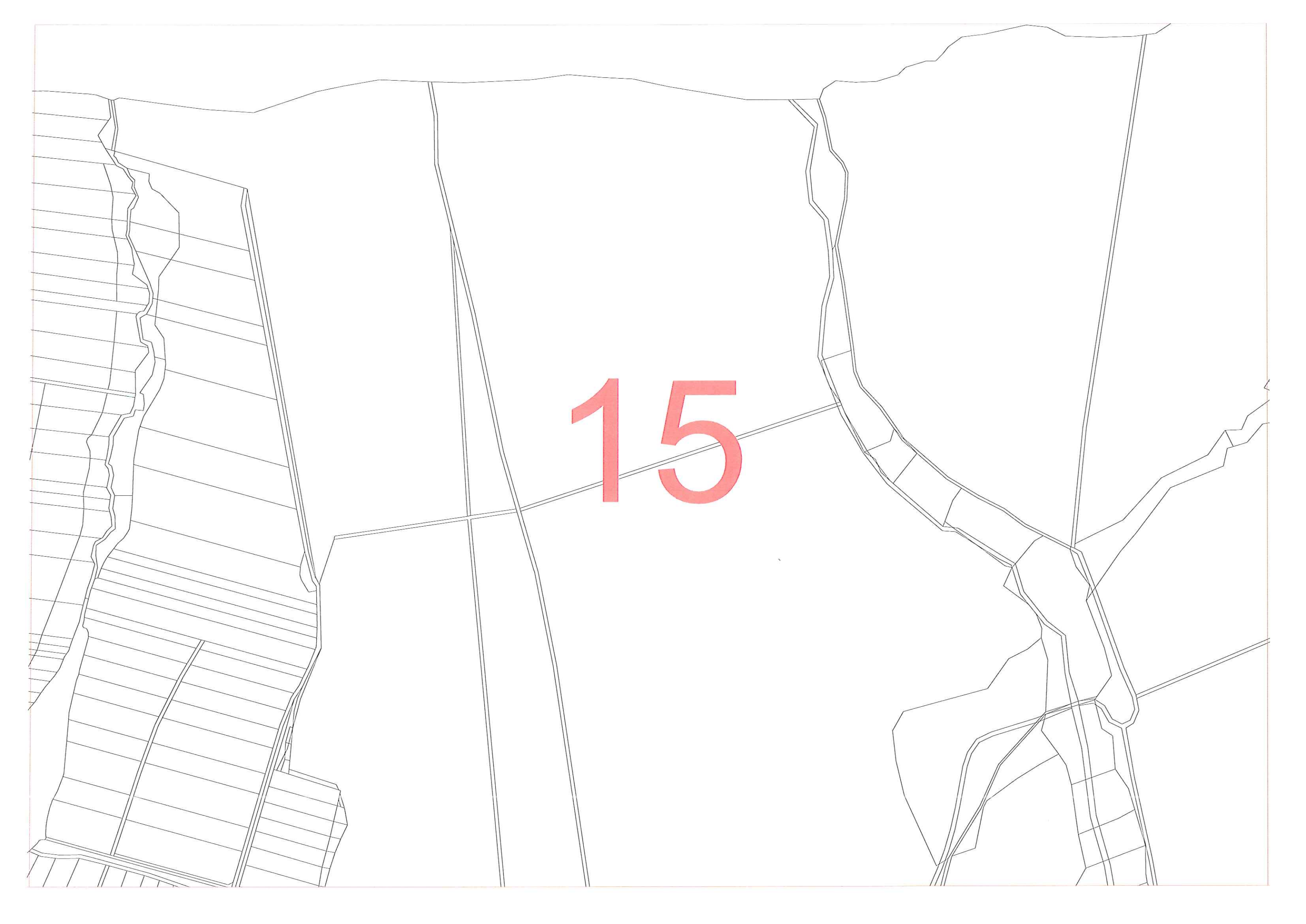
A technical drawing of a land parcel, possibly a survey map or a site plan. The drawing shows a large, irregularly shaped area with several internal lines representing boundaries or features. On the left side, there is a section with a grid of horizontal lines, suggesting a field or a specific type of terrain. The central part of the drawing is mostly blank, with a large red number '15' prominently displayed. The number is oriented vertically, with the '1' on the left and the '5' on the right. The overall appearance is that of a professional technical drawing, likely used in land management or engineering.