

VÝKAZ DOSAVADNÍHO A NOVÉHO STAVU ÚDAJŮ KATASTRU NEMOVITOSTÍ

Dosavadní stav			Nový stav												
Označení pozemku parc. číslem	Výměra parcely		Druh pozemku Způsob využití	Označení pozemku parc. číslem	Výměra parcely		Druh pozemku Způsob využití	Typ stavby Způsob využití	Zpús. určení výměr	Porovnání se stavem evidence právních vztahů					
	ha	m ²			ha	m ²				Díl přechází z pozemku označeného v katastru nemovitostí	Číslo listu vlastnictví	Výměra dílu		Označení dílu	
												ha	m ²		
1274/5										1274/5		4188			
1280/4										1280/4		685			
1299/12										1299/12		685			
1397/2										1397/2		4340			
1397/14										1397/14		4340			
1397/15										1397/15		4349			
1397/16										1397/16		4349			
1397/24										1397/24		4366			
1397/34										1397/34		4082			
1397/40										1397/40		2396			
1397/41										1397/41		4345			
1397/44										1397/44		4354			
1397/46										1397/46		4352			
1397/47										1397/47		2096			
1397/48										1397/48		4351			
1397/49										1397/49		4077			
1397/50										1397/50		2376			
1397/56										1397/56		4355			
1397/61										1397/61		3896			
1397/64										1397/64		2513			
1397/67										1397/67		1938			
1397/68										1397/68		4347			
1397/69										1397/69		4671			
1397/71										1397/71		4342			
1397/72										1397/72		236			
1397/73										1397/73		2673			
1397/75										1397/75		4344			
1397/76										1397/76		3921			
1397/82										1397/82		4360			
1397/83										1397/83		4360			
1397/84										1397/84		2680			
1397/86										1397/86		5180			
1397/87										1397/87		4369			
1397/88										1397/88		5167			
1397/91										1397/91		320			
1397/92										1397/92		320			
1397/96										1397/96		320			
8094										8094		10001			
8241										8241		10001			
8242										8242		10001			
8379										8379		10001			
8386/1										8386/1		1357			
8387										8387		10001			
8392										8392		10001			
8480										8480		4187			

Druh věcného břemene: dle smlouvy

Oprávněný: dle smlouvy

** Moravská Třebová 6-0/41,6-0/32,6-0/34,6-0/43

GEOMETRICKÝ PLÁN pro vymezení rozsahu věcného břemene k části pozemku	Geometrický plán ověřil úředně oprávněný zeměměřický inženýr:	Stejnopis ověřil úředně oprávněný zeměměřický inženýr:
	Jméno, příjmení: Ing. Michal Kadlec	Jméno, příjmení:
	Číslo položky seznamu úředně oprávněných zeměměřických inženýrů: 1899/2000	Číslo položky seznamu úředně oprávněných zeměměřických inženýrů:
	Dne: 21. srpna 2017 Číslo: 1138/2017	Dne: Číslo:
Náležitosti a přesností odpovídá právním předpisům.	Tento stejnopis odpovídá geometrickému plánu v elektronické podobě uloženému v dokumentaci katastrálního úřadu.	
Vyhotovitel: Ing. Michal Kadlec Za Lávkou 332 IČ: 701 44 575 560 02 Česká Třebová	Katastrální úřad souhlasí s očíslováním parcel.	Ověření stejnopisu geometrického plánu v listinné podobě.
Číslo plánu: 3595-1059/2016		
Okres: Ústí nad Orlicí		
Obec: Lanškroun		
Kat. území: Lanškroun		
Mapový list: **		
Dosavadním vlastníkům pozemků byla poskytnuta možnost seznámit se v terénu s průběhem navrhovaných nových hranic, které byly označeny předepsaným způsobem:		
--		

Seznam souřadnic (S-JTSK)				Seznam souřadnic (S-JTSK)			
Číslo bodu	Souřadnice pro zápis do KN		Poznámka	Číslo bodu	Souřadnice pro zápis do KN		Poznámka
k.ú.	Y	X	Kód kv.		Y	X	Kód kv.
Lanškroun (678929)							
132-1	591229.47	1081447.17	4	3499-1	591171.96	1081777.35	3
132-2	591229.78	1081330.82	4	3499-3	591168.54	1081778.62	3
132-3	591230.36	1081428.65	4	3499-4	591170.03	1081779.80	3
132-4	591233.52	1081361.00	4	3	591295.63	1081672.70	3
132-5	591234.15	1081368.54	4	157	591056.75	1081899.29	3
132-6	591233.11	1081393.57	4	186	590991.10	1081889.61	3
132-27	591191.70	1081198.10	4	197	590973.22	1081888.04	3
132-28	591226.18	1081282.97	4	211	590942.38	1081890.11	3
132-29	591220.19	1081267.19	4	226	590915.61	1081883.34	3
132-30	591218.07	1081262.05	4	240	590889.74	1081885.68	3
132-35	591162.68	1081153.34	4	297	590930.41	1081928.74	3
137-30	591243.17	1081531.92	4	305	590915.57	1081927.46	3
195-121	591287.49	1081620.42	4	362	590950.66	1081930.27	3
195-122	591306.72	1081657.45	4	373	590969.19	1081931.82	3
195-125	591311.75	1081654.33	4	404	591013.83	1081941.64	3
195-126	591316.66	1081663.59	4	405	591014.80	1081941.16	3
390-14	590832.66	1081876.62	4	483	591072.17	1081912.30	3
390-32	591140.04	1081812.83	4	484	591072.30	1081912.52	3
390-59	591153.88	1081803.82	4	485	591073.24	1081912.02	3
410-38	591309.12	1081659.83	3	595	591118.20	1081874.20	3
1624-140	591153.85	1081794.97	3	617	591125.83	1081843.87	3
1642-19	591156.38	1081793.22	3	634	591131.56	1081822.04	3
1642-20	591158.92	1081797.15	3	2500	590607.65	1081642.08	3
1671-1	591312.76	1081666.59	3	2501	590608.24	1081642.21	3
1813-128	591142.13	1081826.93	3	2502	590608.00	1081643.29	3
1814-15	591157.38	1081837.39	3	2503	590607.44	1081643.07	3
1814-16	591160.31	1081832.51	3	2504	590606.57	1081644.53	3
1814-21	591166.07	1081840.08	3	2505	590607.25	1081644.57	3
1814-33	591134.52	1081812.13	3	2506	590608.91	1081648.49	3
1814-40	591160.81	1081831.46	3	2507	590608.39	1081648.81	3
1814-42	591121.79	1081859.52	3	2508	590611.03	1081651.76	3
1814-43	591125.11	1081847.19	3	2509	590611.49	1081651.36	3
1814-44	591128.13	1081835.51	3	2510	590613.69	1081653.92	3
1814-45	591131.38	1081823.73	3	2511	590613.23	1081654.30	3
1814-46	591137.60	1081819.53	3	2512	590616.18	1081657.86	3
1814-47	591133.62	1081833.47	3	2513	590616.66	1081657.48	3
1814-63	591005.21	1081946.33	3	2514	590627.47	1081673.13	3
1814-69	590926.81	1081987.74	3	2515	590627.97	1081672.81	3
1814-79	590939.12	1081885.56	3	2516	590632.06	1081681.42	3
1814-80	590957.44	1081887.12	3	2517	590632.60	1081681.14	3
1814-81	590975.85	1081888.72	3	2518	590640.41	1081698.14	3
1814-82	590994.22	1081890.22	3	2519	590640.95	1081697.88	3
1814-84	591031.18	1081893.32	3	2520	590646.72	1081711.75	3
1814-85	591049.53	1081894.84	3	2521	590647.26	1081711.49	3
1814-86	591068.62	1081896.47	3	2522	590654.05	1081724.50	3
1814-87	591068.55	1081899.90	3	2523	590653.53	1081724.78	3
1814-92	590966.84	1081891.94	3	2524	590662.49	1081741.31	3
1814-93	590948.37	1081890.30	3	2525	590663.01	1081741.03	3
1814-94	590930.00	1081888.75	3	2526	590672.56	1081759.21	3
1814-96	590893.22	1081885.68	3	2527	590672.02	1081759.49	3
1814-97	590874.81	1081884.14	3	2528	590682.01	1081778.95	3
1814-101	590847.16	1081877.76	3	2529	590682.55	1081778.67	3
1814-102	590866.11	1081879.30	3	2530	590693.53	1081800.21	3
1814-103	590884.33	1081880.94	3	2531	590692.99	1081800.49	3
1814-104	590902.52	1081882.54	3	2532	590700.61	1081815.67	3
1814-105	590920.91	1081884.09	3	2533	590701.15	1081815.41	3
1814-116	590916.67	1081927.83	3	2534	590706.98	1081827.10	3
1814-117	590935.12	1081929.38	3	2535	590706.46	1081827.40	3
1814-118	590953.61	1081930.92	3	2536	590707.79	1081829.54	3
1814-119	590971.72	1081932.38	3	2537	590708.27	1081829.18	3
1814-121	591001.14	1081934.88	3	2538	590708.90	1081830.79	3
1814-123	591001.48	1081939.17	3	2539	590709.26	1081830.29	3
1814-131	590889.06	1081929.54	3	2540	590710.36	1081830.81	3
1814-132	590870.61	1081927.98	3	2541	590710.22	1081831.41	3
1814-135	590861.27	1081923.17	3	2542	590712.29	1081831.41	3
1814-136	590879.81	1081924.64	3	2543	590712.21	1081830.81	3
1814-137	590898.25	1081926.25	3	2544	590714.95	1081830.04	3
1814-199	591131.54	1081840.76	3	2545	590715.11	1081830.62	3
1814-200	591124.29	1081850.22	3	2546	590725.48	1081827.73	3
1814-201	591136.73	1081833.99	3	2547	590725.30	1081827.15	3
1814-209	591061.79	1081895.89	3	2548	590735.74	1081823.57	3
1814-210	591056.33	1081898.92	3	2549	590735.94	1081824.13	3
1814-214	590992.89	1081934.24	3	2550	590751.00	1081818.60	3
1814-215	590986.39	1081937.85	3	2551	590750.80	1081818.04	3
1814-227	591071.68	1081913.00	3	2552	590767.41	1081812.95	3
2096-1	591313.06	1081656.81	3	2553	590767.57	1081813.53	3
2558-3	591167.95	1081785.20	3	2554	590780.02	1081810.29	3
2697-7	591020.22	1081938.59	3	2555	590779.90	1081809.71	3
2697-98	590965.52	1081966.80	3	2556	590791.73	1081807.74	3
2697-104	591169.38	1081833.99	3	2557	590791.79	1081808.34	3
2697-105	591167.76	1081837.02	3	2558	590809.15	1081807.19	3
2697-107	591081.13	1081908.70	3	2559	590809.11	1081806.59	3
2698-573	591304.81	1081663.67	3	2560	590826.01	1081806.43	3
2698-674	590608.91	1081650.34	3	2561	590825.97	1081805.83	3
3082-119	591276.33	1081689.72	3	2562	590846.81	1081804.49	3
3082-192	591225.88	1081294.55	3	2563	590846.85	1081805.09	3
3082-517	590707.35	1081831.47	3	2564	590865.94	1081803.95	3
3082-518	590715.41	1081828.90	3	2565	590865.90	1081803.35	3
3082-522	590617.24	1081640.44	3	2566	590881.52	1081802.44	3
3082-732	591169.67	1081780.26	3	2567	590881.56	1081803.04	3
3082-883	591159.49	1081784.37	3	2568	590899.36	1081801.51	3
				2569	590899.32	1081800.91	3

Seznam souřadnic (S-JTSK)				
Číslo bodu	Souřadnice pro zápis do KN			Poznámka
	Y	X	Kód kv.	
2570	590913.18	1081800.50	3	
2571	590913.20	1081801.10	3	
2572	590931.62	1081800.76	3	
2573	590931.60	1081800.16	3	
2574	590949.73	1081799.70	3	
2575	590949.75	1081800.30	3	
2576	590957.71	1081799.90	3	
2577	590957.67	1081799.30	3	
2578	590970.41	1081798.57	3	
2579	590970.45	1081799.17	3	
2580	590988.14	1081797.91	3	
2581	590988.10	1081797.31	3	
2582	591004.02	1081796.53	3	
2583	591004.02	1081797.13	3	
2584	591020.93	1081797.41	3	
2585	591020.93	1081796.81	3	
2586	591037.52	1081796.56	3	
2587	591037.52	1081797.16	3	
2588	591057.29	1081796.80	3	
2589	591057.27	1081796.20	3	
2590	591076.54	1081795.72	3	
2591	591076.54	1081796.32	3	
2592	591090.92	1081796.47	3	
2593	591090.94	1081795.87	3	
2594	591099.22	1081796.08	3	
2595	591099.18	1081796.68	3	
2596	591113.92	1081797.87	3	
2597	591113.96	1081797.27	3	
2598	591124.88	1081798.18	3	
2599	591124.86	1081798.78	3	
2600	591129.37	1081798.79	3	
2601	591129.33	1081798.19	3	
2602	591135.34	1081797.27	3	
2603	591135.48	1081797.85	3	
2604	591139.44	1081796.65	3	
2605	591139.24	1081796.09	3	
2606	591143.75	1081794.18	3	
2607	591143.99	1081794.74	3	
2608	591150.78	1081791.70	3	
2609	591150.50	1081791.18	3	
2610	591155.91	1081787.67	3	
2611	591156.23	1081788.17	3	
2612	591163.64	1081783.65	3	
2613	591163.32	1081783.15	3	
2614	591168.57	1081779.68	3	
2615	591168.99	1081780.12	3	
2616	591169.51	1081779.39	3	
2617	591169.04	1081779.02	3	
2618	591170.98	1081778.59	3	
2619	591171.36	1081778.12	3	
2620	591172.04	1081778.77	3	
2621	591171.24	1081778.83	3	
2622	591170.79	1081779.41	3	
2623	591171.23	1081779.83	3	
2624	591168.60	1081781.30	3	
2625	591169.21	1081781.58	3	
2626	591165.17	1081784.34	3	
2627	591165.55	1081784.80	3	
2628	591162.76	1081786.94	3	
2629	591162.40	1081786.46	3	
2630	591160.32	1081788.02	3	
2631	591160.70	1081788.48	3	
2632	591159.13	1081789.82	3	
2633	591158.69	1081789.40	3	
2634	591157.41	1081791.02	3	
2635	591157.83	1081791.46	3	
2636	591155.45	1081793.17	3	
2637	591154.75	1081792.95	3	
2638	591155.48	1081795.18	3	
2639	591156.02	1081794.92	3	
2640	591156.57	1081796.92	3	
2641	591157.09	1081796.62	3	
2642	591158.29	1081799.07	3	
2643	591157.53	1081798.87	3	
2644	591156.53	1081799.53	3	
2645	591156.61	1081800.21	4	
2646	591155.34	1081801.09	3	
2647	591155.00	1081800.59	3	
2648	591151.46	1081803.11	3	
2649	591151.82	1081803.59	3	
2650	591147.61	1081806.74	3	
2651	591147.27	1081806.24	3	
2652	591142.70	1081809.08	3	
2653	591143.00	1081809.60	3	
2654	591140.78	1081810.84	3	
2655	591140.58	1081810.26	3	
2656	591137.67	1081810.84	3	
2657	591137.83	1081811.42	3	
2658	591136.49	1081811.88	3	
2659	591136.11	1081811.38	3	
2660	591135.50	1081812.25	4	
2661	591136.03	1081812.55	3	

Seznam souřadnic (S-JTSK)				
Číslo bodu	Souřadnice pro zápis do KN			Poznámka
	Y	X	Kód kv.	
2662	591134.45	1081818.84	3	
2663	591133.87	1081818.68	3	
2664	591132.92	1081822.20	3	
2665	591133.42	1081822.62	3	
2666	591132.78	1081822.78	3	
2667	591131.70	1081822.55	3	
2668	591131.49	1081822.37	3	
2669	591131.86	1081821.97	3	
2670	591132.30	1081825.41	3	
2671	591132.93	1081825.26	3	
2672	591132.81	1081825.85	3	
2673	591131.83	1081827.40	3	
2674	591132.41	1081827.56	3	
2675	591131.57	1081830.08	3	
2676	591131.01	1081829.84	3	
2677	591130.06	1081831.68	3	
2678	591130.50	1081832.12	3	
2679	591129.86	1081832.25	3	
2680	591129.07	1081832.10	3	
2681	591128.92	1081831.84	3	
2682	591129.03	1081831.58	3	
2683	591129.23	1081831.52	3	
2684	591128.69	1081837.25	3	
2685	591129.27	1081837.39	3	
2686	591127.43	1081844.09	3	
2687	591126.93	1081843.65	3	
2688	591126.07	1081843.46	3	
2689	591125.90	1081843.55	3	
2690	591125.92	1081844.04	3	
2691	591126.77	1081844.23	3	
2692	591124.85	1081851.34	3	
2693	591125.43	1081851.50	3	
2694	591124.29	1081855.05	3	
2695	591123.80	1081854.60	3	
2696	591123.17	1081854.40	3	
2697	591122.95	1081854.48	3	
2698	591122.86	1081854.79	3	
2699	591123.01	1081854.98	3	
2700	591123.64	1081855.17	3	
2701	591122.13	1081861.19	3	
2702	591122.71	1081861.33	3	
2703	591121.32	1081867.28	3	
2704	591120.74	1081867.12	3	
2705	591119.55	1081871.30	3	
2706	591120.13	1081871.48	3	
2707	591119.51	1081873.44	3	
2708	591119.33	1081874.10	3	
2709	591118.93	1081873.28	3	
2710	591118.83	1081873.65	3	
2711	591118.25	1081873.88	3	
2712	591118.46	1081874.44	3	
2713	591135.72	1081826.11	3	
2714	591135.56	1081826.69	3	
2715	591140.06	1081828.23	3	
2716	591140.22	1081827.65	3	
2717	591146.62	1081829.44	3	
2718	591146.72	1081828.84	3	
2719	591152.21	1081829.71	3	
2720	591152.05	1081830.29	3	
2721	591154.21	1081831.12	3	
2722	591154.43	1081830.56	3	
2723	591157.17	1081831.70	3	
2724	591157.03	1081832.30	3	
2725	591159.58	1081832.45	3	
2726	591159.74	1081831.85	3	
2727	591164.90	1081834.58	3	
2728	591164.64	1081835.12	3	
2729	591167.67	1081836.43	3	
2730	591168.28	1081836.05	3	
2731	591168.13	1081842.12	3	
2732	591167.53	1081841.96	3	
2733	591163.45	1081849.00	3	
2734	591163.97	1081849.30	3	
2735	591160.04	1081855.95	3	
2736	591159.52	1081855.63	3	
2737	591156.28	1081860.88	3	
2738	591156.80	1081861.18	3	
2739	591153.69	1081866.73	3	
2740	591153.17	1081866.43	3	
2741	591149.96	1081871.98	3	
2742	591150.48	1081872.28	3	
2743	591147.53	1081877.32	3	
2744	591147.03	1081877.00	3	
2745	591144.29	1081880.91	3	
2746	591144.77	1081881.27	3	
2747	591141.52	1081885.04	3	
2748	591141.10	1081884.60	3	
2749	591137.50	1081887.44	3	
2750	591137.84	1081887.94	3	
2751	591132.22	1081890.61	3	
2752	591132.50	1081891.15	3	
2753	591126.73	1081893.53	3	

Číslo bodu	Seznam souřadnic (S-JTSK)			
	Souřadnice pro zápis do KN			Poznámka
	Y	X	Kód kv.	
2754	591126.51	1081892.97	3	
2755	591119.96	1081895.44	3	
2756	591120.16	1081896.00	3	
2757	591113.92	1081898.11	3	
2758	591113.74	1081897.53	3	
2759	591108.05	1081899.33	3	
2760	591108.23	1081899.89	3	
2761	591104.28	1081901.28	3	
2762	591104.08	1081900.72	3	
2763	591097.20	1081903.28	3	
2764	591097.40	1081903.84	3	
2765	591090.23	1081906.53	3	
2766	591090.01	1081905.97	3	
2767	591083.11	1081908.66	3	
2768	591083.33	1081909.22	3	
2769	591075.99	1081912.42	3	
2770	591075.75	1081911.88	3	
2771	591073.20	1081913.01	3	
2772	591073.12	1081913.70	3	
2773	591072.65	1081913.26	3	
2774	591072.43	1081912.45	3	
2775	591072.97	1081912.16	3	
2776	591073.12	1081911.79	3	
2777	591072.83	1081911.95	3	
2778	591072.30	1081912.23	3	
2779	591071.38	1081910.57	3	
2780	591071.92	1081910.29	3	
2781	591070.63	1081907.49	3	
2782	591070.07	1081907.71	3	
2783	591069.59	1081906.21	3	
2784	591070.19	1081906.11	3	
2785	591070.14	1081903.73	3	
2786	591069.54	1081903.75	3	
2787	591069.38	1081899.15	3	
2788	591069.96	1081898.67	3	
2789	591068.58	1081898.37	3	
2790	591068.57	1081898.98	3	
2791	591065.06	1081898.81	3	
2792	591065.10	1081898.21	3	
2793	591056.75	1081897.57	3	
2794	591056.98	1081898.19	3	
2795	591056.93	1081898.97	3	
2796	591056.40	1081899.25	3	
2797	591056.39	1081898.14	3	
2798	591053.30	1081897.82	3	
2799	591053.34	1081897.22	3	
2800	591047.86	1081896.90	3	
2801	591047.52	1081897.48	3	
2802	591047.26	1081896.85	3	
2803	591048.03	1081894.72	3	
2804	591047.89	1081894.37	3	
2805	591047.59	1081894.32	3	
2806	591047.43	1081894.67	3	
2807	591040.28	1081896.09	3	
2808	591040.22	1081896.69	3	
2809	591031.12	1081896.07	3	
2810	591031.16	1081895.47	3	
2811	591022.52	1081894.77	3	
2812	591022.48	1081895.37	3	
2813	591014.07	1081894.78	3	
2814	591014.11	1081894.18	3	
2815	591006.02	1081893.53	3	
2816	591005.98	1081894.13	3	
2817	590997.92	1081893.49	3	
2818	590997.96	1081892.89	3	
2819	590991.57	1081892.36	3	
2820	590991.01	1081892.92	3	
2821	590990.90	1081891.40	3	
2822	590991.48	1081891.12	3	
2823	590991.53	1081890.00	3	
2824	590991.41	1081889.64	3	
2825	590990.94	1081889.95	3	
2826	590990.90	1081890.80	3	
2827	590987.52	1081890.53	3	
2828	590987.48	1081891.13	3	
2829	590980.32	1081890.60	3	
2830	590980.38	1081890.00	3	
2831	590973.63	1081889.31	3	
2832	590973.55	1081889.91	3	
2833	590973.01	1081889.54	3	
2834	590973.67	1081888.53	3	
2835	590973.56	1081888.07	3	
2836	590973.08	1081888.48	3	
2837	590973.28	1081891.35	3	
2838	590972.78	1081890.73	3	
2839	590969.03	1081890.57	3	
2840	590968.99	1081891.17	3	
2841	590963.88	1081890.62	3	
2842	590963.64	1081889.99	3	
2843	590963.29	1081890.56	3	
2844	590963.20	1081891.62	3	
2845	590963.32	1081891.85	3	

Číslo bodu	Seznam souřadnic (S-JTSK)			
	Souřadnice pro zápis do KN			Poznámka
	Y	X	Kód kv.	
2846	590963.65	1081891.86	3	
2847	590963.80	1081891.67	3	
2848	590957.61	1081889.92	3	
2849	590957.67	1081889.32	3	
2850	590951.52	1081888.93	3	
2851	590951.17	1081889.51	3	
2852	590950.92	1081888.90	3	
2853	590951.79	1081886.64	3	
2854	590951.63	1081886.35	3	
2855	590951.31	1081886.34	3	
2856	590951.19	1081886.59	3	
2857	590947.48	1081888.71	3	
2858	590947.44	1081889.31	3	
2859	590942.85	1081889.07	3	
2860	590942.57	1081888.45	3	
2861	590942.25	1081889.01	3	
2862	590942.27	1081889.79	3	
2863	590942.69	1081890.15	3	
2864	590942.87	1081889.84	3	
2865	590937.49	1081888.39	3	
2866	590937.55	1081887.79	3	
2867	590930.65	1081887.14	3	
2868	590930.59	1081887.74	3	
2869	590922.20	1081887.09	3	
2870	590922.26	1081886.49	3	
2871	590917.62	1081886.07	3	
2872	590917.56	1081886.67	3	
2873	590915.09	1081886.34	3	
2874	590915.77	1081885.82	3	
2875	590915.92	1081884.66	3	
2876	590916.08	1081883.68	3	
2877	590915.94	1081883.38	3	
2878	590915.48	1081883.63	3	
2879	590915.37	1081884.31	3	
2880	590915.28	1081884.90	3	
2881	590912.03	1081884.14	3	
2882	590911.99	1081884.74	3	
2883	590907.40	1081884.39	3	
2884	590907.46	1081883.79	3	
2885	590900.79	1081883.04	3	
2886	590900.46	1081883.61	3	
2887	590900.19	1081883.00	3	
2888	590900.81	1081882.39	3	
2889	590900.68	1081882.04	3	
2890	590900.39	1081882.02	3	
2891	590900.22	1081882.34	3	
2892	590897.13	1081882.94	3	
2893	590897.11	1081883.54	3	
2894	590890.38	1081883.02	3	
2895	590890.12	1081882.40	3	
2896	590889.78	1081882.97	3	
2897	590889.65	1081885.38	3	
2898	590890.07	1081885.69	3	
2899	590890.25	1081885.43	3	
2900	590883.99	1081882.47	3	
2901	590884.05	1081881.87	3	
2902	590878.36	1081881.33	3	
2903	590878.00	1081881.90	3	
2904	590877.76	1081881.27	3	
2905	590878.45	1081880.41	3	
2906	590878.39	1081879.96	3	
2907	590878.06	1081879.94	3	
2908	590877.85	1081880.36	3	
2909	590875.14	1081881.04	3	
2910	590875.08	1081881.64	3	
2911	590865.75	1081880.75	3	
2912	590865.81	1081880.15	3	
2913	590856.84	1081879.48	3	
2914	590856.80	1081880.08	3	
2915	590847.96	1081879.33	3	
2916	590848.00	1081878.73	3	
2917	590843.38	1081878.58	3	
2918	590843.32	1081879.18	3	
2919	590842.01	1081878.95	3	
2920	590842.33	1081878.39	3	
2921	590842.14	1081878.15	3	
2922	590841.58	1081878.41	3	
2923	590841.36	1081877.11	3	
2924	590841.53	1081876.81	3	
2925	590841.85	1081876.81	3	
2926	590841.97	1081877.07	3	
2927	591069.51	1081914.73	3	
2928	591069.77	1081915.27	3	
2929	591064.97	1081917.49	3	
2930	591064.73	1081916.95	3	
2931	591059.46	1081919.31	3	
2932	591059.72	1081919.85	3	
2933	591054.73	1081922.34	3	
2934	591054.47	1081921.80	3	
2935	591048.85	1081924.61	3	
2936	591049.13	1081925.15	3	
2937	591043.61	1081928.00	3	

Číslo bodu	Seznam souřadnic (S-JTSK)			Poznámka
	Souřadnice pro zápis do KN			
	Y	X	Kód kv.	
2938	591043.33	1081927.46	3	
2939	591037.74	1081930.40	3	
2940	591038.02	1081930.94	3	
2941	591031.66	1081934.05	3	
2942	591031.38	1081933.51	3	
2943	591025.30	1081936.91	3	
2944	591025.60	1081937.43	3	
2945	591020.50	1081940.33	3	
2946	591020.22	1081939.81	3	
2947	591016.38	1081941.85	3	
2948	591016.66	1081942.39	3	
2949	591014.76	1081943.38	3	
2950	591014.26	1081942.98	3	
2951	591014.80	1081942.68	3	
2952	591014.52	1081941.53	3	
2953	591014.89	1081941.34	3	
2954	591014.59	1081941.26	3	
2955	591013.93	1081941.83	3	
2956	591013.93	1081941.59	3	
2957	591013.91	1081941.27	3	
2958	591013.58	1081939.36	3	
2959	591013.02	1081939.60	3	
2960	591011.51	1081935.23	3	
2961	591012.05	1081934.97	3	
2962	591010.95	1081933.28	3	
2963	591010.69	1081933.98	3	
2964	591009.47	1081934.35	3	
2965	591009.25	1081933.79	3	
2966	591005.08	1081935.72	3	
2967	591005.32	1081936.28	3	
2968	591002.64	1081937.31	3	
2969	591002.50	1081936.73	3	
2970	590999.39	1081937.08	3	
2971	590999.41	1081937.68	3	
2972	590995.17	1081937.45	3	
2973	590995.19	1081936.85	3	
2974	590991.60	1081936.73	3	
2975	590991.56	1081937.33	3	
2976	590983.04	1081936.62	3	
2977	590983.08	1081936.02	3	
2978	590977.52	1081935.60	3	
2979	590977.48	1081936.20	3	
2980	590968.99	1081935.42	3	
2981	590969.21	1081934.84	3	
2982	590968.73	1081934.47	3	
2983	590968.07	1081934.73	3	
2984	590968.29	1081933.63	3	
2985	590968.94	1081933.44	3	
2986	590969.28	1081932.18	3	
2987	590968.85	1081931.80	3	
2988	590968.68	1081932.13	3	
2989	590968.43	1081933.04	3	
2990	590965.74	1081932.70	3	
2991	590965.68	1081933.30	3	
2992	590957.82	1081932.62	3	
2993	590957.88	1081932.02	3	
2994	590950.67	1081931.44	3	
2995	590950.32	1081932.01	3	
2996	590950.07	1081931.39	3	
2997	590950.14	1081930.63	3	
2998	590950.32	1081930.23	3	
2999	590950.74	1081930.68	3	
3000	590944.12	1081930.95	3	
3001	590944.08	1081931.55	3	
3002	590935.68	1081930.94	3	
3003	590935.74	1081930.34	3	
3004	590930.76	1081929.75	3	
3005	590930.39	1081930.31	3	
3006	590930.16	1081929.69	3	
3007	590930.25	1081928.97	3	
3008	590930.75	1081928.78	3	
3009	590930.85	1081929.02	3	
3010	590925.41	1081929.33	3	
3011	590925.37	1081929.93	3	
3012	590917.94	1081929.40	3	
3013	590917.98	1081928.80	3	
3014	590915.91	1081928.65	3	
3015	590915.80	1081929.24	3	
3016	590915.26	1081928.86	3	
3017	590916.04	1081927.78	3	
3018	590915.93	1081927.50	3	
3019	590915.44	1081927.72	3	
3020	590914.93	1081930.33	3	
3021	590915.41	1081930.97	3	
3022	590909.01	1081930.55	3	
3023	590909.05	1081929.95	3	
3024	590901.31	1081929.33	3	
3025	590901.27	1081929.93	3	
3026	590893.67	1081929.30	3	
3027	590893.73	1081928.70	3	
3028	590885.33	1081927.96	3	
3029	590885.59	1081928.59	3	

Číslo bodu	Seznam souřadnic (S-JTSK)			Poznámka
	Souřadnice pro zápis do KN			
	Y	X	Kód kv.	
3030	590885.58	1081929.25	3	
3031	590885.40	1081929.60	3	
3032	590885.08	1081929.57	3	
3033	590884.98	1081929.20	3	
3034	590884.99	1081928.54	3	
3035	590881.73	1081928.26	3	
3036	590881.77	1081927.66	3	
3037	590874.03	1081927.18	3	
3038	590873.99	1081927.78	3	
3039	590869.91	1081927.36	3	
3040	590870.23	1081926.80	3	
3041	590869.84	1081926.26	3	
3042	590869.24	1081926.44	3	
3043	590869.33	1081923.81	3	
3044	590869.52	1081923.53	3	
3045	590869.83	1081923.56	3	
3046	590869.93	1081923.86	3	
3047	591009.46	1081945.82	3	
3048	591009.76	1081946.34	3	
3049	591003.00	1081949.31	3	
3050	591003.28	1081949.85	3	
3051	590996.64	1081953.15	3	
3052	590996.38	1081952.61	3	
3053	590988.75	1081956.48	3	
3054	590989.01	1081957.02	3	
3055	590982.21	1081959.69	3	
3056	590982.49	1081960.23	3	
3057	590974.33	1081964.55	3	
3058	590974.05	1081964.01	3	
3059	590968.58	1081966.88	3	
3060	590968.86	1081967.42	3	
3061	590961.58	1081971.24	3	
3062	590961.30	1081970.70	3	
3063	590955.95	1081973.54	3	
3064	590956.19	1081974.10	3	
3065	590954.34	1081974.74	3	
3066	590954.34	1081974.10	3	
3067	590954.09	1081974.01	3	
3068	590953.57	1081974.45	3	
3069	590953.34	1081973.39	3	
3070	590953.31	1081972.99	3	
3071	590953.56	1081972.84	3	
3072	590953.89	1081973.09	3	
3073	591171.43	1081778.02	3	
3074	591171.81	1081777.54	3	
3075	591172.26	1081777.82	3	
3076	591172.28	1081778.54	3	
3077	591173.55	1081777.69	3	
3078	591173.13	1081777.25	3	
3079	591175.91	1081773.56	3	
3080	591176.39	1081773.92	3	
3081	591179.21	1081769.86	3	
3082	591178.73	1081769.50	3	
3083	591182.00	1081765.55	3	
3084	591182.44	1081765.95	3	
3085	591186.53	1081761.83	3	
3086	591186.11	1081761.39	3	
3087	591192.97	1081755.35	3	
3088	591193.35	1081755.81	3	
3089	591200.54	1081750.25	3	
3090	591200.18	1081749.77	3	
3091	591207.50	1081744.09	3	
3092	591207.88	1081744.57	3	
3093	591216.17	1081737.84	3	
3094	591215.79	1081737.38	3	
3095	591225.28	1081729.52	3	
3096	591225.68	1081729.98	3	
3097	591235.66	1081721.13	3	
3098	591235.26	1081720.69	3	
3099	591243.17	1081713.53	3	
3100	591243.57	1081713.97	3	
3101	591251.46	1081706.76	3	
3102	591251.04	1081706.32	3	
3103	591256.48	1081701.10	3	
3104	591256.88	1081701.54	3	
3105	591263.82	1081695.23	3	
3106	591263.42	1081694.79	3	
3107	591270.32	1081688.38	3	
3108	591270.72	1081688.82	3	
3109	591276.03	1081683.96	3	
3110	591275.63	1081683.52	3	
3111	591281.78	1081677.66	3	
3112	591282.20	1081678.10	3	
3113	591287.36	1081673.25	3	
3114	591286.94	1081672.83	3	
3115	591290.53	1081668.95	3	
3116	591290.81	1081669.53	3	
3117	591291.26	1081669.50	3	
3118	591291.46	1081668.88	3	
3119	591293.41	1081671.26	3	
3120	591293.69	1081670.72	3	
3121	591294.82	1081671.05	3	

Seznam souřadnic (S-JTSK)				
Číslo bodu	Souřadnice pro zápis do KN			Poznámka
	Y	X	Kód kv.	
3122	591294.71	1081671.65	3	
3123	591295.24	1081672.42	3	
3124	591295.69	1081672.01	3	
3125	591295.29	1081671.43	3	
3126	591297.34	1081669.40	3	
3127	591296.92	1081668.98	3	
3128	591300.71	1081665.30	3	
3129	591301.13	1081665.72	3	
3130	591305.72	1081660.97	3	
3131	591305.30	1081660.55	3	
3132	591306.92	1081659.02	3	
3133	591306.92	1081659.85	3	
3134	591307.08	1081660.03	3	
3135	591307.99	1081659.21	3	
3136	591307.89	1081659.10	3	
3137	591308.62	1081658.60	3	
3138	591308.38	1081658.04	3	
3139	591309.04	1081657.35	3	
3140	591309.14	1081658.11	3	
3141	591309.42	1081657.81	3	
3142	591311.93	1081655.42	3	
3143	591309.67	1081658.26	3	
3144	591309.31	1081658.78	3	
3145	591311.00	1081661.10	3	
3146	591311.50	1081660.78	3	
3147	591312.62	1081663.94	3	
3148	591313.14	1081663.66	3	
3149	591245.82	1081538.55	3	
3150	591245.50	1081539.25	3	
3151	591245.07	1081537.10	3	
3152	591244.51	1081537.32	3	
3153	591242.50	1081530.43	3	
3154	591240.53	1081522.91	3	
3155	591241.11	1081522.77	3	
3156	591239.53	1081515.20	3	
3157	591238.95	1081515.32	3	
3158	591237.56	1081507.42	3	
3159	591238.16	1081507.32	3	
3160	591236.95	1081499.75	3	
3161	591236.35	1081499.85	3	
3162	591235.23	1081493.94	3	
3163	591235.85	1081494.00	3	
3164	591236.16	1081493.21	3	
3165	591235.72	1081492.71	3	
3166	591229.33	1081448.62	3	
3167	591229.19	1081447.77	3	
3168	591229.10	1081440.53	3	
3169	591229.70	1081440.55	3	
3170	591229.47	1081433.40	3	
3171	591230.07	1081433.44	3	
3172	591229.72	1081429.32	3	
3173	591230.19	1081427.98	3	
3174	591232.51	1081386.22	3	
3175	591233.11	1081385.94	3	
3176	591232.49	1081380.01	3	
3177	591233.09	1081380.01	3	
3178	591233.14	1081374.02	3	
3179	591232.54	1081374.02	3	
3180	591232.50	1081366.29	3	
3181	591233.10	1081366.29	3	
3182	591233.15	1081361.12	3	
3183	591232.55	1081361.14	3	
3184	591232.07	1081354.93	3	
3185	591232.67	1081354.89	3	
3186	591231.48	1081345.15	3	
3187	591227.12	1081299.17	3	
3188	591226.81	1081296.88	3	
3189	591226.23	1081297.04	3	
3190	591226.47	1081294.46	3	
3191	591224.78	1081287.75	3	
3192	591225.38	1081287.65	3	
3193	591224.11	1081284.05	3	
3194	591224.69	1081283.91	3	
3195	591222.59	1081278.52	3	
3196	591223.17	1081278.38	3	
3197	591221.78	1081274.88	3	
3198	591222.36	1081274.72	3	
3199	591220.60	1081269.58	3	
3200	591220.04	1081269.80	3	
3201	591217.32	1081263.49	3	
3202	591218.00	1081263.55	3	
3203	591217.77	1081262.99	3	
3204	591215.35	1081256.75	3	
3205	591214.79	1081256.97	3	
3206	591212.90	1081252.49	3	
3207	591213.46	1081252.27	3	
3208	591211.43	1081246.70	3	
3209	591210.87	1081246.92	3	
3210	591208.31	1081240.80	3	
3211	591208.87	1081240.56	3	
3212	591206.33	1081234.63	3	
3213	591205.77	1081234.87	3	

Seznam souřadnic (S-JTSK)				
Číslo bodu	Souřadnice pro zápis do KN			Poznámka
	Y	X	Kód kv.	
3214	591202.86	1081227.89	3	
3215	591203.42	1081227.67	3	
3216	591201.43	1081222.57	3	
3217	591200.87	1081222.79	3	
3218	591199.75	1081219.90	3	
3219	591200.41	1081219.93	3	
3220	591200.17	1081219.38	3	
3221	591198.62	1081216.18	3	
3222	591198.08	1081216.42	3	
3223	591195.65	1081210.65	3	
3224	591196.21	1081210.41	3	
3225	591193.21	1081203.32	3	
3226	591192.67	1081203.56	3	
3227	591190.36	1081198.55	3	
3228	591190.90	1081198.29	3	
3229	591186.49	1081190.96	3	
3230	591182.81	1081184.71	3	
3231	591178.14	1081177.62	3	
3232	591174.54	1081172.20	3	
3233	591171.09	1081167.11	3	
3234	591295.84	1081672.45	3	
3250	590609.71	1081649.38	3	
3251	590609.32	1081649.85	3	
3252	590709.14	1081830.90	3	
3253	590709.98	1081830.63	3	
3254	591164.59	1081782.31	3	
3255	591167.37	1081781.19	3	
3256	591169.61	1081780.43	3	
3257	591155.63	1081793.74	3	
3258	591155.12	1081794.09	3	
3259	591157.97	1081798.41	4	
3260	591136.17	1081812.34	4	
3261	591126.58	1081847.23	3	
3262	591125.62	1081848.48	3	
3263	591141.41	1081827.87	3	
3264	591141.00	1081828.40	3	
3265	591160.45	1081832.22	3	
3266	591160.16	1081832.76	3	
3267	591167.65	1081837.22	3	
3268	591073.03	1081912.39	3	
3269	591072.48	1081912.64	3	
3270	591058.52	1081897.71	3	
3271	591057.56	1081898.23	3	
3272	591056.96	1081898.57	3	
3273	590842.01	1081877.36	4	
3274	590841.39	1081877.31	4	
3275	591001.34	1081937.46	3	
3276	591001.30	1081936.87	3	
3277	590987.88	1081937.02	3	
3278	590988.82	1081936.50	3	
3279	591309.73	1081659.36	3	
3280	591310.21	1081659.00	3	
k.ú. Rudoltice u Lanškrouna (743500)				
554-126	591203.47	1081226.89	8	
1178-1776	591242.62	1081528.52	4	
1178-1777	591244.10	1081533.77	4	
1178-1778	591246.41	1081538.39	4	
1178-1779	591246.68	1081538.93	4	
1178-1947	591311.48	1081654.50	4	
1178-1949	591312.50	1081655.75	4	
1178-1950	591314.09	1081665.57	4	
1178-1951	591313.61	1081665.94	4	
1208-586	591171.35	1081166.72	4	
1208-591	591187.48	1081191.60	4	
1208-592	591200.36	1081219.29	8	
1208-593	591200.59	1081219.85	8	
1208-760	591218.37	1081262.77	4	
1208-761	591218.60	1081263.33	4	
1208-912	591227.32	1081298.07	4	
1208-913	591227.58	1081301.60	4	
1208-975	591231.07	1081341.21	4	
1208-976	591232.58	1081353.41	4	
1208-977	591233.42	1081386.21	4	
1208-978	591233.38	1081386.97	4	
1208-1299	591229.75	1081448.93	4	
1208-1301	591229.72	1081441.97	4	
1208-1302	591230.32	1081429.41	4	
1208-1303	591230.42	1081427.91	4	
1208-1332	591236.78	1081492.42	4	
1208-1333	591236.88	1081493.01	4	

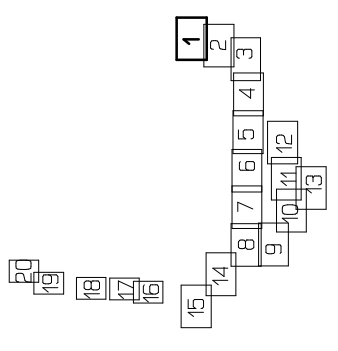
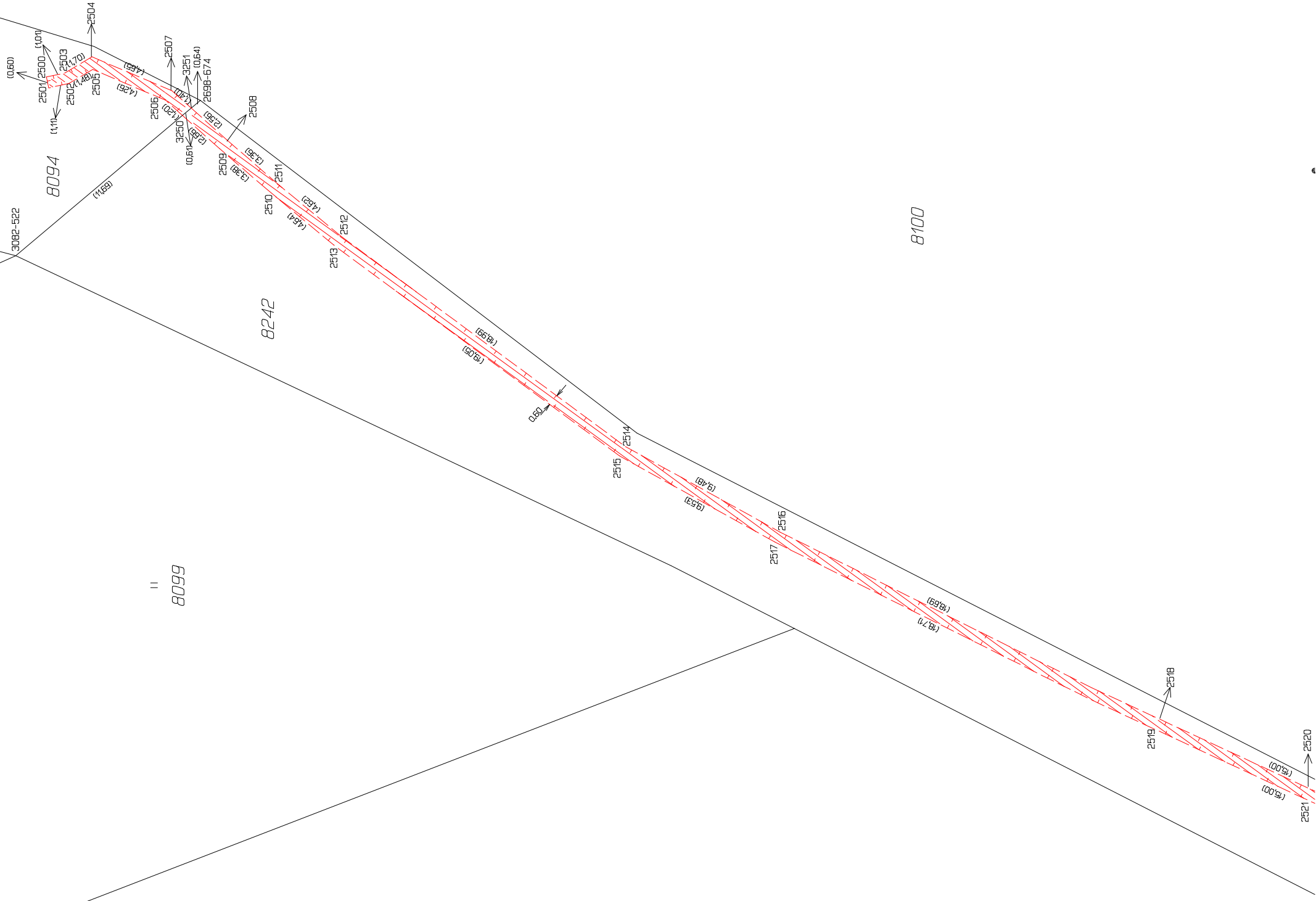

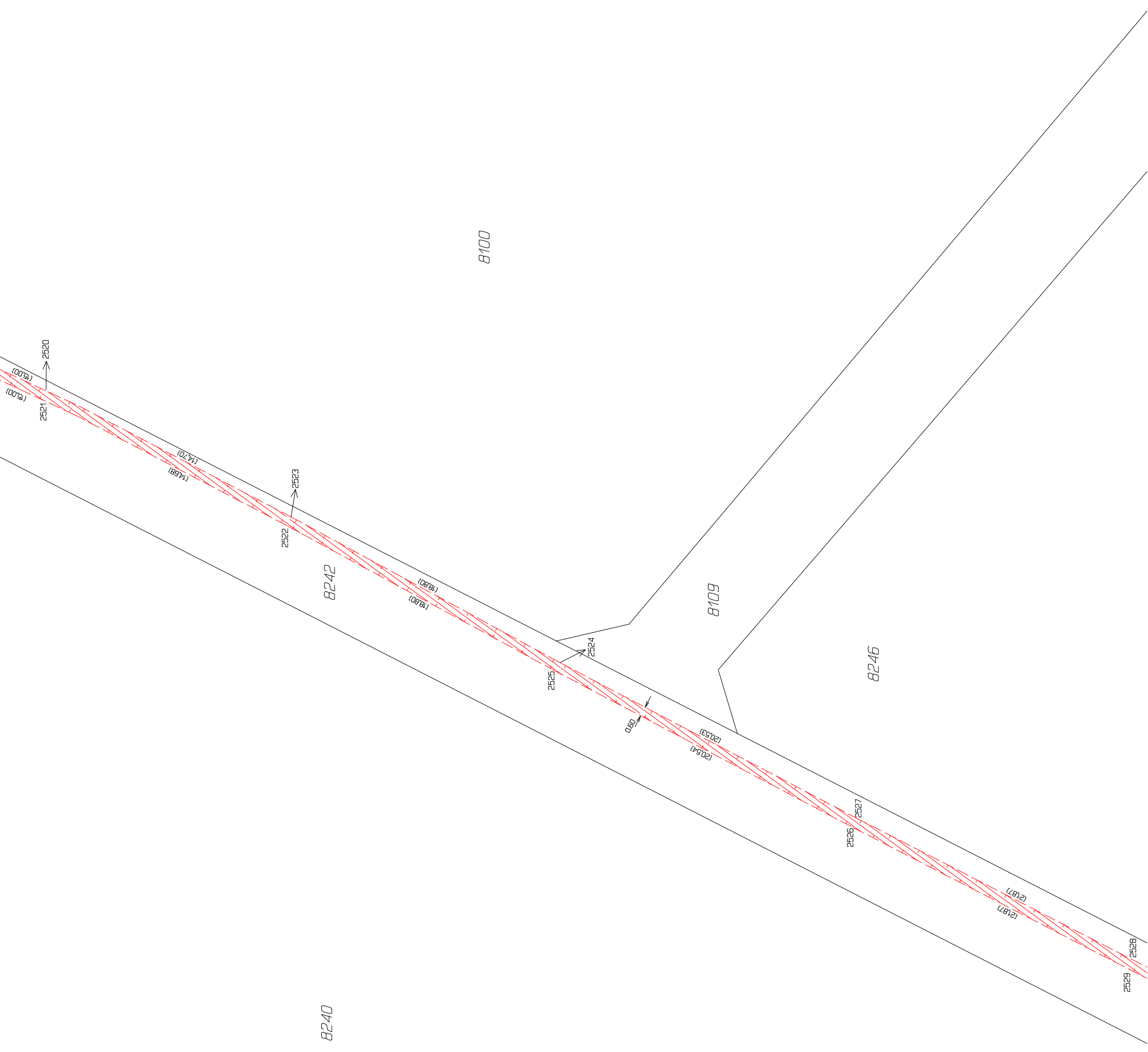
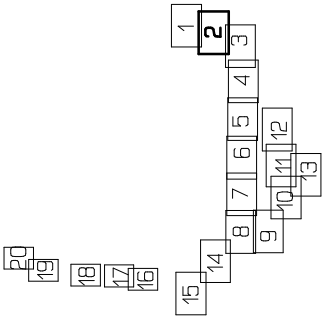

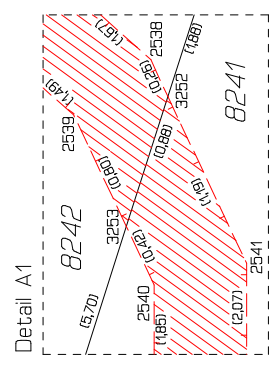
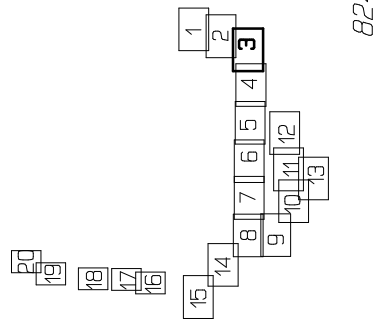
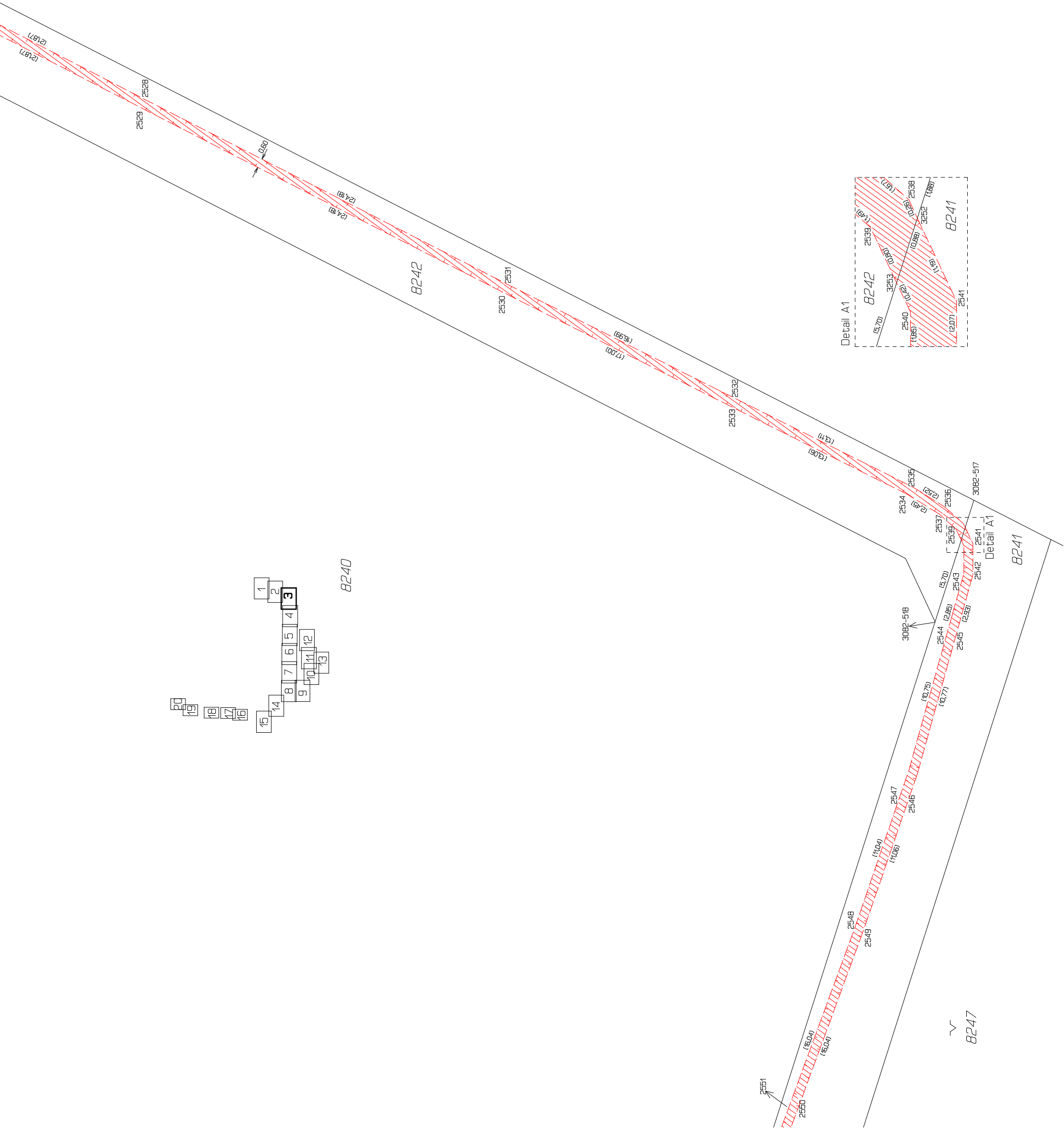

8246

Ciheina

8247

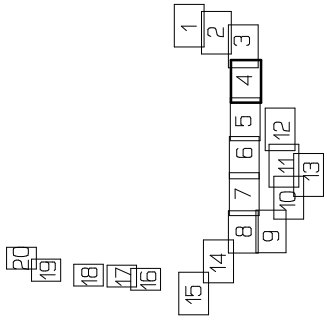

8240

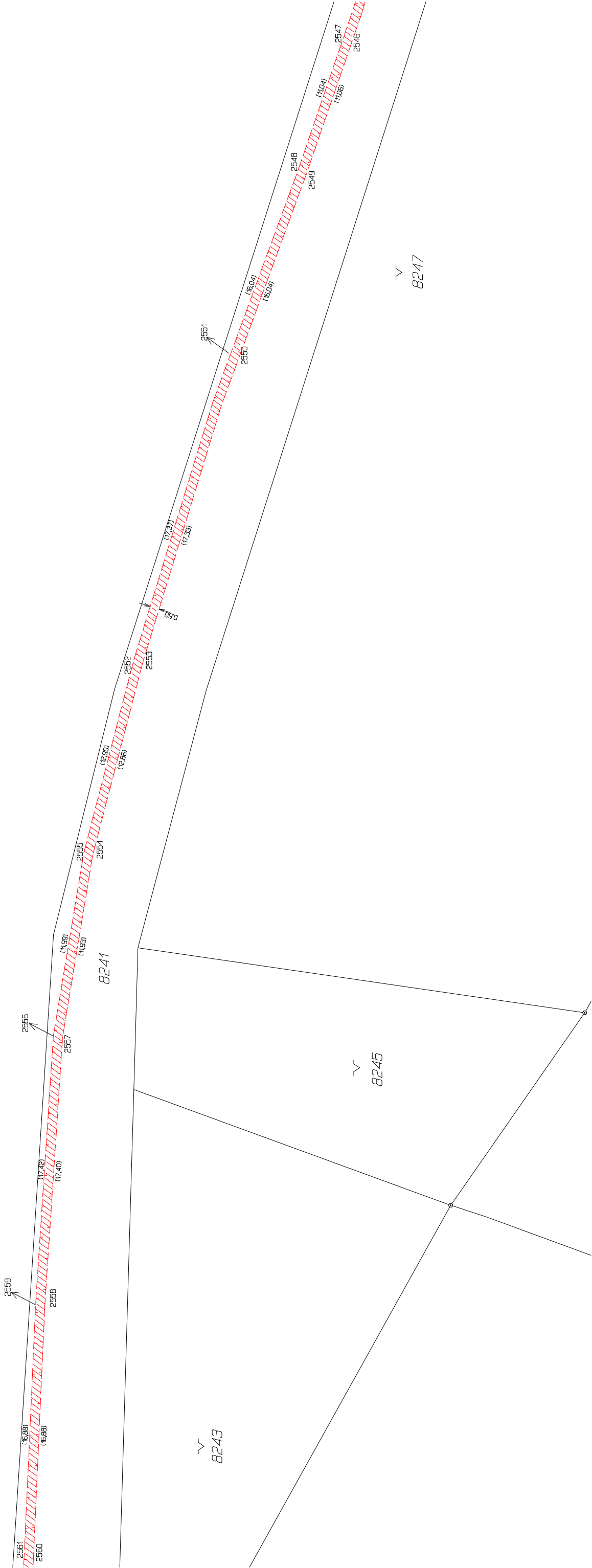

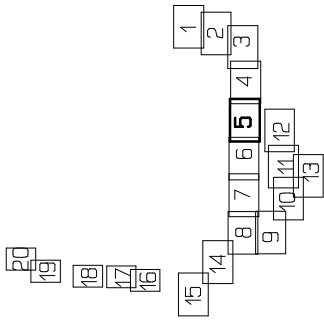

8239

8240

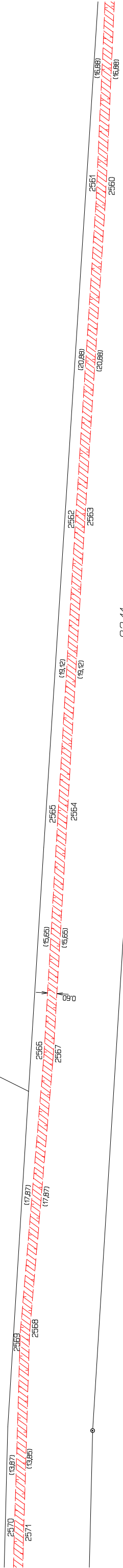

8241

1382/2

1382/11

8243

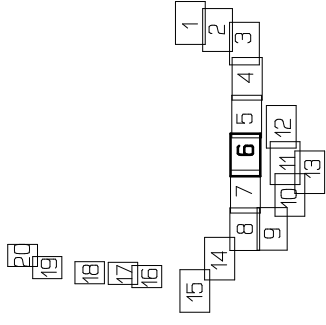

8239

8238

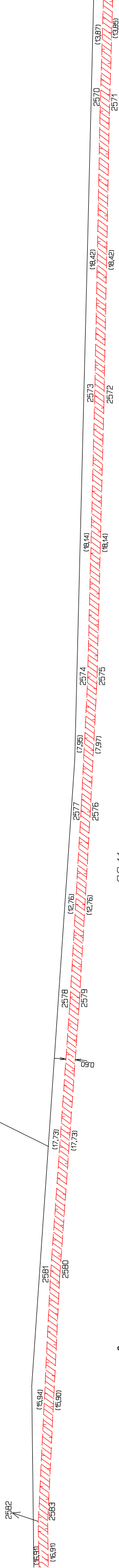

8241

1299/11

1382/2

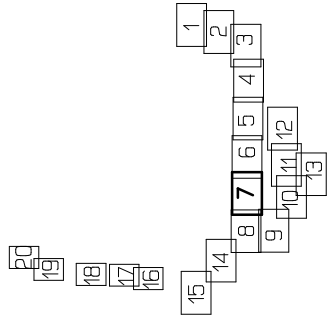

8388

8383

8238

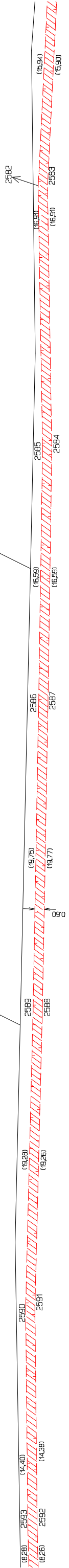

(15,28) 2593 (14,70) 2590 (16,76) 2589 (16,26) 2592

(14,38) 2591

(16,76) 2590 (16,26) 2591

(16,76) 2589 (16,26) 2590

(16,76) 2588 (16,77) 2589

(16,76) 2587 (16,77) 2588

(16,59) 2586 (16,59) 2587

(16,59) 2585 (16,59) 2586

(16,59) 2584 (16,59) 2585

(16,59) 2583 (16,59) 2584

(16,59) 2582 (16,59) 2583

(15,94) 2581 (16,90) 2582

8241

1299/11

1299/12

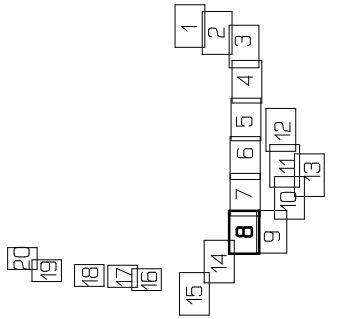

8389

K. Fudytice u Lanškrouna
K. Lanškrouna

2956

2954

2957

3420/1





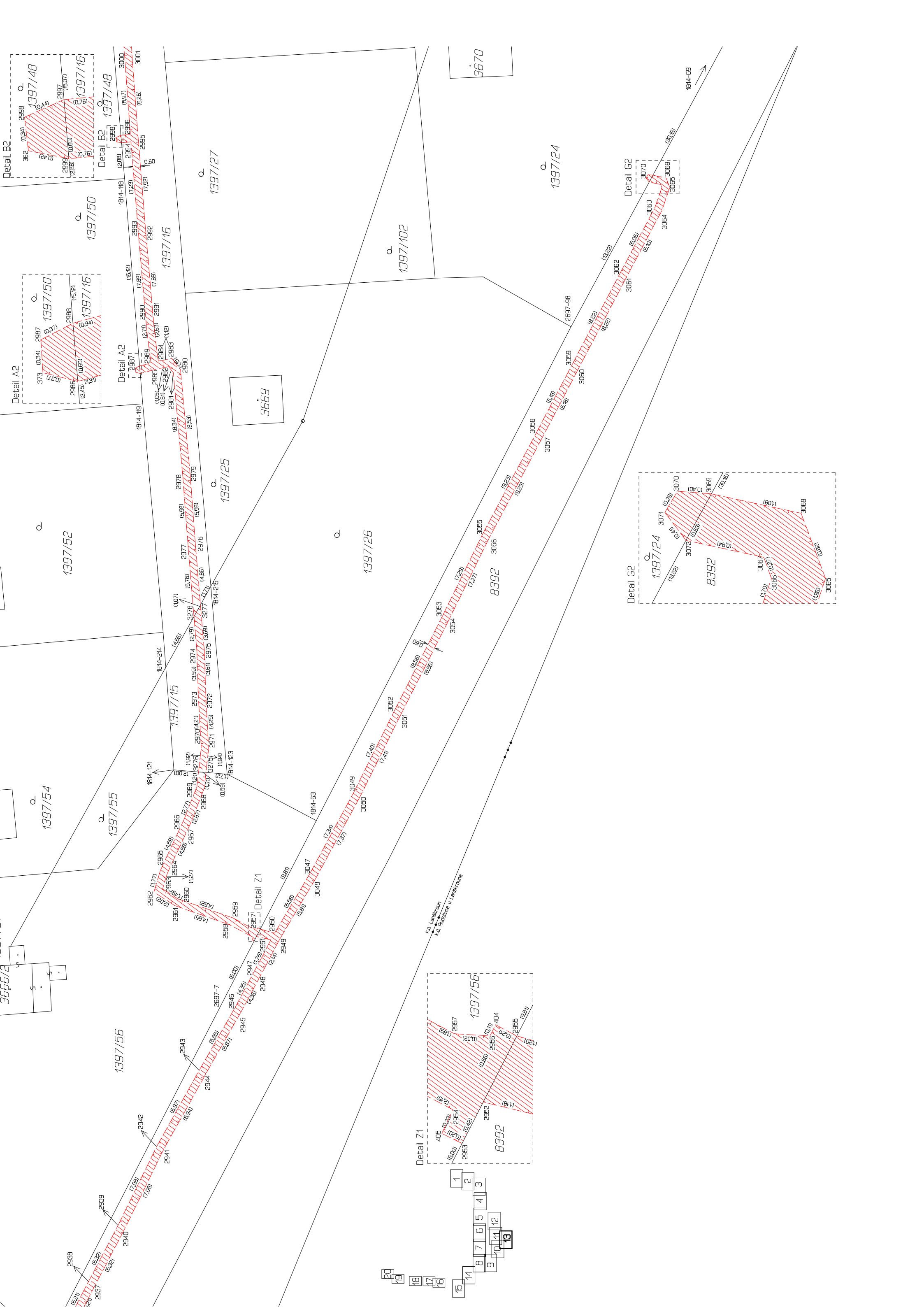

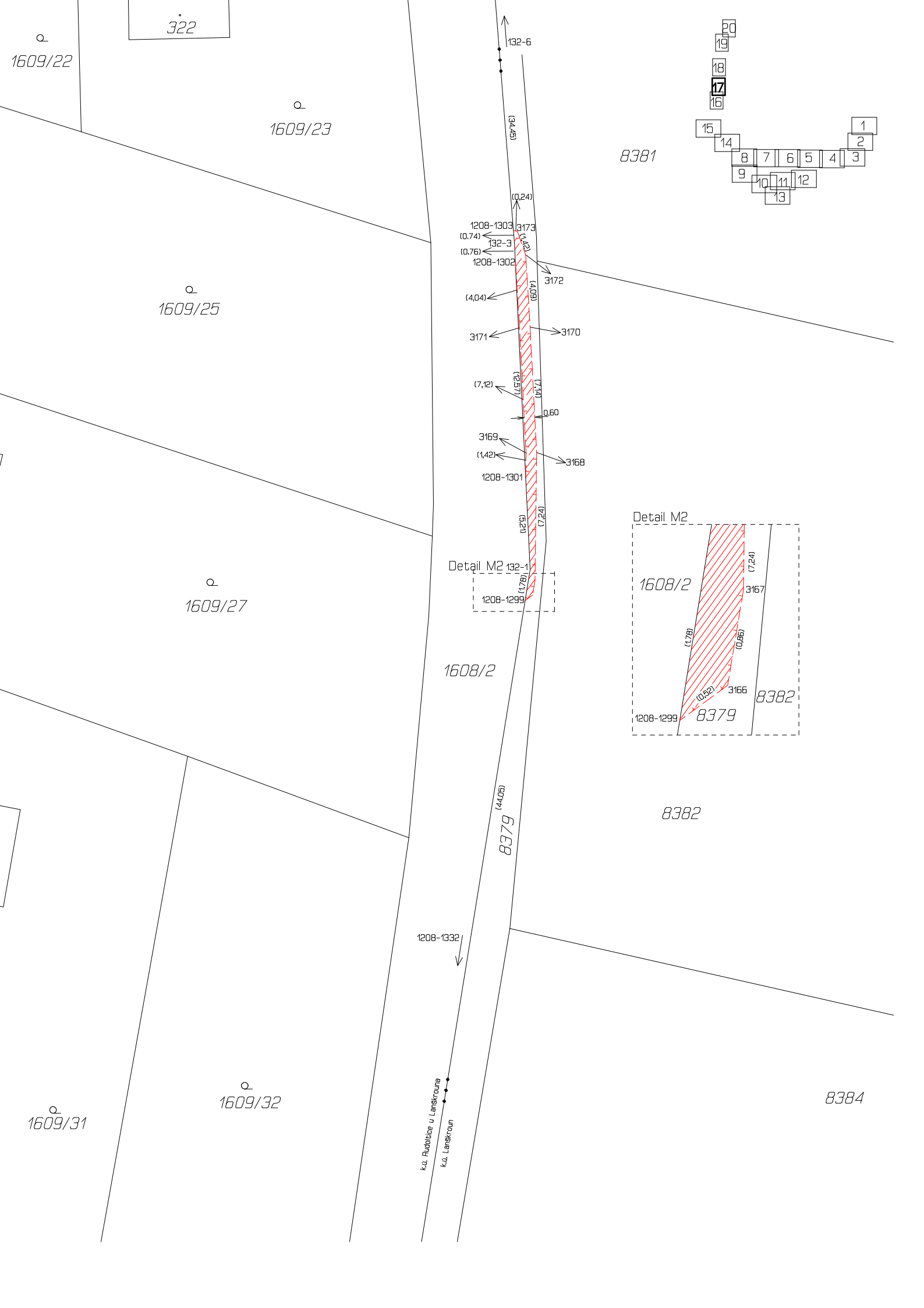

1609/22

322

1609/23

1609/25

1609/27

1609/31

1609/32

k.ú. Rudbice u Lanškrouna
k.ú. Lanškroun

8381

1608/2

8382

8384

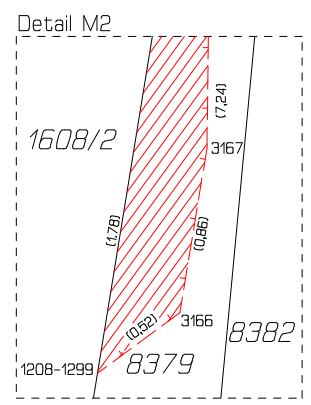
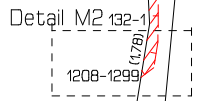
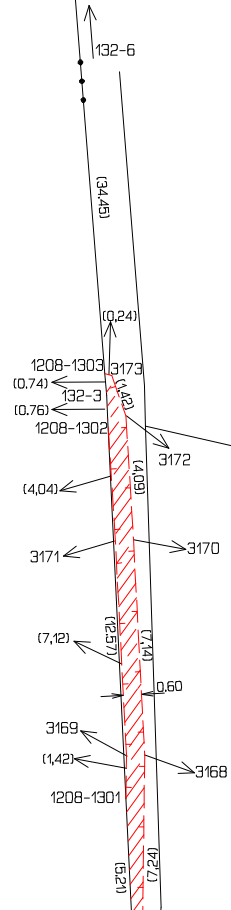
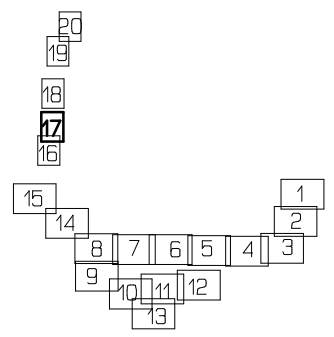

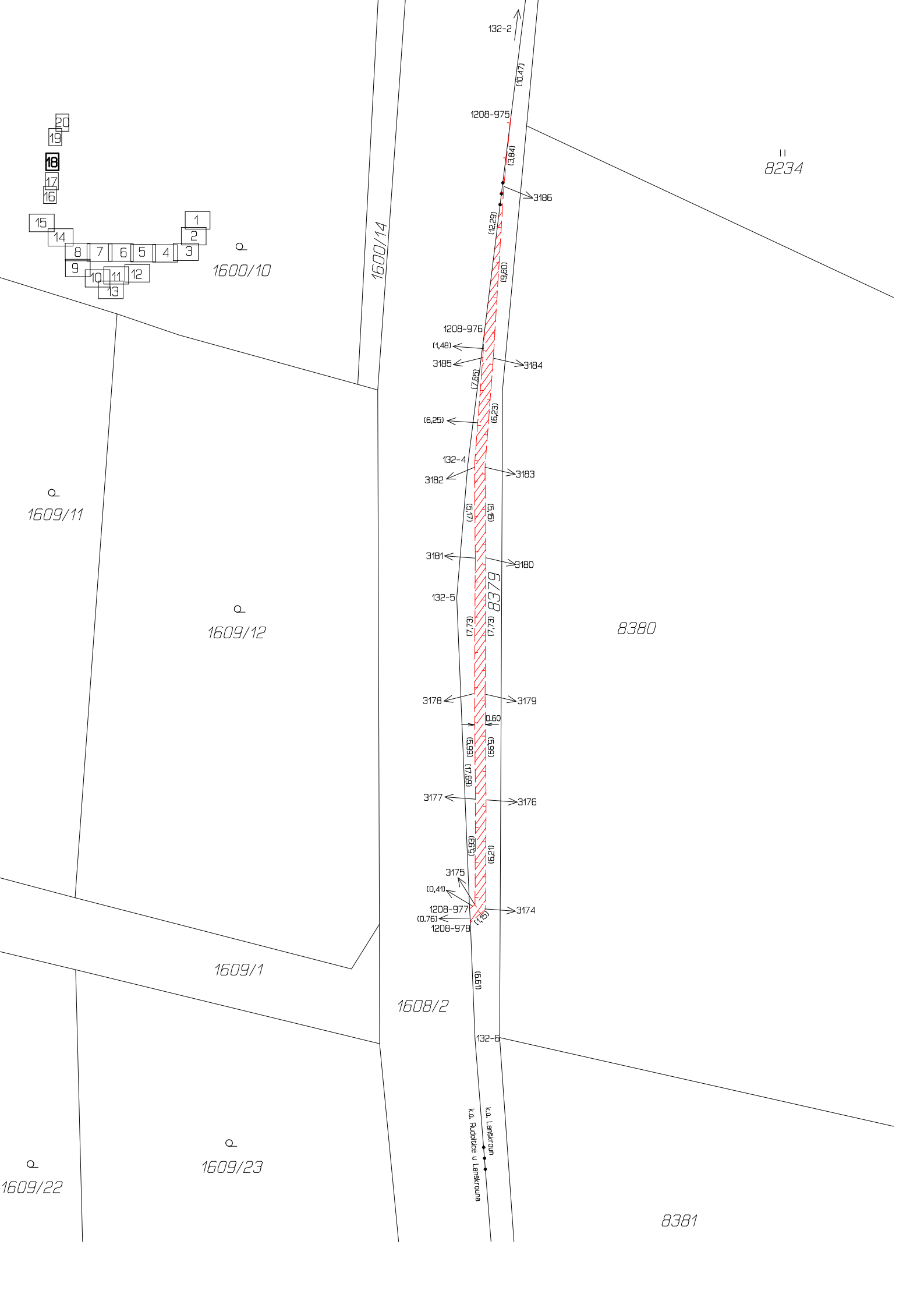

11
8234

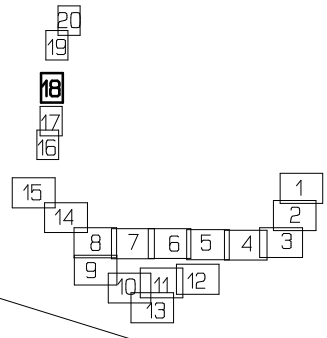

1600/10

1600/14

1609/11

1609/12

8380

1609/1

1608/2

1609/23

1609/22

K.O. Lankrakoune
K.O. Padoouice u Lankrakoune

8381

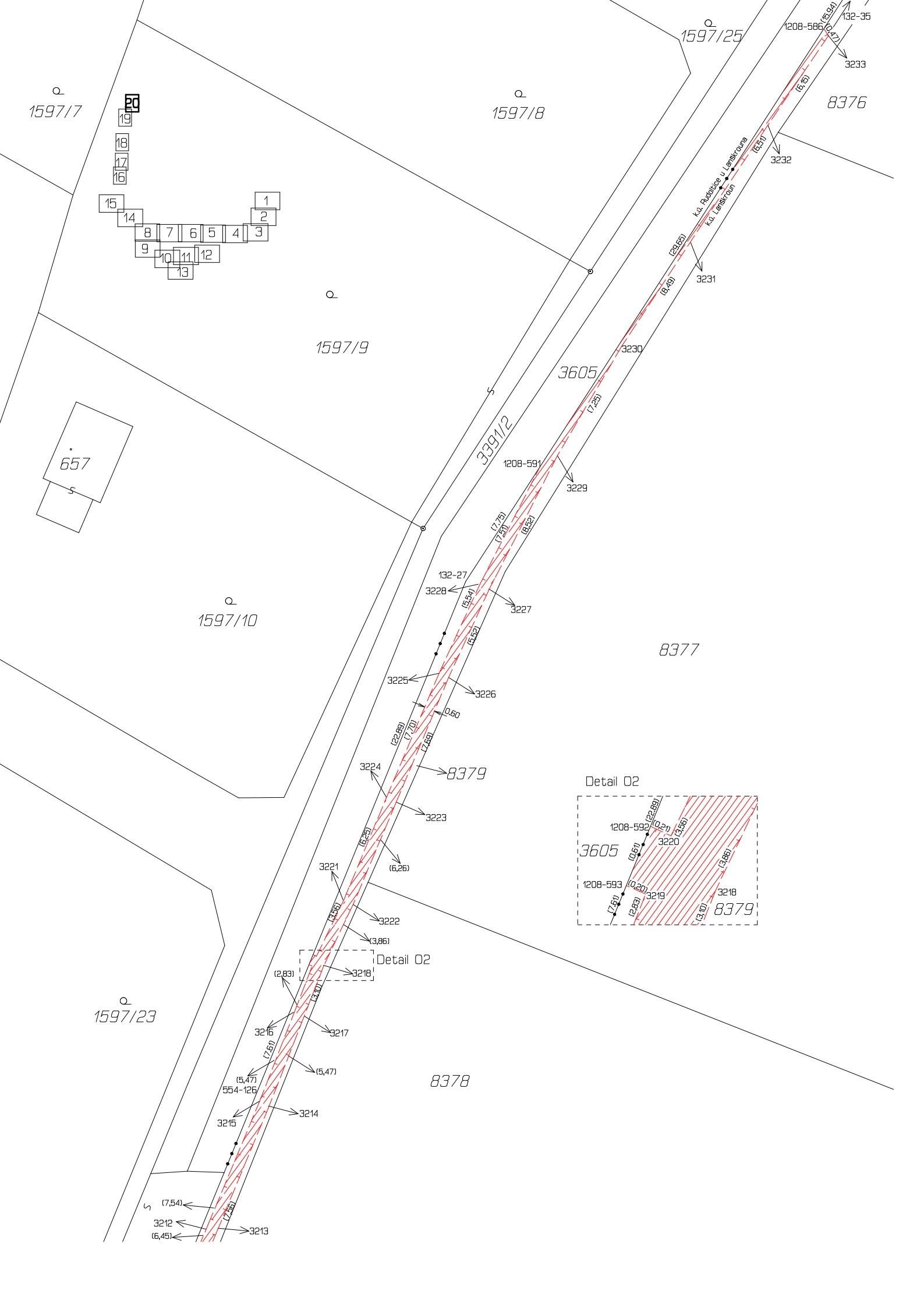

1597/7

1597/8

1597/25

1208-586 (6,47)

8376

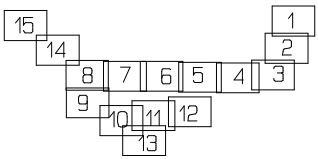

1597/9

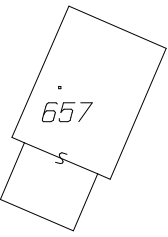

1597/10

8377

Detail O2

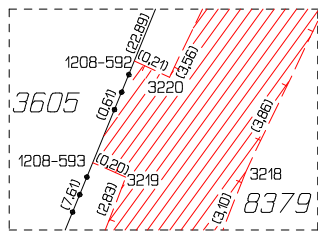

8378

1597/23

(7,54)

3212 (6,45)

3213 (7,26)

3215 (5,47)

554-126 (5,47)

3214 (5,47)

3216 (7,57)

3217 (5,47)

3218 (2,83)

3219 (3,86)

3220 (3,86)

3221 (6,26)

3222 (3,86)

3223 (6,26)

3224 (6,26)

3225 (22,89)

3226 (7,70)

3227 (4,89)

3228 (5,54)

132-27 (7,70)

3229 (8,92)

1208-591 (7,70)

3230 (7,26)

3231 (6,45)

3232 (23,65)

3233 (6,15)

132-35 (6,92)

3234 (16,15)

3235 (16,15)

3236 (16,15)

3237 (16,15)

3238 (16,15)

3239 (16,15)

3240 (16,15)

3241 (16,15)

3242 (16,15)

3243 (16,15)

3244 (16,15)

3245 (16,15)

3246 (16,15)

3247 (16,15)

3248 (16,15)

3249 (16,15)

3250 (16,15)

3251 (16,15)

3252 (16,15)

3253 (16,15)

3254 (16,15)

3255 (16,15)

3256 (16,15)

3257 (16,15)

3258 (16,15)

3259 (16,15)

3260 (16,15)

3261 (16,15)

3262 (16,15)

3263 (16,15)

3264 (16,15)

3265 (16,15)

3266 (16,15)

3267 (16,15)

3268 (16,15)

3269 (16,15)

3270 (16,15)

3271 (16,15)

3272 (16,15)

3273 (16,15)

3274 (16,15)

3275 (16,15)

3276 (16,15)

3277 (16,15)

3278 (16,15)

3279 (16,15)

3280 (16,15)

3281 (16,15)

3282 (16,15)

3283 (16,15)

3284 (16,15)

3285 (16,15)

3286 (16,15)

3287 (16,15)

3288 (16,15)

3289 (16,15)

3290 (16,15)

3291 (16,15)

3292 (16,15)

3293 (16,15)

3294 (16,15)

3295 (16,15)

3296 (16,15)

3297 (16,15)

3298 (16,15)

3299 (16,15)

3300 (16,15)

3301 (16,15)

3302 (16,15)

3303 (16,15)

3304 (16,15)

3305 (16,15)

3306 (16,15)

3307 (16,15)

3308 (16,15)

3309 (16,15)

3310 (16,15)

3311 (16,15)

3312 (16,15)

3313 (16,15)

3314 (16,15)

3315 (16,15)

3316 (16,15)

3317 (16,15)

3318 (16,15)

3319 (16,15)

3320 (16,15)

3321 (16,15)

3322 (16,15)

3323 (16,15)

3324 (16,15)

3325 (16,15)

3326 (16,15)

3327 (16,15)

3328 (16,15)

3329 (16,15)

3330 (16,15)

3331 (16,15)

3332 (16,15)

3333 (16,15)

3334 (16,15)

3335 (16,15)

3336 (16,15)

3337 (16,15)

3338 (16,15)

3339 (16,15)

3340 (16,15)

3341 (16,15)

3342 (16,15)

3343 (16,15)

3344 (16,15)

3345 (16,15)

3346 (16,15)

3347 (16,15)

3348 (16,15)

3349 (16,15)

3350 (16,15)

3351 (16,15)

3352 (16,15)

3353 (16,15)

3354 (16,15)

3355 (16,15)

3356 (16,15)

3357 (16,15)

3358 (16,15)

3359 (16,15)

3360 (16,15)

3361 (16,15)

3362 (16,15)

3363 (16,15)

3364 (16,15)

3365 (16,15)

3366 (16,15)

3367 (16,15)

3368 (16,15)

3369 (16,15)

3370 (16,15)

3371 (16,15)

3372 (16,15)

3373 (16,15)

3374 (16,15)

3375 (16,15)

3376 (16,15)

3377 (16,15)

3378 (16,15)

3379 (16,15)

3380 (16,15)

3381 (16,15)

3382 (16,15)

3383 (16,15)

3384 (16,15)

3385 (16,15)

3386 (16,15)

3387 (16,15)

3388 (16,15)

3389 (16,15)

3390 (16,15)

3391 (16,15)

3392 (16,15)

3393 (16,15)

3394 (16,15)

3395 (16,15)

3396 (16,15)

3397 (16,15)

3398 (16,15)

3399 (16,15)

3400 (16,15)

3401 (16,15)

3402 (16,15)

3403 (16,15)

3404 (16,15)

3405 (16,15)

3406 (16,15)

3407 (16,15)

3408 (16,15)

3409 (16,15)

3410 (16,15)

3411 (16,15)

3412 (16,15)

3413 (16,15)

3414 (16,15)

3415 (16,15)

3416 (16,15)

3417 (16,15)

3418 (16,15)

3419 (16,15)

3420 (16,15)

3421 (16,15)

3422 (16,15)

3423 (16,15)

3424 (16,15)

3425 (16,15)

3426 (16,15)

3427 (16,15)

3428 (16,15)

3429 (16,15)

3430 (16,15)

3431 (16,15)

3432 (16,15)

3433 (16,15)

3434 (16,15)

3435 (16,15)

3436 (16,15)

3437 (16,15)

3438 (16,15)

3439 (16,15)

3440 (16,15)

3441 (16,15)

3442 (16,15)

3443 (16,15)

3444 (16,15)

3445 (16,15)

3446 (16,15)

3447 (16,15)

3448 (16,15)

3449 (16,15)

3450 (16,15)

3451 (16,15)

3452 (16,15)

3453 (16,15)

3454 (16,15)

3455 (16,15)

3456 (16,15)

3457 (16,15)

3458 (16,15)

3459 (16,15)

3460 (16,15)

3461 (16,15)

3462 (16,15)

3463 (16,15)

3464 (16,15)

3465 (16,15)