



Příloha č. 2  
Vybudování WiFi sítě v objektech Jedličkova ústavu a škol  
PROJEKTOVÁ DOKUMENTACE - Heatmaps

*Tato dokumentace a všechny její součásti zůstávají do doby řádného předání díla zhotovitelem a plného zaplacení díla objednatelem výhradním duševním majetkem společnosti ICT-GROUP s.r.o., IČ: 61676802 a nesmí být použita ani rozšiřována bez předchozího písemného souhlasu společnosti.*

Zpracovali: Ing. Roman Krutina  
V Praze dne: 24. 9. 2017

## Obsah:

1. SITUACE – BUDOVY ZAHRNUTÉ DO PROJEKTU „VYBUDOVÁNÍ WIFI SÍTĚ V OBJEKTECH JUS“	4
2. TOPOLKA.....	5
2.1 TOPOLKA – PODLAŽÍ 1. PP .....	5
2.2 TOPOLKA – PODLAŽÍ 1. NP .....	9
2.3 TOPOLKA – PODLAŽÍ 2. NP .....	12
2.4 TOPOLKA – PODLAŽÍ 3. NP .....	15
2.5 TOPOLKA – PODLAŽÍ 4. NP .....	18
3. TAP.....	21
3.1 TAP – PODLAŽÍ 1. NP .....	21
3.2 TAP – PODLAŽÍ 2. NP .....	24
3.3 TAP – PODLAŽÍ 3. NP .....	27
3.4 TAP – PODLAŽÍ 4. NP .....	30
3.5 TAP – PODLAŽÍ 5. NP .....	33
4. NOVÁ BUDOVA .....	36
4.1 NOVÁ BUDOVA – PODLAŽÍ 1. NP .....	36
4.2 NOVÁ BUDOVA – PODLAŽÍ 2. NP .....	39
4.3 NOVÁ BUDOVA – PODLAŽÍ 3. NP .....	41
4.4 NOVÁ BUDOVA – PODLAŽÍ 4. NP .....	43
4.5 NOVÁ BUDOVA – PODLAŽÍ 5. NP .....	45

5. STARÁ BUDOVA – ŘEDITELSTVÍ .....	47
5.1 STARÁ BUDOVA – PODLAŽÍ 2. NP .....	47
5.2 STARÁ BUDOVA – PODLAŽÍ 3. NP .....	51
6. DOMEČEK.....	53
6.1 DOMEČEK – PODLAŽÍ 1. NP .....	53
6.2 DOMEČEK – PODLAŽÍ 2. NP .....	57
6.3 DOMEČEK – PODLAŽÍ 3. NP .....	61
7. ŠKOLA VE ZDI.....	64
7.1 ŠKOLA VE ZDI – PODLAŽÍ 2. NP .....	64
8. REHAPAVILON D.....	68
8.1 REHAPAVILON D – PODLAŽÍ 2. NP .....	68
8.2 REHAPAVILON D – PODLAŽÍ 3. NP .....	71
9. REHAPAVILON C.....	73
9.1 REHAPAVILON C – PODLAŽÍ 2. NP.....	73
9.2 REHAPAVILON C – PODLAŽÍ 3. NP.....	75

## 1. Situace – budovy zahrnuté do projektu „Vybudování WiFi sítě v objektech JUS“



## 2. Topolka

### 2.1 Topolka – podlaží 1. PP

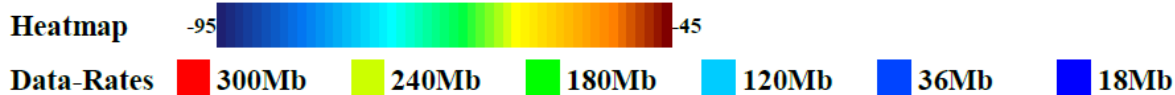

**Campus: JUS**

Data Rate: 36.0 Mbps  
Client Xmit: 30mW

**Building: TOP**

Address: Na Topolce 1350/1, Praha 4 - Nusle  
Data Rate: 36.0 Mbps  
Client Xmit: 30mW  
Geo Code: Long: 14.42 Lat: 50.06

**Floor 0.0: 1.PP**

Environment: Offices  
Data Rate: 36.0 Mbps  
Client Xmit: 30mW  
Floor Height: 3,60 Meters  
Image Area: 1 490 Sq Meters  
Total Controllers: 0  
Total IDFs: 0  
Total Racks: 1  
Total Switches: 0  
Total Ports: 0  
Total POE Ports: 0  
Total APs: 2  
Total AMs: 0



**Data Rate View**









**Data Rate View**

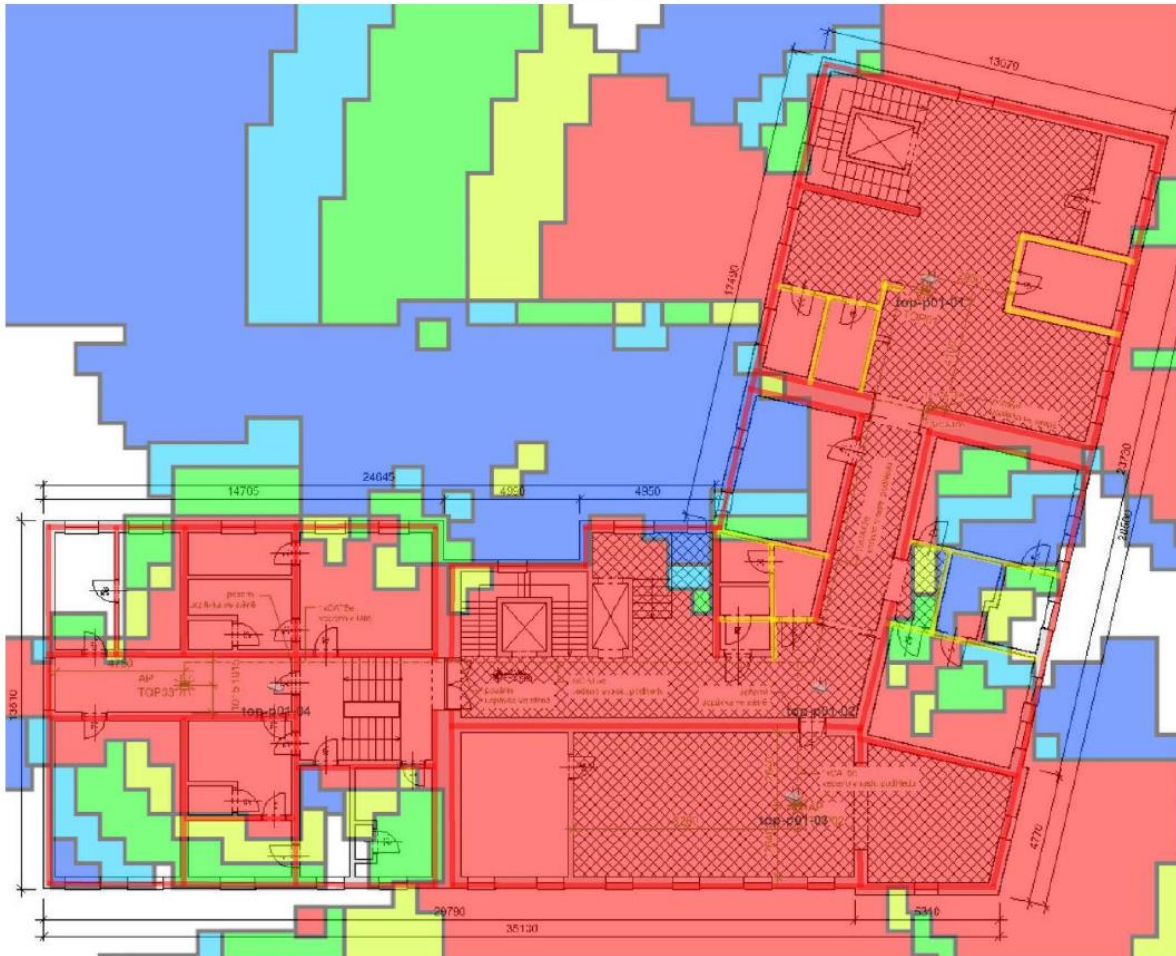

**Heat Map View**

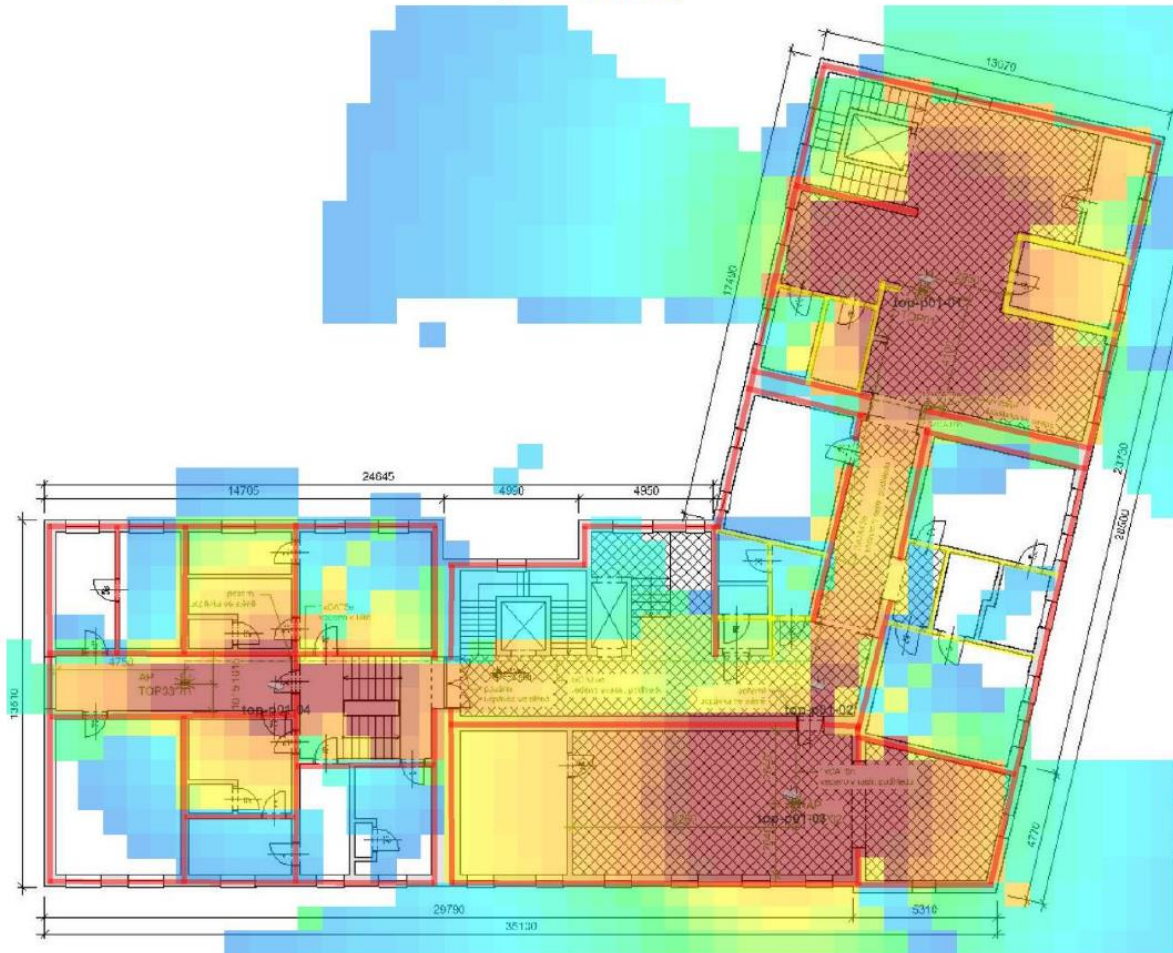

## 2.3 Topolka – podlaží 2. NP

### Floor 2.0: 2.NP

Environment:	Offices
Data Rate:	36.0 Mbps
Client Xmit:	30mW
Floor Height:	3,60 Meters
Image Area:	1 617 Sq Meters
Total Controllers:	0
Total IDF's:	0
Total Racks:	0
Total Switches:	0
Total Ports:	0
Total POE Ports:	0
Total APs:	4
Total AMs:	0

Floor Plan Only View

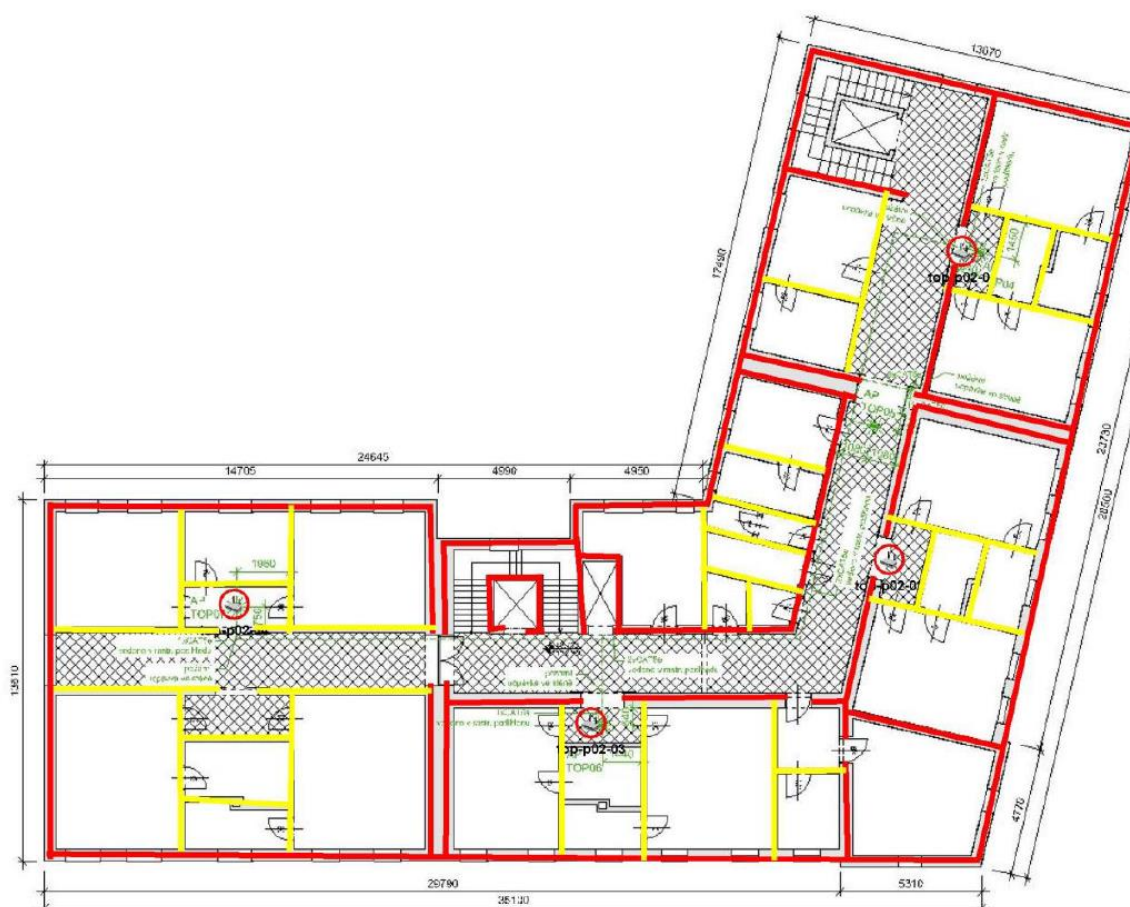



**Heat Map View**

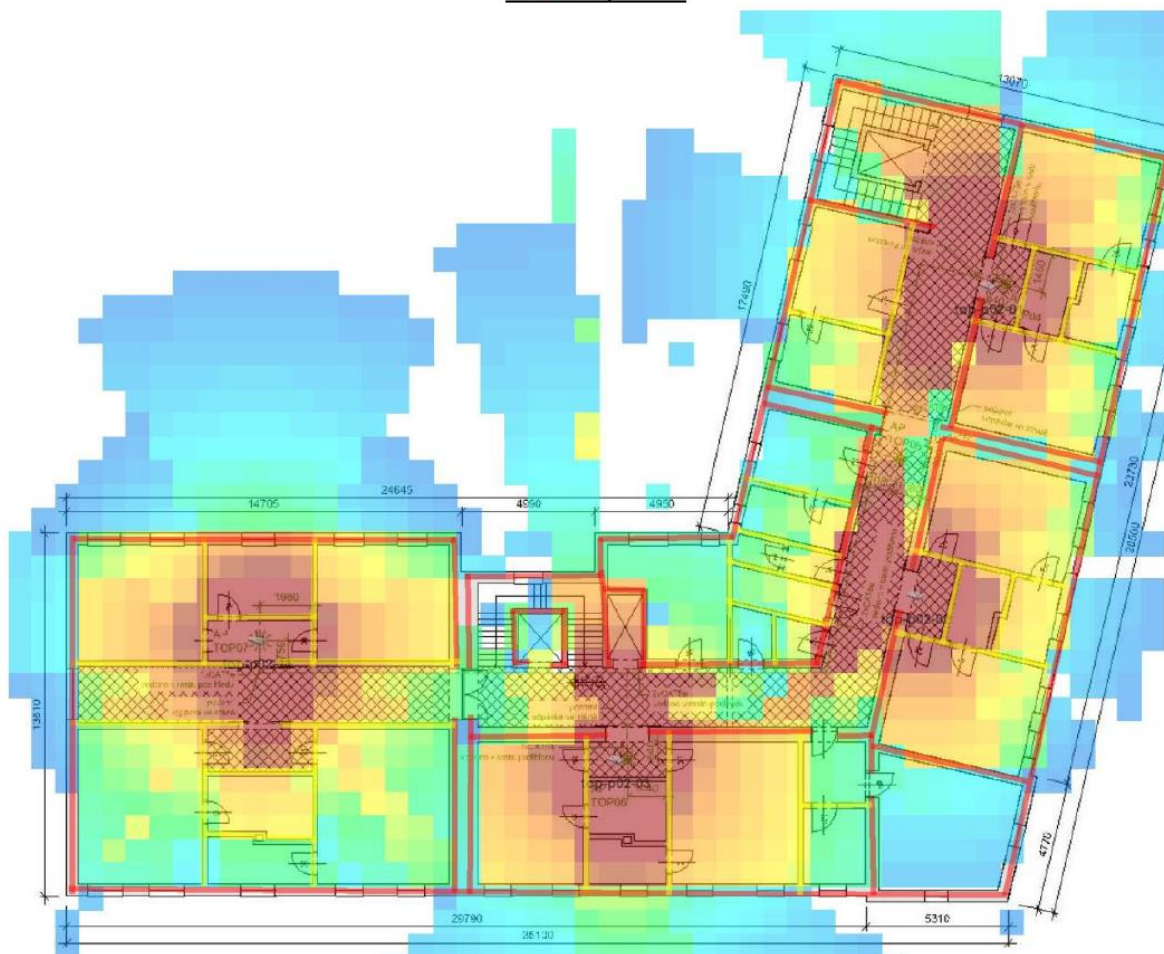

## 2.4 Topolka – podlaží 3. NP

### Floor 3.0: 3.NP

Environment:	Offices
Data Rate:	36.0 Mbps
Client Xmit:	30mW
Floor Height:	3,60 Meters
Image Area:	1 559 Sq Meters
Total Controllers:	0
Total IDFs:	0
Total Racks:	0
Total Switches:	0
Total Ports:	0
Total POE Ports:	0
Total APs:	4
Total AMs:	0

Floor Plan Only View

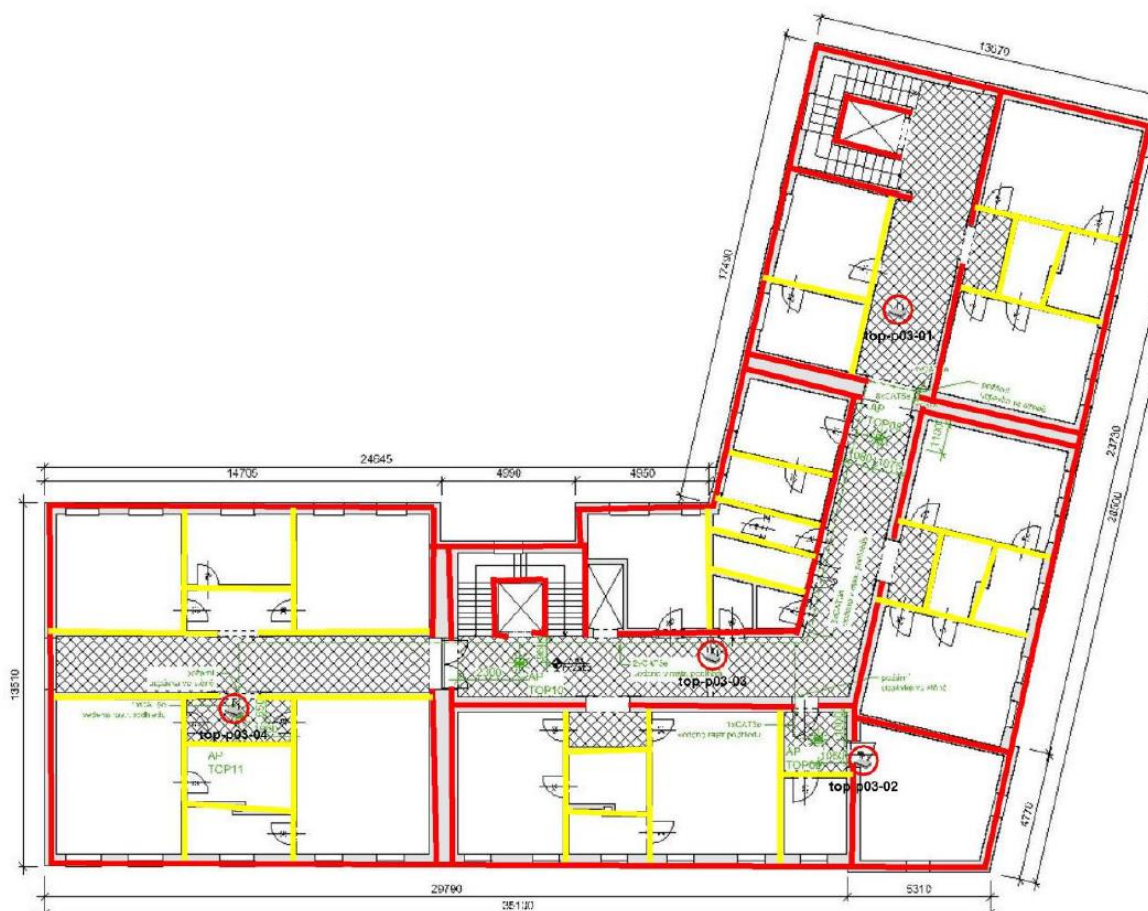

**Data Rate View**

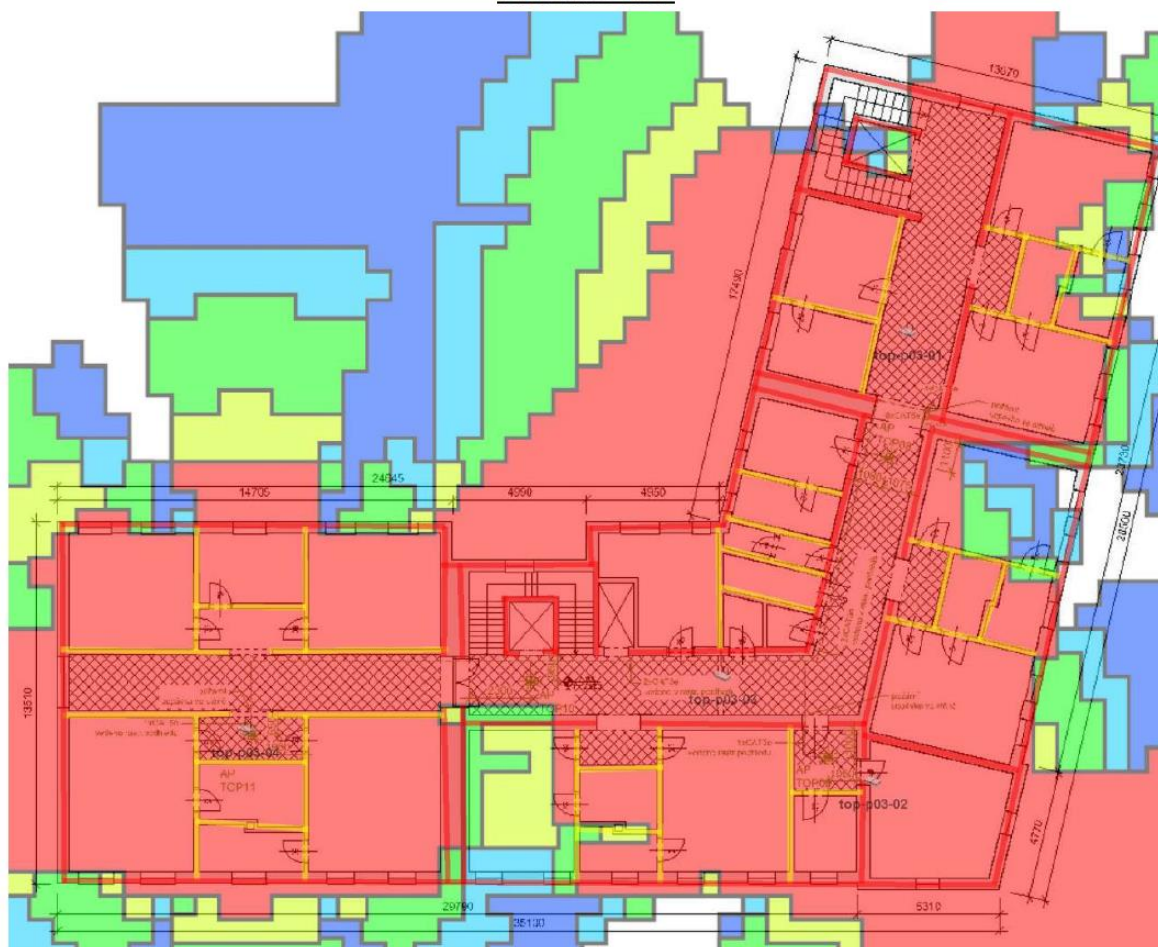



**Heat Map View**

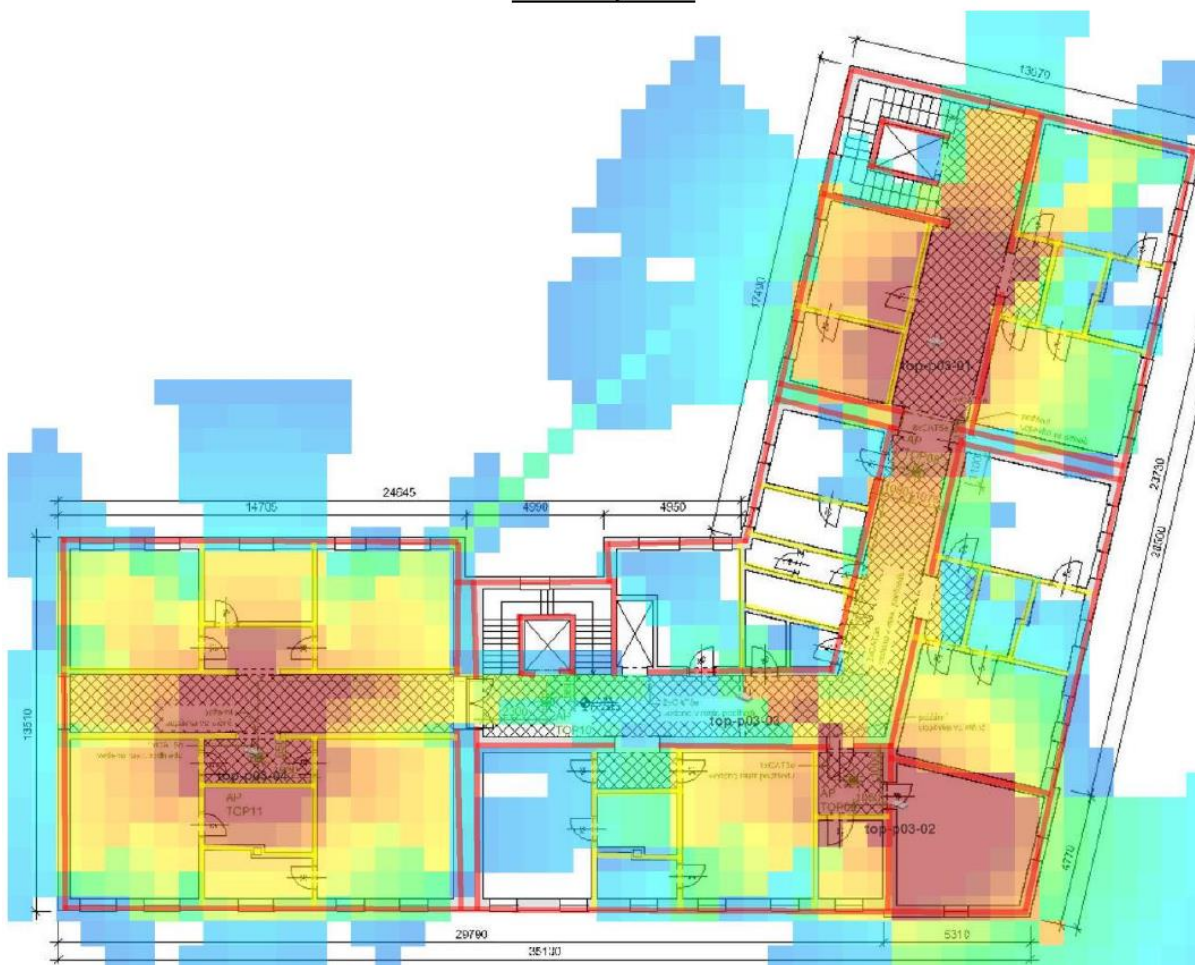

## 2.5 Topolka – podlaží 4. NP

### Floor 4.0: 4.NP

Environment:	Offices
Data Rate:	36.0 Mbps
Client Xmit:	30mW
Floor Height:	3,60 Meters
Image Area:	1 493 Sq Meters
Total Controllers:	0
Total IDFs:	0
Total Racks:	0
Total Switches:	0
Total Ports:	0
Total POE Ports:	0
Total APs:	4
Total AMs:	0

**Floor Plan Only View**

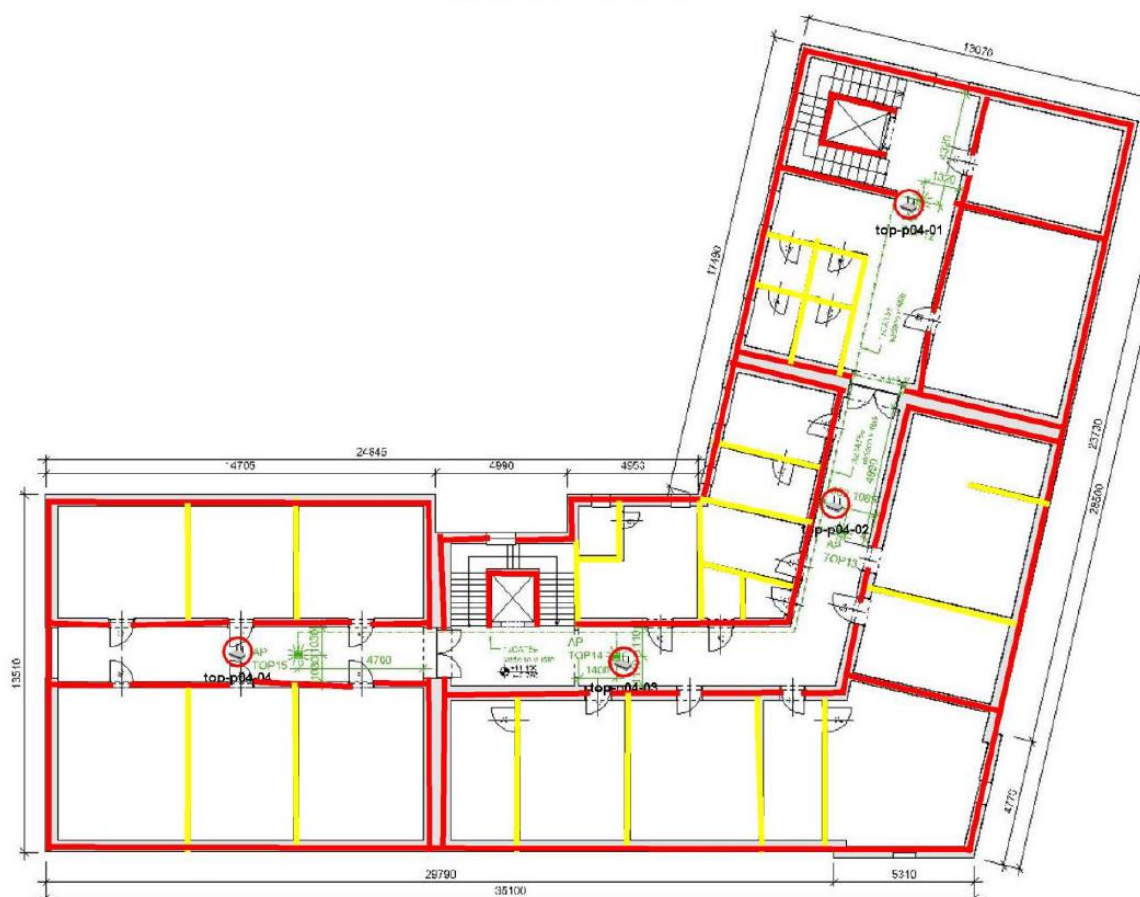



**Heat Map View**

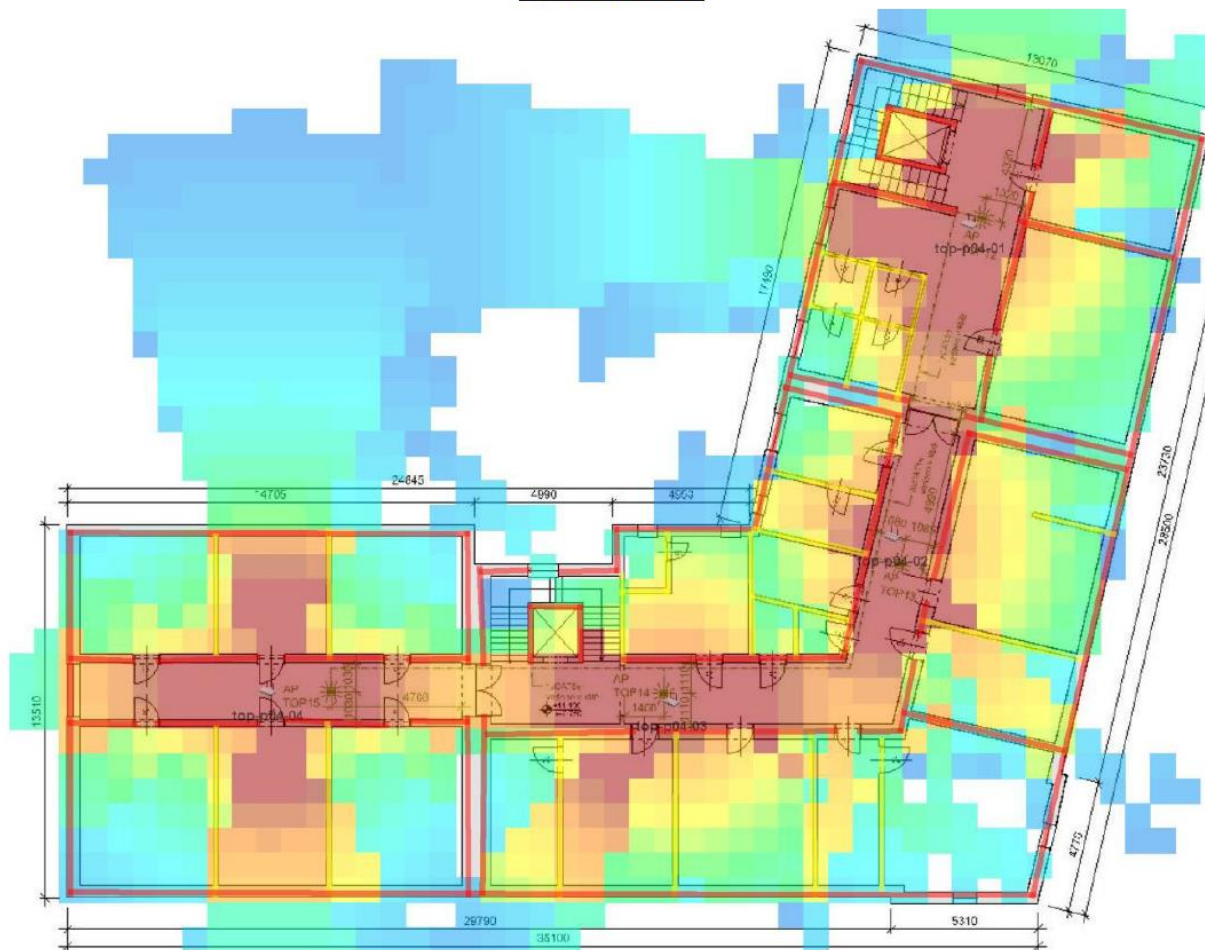

### 3. TAP

#### 3.1 TAP – podlaží 1. NP

**Floor 1.0: 1.NP**

Environment:	Offices
Data Rate:	36.0 Mbps
Client Xmit:	30mW
Floor Height:	10,00 Meters
Image Area:	420 Sq Meters
Total Controllers:	0
Total IDFs:	0
Total Racks:	0
Total Switches:	0
Total Ports:	0
Total POE Ports:	0
Total APs:	1
Total AMs:	0

**Floor Plan Only View**

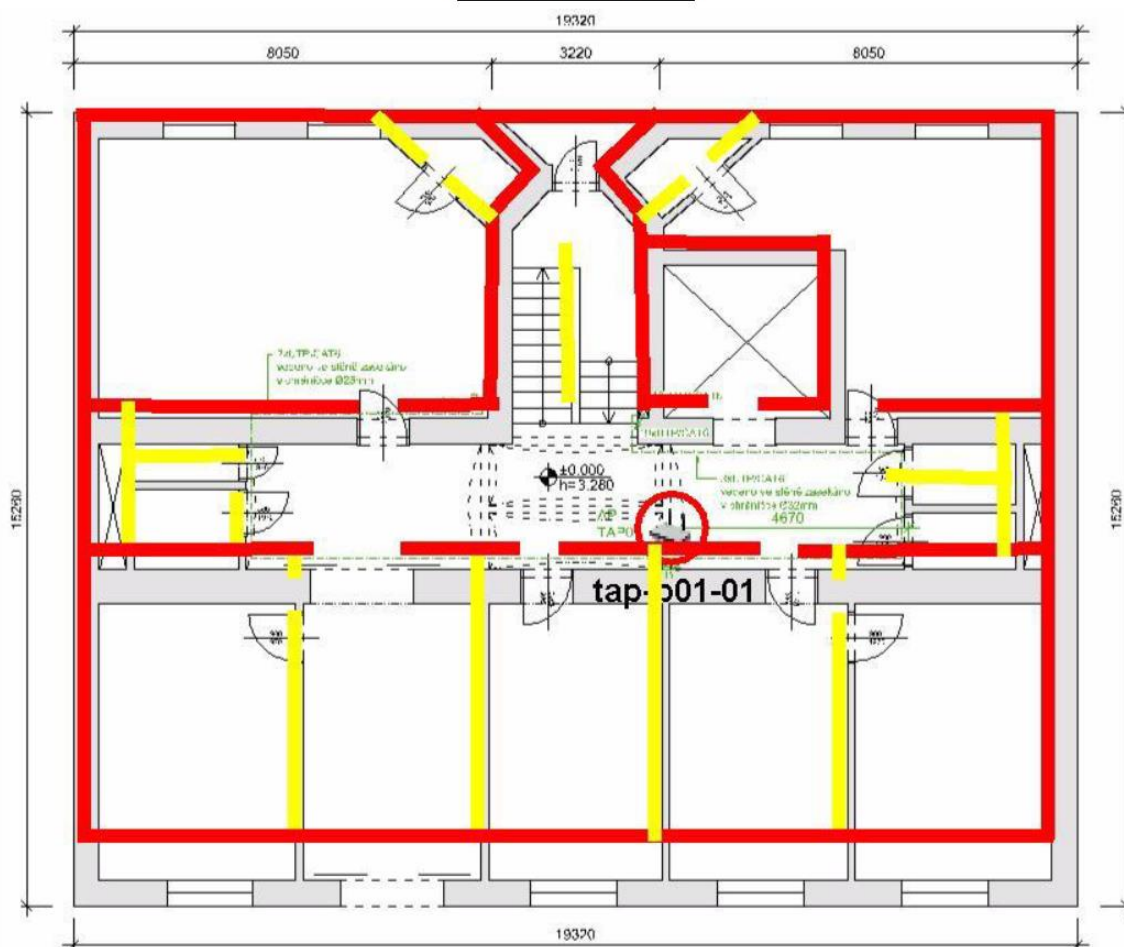

**Data Rate View**

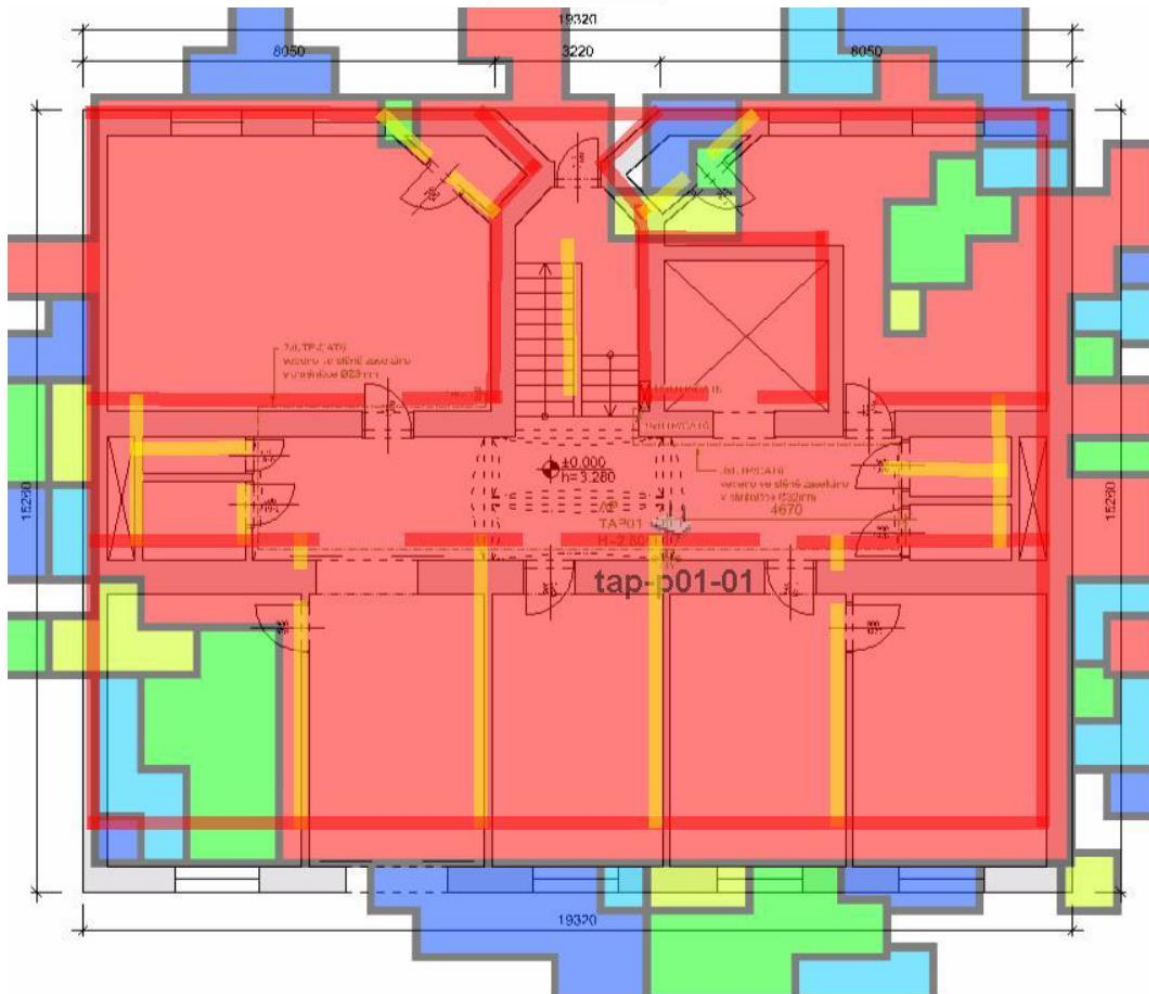

**Heat Map View**

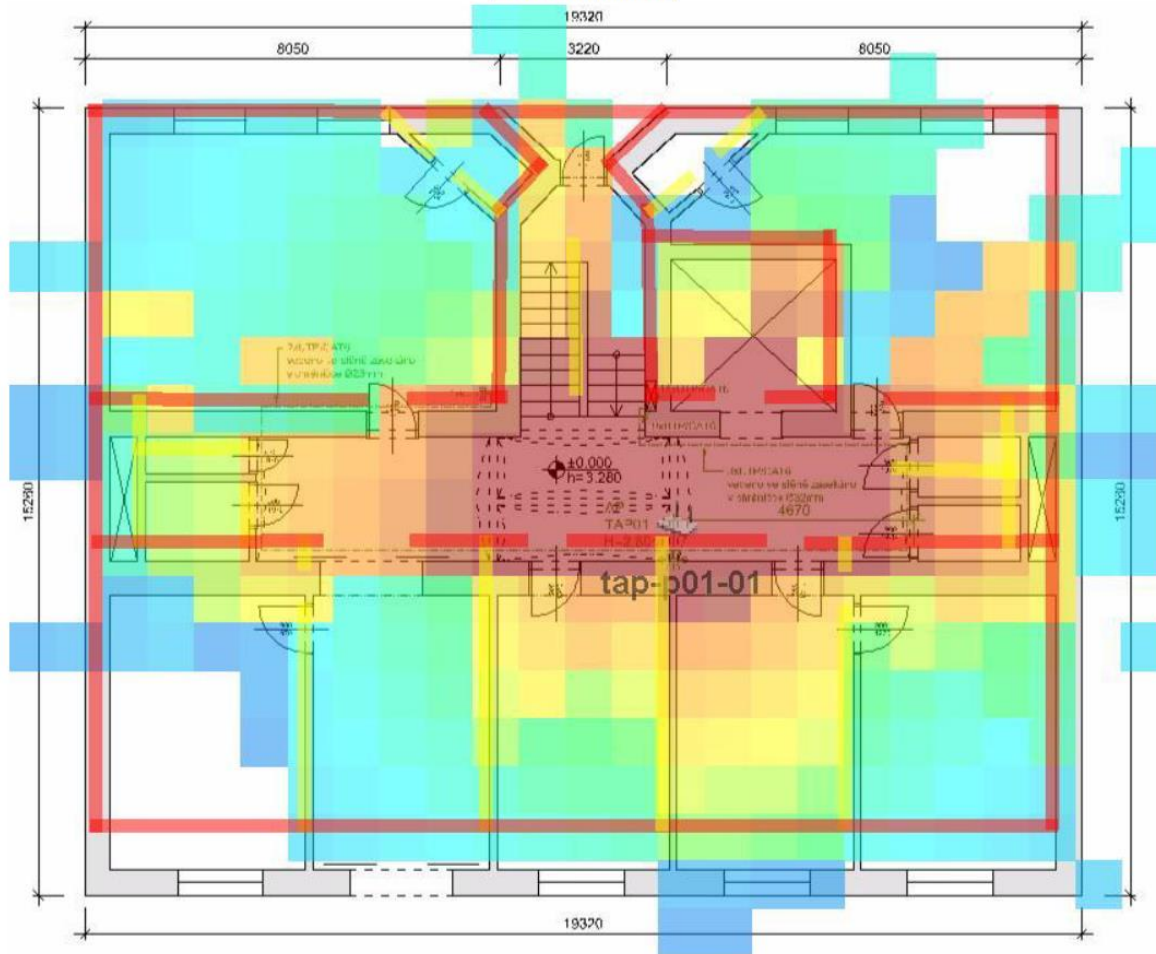

## 3.2 TAP – podlaží 2. NP

### Floor 2.0: 2.NP

Environment:	Offices
Data Rate:	36.0 Mbps
Client Xmit:	30mW
Floor Height:	10,00 Meters
Image Area:	407 Sq Meters
Total Controllers:	0
Total IDFs:	0
Total Racks:	0
Total Switches:	0
Total Ports:	0
Total POE Ports:	0
Total APs:	2
Total AMs:	0

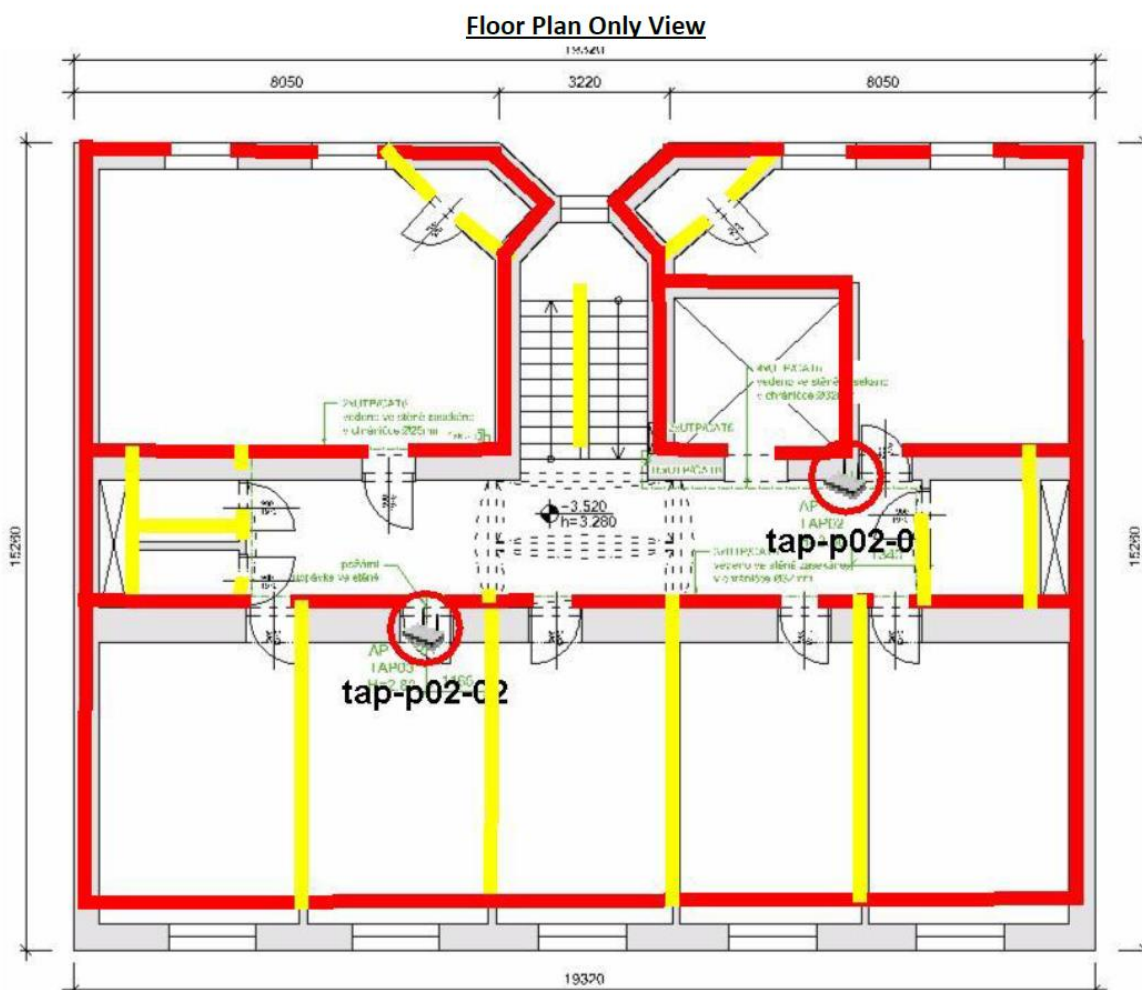



**Data Rate View**

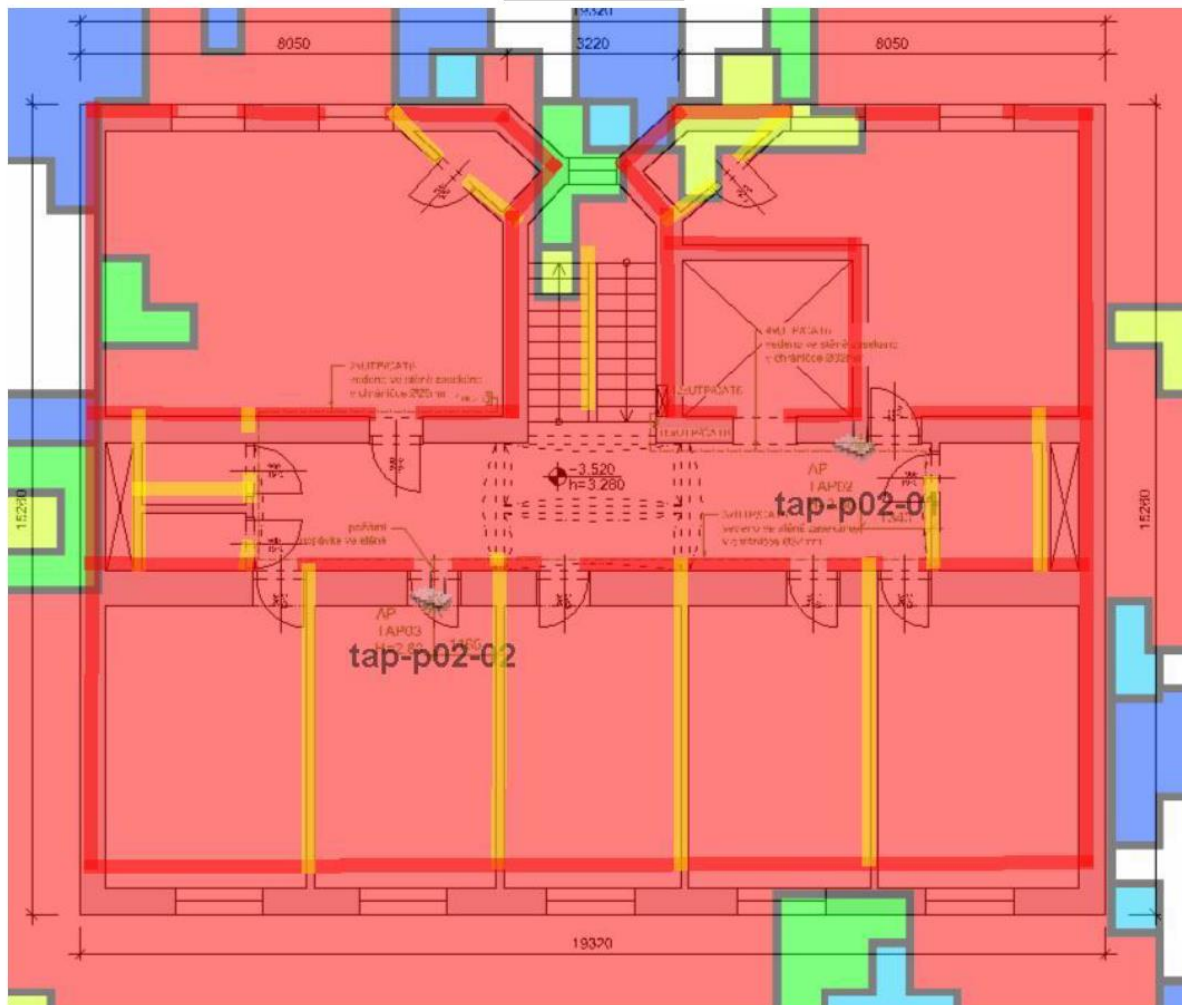



### 3.3 TAP – podlaží 3. NP

**Floor 3.0: 3.NP**

Environment:	Offices
Data Rate:	36.0 Mbps
Client Xmit:	30mW
Floor Height:	10,00 Meters
Image Area:	404 Sq Meters
Total Controllers:	0
Total IDFs:	0
Total Racks:	0
Total Switches:	0
Total Ports:	0
Total POE Ports:	0
Total APs:	2
Total AMs:	0

**Floor Plan Only View**

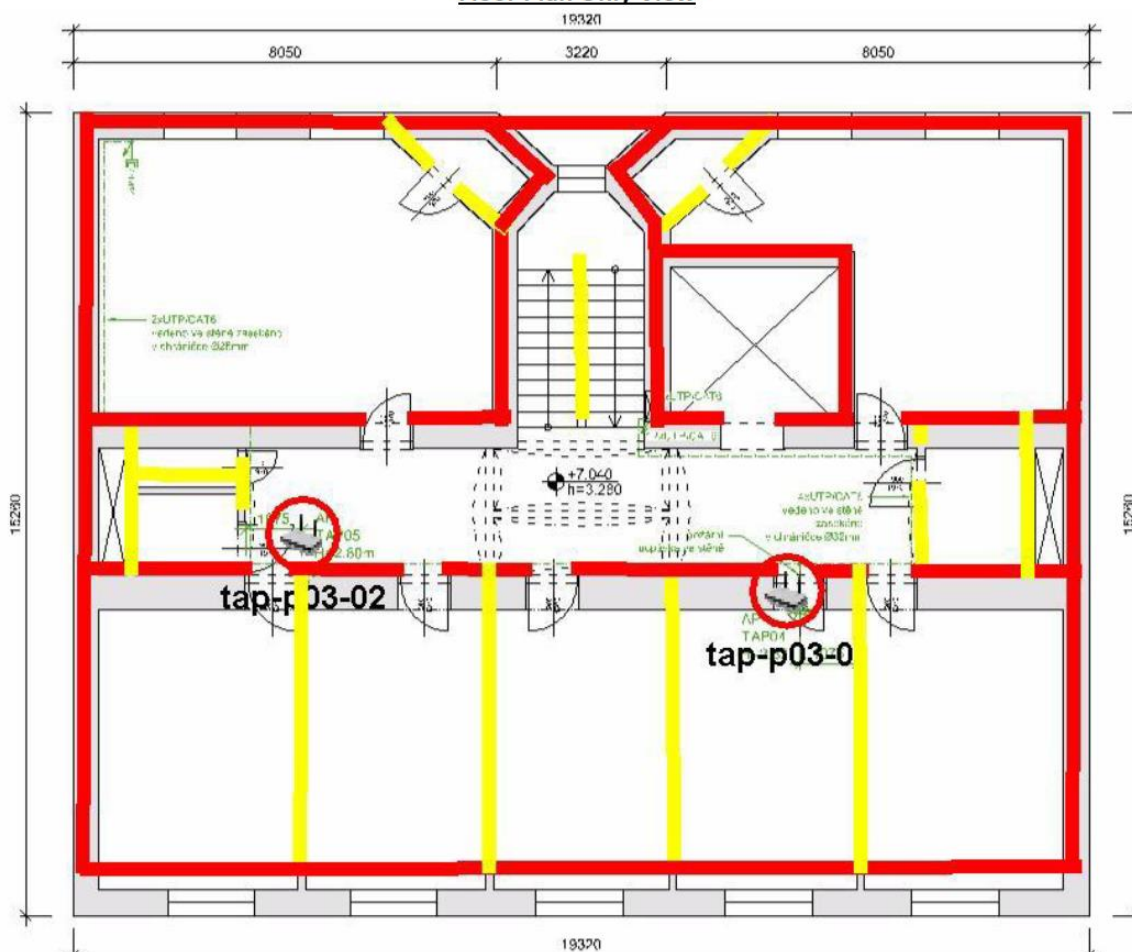

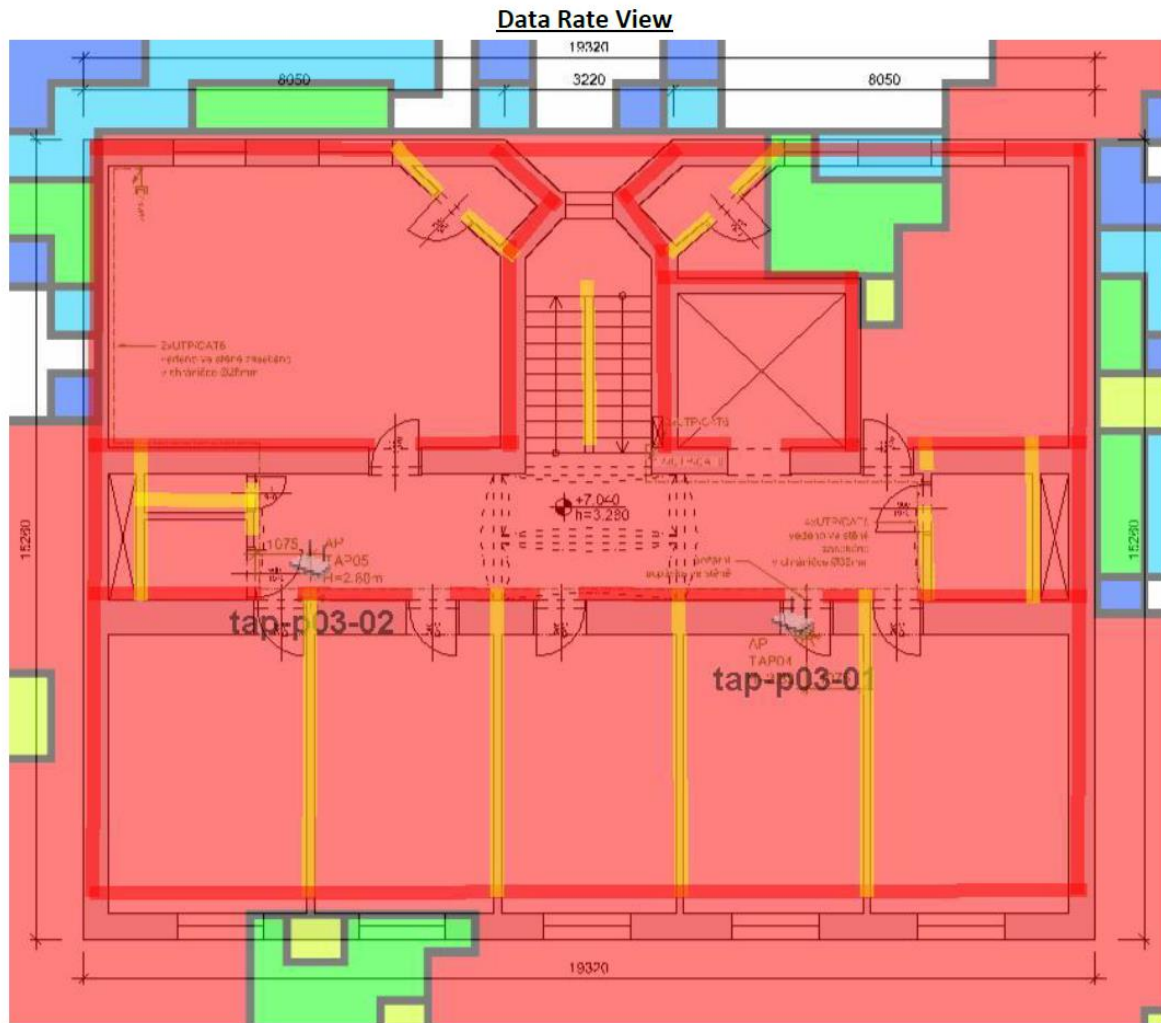

**Heat Map View**

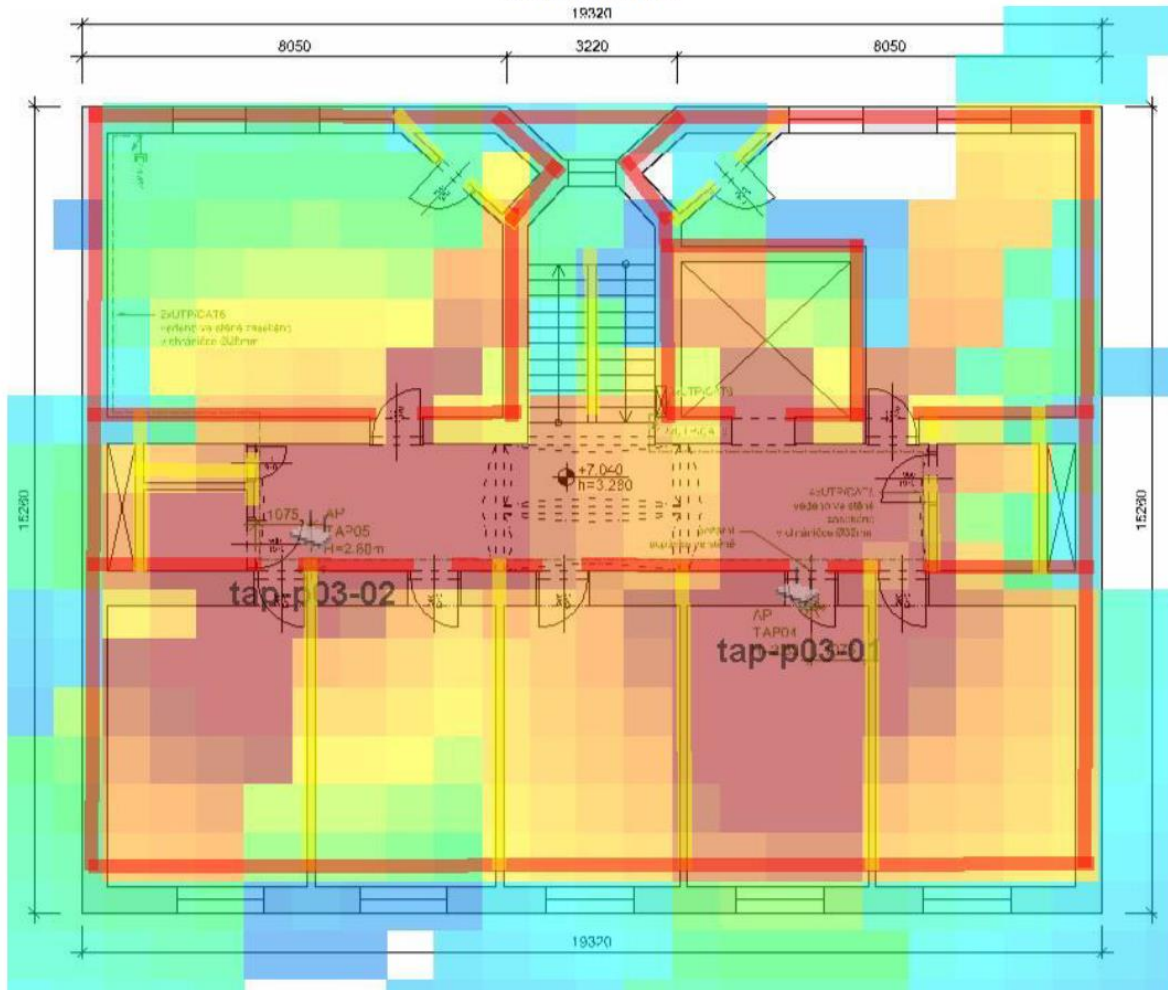

### 3.4 TAP – podlaží 4. NP

**Floor 4.0: 4.NP**

Environment:	Offices
Data Rate:	36.0 Mbps
Client Xmit:	30mW
Floor Height:	10,00 Meters
Image Area:	400 Sq Meters
Total Controllers:	0
Total IDFs:	0
Total Racks:	0
Total Switches:	0
Total Ports:	0
Total POE Ports:	0
Total APs:	2
Total AMs:	0

**Floor Plan Only View**

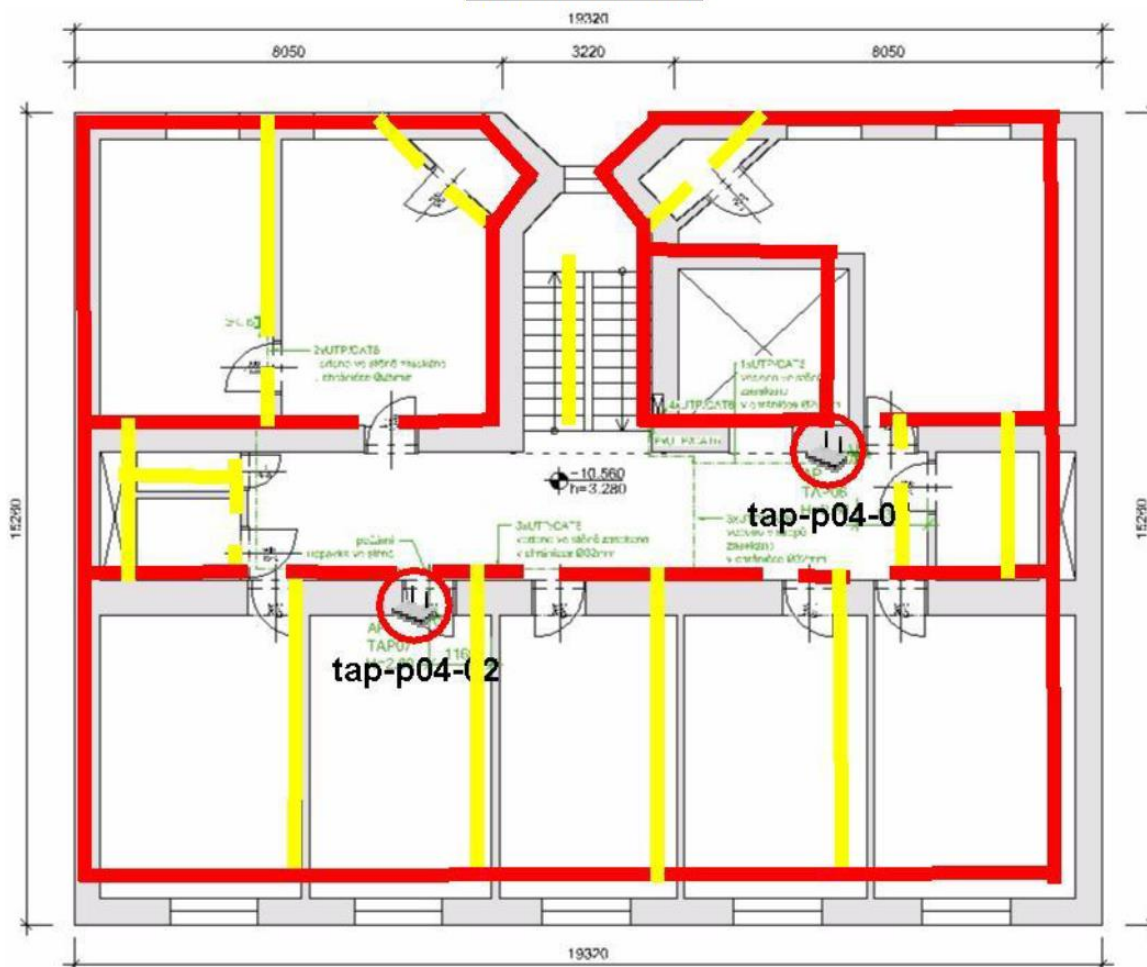



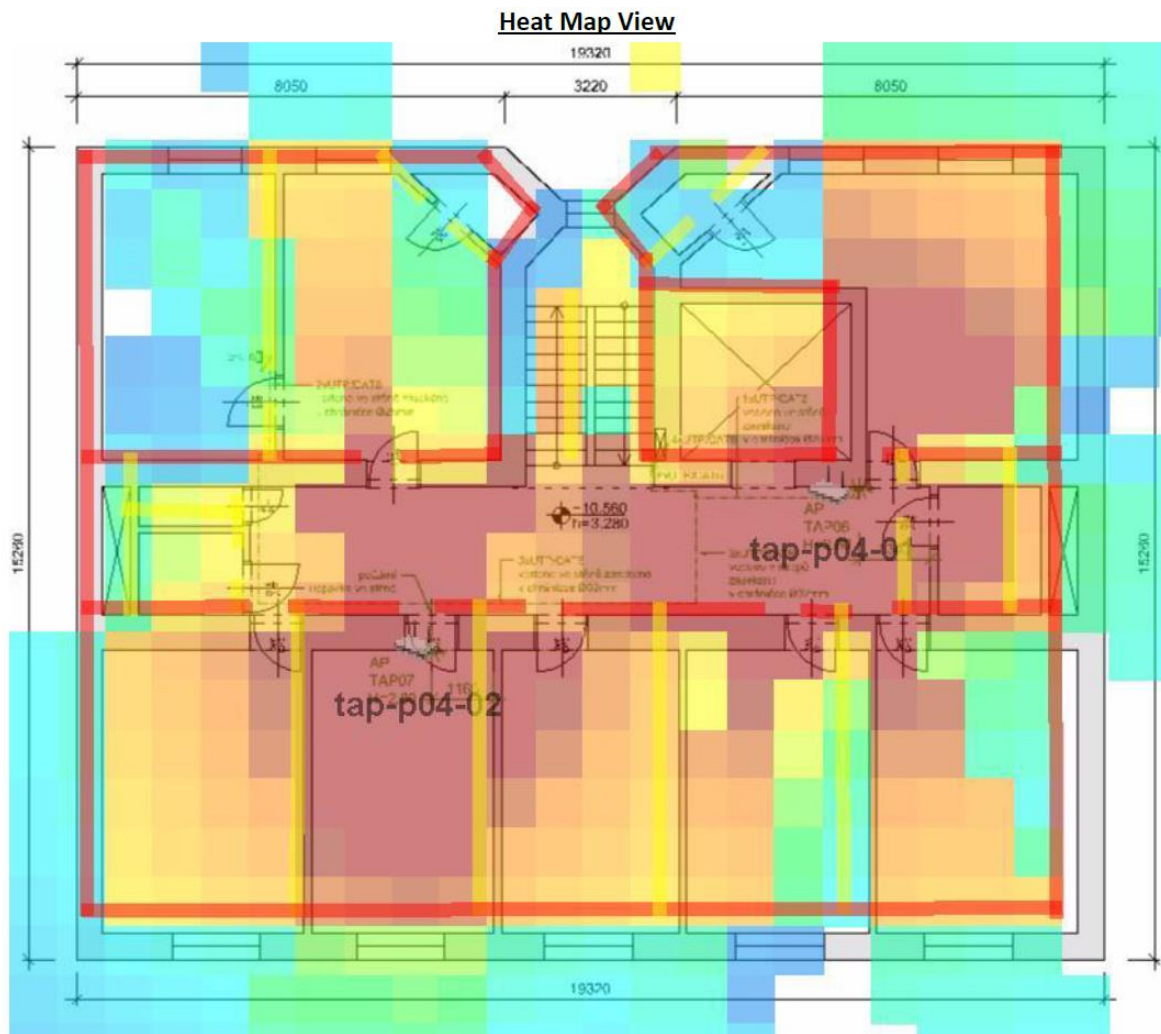



### 3.5 TAP – podlaží 5. NP

**Floor 5.0: 5.NP**

Environment:	Offices
Data Rate:	36.0 Mbps
Client Xmit:	30mW
Floor Height:	10,00 Meters
Image Area:	414 Sq Meters
Total Controllers:	0
Total IDF's:	0
Total Racks:	0
Total Switches:	0
Total Ports:	0
Total POE Ports:	0
Total APs:	2
Total AMs:	0

**Floor Plan Only View**

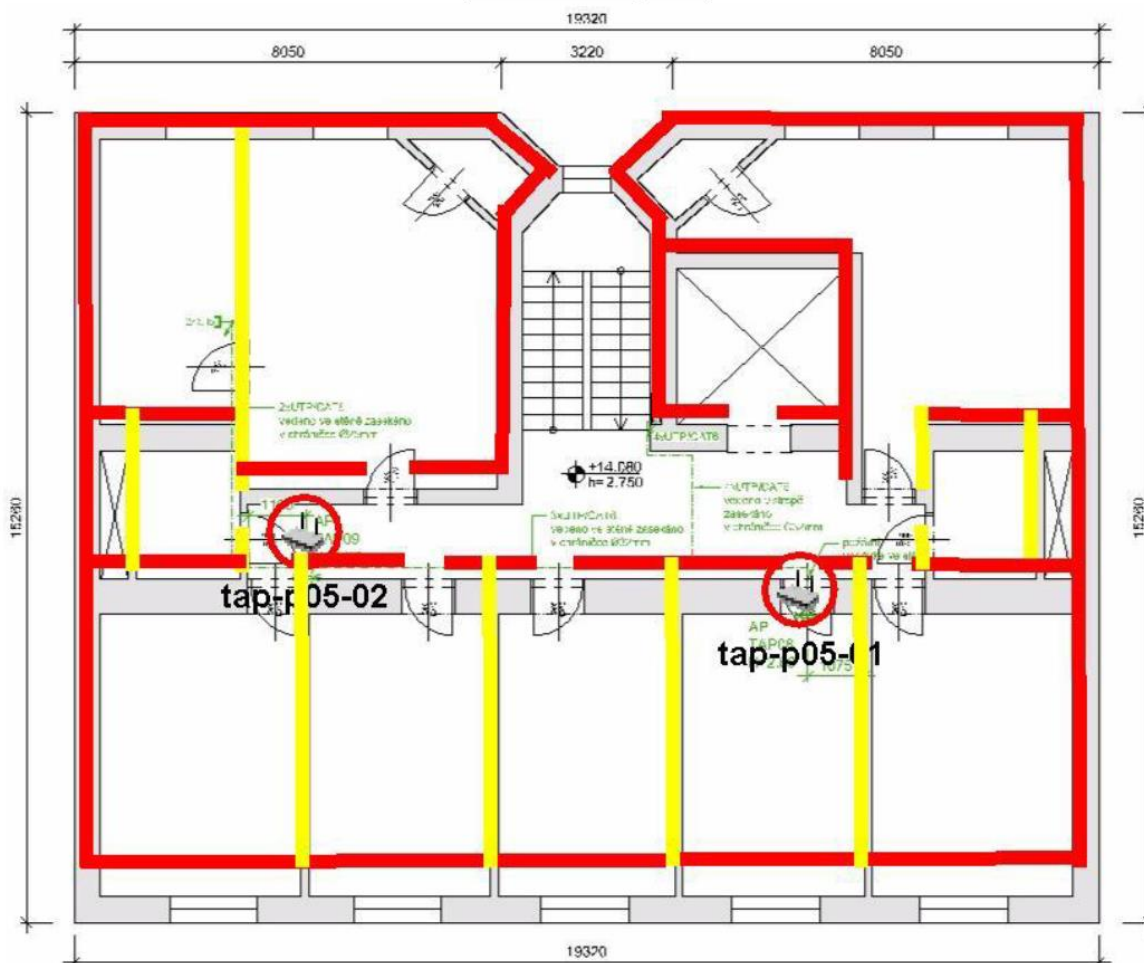

**Data Rate View**

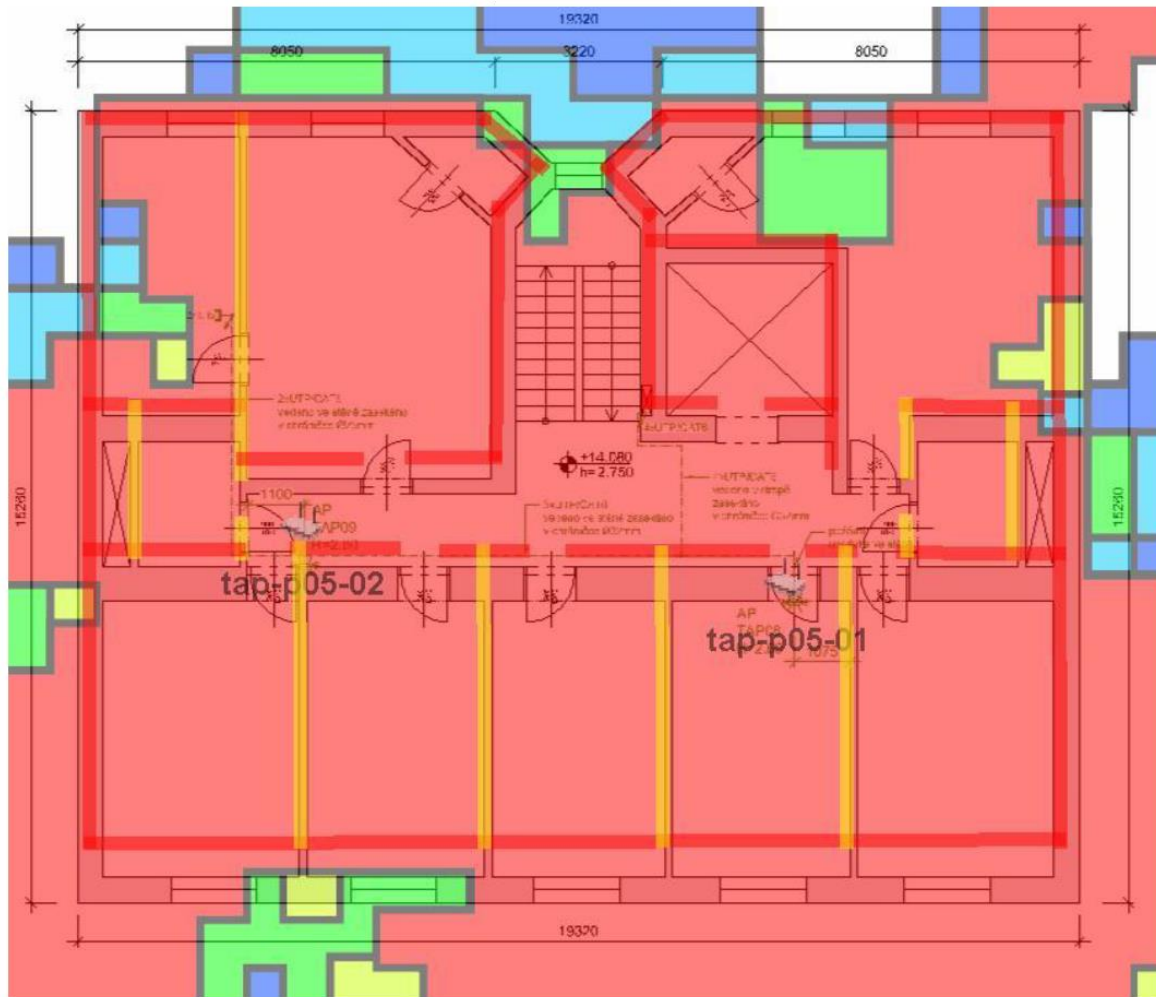

**Heat Map View**

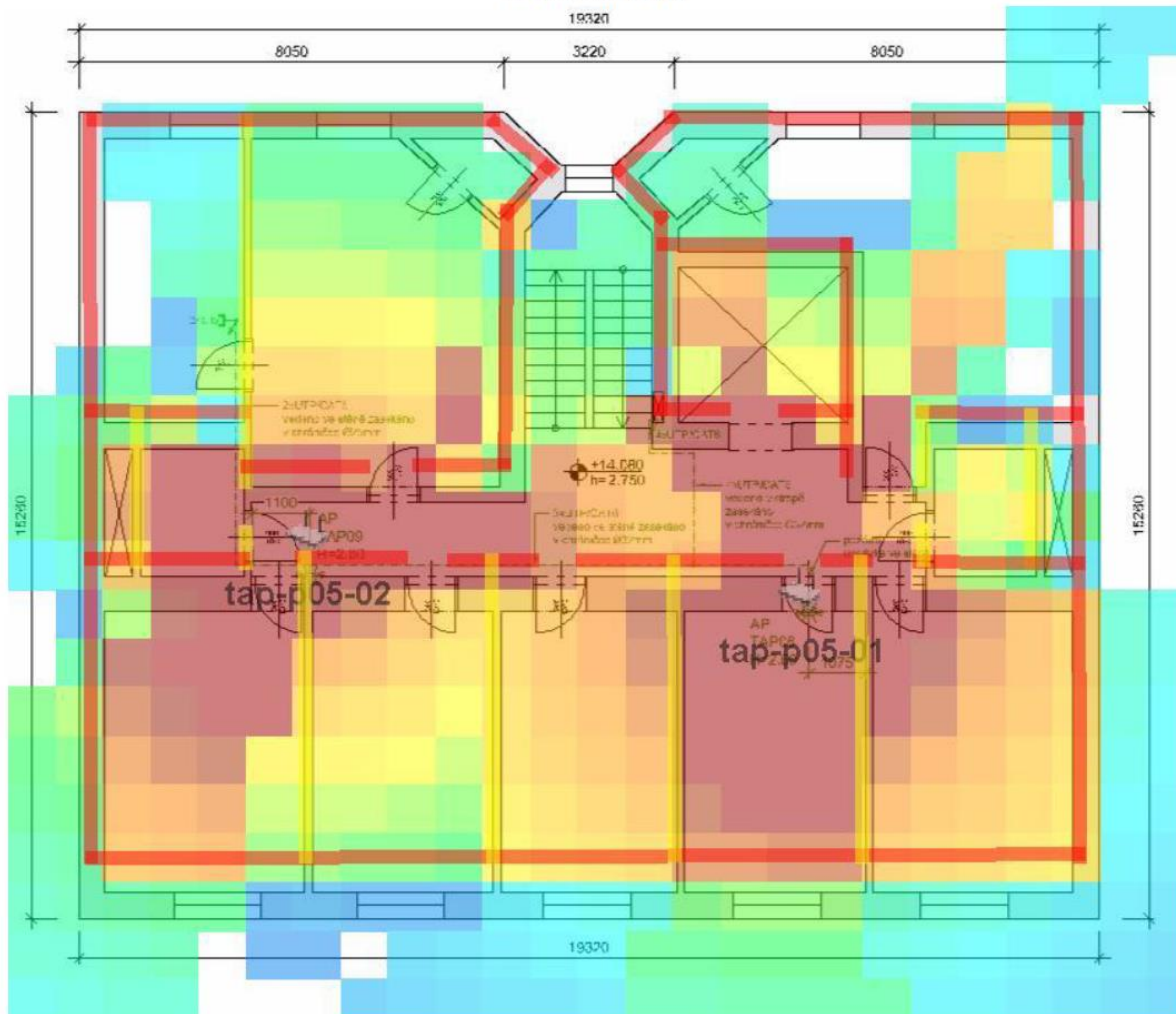

## 4. Nová budova

### 4.1 Nová budova – podlaží 1. NP

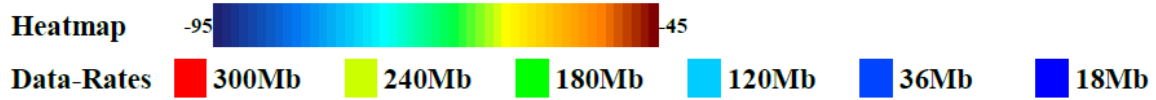

**Campus: JUS**

Data Rate: 36.0 Mbps  
Client Xmit: 30mW

**Building: Novábudova**

Address: U Jedličkova ústavu 2, Praha 2  
Data Rate: 36.0 Mbps  
Client Xmit: 30mW  
Geo Code: Long: 14.4249767 Lat: 50.0602703

**Floor 1.0: 1.NP**

Environment: Offices  
Data Rate: 36.0 Mbps  
Client Xmit: 30mW  
Floor Height: 3,64 Meters  
Image Area: 1 456 Sq Meters  
Total Controllers: 0  
Total IDFs: 0  
Total Racks: 0  
Total Switches: 0  
Total Ports: 0  
Total POE Ports: 0  
Total APs: 3  
Total AMs: 0

**Floor Plan Only View**

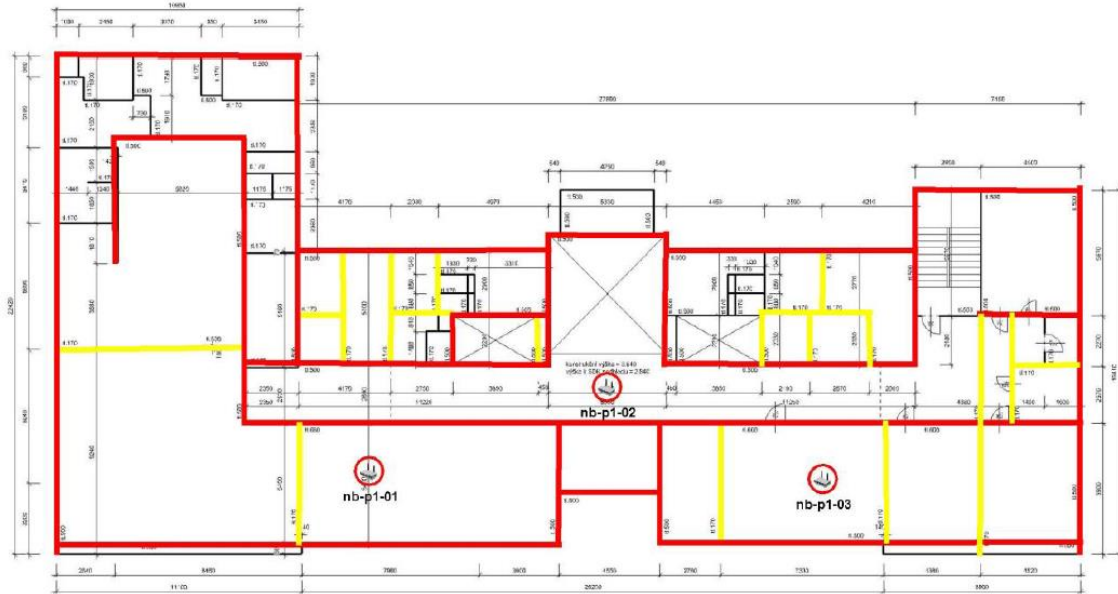

**Data Rate View**



**Heat Map View**

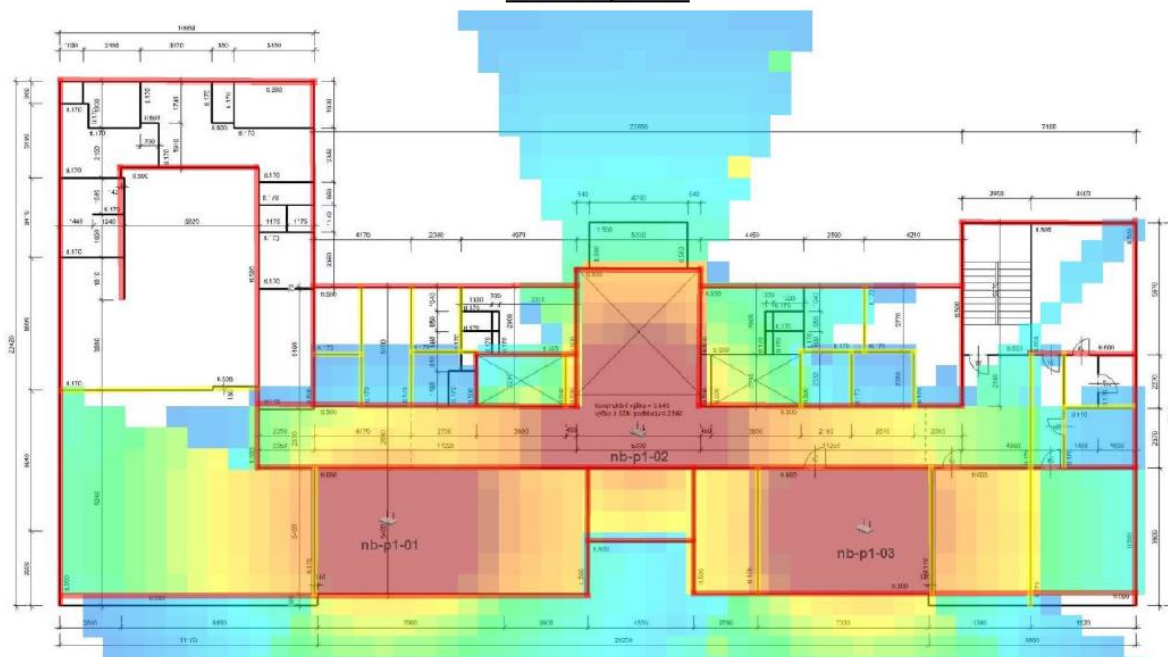

## 4.2 Nová budova – podlaží 2. NP

### Floor 2.0: 2.NP

Environment:	Offices
Data Rate:	36.0 Mbps
Client Xmit:	30mW
Floor Height:	3,64 Meters
Image Area:	1 591 Sq Meters
Total Controllers:	0
Total IDF's:	0
Total Racks:	0
Total Switches:	0
Total Ports:	0
Total POE Ports:	0
Total APs:	3
Total AMs:	0

### Floor Plan Only View

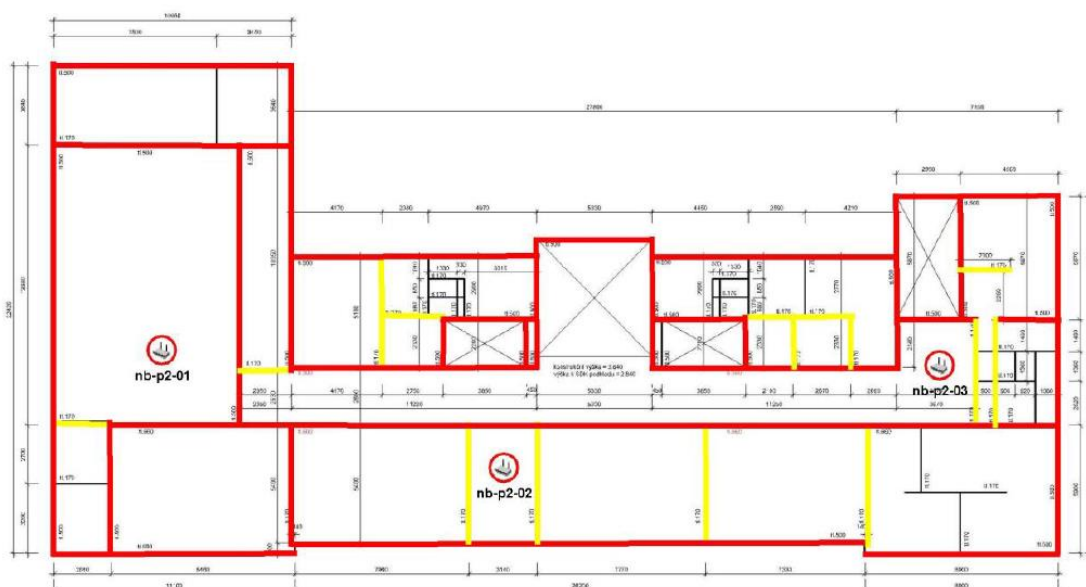

**Data Rate View**



**Heat Map View**

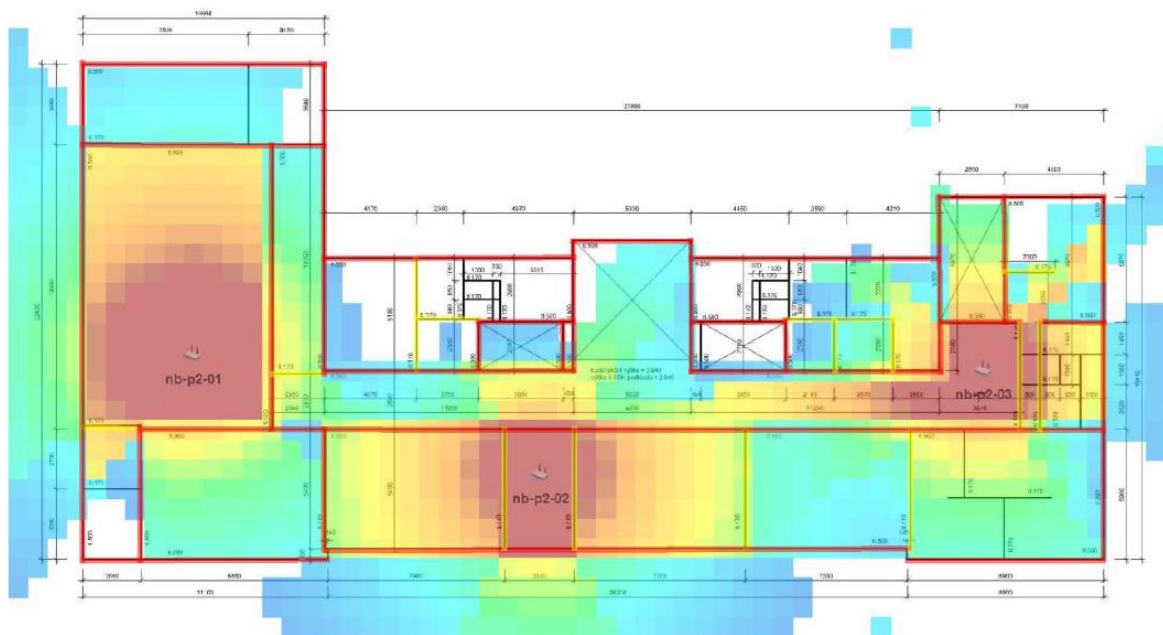



## 4.3 Nová budova – podlaží 3. NP

### Floor 3.0: 3.NP

Environment:	Offices
Data Rate:	36.0 Mbps
Client Xmit:	30mW
Floor Height:	3,64 Meters
Image Area:	1 284 Sq Meters
Total Controllers:	0
Total IDF's:	0
Total Racks:	0
Total Switches:	0
Total Ports:	0
Total POE Ports:	0
Total APs:	4
Total AMs:	0

Floor Plan Only View

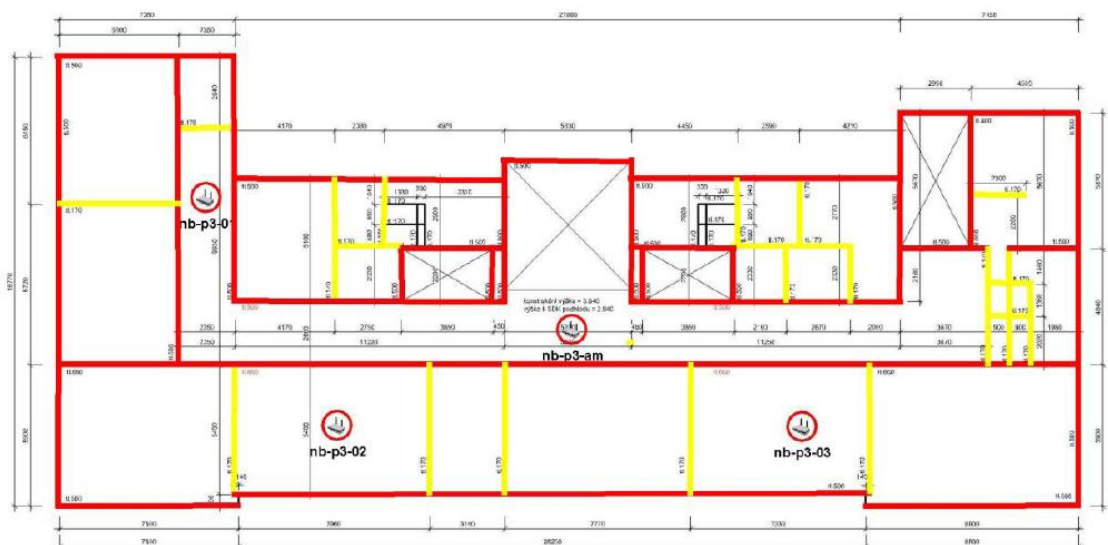

**Data Rate View**



**Heat Map View**

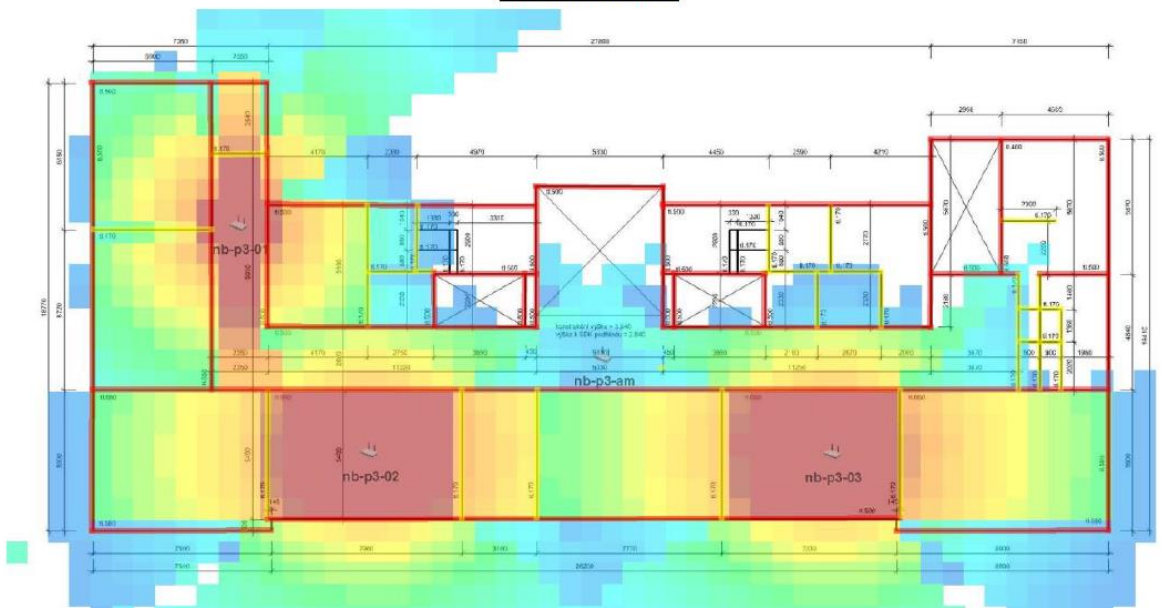

## 4.4 Nová budova – podlaží 4. NP

### Floor 4.0: 4.NP

Environment:	Offices
Data Rate:	36.0 Mbps
Client Xmit:	30mW
Floor Height:	3,64 Meters
Image Area:	1 293 Sq Meters
Total Controllers:	0
Total IDF's:	0
Total Racks:	0
Total Switches:	0
Total Ports:	0
Total POE Ports:	0
Total APs:	3
Total AMs:	0

**Floor Plan Only View**

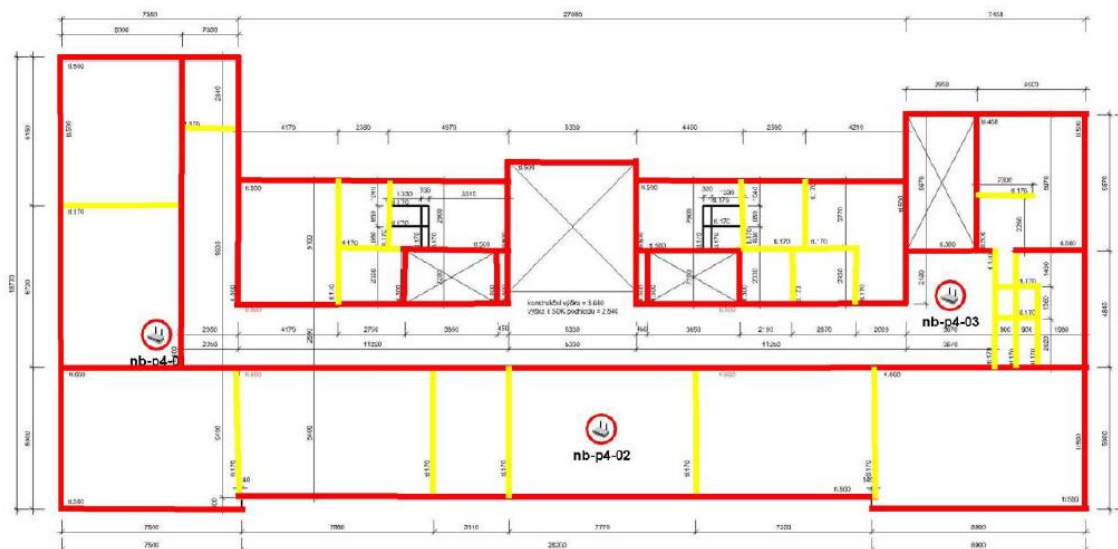

**Data Rate View**

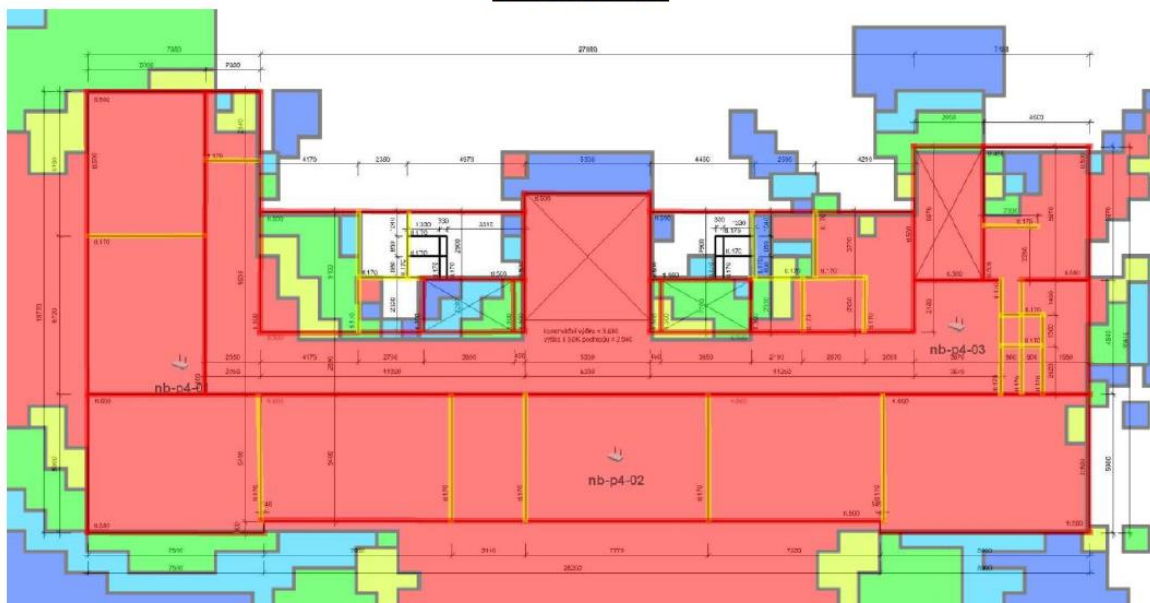

**Heat Map View**



## 4.5 Nová budova – podlaží 5. NP

### Floor 5.0: 5.NP

Environment:	Offices
Data Rate:	36.0 Mbps
Client Xmit:	30mW
Floor Height:	2,60 Meters
Image Area:	1 073 Sq Meters
Total Controllers:	0
Total IDF's:	0
Total Racks:	0
Total Switches:	0
Total Ports:	0
Total POE Ports:	0
Total APs:	3
Total AMs:	0

**Floor Plan Only View**

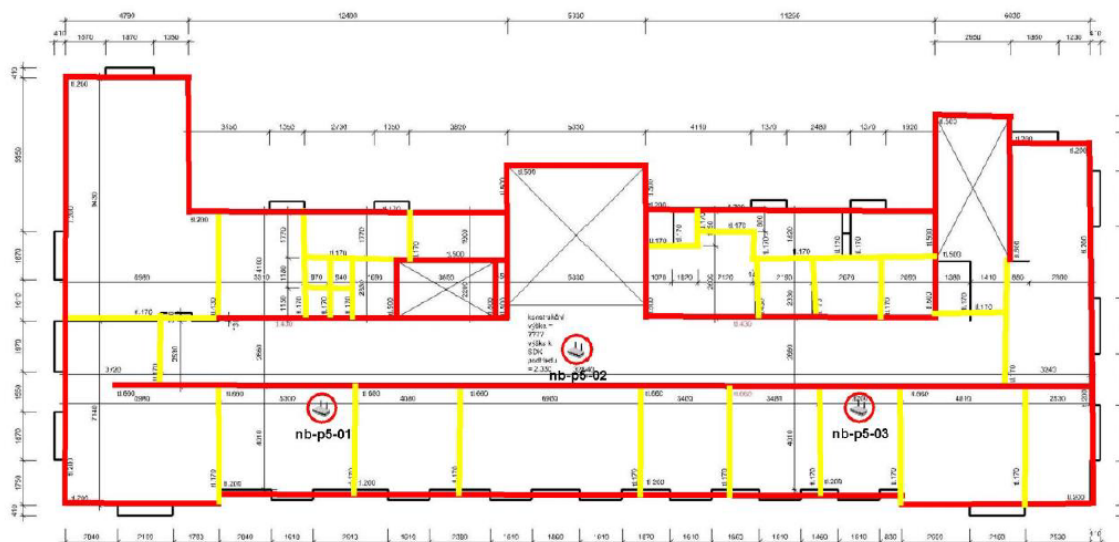

**Data Rate View**



**Heat Map View**

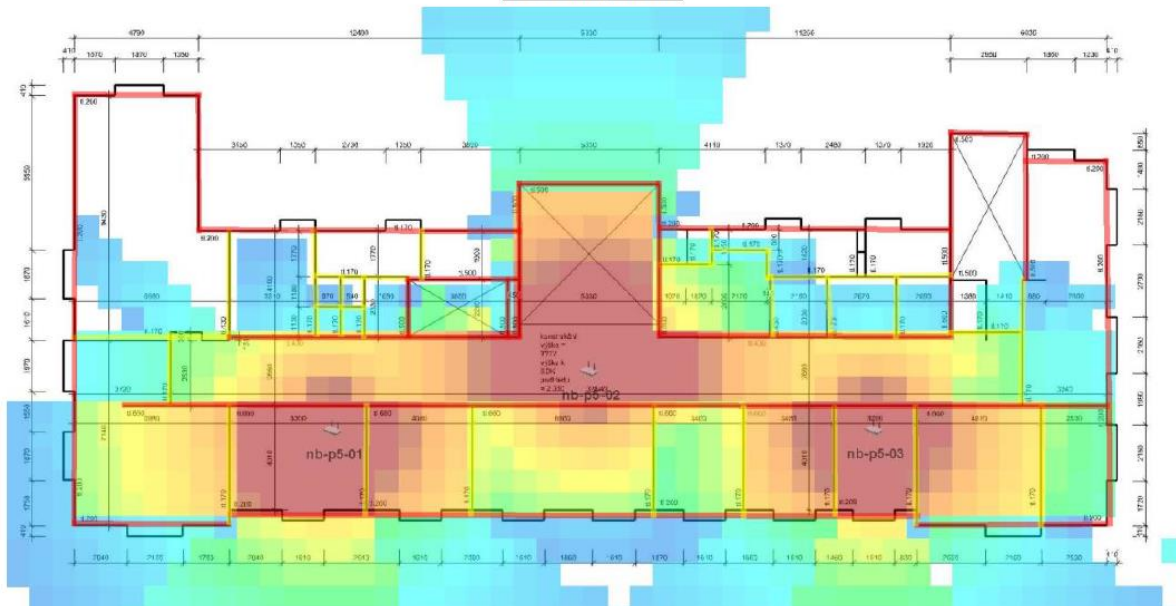

## 5. Stará budova – ředitelství

### 5.1 Stará budova – podlaží 2. NP

#### **Floor 2.0: 2.NP**

Environment:	Offices
Data Rate:	36.0 Mbps
Client Xmit:	30mW
Floor Height:	10,00 Meters
Image Area:	1 163 Sq Meters
Total Controllers:	0
Total IDFs:	0
Total Racks:	0
Total Switches:	0
Total Ports:	0
Total POE Ports:	3
Total APs:	3
Total AMs:	0

Floor Plan Only View





Data Rate View

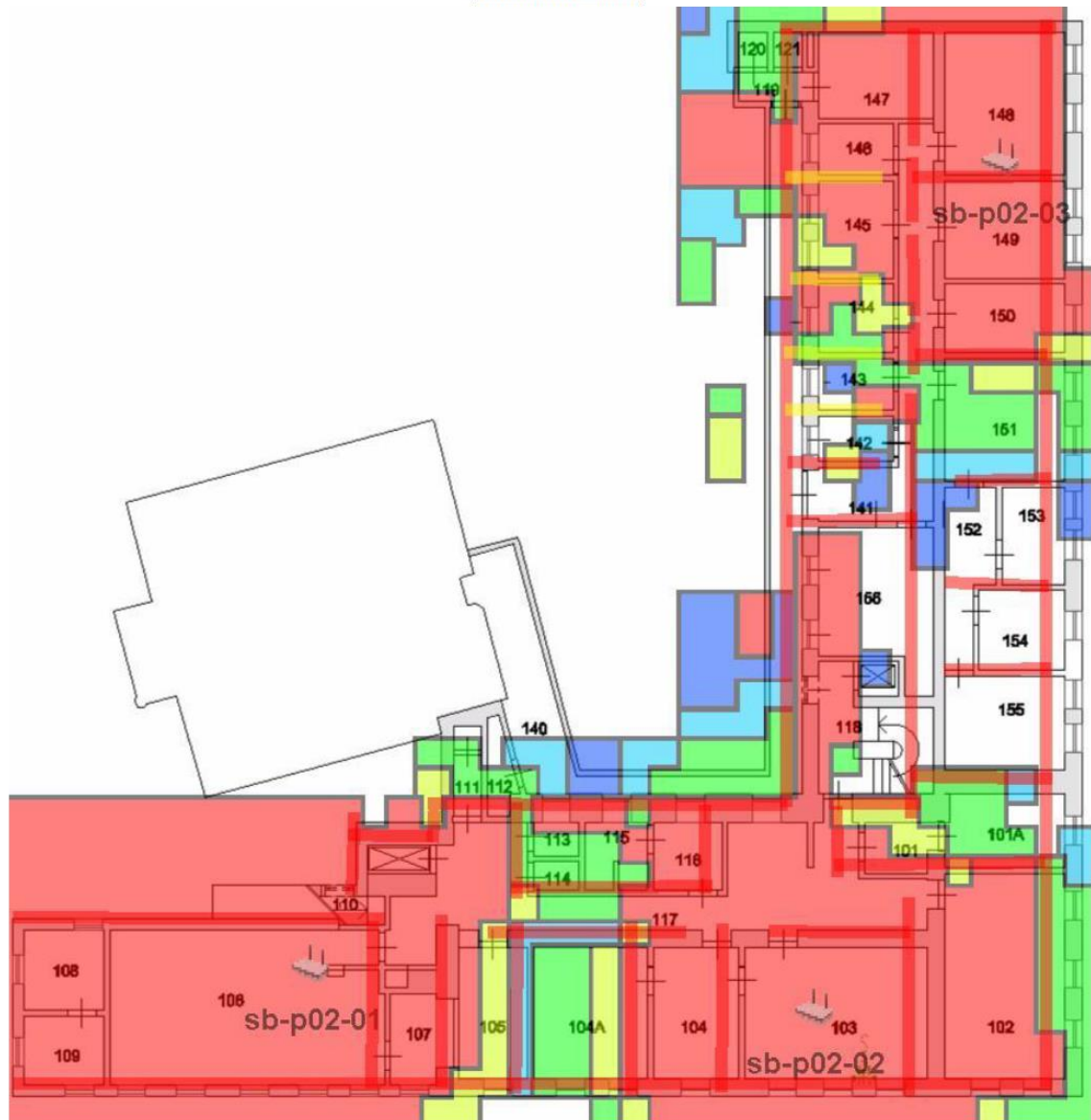

Heat Map View



## 5.2 Stará budova – podlaží 3. NP

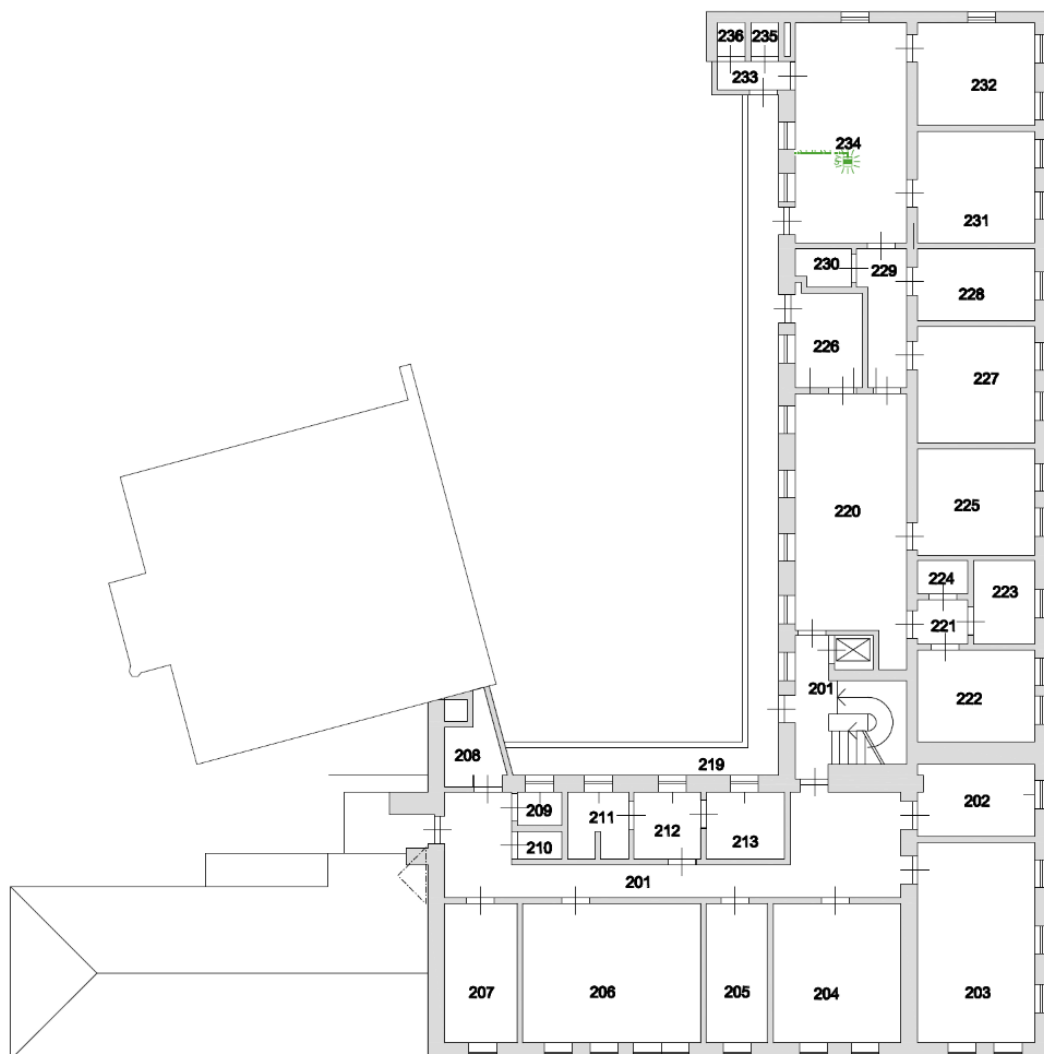

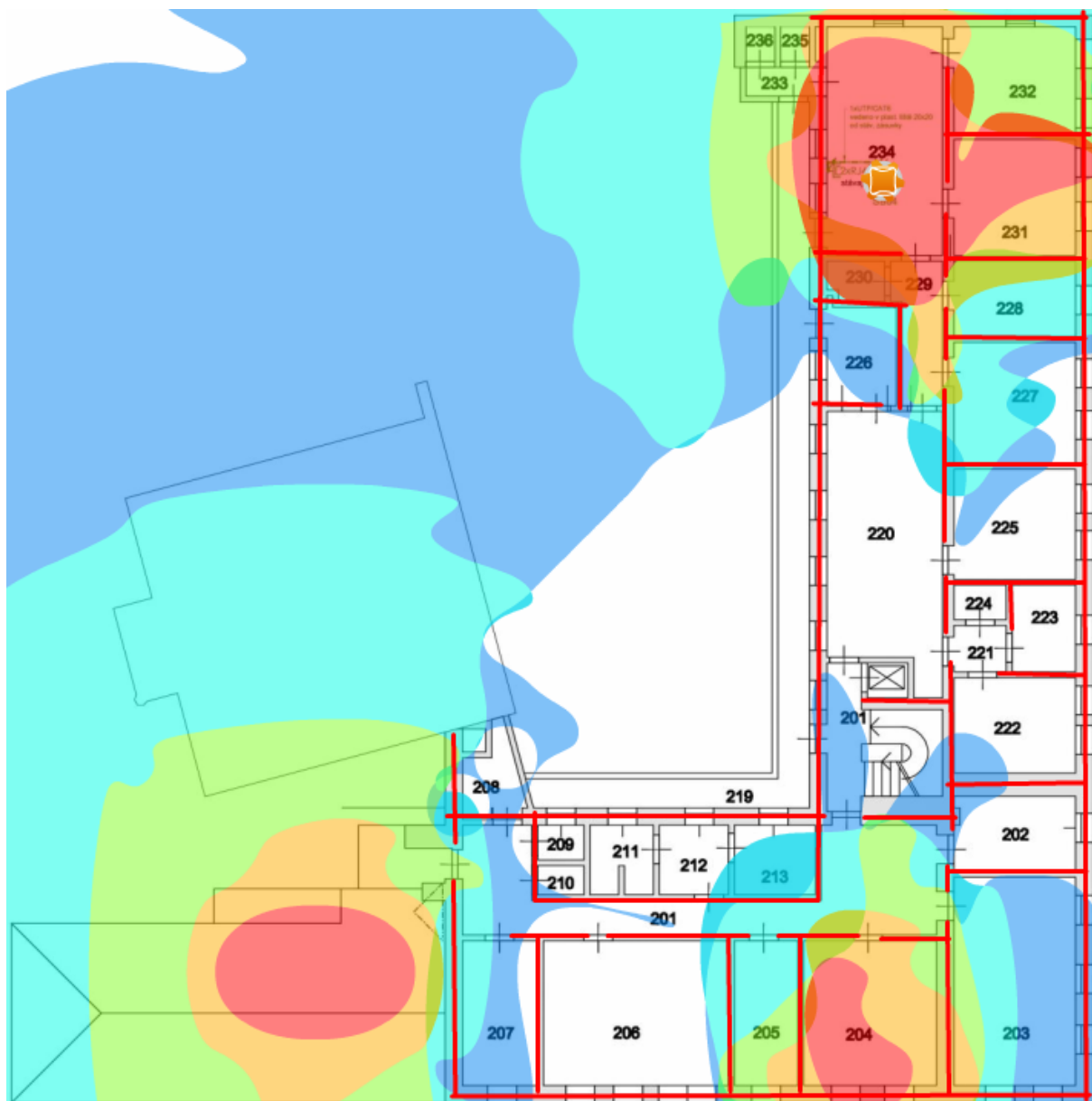

## 6. Domeček

### 6.1 Domeček – podlaží 1. NP

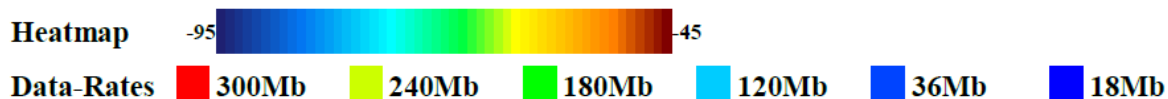

**Campus: JUS**

Data Rate: 36.0 Mbps  
Client Xmit: 30mW

**Building: DOMECEK**

Address: V Pevnosti 4/13, Praha 2  
Data Rate: 36.0 Mbps  
Client Xmit: 30mW  
Geo Code: Long: 14.42 Lat: 50.06

**Floor 1.0: 1.NP**

Environment: Offices  
Data Rate: 36.0 Mbps  
Client Xmit: 30mW  
Floor Height: 10,00 Meters  
Image Area: 351 Sq Meters  
Total Controllers: 0  
Total IDFs: 0  
Total Racks: 0  
Total Switches: 0  
Total Ports: 0  
Total POE Ports: 0  
Total APs: 1  
Total AMs: 0

**Floor Plan Only View**

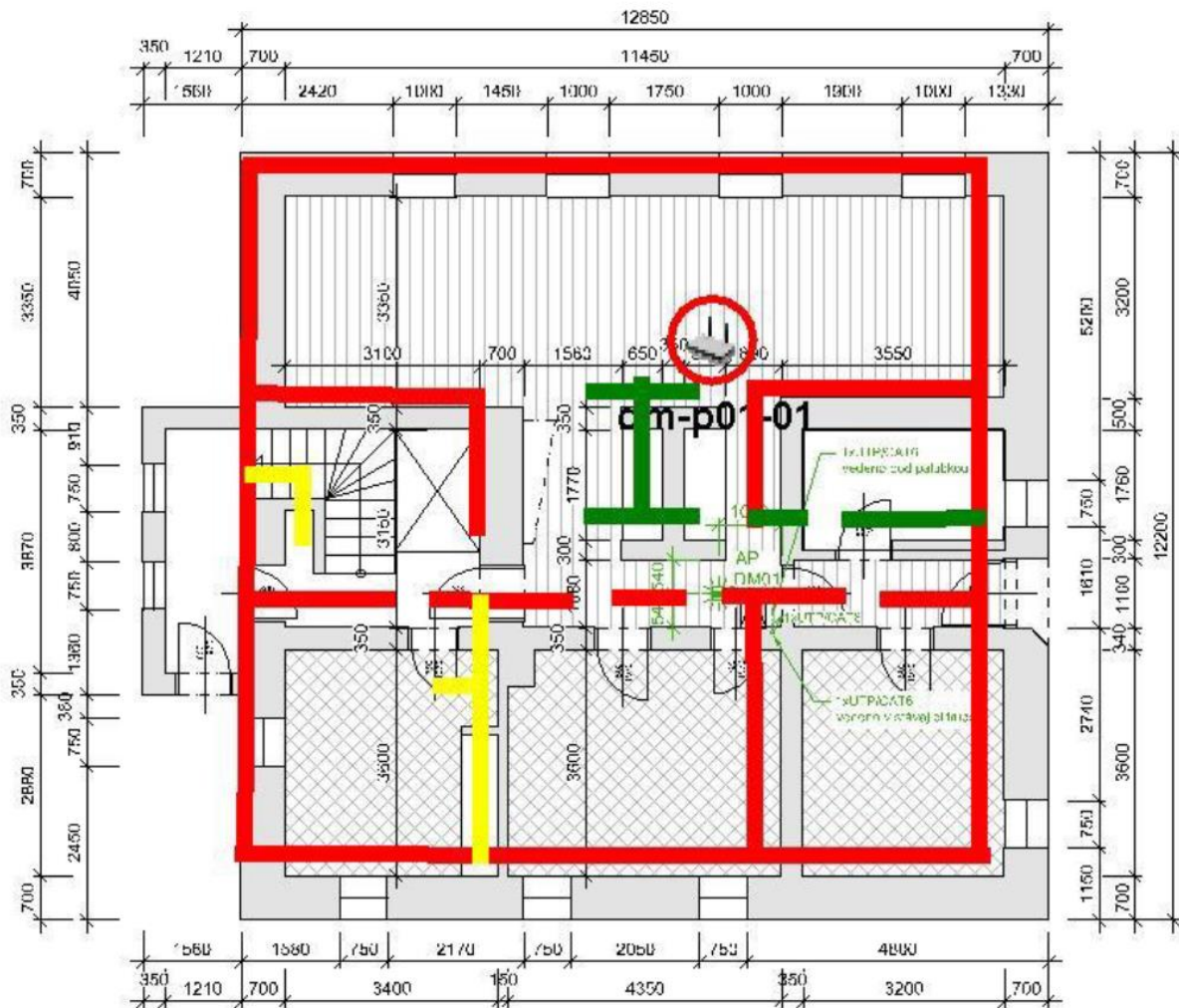

**Data Rate View**

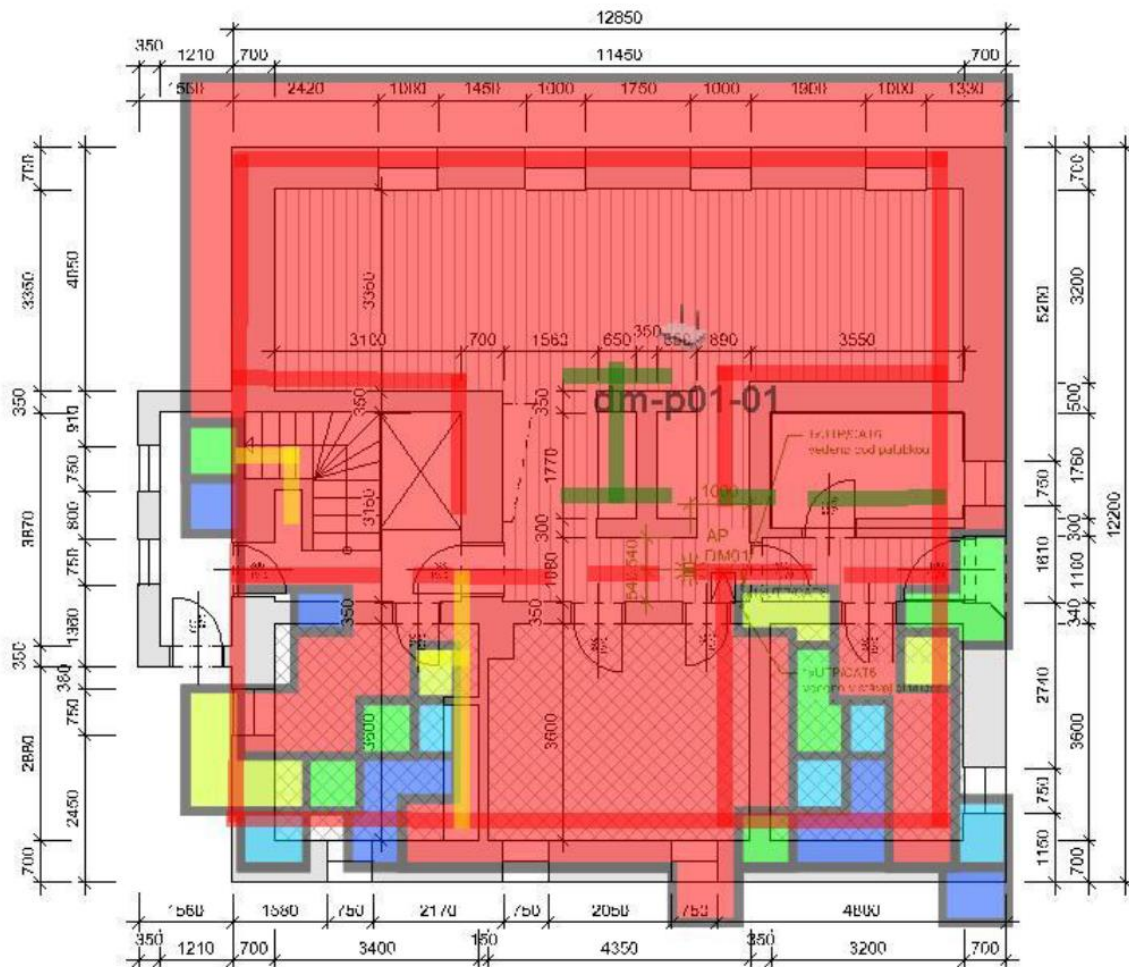

**Heat Map View**

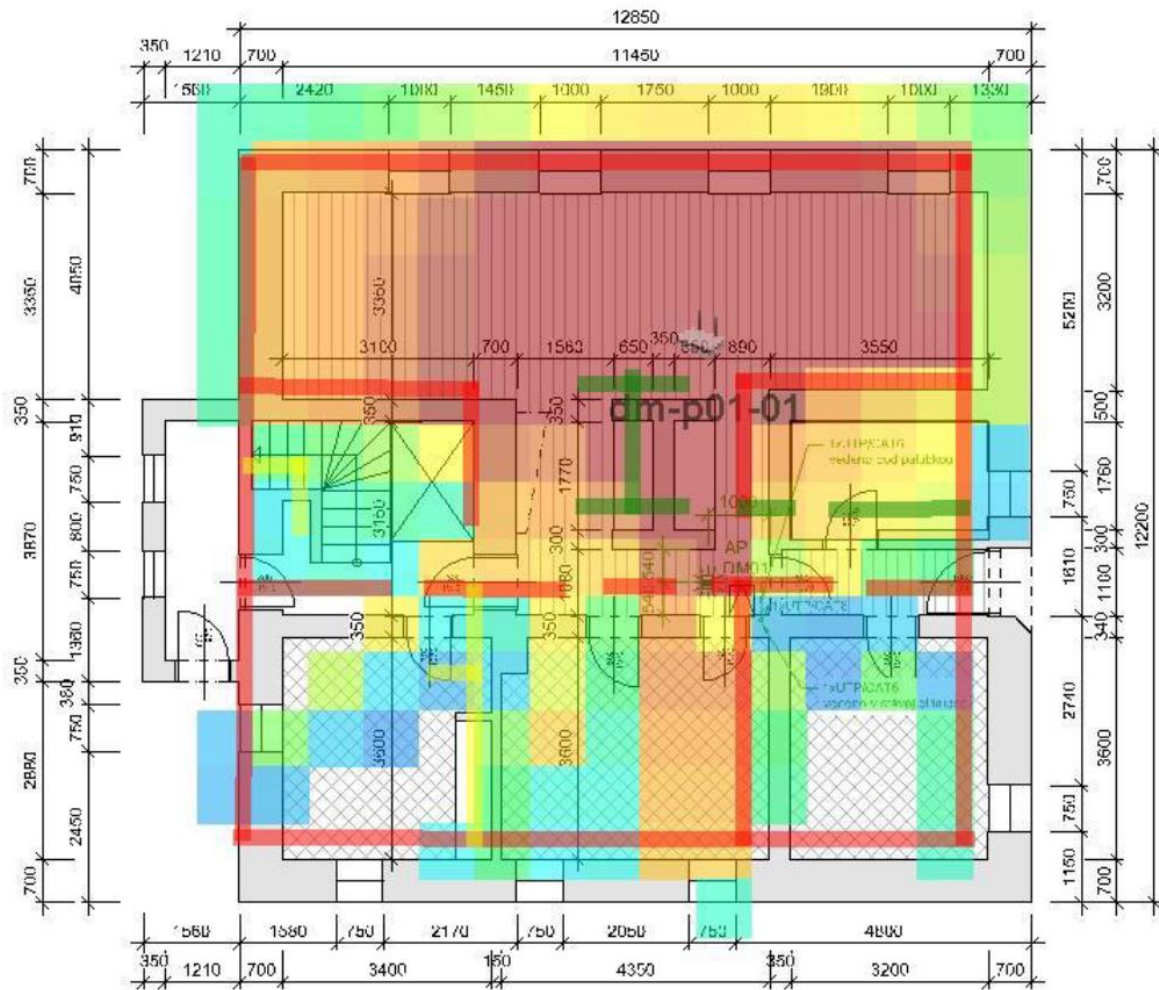



## 6.2 Domeček – podlaží 2. NP

### Floor 2.0: 2.NP

Environment:	Offices
Data Rate:	36.0 Mbps
Client Xmit:	30mW
Floor Height:	10,00 Meters
Image Area:	346 Sq Meters
Total Controllers:	0
Total IDFs:	0
Total Racks:	0
Total Switches:	0
Total Ports:	0
Total POE Ports:	0
Total APs:	1
Total AMs:	0

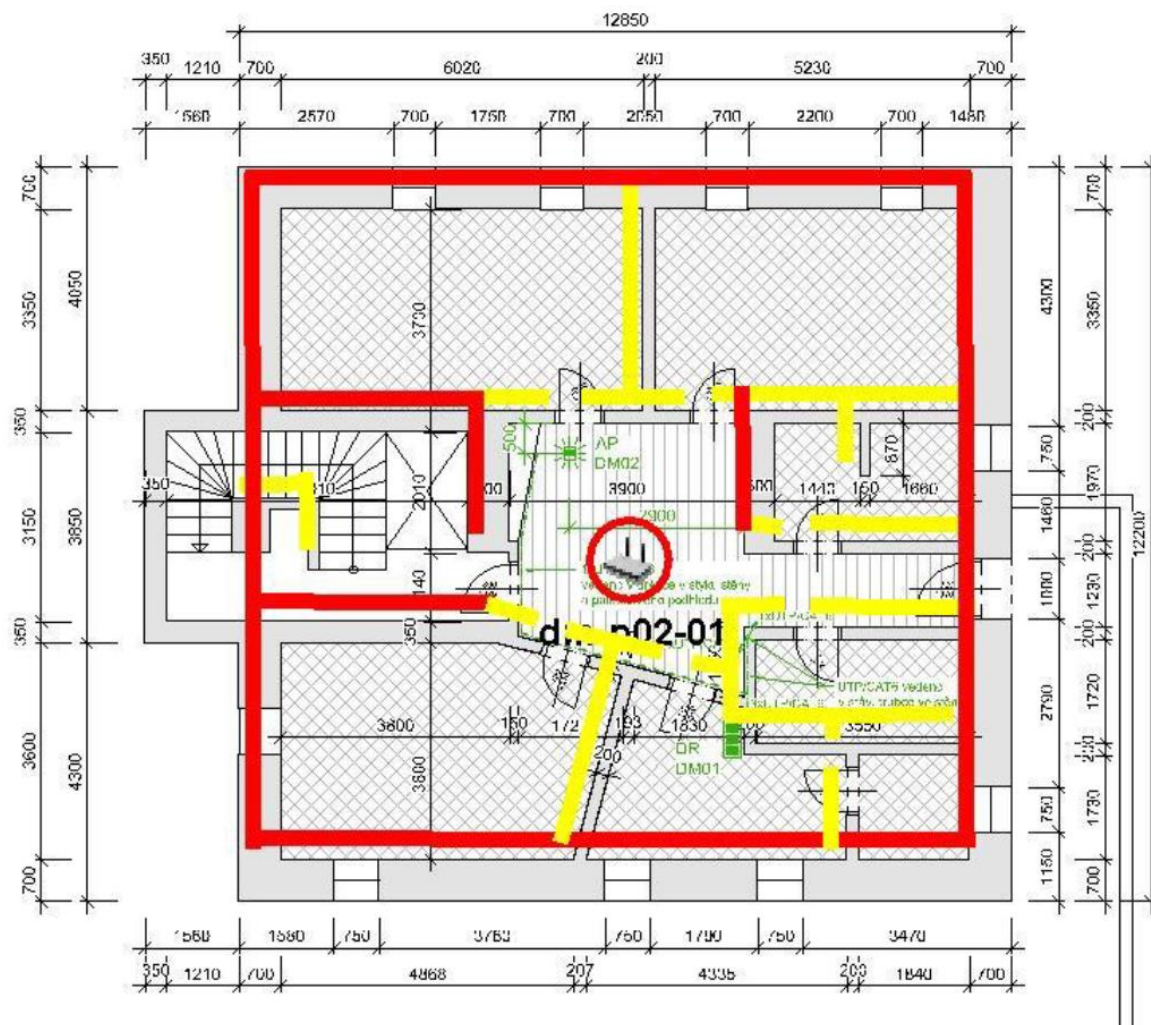

**Data Rate View**

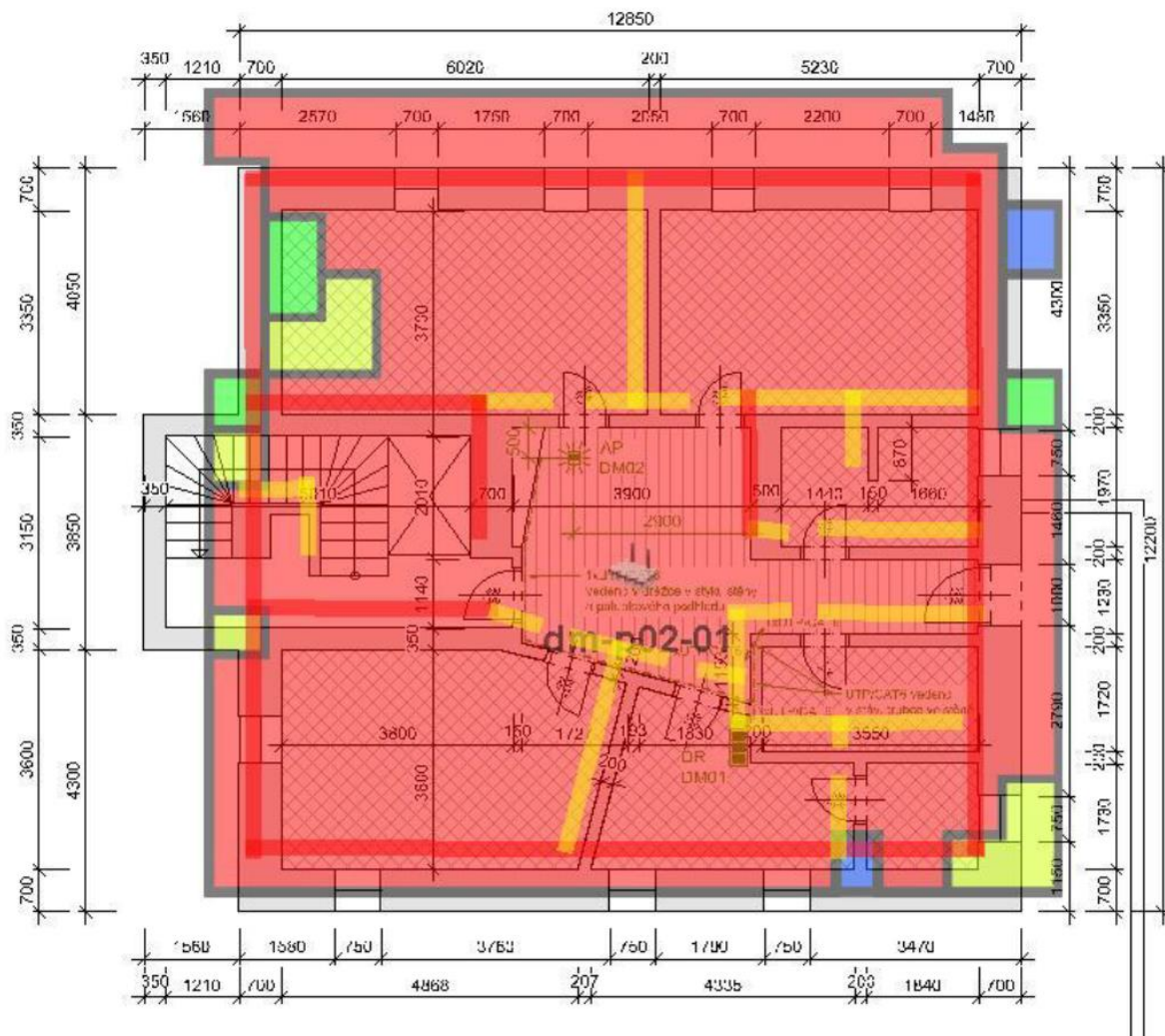

**Heat Map View**

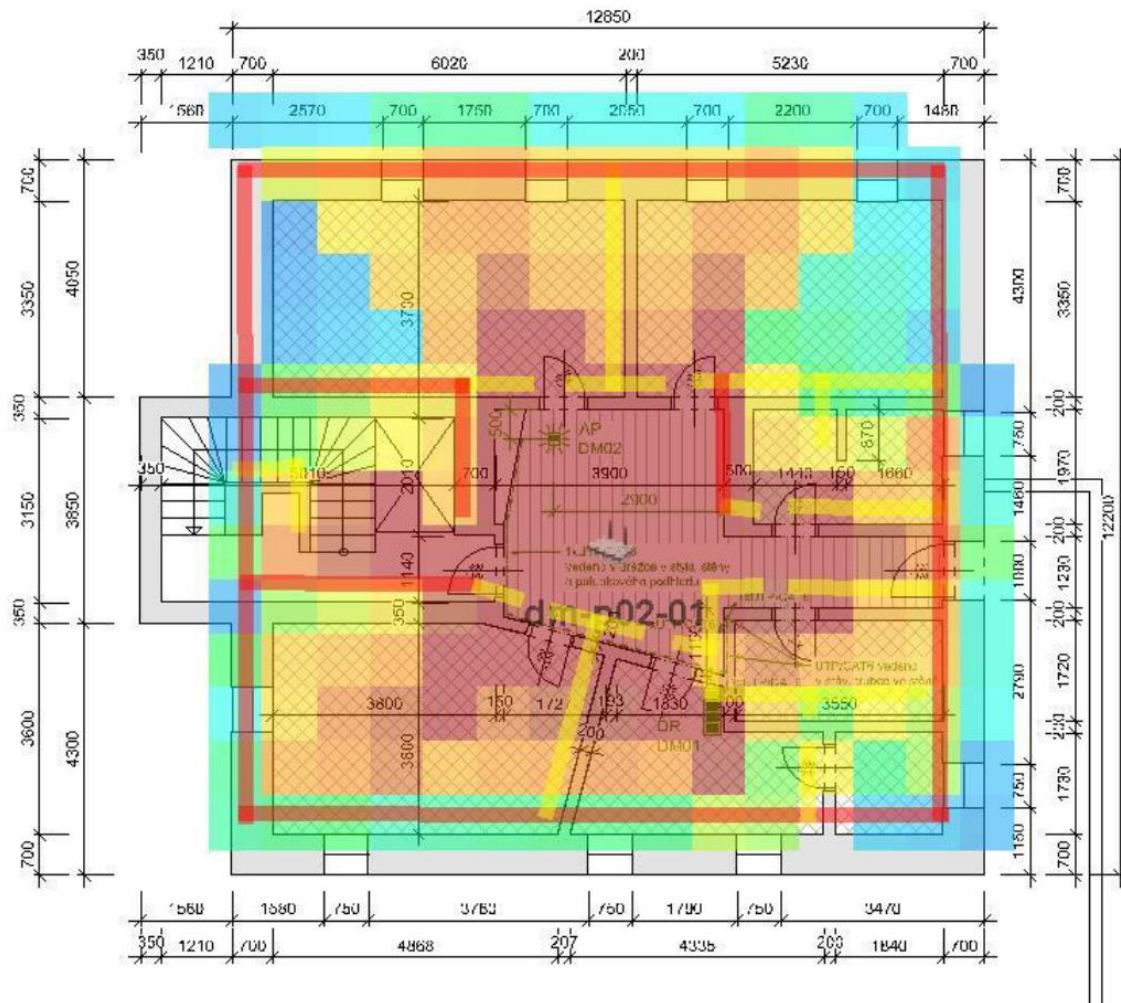



**Data Rate View**

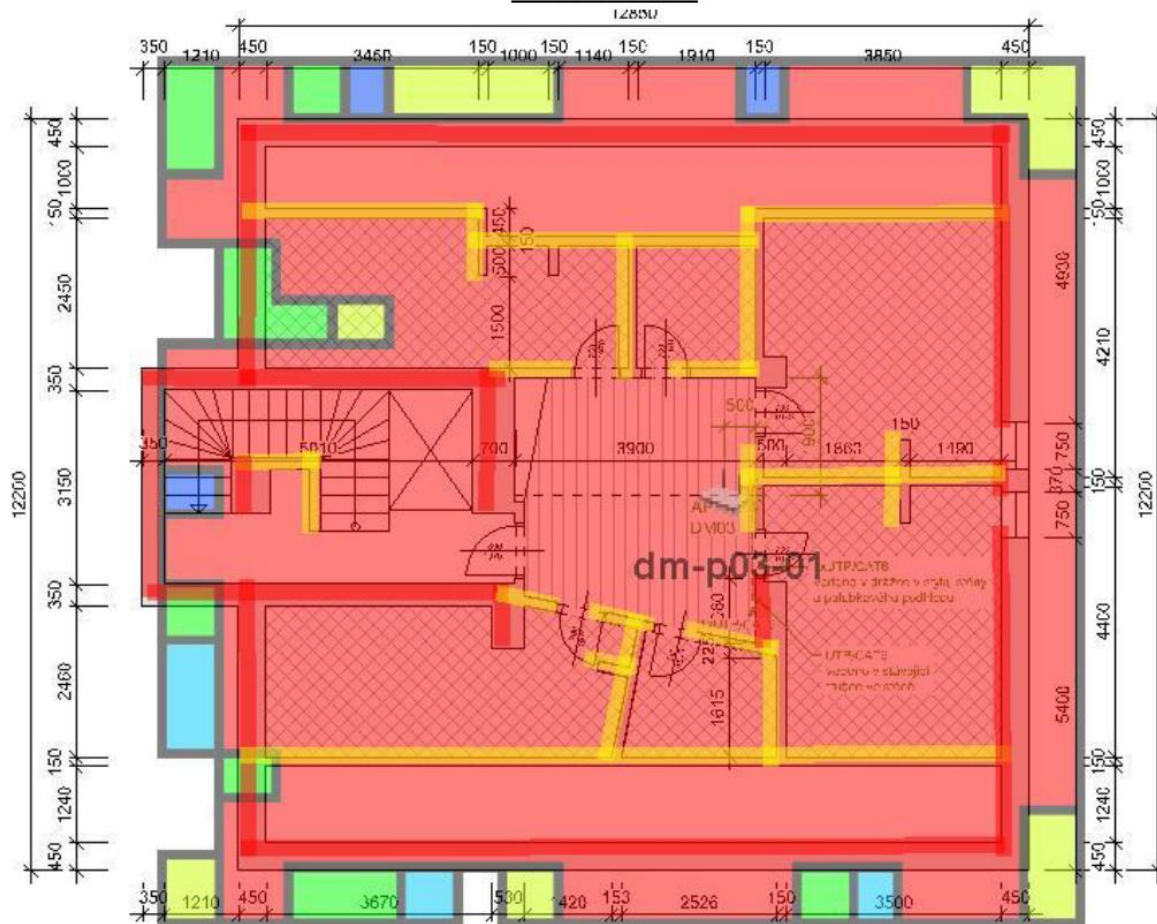

**Heat Map View**

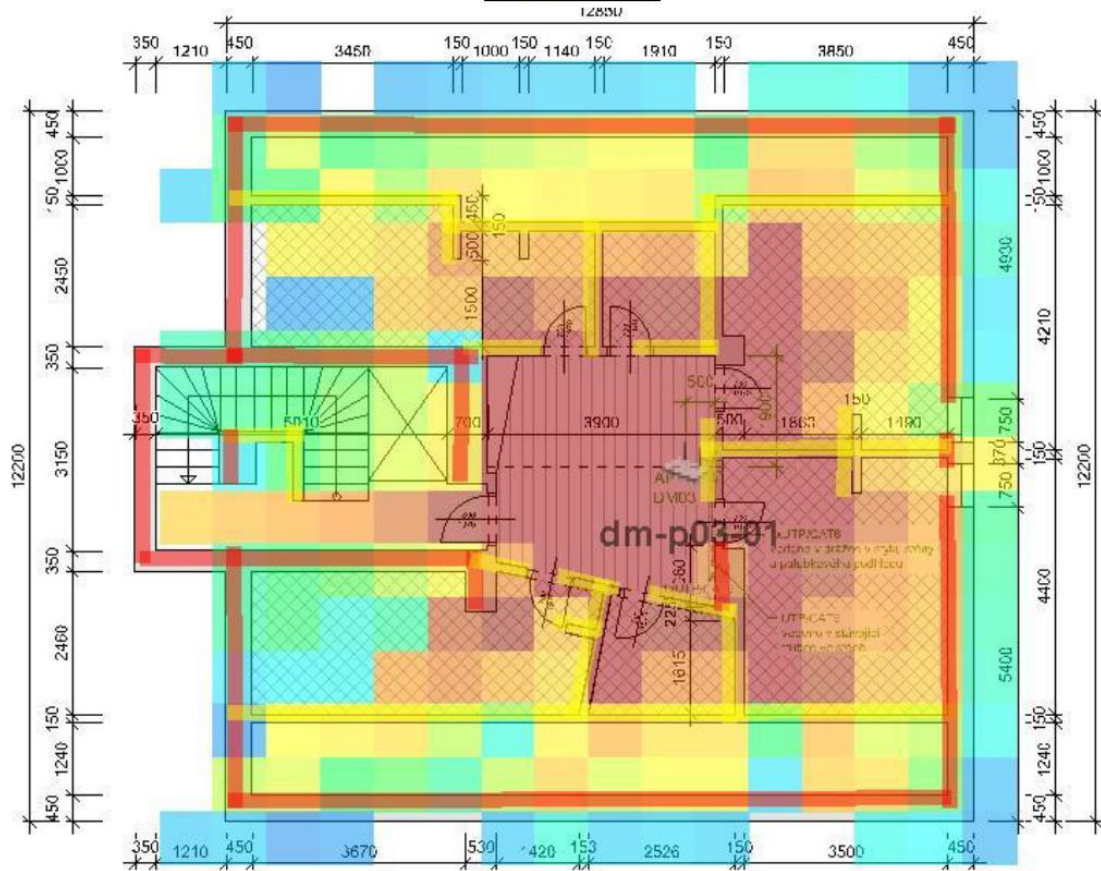

## 7. Škola ve zdi

### 7.1 Škola ve zdi – podlaží 2. NP

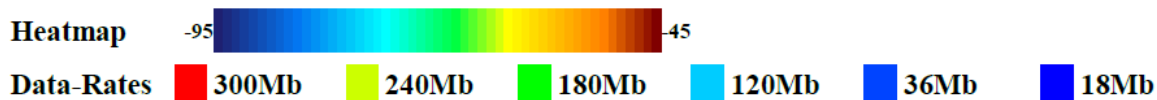

#### Campus: JUS

Data Rate: 36.0 Mbps  
Client Xmit: 30mW

#### Building: ŠKOLAVEZDI

Address: V Pevnosti 4/13  
Data Rate: 36.0 Mbps  
Client Xmit: 30mW  
Geo Code: Long: unset Lat: unset

#### Floor 2.0: 2.NP

Environment: Offices  
Data Rate: 36.0 Mbps  
Client Xmit: 30mW  
Floor Height: 10,00 Meters  
Image Area: 349 Sq Meters  
Total Controllers: 0  
Total IDFs: 0  
Total Racks: 0  
Total Switches: 0  
Total Ports: 0  
Total POE Ports: 0  
Total APs: 2  
Total AMs: 0



Floor Plan Only View

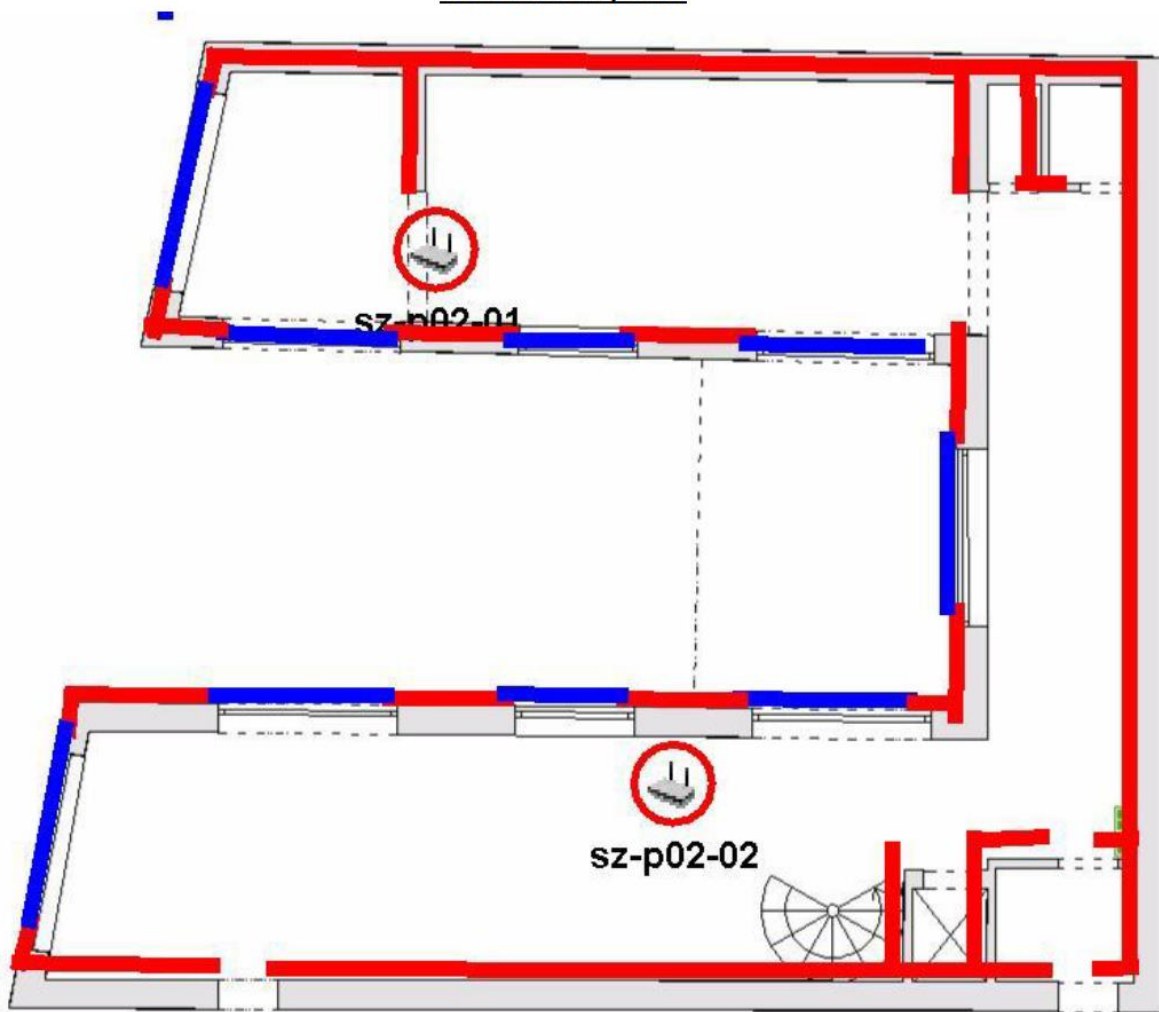

Data Rate View



Heat Map View

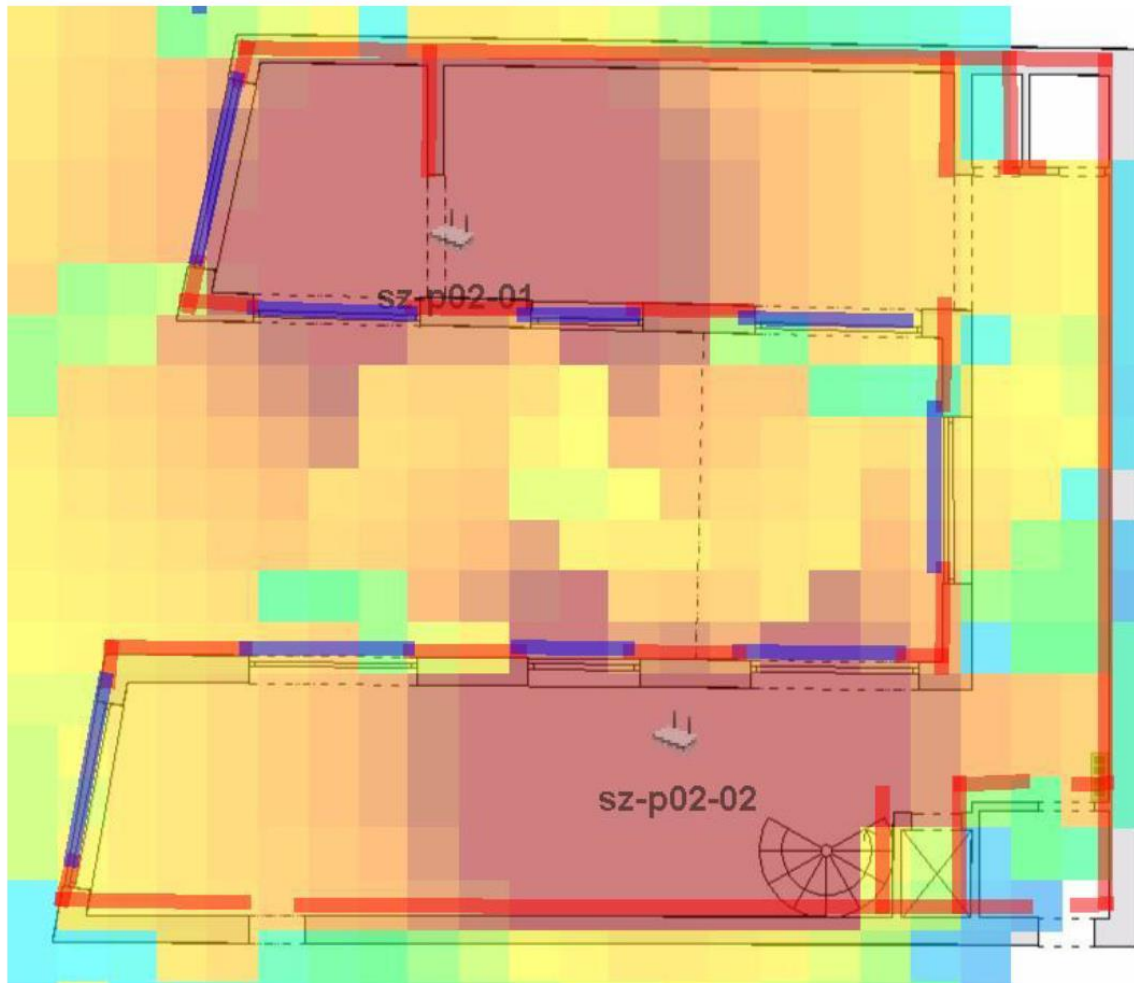

## 8. Rehapavilon D

### 8.1 Rehapavilon D – podlaží 2. NP

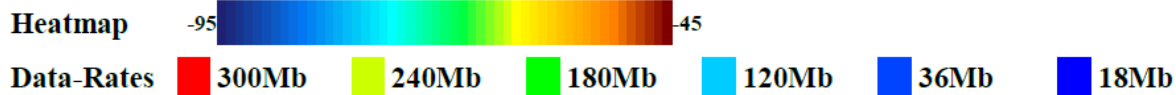

**Campus: JUS**

Data Rate: 36.0 Mbps  
Client Xmit: 30mW

**Building: REHABD**

Address: Na Topolce 1714/1b, Praha 4 - Nusle  
Data Rate: 36.0 Mbps  
Client Xmit: 30mW  
Geo Code: Long: 14.42 Lat: 50.06

**Floor 2.0: 2.NP**

Environment: Offices  
Data Rate: 36.0 Mbps  
Client Xmit: 30mW  
Floor Height: 2,80 Meters  
Image Area: 726 Sq Meters  
Total Controllers: 1  
Total IDFs: 0  
Total Racks: 0  
Total Switches: 1  
Total Ports: 0  
Total POE Ports: 0  
Total APs: 3  
Total AMs: 0

**Floor Plan Only View**

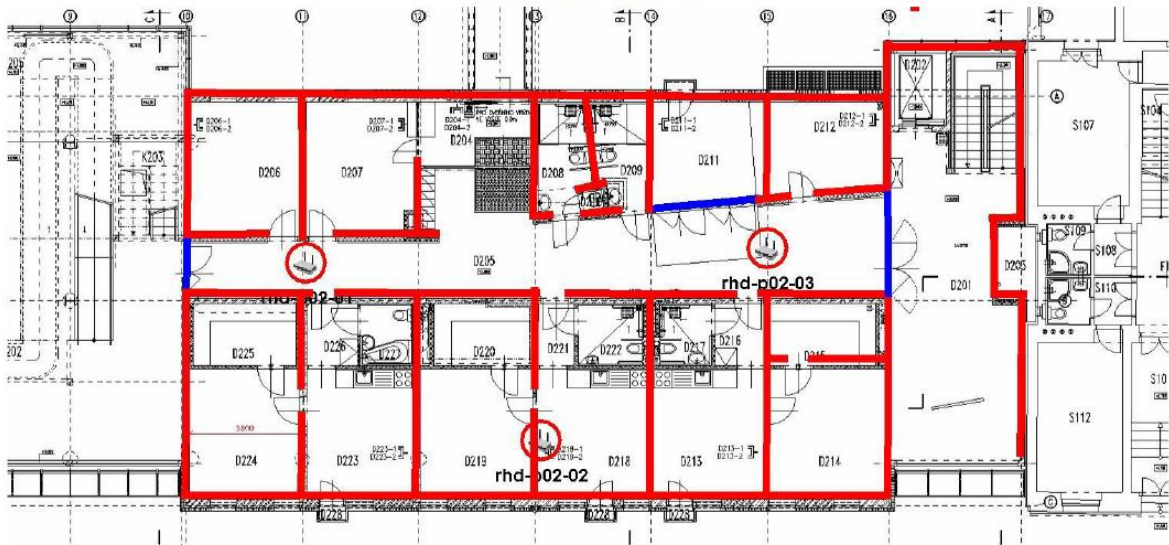

**Data Rate View**

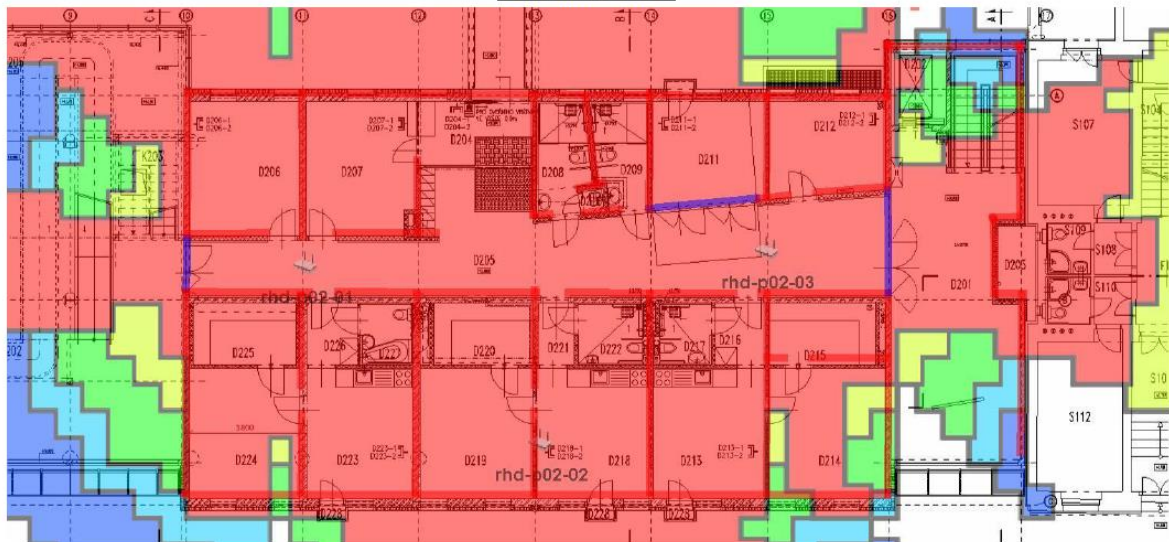

**Heat Map View**

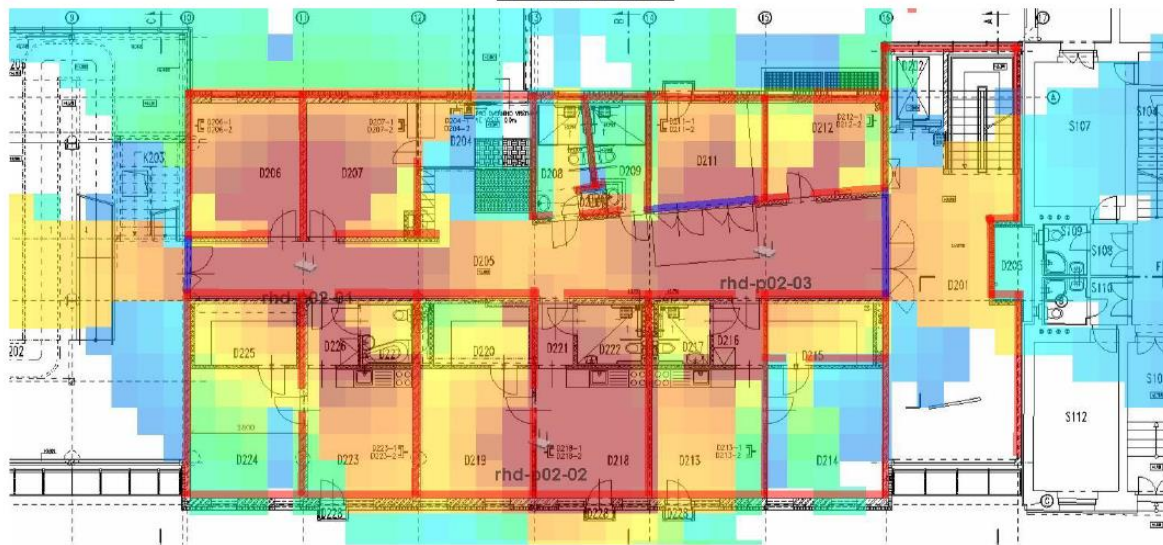

## 8.2 Rehavivon D – podlaží 3. NP

### Floor 3.0: 3.NP

Environment:	Offices
Data Rate:	36.0 Mbps
Client Xmit:	30mW
Floor Height:	2,80 Meters
Image Area:	698 Sq Meters
Total Controllers:	0
Total IDF's:	0
Total Racks:	0
Total Switches:	0
Total Ports:	0
Total POE Ports:	0
Total APs:	2
Total AMs:	0

**Floor Plan Only View**



**Data Rate View**



**Heat Map View**





## 9. Rehapavilon C

### 9.1 Rehapavilon C – podlaží 2. NP

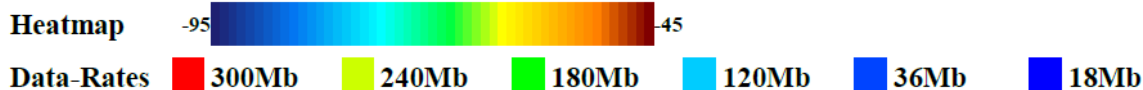

**Campus: JUS**

Data Rate: 36.0 Mbps  
Client Xmit: 30mW

**Building: REHABC**

Address: Na Topolce 1713/1a, Praha 4 - Nusle  
Data Rate: 36.0 Mbps  
Client Xmit: 30mW  
Geo Code: Long: 14.42 Lat: 50.06

**Floor 2.0: 2.NP**

Environment: Offices  
Data Rate: 36.0 Mbps  
Client Xmit: 30mW  
Floor Height: 10,00 Meters  
Image Area: 819 Sq Meters  
Total Controllers: 0  
Total IDFs: 0  
Total Racks: 0  
Total Switches: 0  
Total Ports: 0  
Total POE Ports: 0  
Total APs: 1  
Total AMs: 0

**Floor Plan Only View**

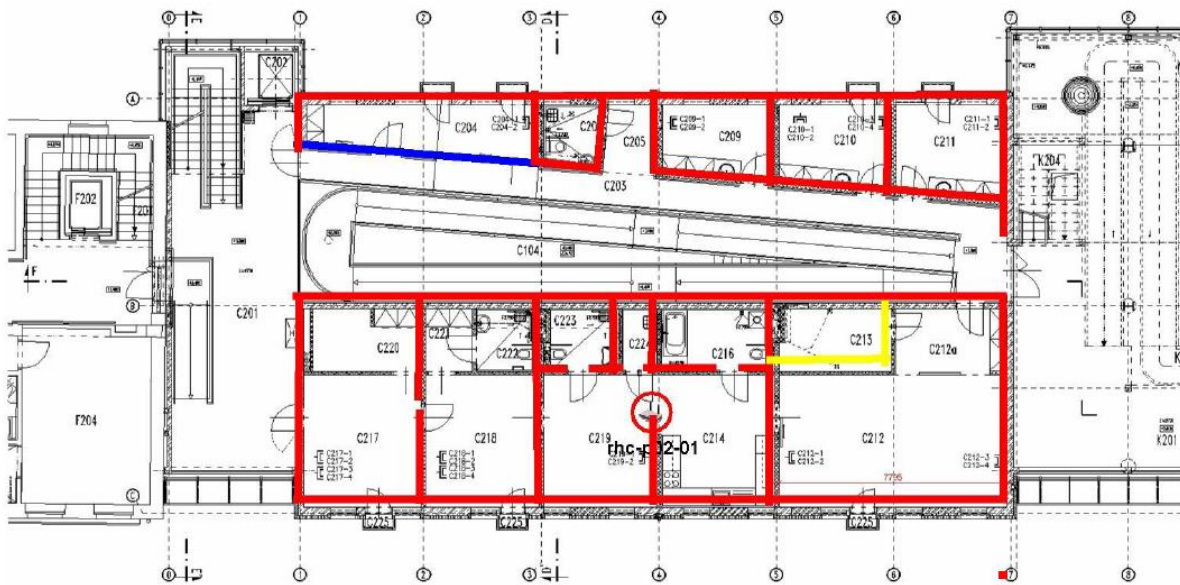

**Data Rate View**

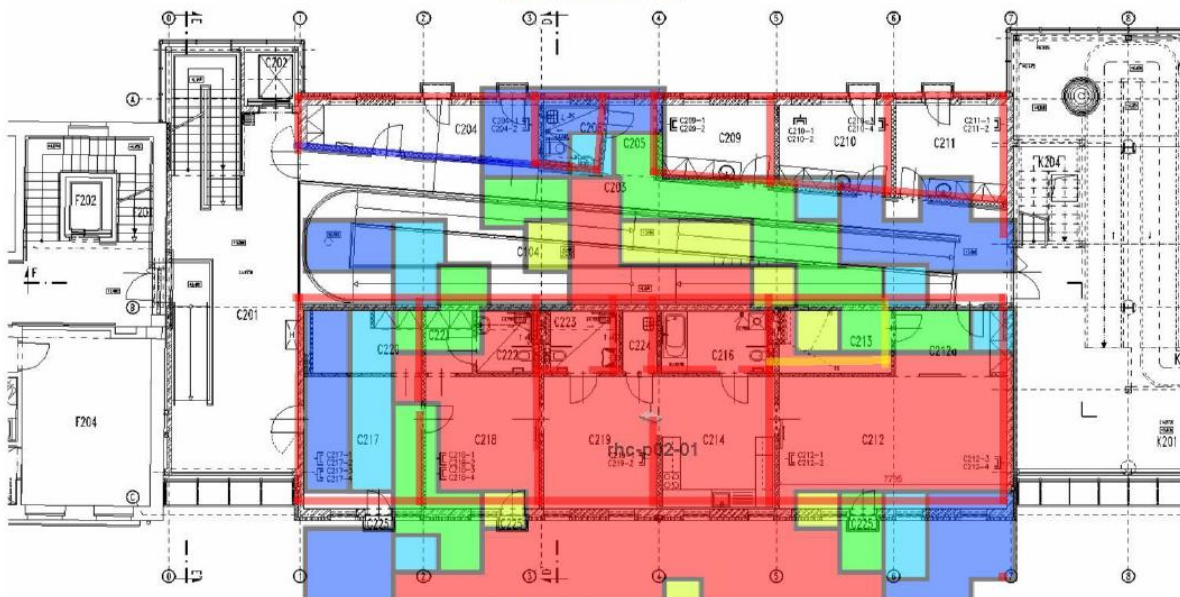

**Heat Map View**

## 9.2 Rehapavilon C – podlaží 3. NP

### Floor 3.0: 3.NP

Environment:	Offices
Data Rate:	36.0 Mbps
Client Xmit:	30mW
Floor Height:	10,00 Meters
Image Area:	764 Sq Meters
Total Controllers:	0
Total IDFs:	0
Total Racks:	0
Total Switches:	0
Total Ports:	0
Total POE Ports:	0
Total APs:	1
Total AMs:	0

**Floor Plan Only View**

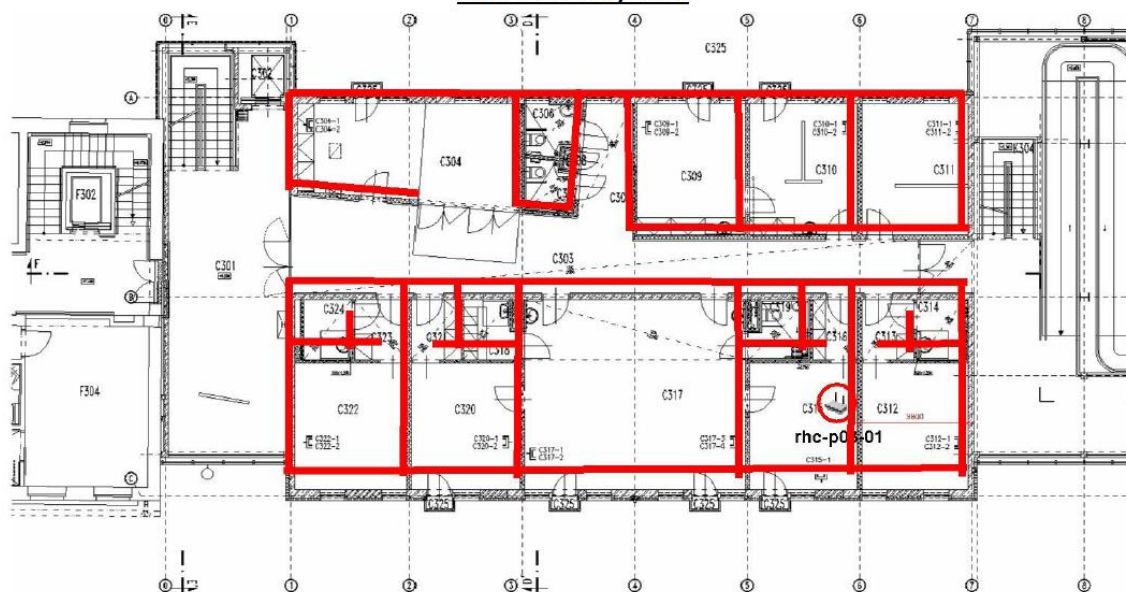

**Data Rate View**

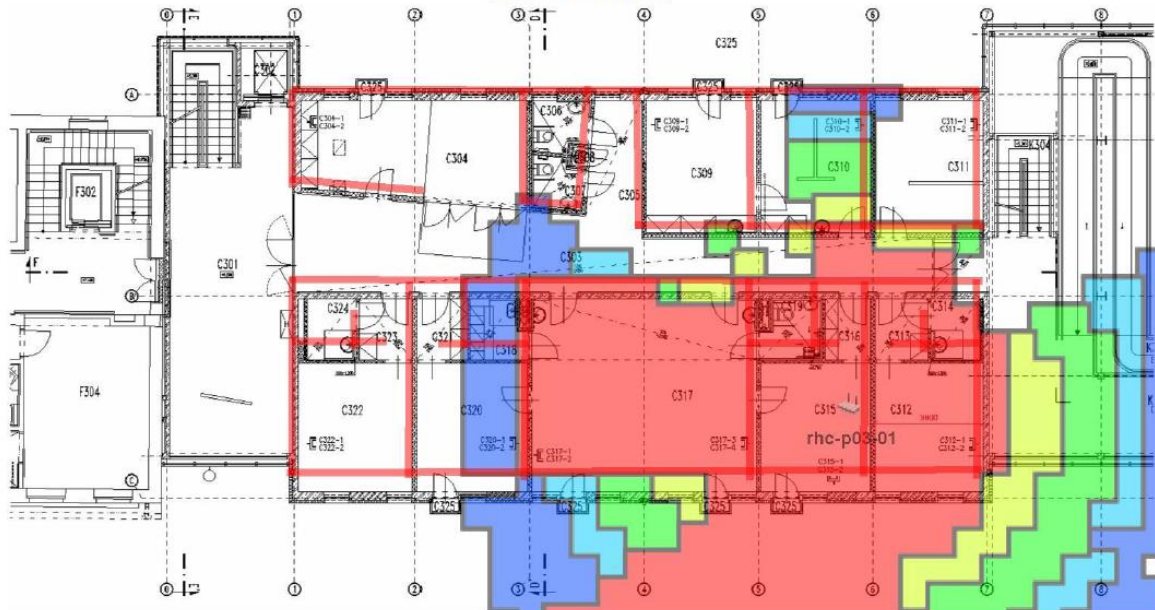

**Heat Map View**

