

Příloha k nájemní smlouvě č. 95N17/66

Agrijan s. r. o.

Variabilní symbol: 9511766

Uzavřeno: 1.8.2017

Roční nájem:

Husovo náměstí 67

Datum tisku: 27.9.2017

Účinná od: 1.8.2017

242 996 Kč

Chotětov

Katastr	Parcela	/	Díl	Skup.	Kultura	Číslo LV	Cena za ha [Kč]	Výměra [m2]	%	Nájem [Kč]
Horky nad Jizerou										
	378	0	0	2	7	10 002	150 800	4 737	2,2	1 571,55
								4 737		1 571,55
Chotětov										
	598	1	0	2	2	10 002	175 000	2 850	2,2	1 097,25
								2 850		1 097,25
Kbel										
	5 034	1	0	2	2	10 002	76 700	405 315	2,2	68 392,85
	5 034	2	0	2	2	10 002	76 700	30 643	2,2	5 170,70
	5 034	3	0	2	2	10 002	76 700	26 611	2,2	4 490,34
	5 034	6	0	2	2	10 002	76 700	70 056	2,2	11 821,25
	5 034	7	0	2	2	10 002	76 700	14 495	2,2	2 445,89
	5 036	1	0	2	2	10 002	76 700	93 117	2,2	15 712,56
	5 036	2	0	2	2	10 002	76 700	10 297	2,2	1 737,52
	5 036	11	0	2	2	10 002	76 700	23 751	2,2	4 007,74
	5 036	12	0	2	2	10 002	76 700	6 567	2,2	1 108,12
	5 036	13	0	2	2	10 002	76 700	13 548	2,2	2 286,09
	5 044	1	0	2	2	10 002	76 700	295 916	2,2	49 932,87
	5 044	2	0	2	2	10 002	76 700	6 279	2,2	1 059,52
	5 044	5	0	2	2	10 002	76 700	34 183	2,2	5 768,04
								1 030 778		173 933,49
Staré Benátky										
	1 484	0	0	2	2	10 002	68 000	364 259	2,2	54 493,15
	1 492	0	0	2	2	10 002	68 000	79 548	2,2	11 900,38
								443 807		66 393,53
CELKEM:								1 482 172		242 996 Kč

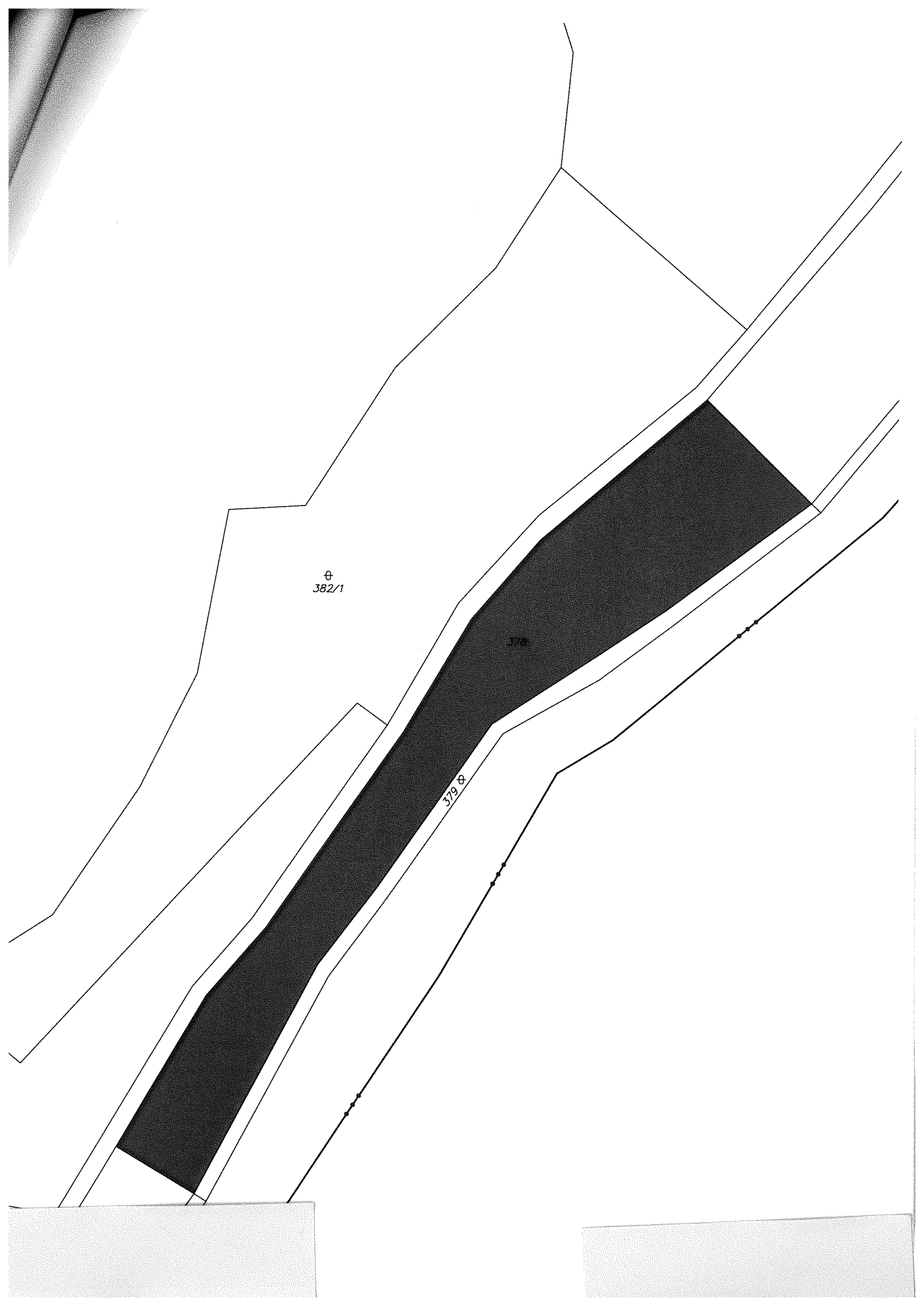

⊕
382/1

378

379 ⊕

600

599

598/29

631

598/30

632

598/31

654

598/35

623

598/2

598/32

648

35

635

597/36

598/33

598/1

597/40

647

659

597/23

597/41

641

597/39

5/46

597/42

642

596/47

597/22

596/48

tek

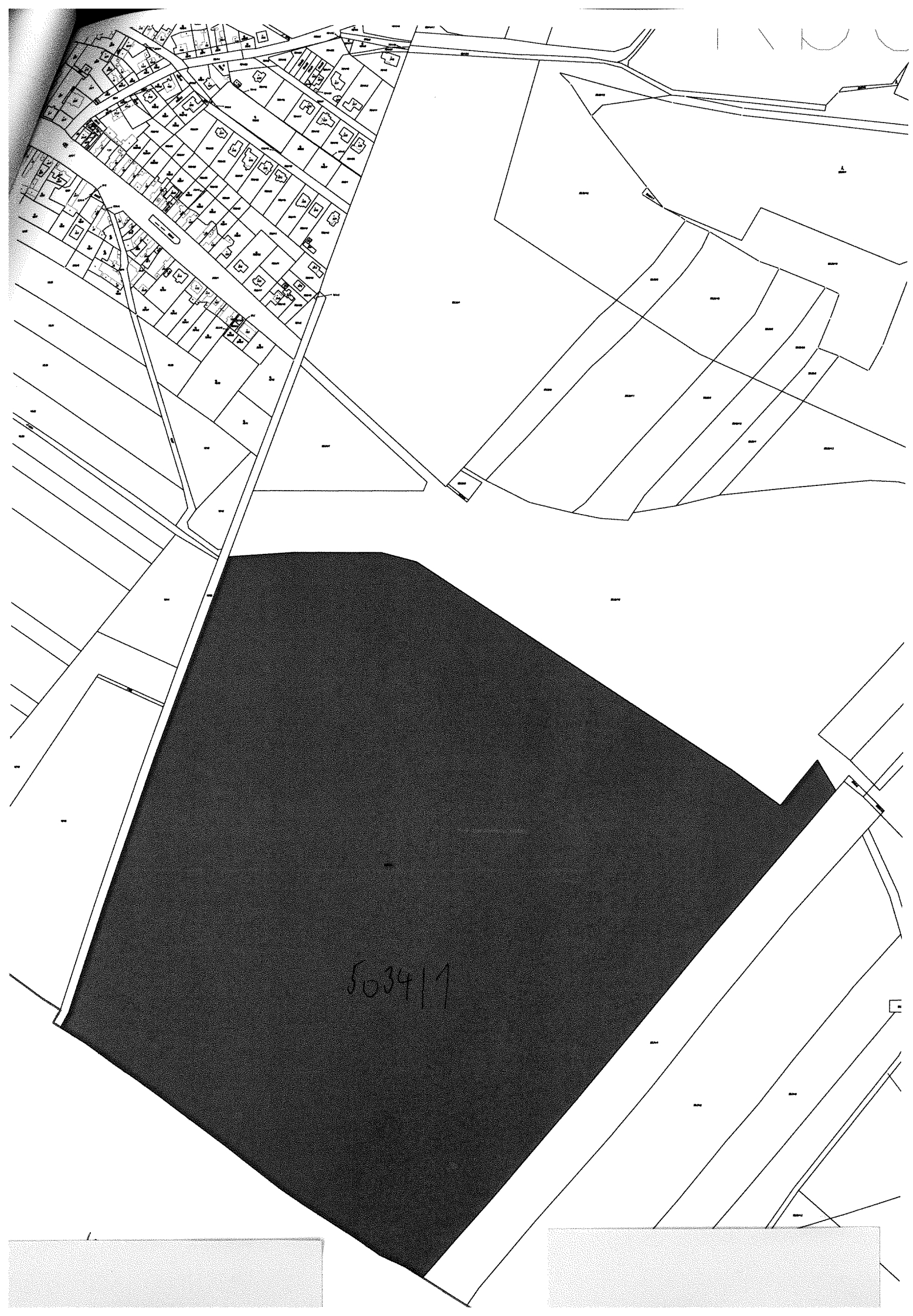

Nad benáteckou cestou

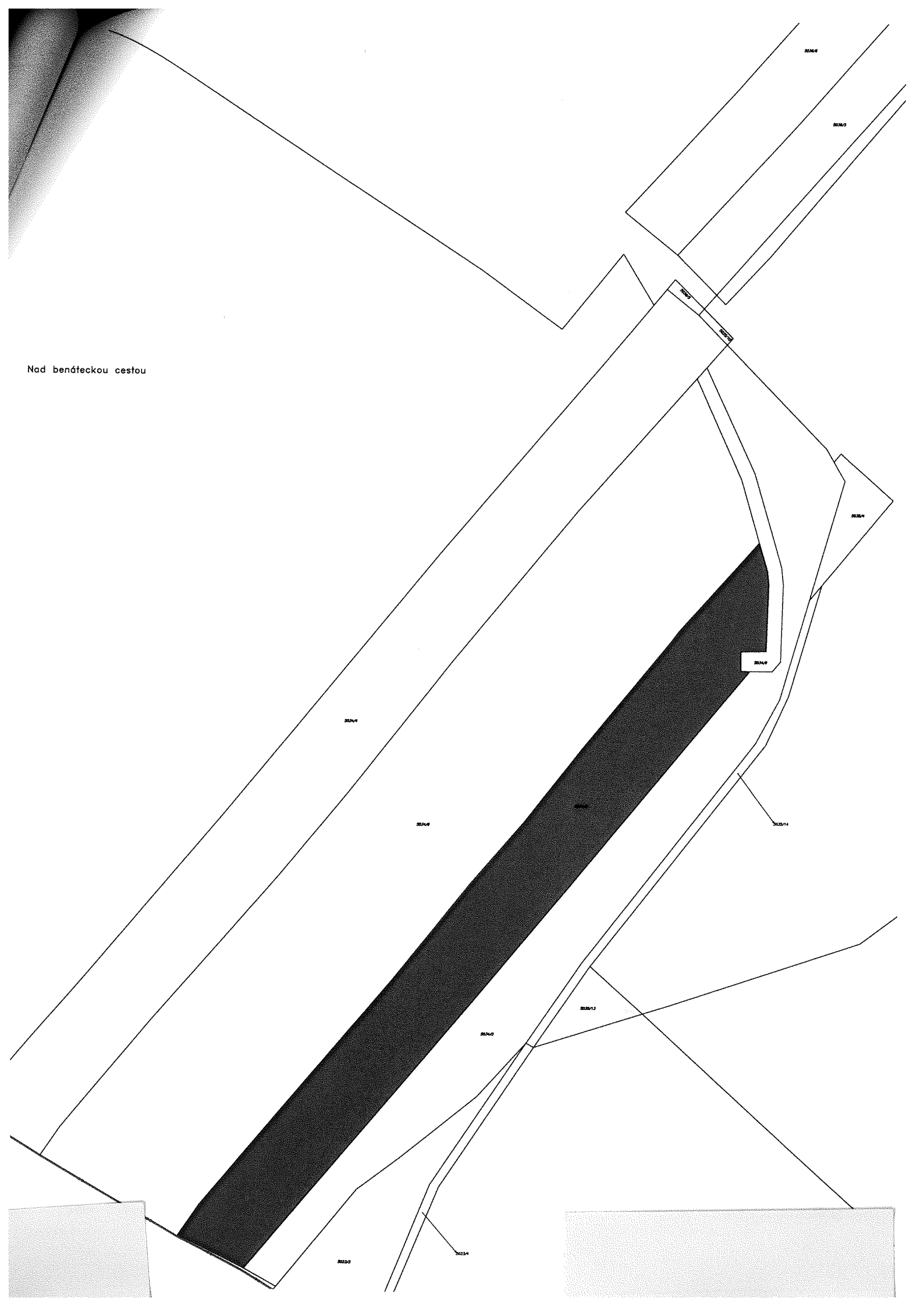

ckou cestou

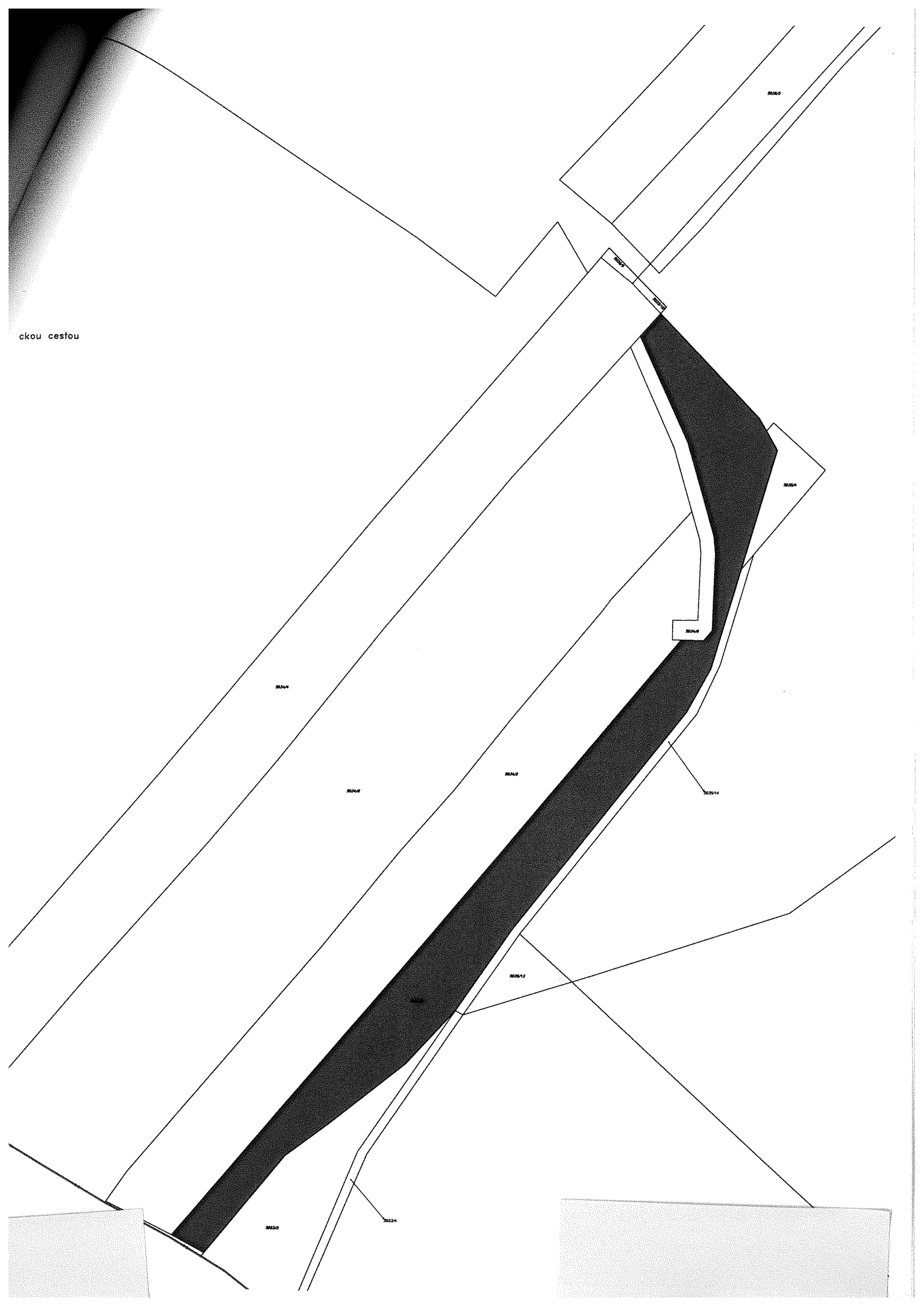

Nad benáteckou cestou

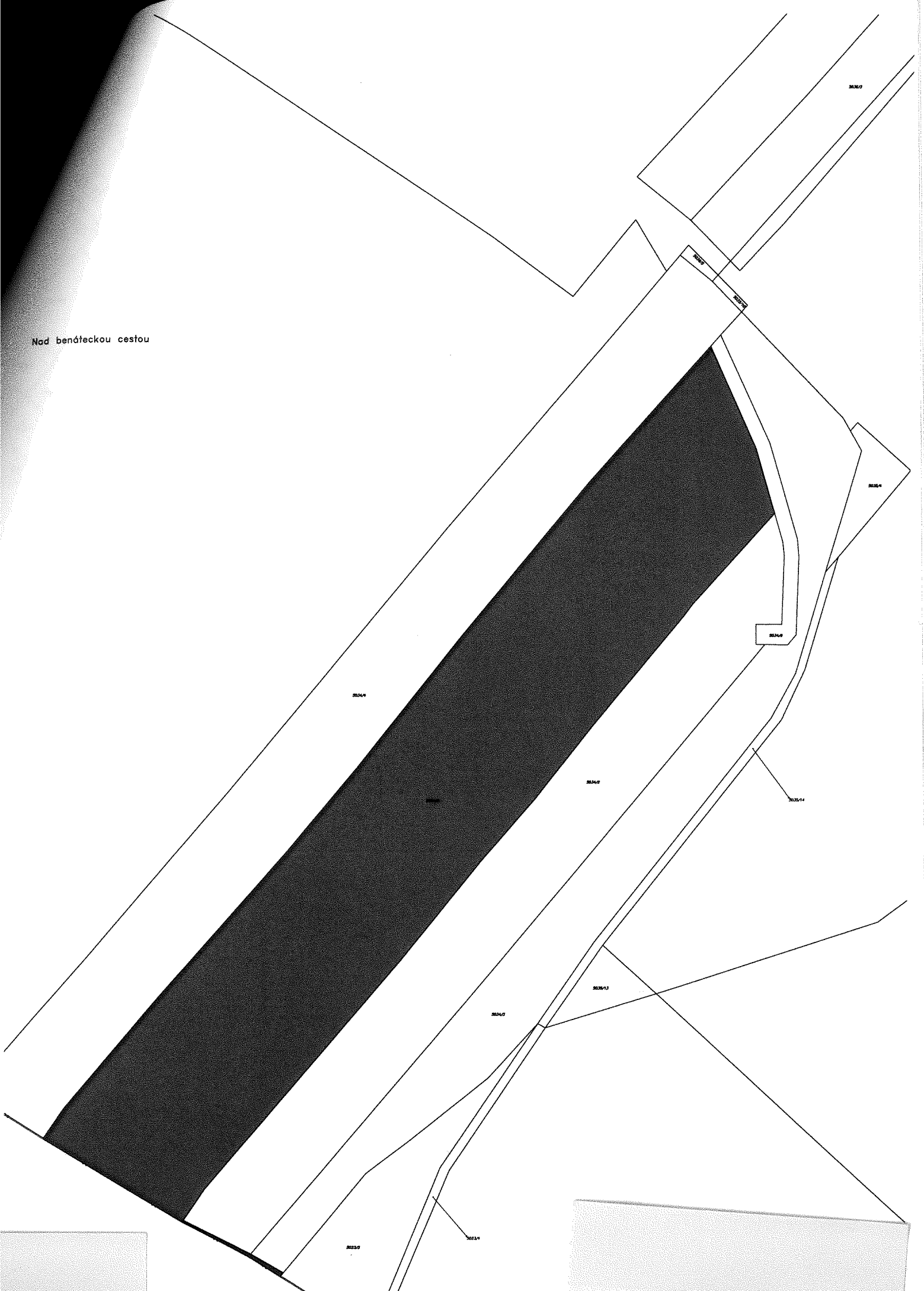



1060

454/10

5044/11

452/5

28/9

866/3

454/8

454/11

870/2

454/9

754/26

754/27

5043/8

249

754/6

754/28

754/2

754/10

754/13

754/11

754/12

754/13

754/14

754/9

754/15

754/18

754/17

754/18

754/19

754/20

755/6

755/3

754/18

754/17

754/18

754/19

754/20

756/24

756/35

756/36

756/37

756/38

756/39

756/40

756/27

756/28

756/29

756/30

756/31

756/32

756/33

756/7

756/6

756/5

756/4

756/3

756/2

756/1

758/1

758/2

758/3

758/4

758/5

758/6

758/7

758/4

758/3

758/2

758/1

758/0

758/9

758/8

758/1

758/2

758/3

758/4

758/5

758/6

758/7

758/4

758/3

758/2

758/1

758/0

758/9

758/8

758/1

758/2

758/3

758/4

758/5

758/6

758/7

758/4

758/3

758/2

758/1

758/0

758/9

758/8

830/1

758/17

758/18

758/19

758/20

758/21

758/22

764/4

764/3

764/2

833/5

833/3

833/2

833/1

1239

1240

1241

1242

761/2

761/3

5036/1

5036/6

5036/5

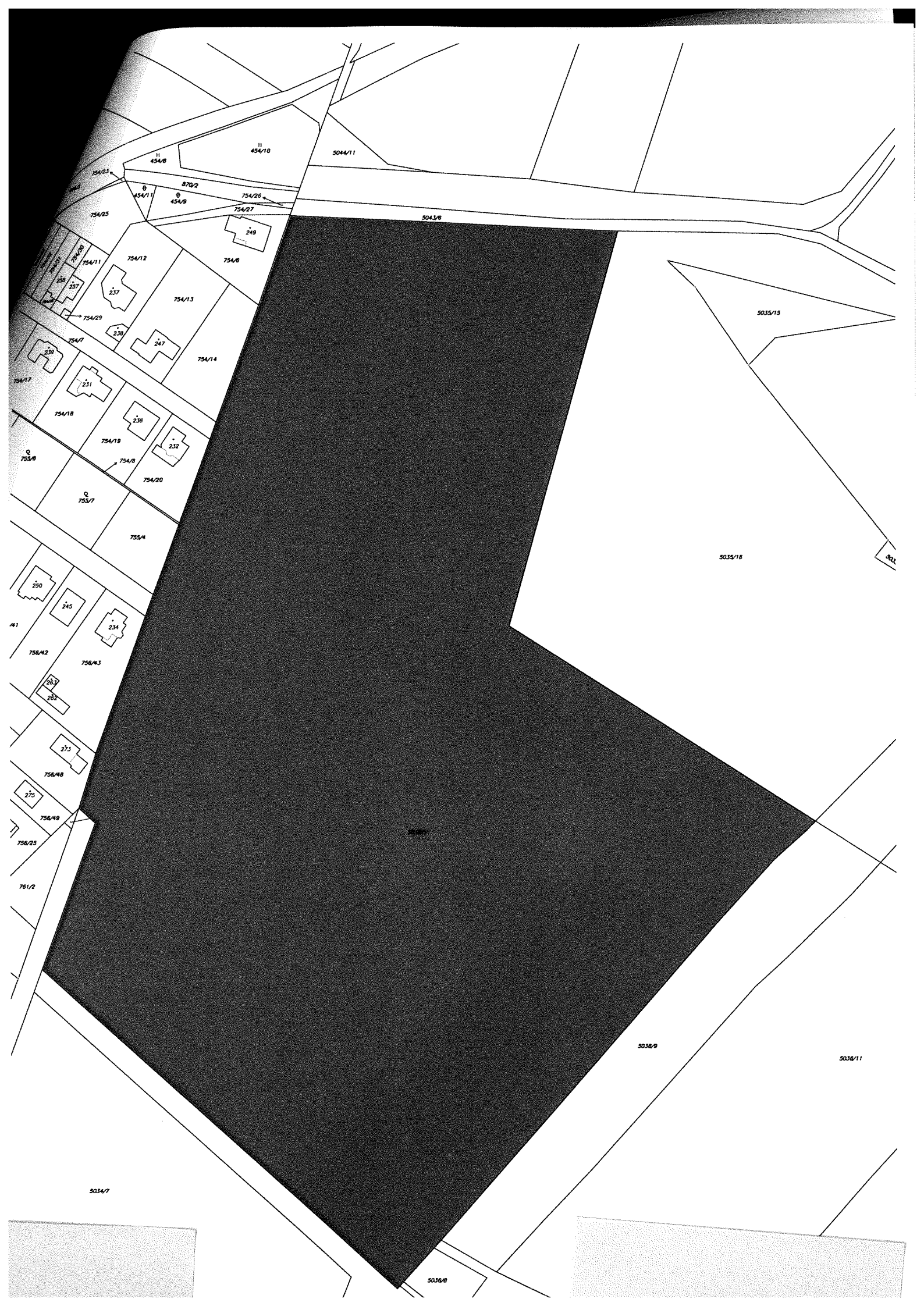

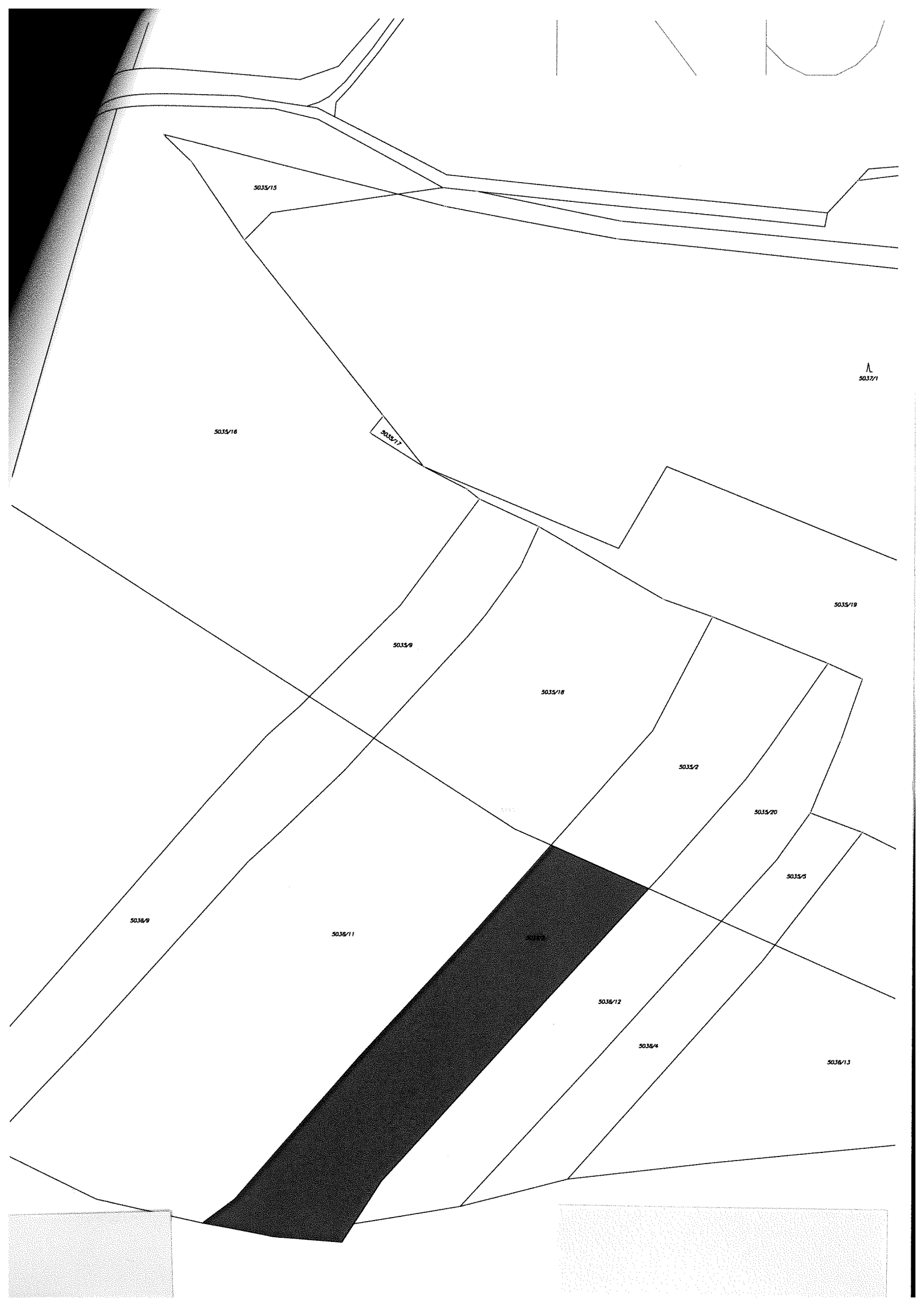

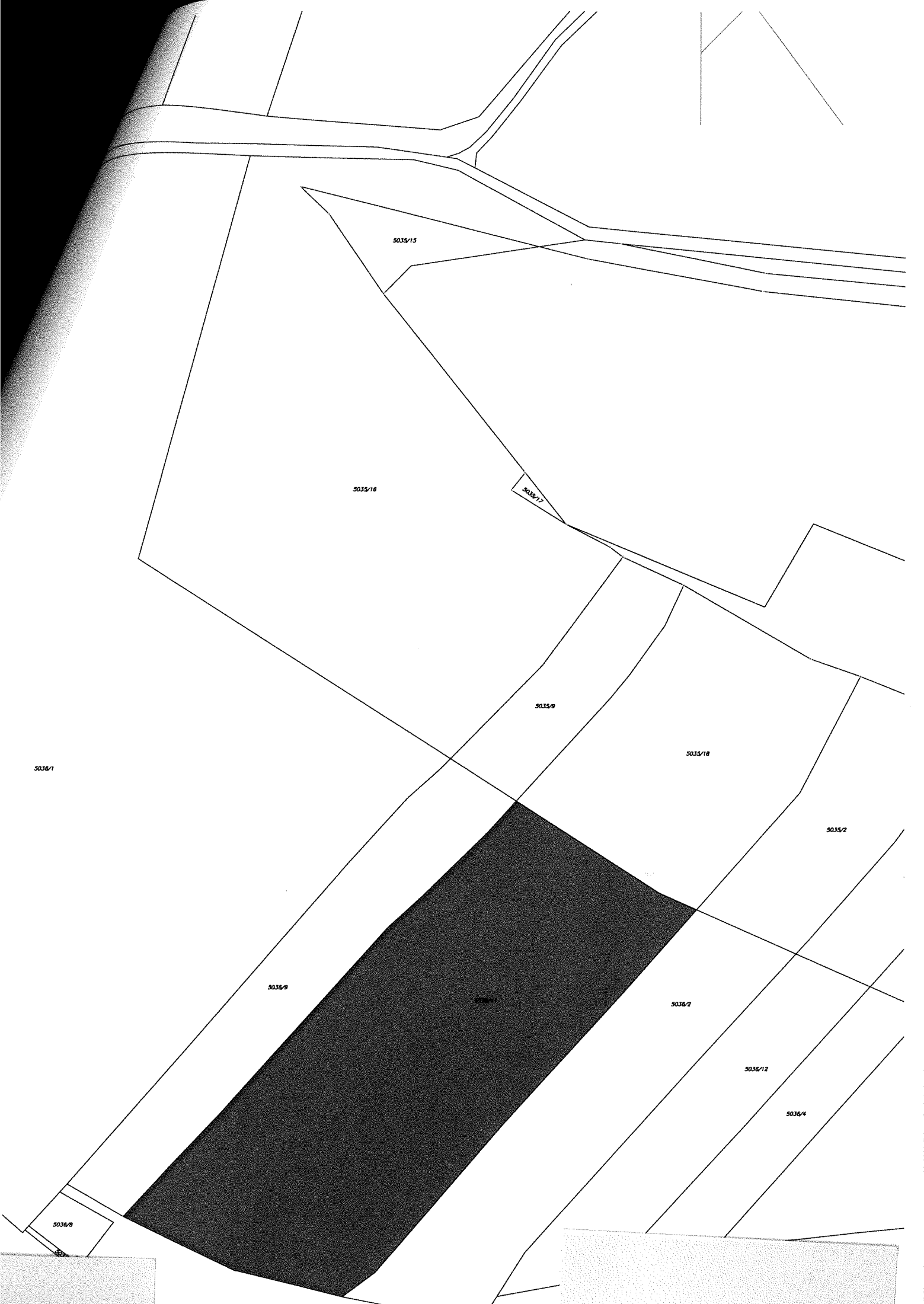

5035/15

5035/16

5035/17

5035/9

5035/18

5035/2

5036/1

5036/9

5036/1

5036/2

5036/12

5036/4

5036/8

5035/18

5035/2

50

5036/11

5036/2

5036/12

5036/4

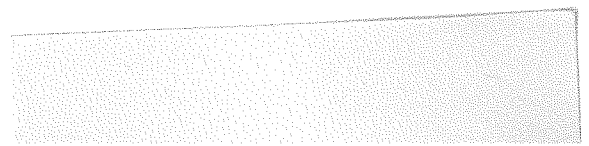
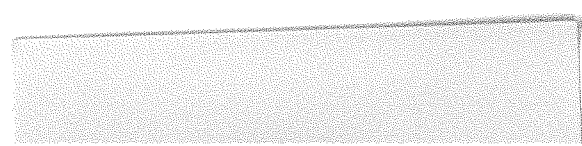

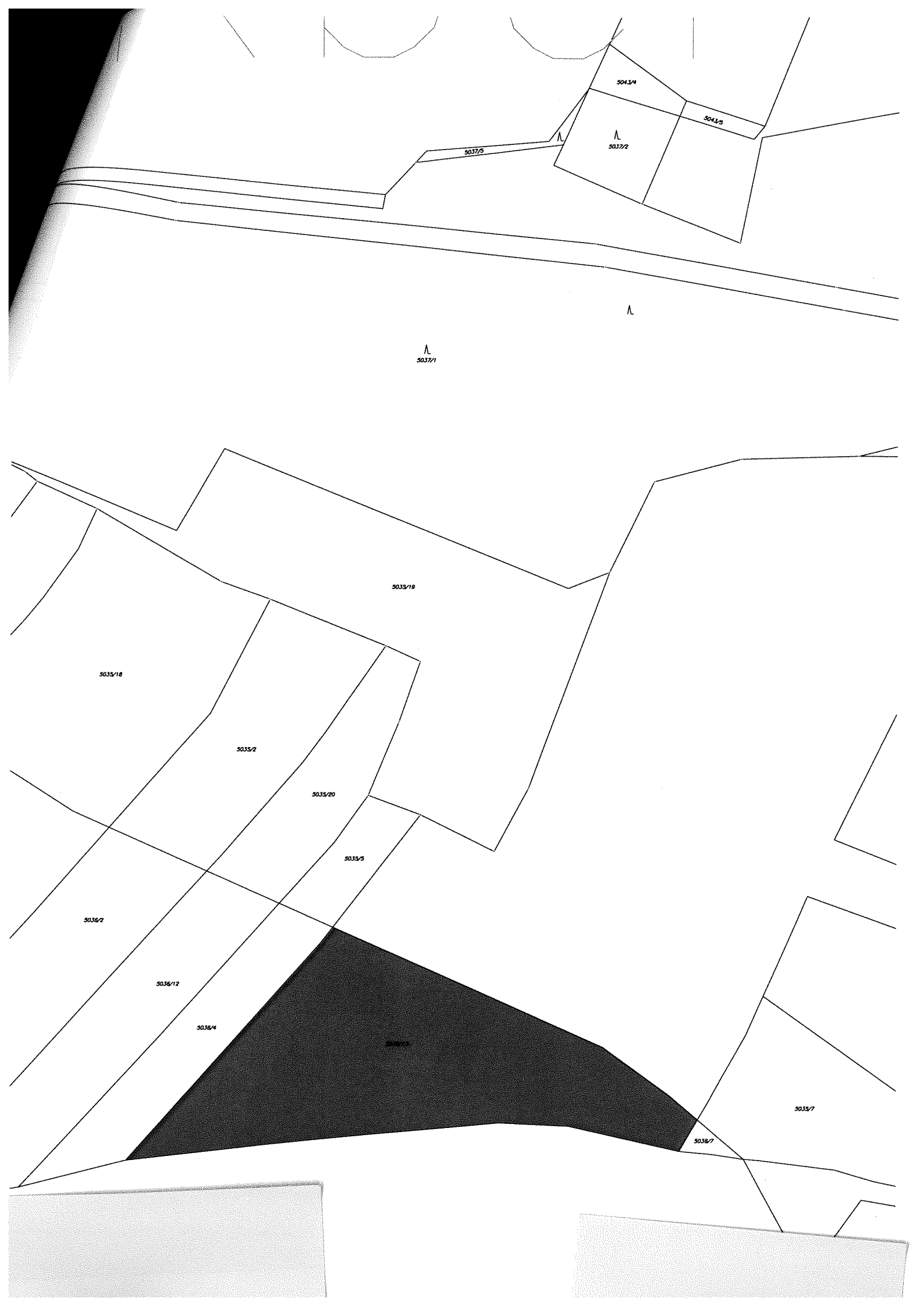

Trnávka

Na Dražicku

Zajčkův šrofk

504911

Kbela

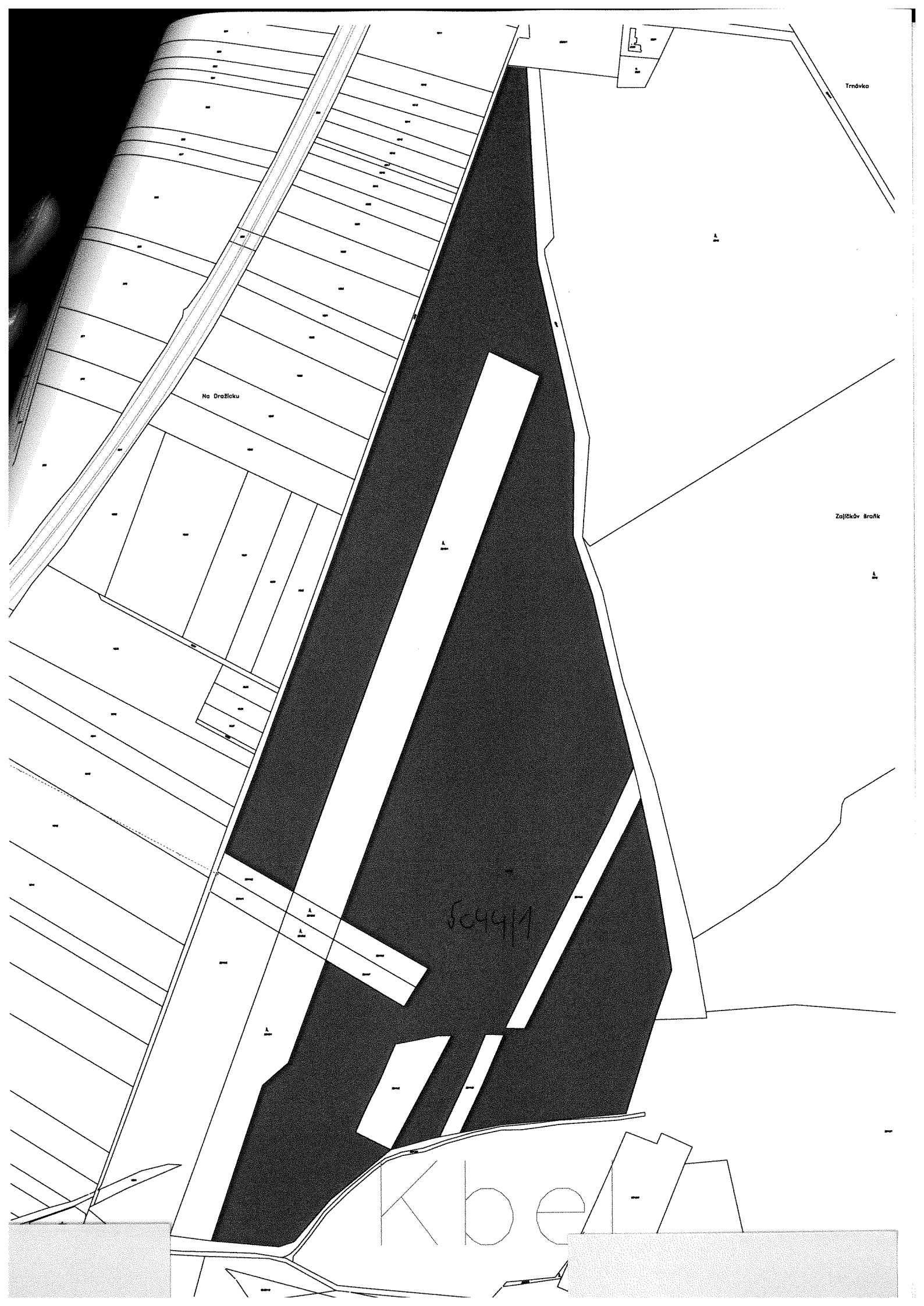

5044/6

5044/7

5044/2

5044/8

5043/8

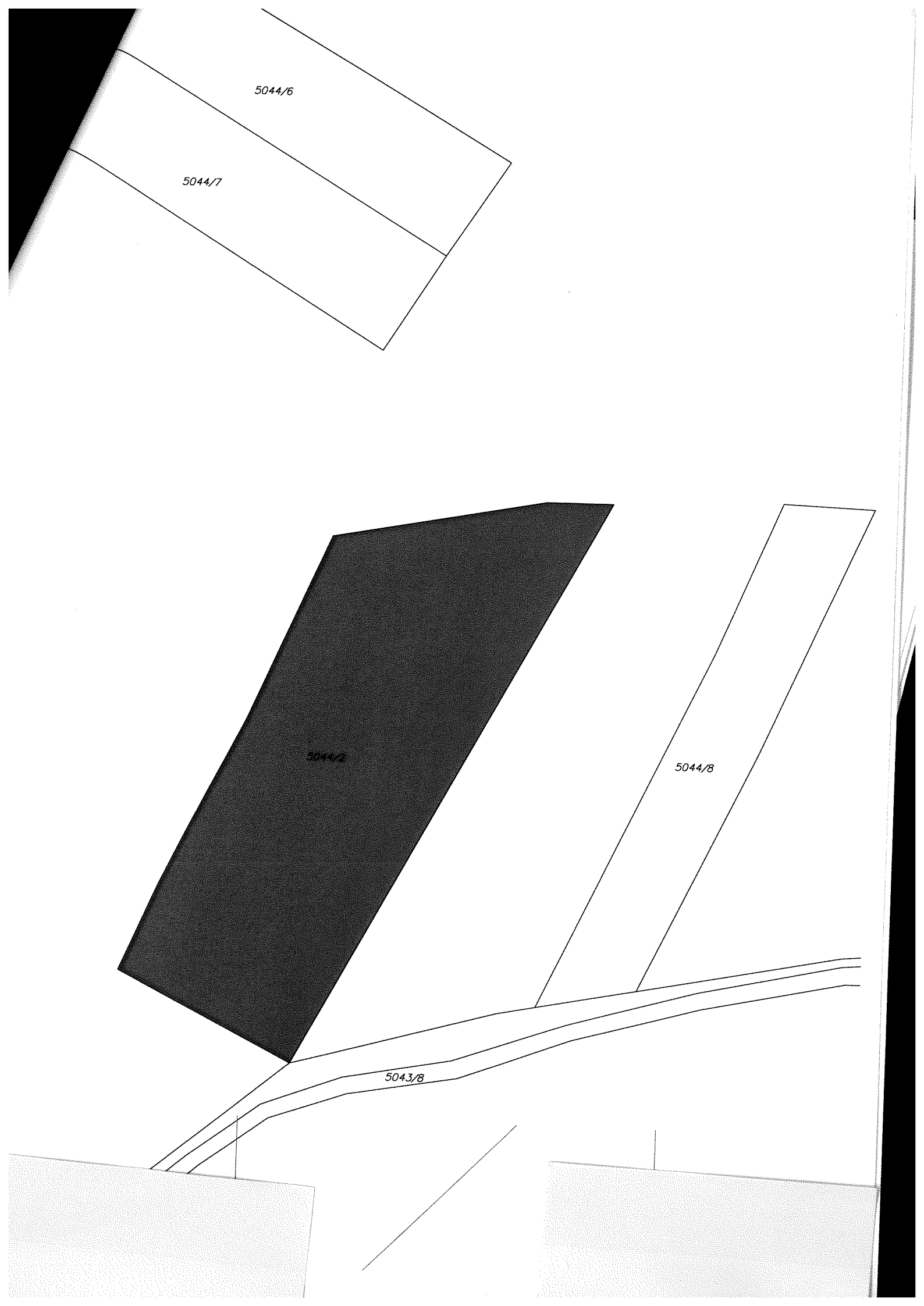

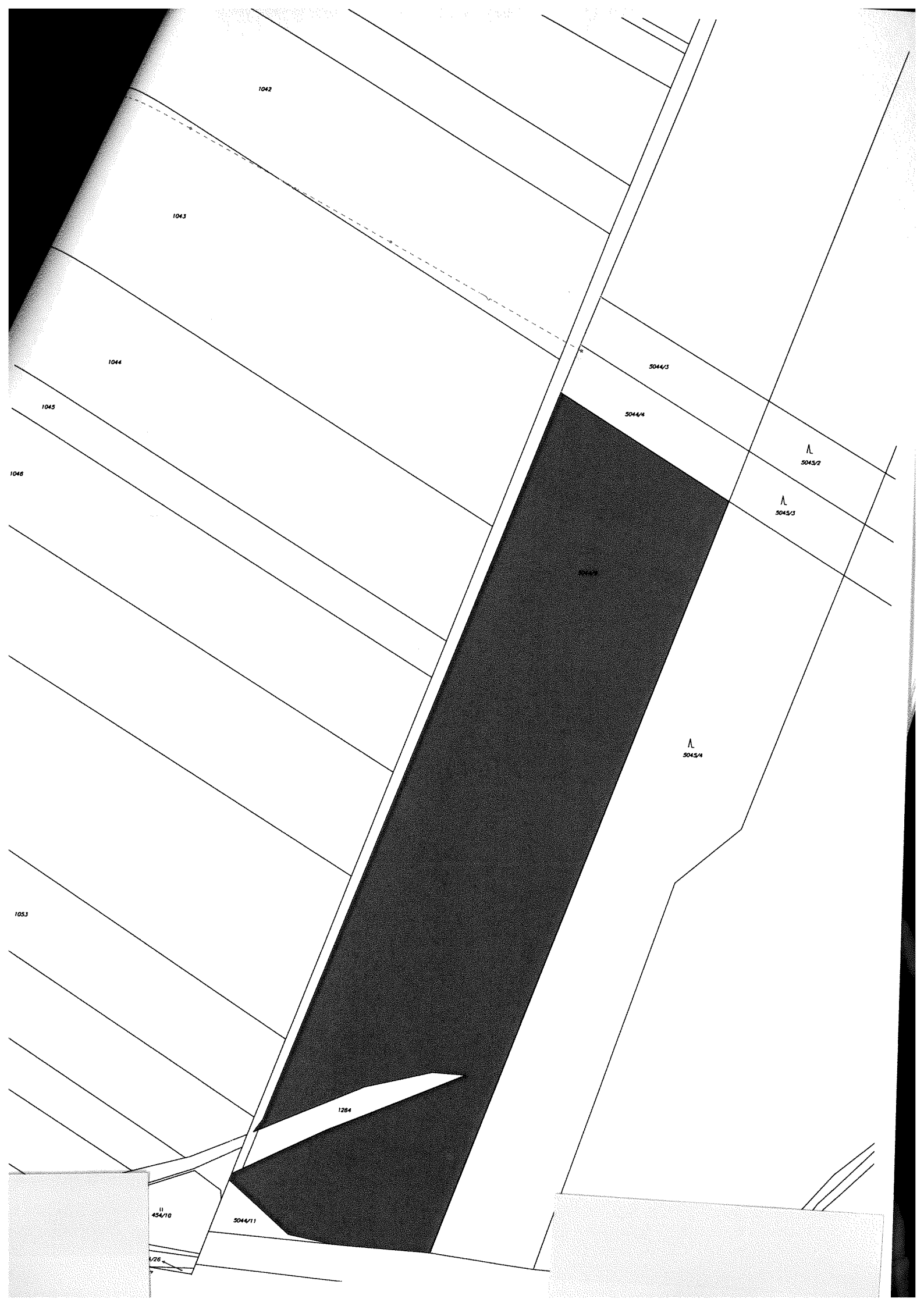

1042

1043

1044

1045

1046

1053

5044/3

5044/4

5044/5

A
5045/2

L
5045/3

L
5045/4

1264

11
454/10

5044/11

1/26