

VÝKAZ DOSAVADNÍHO A NOVÉHO STAVU ÚDAJŮ KATASTRU NEMOVITOSTÍ

Dosavadní stav			Nový stav												
Označení pozemku parc. číslem	Výměra parcely		Druh pozemku	Označení pozemku parc. číslem	Výměra parcely		Druh pozemku	Typ stavby	Způsob určení výměr	Porovnání se stavem evidence právních vztahů					
	ha	m ²	Způsob využití		ha	m ²	Způsob využití	Způsob využití		Díl přechází z pozemku označeného v		Číslo listu vlastnictví	Výměra dílu		Označení dílu
										katastru nemovitostí	dřívější poz. evidenci			ha	
2651										2651		4286			
2743										2743		1			
2747										2747		1			
2863/3										2863/3		1			
2863/51										2863/51		1			
2863/53										2863/53		1			
2863/56										2863/56		1			
2863/98										2863/98		1			
2867/1										2867/1		1			
2868/1										2868/1		1			
2868/2										2868/2		1			
2871/5										2871/5		1			
5620/1										5620/1		1			
5685										5685		1			

Druh věcného břemene: dle příložených listin.

Oprávněný: dle příložených listin

GEOMETRICKÝ PLÁN	Geometrický plán ověřil úředně oprávněný zeměměřický inženýr	Stejnopis ověřil úředně oprávněný zeměměřický inženýr:
pro vymezení rozsahu věcného břemene k části pozemku	Jméno, příjmení:	Jméno, příjmení:
	Číslo položky seznamu úředně oprávněných zeměměřických inženýrů 2490/10	Číslo položky seznamu úředně oprávněných zeměměřických inženýrů
	Dne: 26.4.2024 Číslo: 553/2024	Dne: Číslo:
	Náležitostmi a přesností odpovídá právním předpisům.	Tento stejnopis odpovídá geometrickému plánu v elektronické podobě uloženému v dokumentaci katastrálního úřadu.
Vyhotovitel: GEO75 s.r.o., IČ27699579 Sokolova 32, 619 00 Brno www.geo75.cz 737 432 573	Katastrální úřad souhlasí s očíslováním parcel. nÚ pro Vysočinu, KP Velké Meziříčí PGP-362/2024-746 2024.05.06 11:14:26 +02'00'	Ověření stejnopisu geometrického plánu v listinné podobě.
Číslo plánu: 6331-6043/2024		
Okres: Žďár nad Sázavou		
Obec: Velké Meziříčí		
Kat. území: Velké Meziříčí		
Mapový list: Velké Meziříčí 5-9/11, 5-9/13		
Dosavadním vlastníkům pozemků byla poskytnuta možnost seznámit se v terénu s průběhem navrhovaných nových hranic, které byly označeny předepsaným způsobem: nestabilizováno		

Seznam souřadnic (S-JTSK):

Souřadnice pro zápis do KN

Číslo bodu	Y	X	kk
872-4	639644.02	1138548.82	3
3456-111	639735.59	1138544.25	3
3456-134	639721.09	1138525.21	3
3804-8	639821.41	1138510.20	3
3804-42	639856.97	1138494.54	3
3804-43	639855.53	1138495.92	3
1	639867.78	1138432.41	3
2	639867.78	1138432.91	3
3	639873.83	1138432.52	3
4	639873.62	1138433.02	3
5	639874.23	1138433.04	3
6	639874.49	1138433.71	3
7	639874.01	1138433.83	3
8	639874.99	1138437.60	3
9	639874.49	1138437.68	3
10	639875.22	1138438.79	3
11	639874.73	1138438.86	3
12	639875.59	1138441.53	3
13	639875.09	1138441.63	3
14	639876.03	1138442.98	3
15	639875.53	1138443.08	3
16	639876.49	1138448.08	3
17	639875.99	1138448.14	3
18	639877.24	1138452.85	3
19	639876.74	1138452.93	3
20	639878.20	1138459.69	3
21	639877.70	1138459.75	3
22	639878.66	1138464.27	3
23	639878.16	1138464.33	3
24	639879.38	1138468.60	3
25	639878.88	1138468.64	3
26	639879.41	1138469.89	3
27	639878.91	1138469.85	3
28	639879.14	1138471.16	3
29	639878.66	1138471.02	3
30	639878.73	1138472.34	3
31	639878.29	1138472.06	3
32	639877.86	1138473.19	3
33	639877.54	1138472.79	3
34	639876.30	1138474.16	3
35	639876.02	1138473.76	3
36	639872.51	1138477.16	3
37	639872.23	1138476.74	3
38	639870.78	1138478.20	3
39	639870.48	1138477.80	3
40	639869.77	1138479.20	3
41	639869.37	1138478.90	3
42	639869.18	1138480.39	3
43	639868.70	1138480.21	3
44	639868.85	1138481.78	3
45	639868.35	1138481.72	3
46	639868.84	1138483.48	3
47	639868.34	1138483.54	3
48	639869.43	1138485.71	3
49	639868.93	1138485.79	3
50	639869.46	1138486.53	3
51	639868.96	1138486.33	3
52	639869.03	1138486.94	3
53	639868.75	1138486.52	3
54	639868.36	1138486.71	3
55	639868.54	1138487.17	3
56	639865.53	1138487.75	3
57	639865.67	1138488.23	3
58	639862.89	1138488.80	3
59	639862.73	1138488.32	3
60	639862.20	1138489.12	3
61	639861.92	1138488.70	3
62	639861.63	1138489.62	3
63	639861.27	1138489.28	3
64	639859.37	1138492.53	3
65	639858.99	1138492.21	3
66	639773.60	1138521.86	3
67	639856.89	1138495.38	3
68	639773.58	1138521.36	3
69	639854.42	1138497.62	3
70	639854.12	1138497.22	3
71	639852.58	1138498.79	3
72	639852.34	1138498.35	3
73	639849.27	1138500.21	3
74	639849.07	1138499.75	3
75	639843.66	1138502.66	3
76	639843.46	1138502.20	3
77	639839.12	1138504.51	3
78	639838.94	1138504.05	3
79	639834.71	1138506.21	3

Seznam souřadnic (S-JTSK):

Souřadnice pro zápis do KN

Číslo bodu	Y	X	kk
80	639834.53	1138505.75	3
81	639831.62	1138507.44	3
82	639831.43	1138506.99	3
83	639829.58	1138508.37	3
84	639829.37	1138507.88	3
85	639826.11	1138509.68	3
86	639825.91	1138509.22	3
87	639824.35	1138510.47	3
88	639824.13	1138510.03	3
89	639823.64	1138510.89	3
90	639823.36	1138510.47	3
91	639822.92	1138511.46	3
92	639822.54	1138511.06	3
93	639823.08	1138511.66	3
94	639822.62	1138511.90	3
95	639823.34	1138512.57	3
96	639822.84	1138512.65	3
97	639823.37	1138515.83	3
98	639822.87	1138515.93	3
99	639824.11	1138517.86	3
100	639823.71	1138518.36	3
101	639825.24	1138517.86	3
102	639825.32	1138518.36	3
103	639822.31	1138511.52	3
104	639821.03	1138510.60	3
105	639821.22	1138510.09	3
106	639820.44	1138510.72	3
107	639820.26	1138510.24	3
108	639819.75	1138511.07	3
109	639819.59	1138510.59	3
110	639818.56	1138511.30	3
111	639818.50	1138510.80	3
112	639816.92	1138511.40	3
113	639816.87	1138510.90	3
114	639815.94	1138511.54	3
115	639815.84	1138511.04	3
116	639813.82	1138512.15	3
117	639813.62	1138511.69	3
118	639812.71	1138512.85	3
119	639812.53	1138512.37	3
120	639810.51	1138513.20	3
121	639810.41	1138512.70	3
122	639808.67	1138513.55	3
123	639808.55	1138513.07	3
124	639806.67	1138514.11	3
125	639806.51	1138513.63	3
126	639805.19	1138514.68	3
127	639805.05	1138514.20	3
128	639803.44	1138515.07	3
129	639803.32	1138514.59	3
130	639800.79	1138515.75	3
131	639800.69	1138515.27	3
132	639798.10	1138516.24	3
133	639798.02	1138515.74	3
134	639795.56	1138516.70	3
135	639795.48	1138516.20	3
136	639791.29	1138517.48	3
137	639791.19	1138516.98	3
138	639787.68	1138518.25	3
139	639787.60	1138517.75	3
140	639784.98	1138518.44	3
141	639784.88	1138517.94	3
142	639782.84	1138519.08	3
143	639782.76	1138518.58	3
144	639781.01	1138519.17	3
145	639781.14	1138518.66	3
146	639780.45	1138515.79	3
147	639779.96	1138515.87	3
148	639780.66	1138518.78	3
149	639779.35	1138519.42	3
150	639779.55	1138519.88	3
151	639777.29	1138520.16	3
152	639777.45	1138520.64	3
153	639775.00	1138520.84	3
154	639775.18	1138521.30	3
155	639774.16	1138521.23	3
156	639774.32	1138521.71	3
157	639772.94	1138521.26	3
158	639772.94	1138521.76	3
159	639772.29	1138521.37	3
160	639772.35	1138521.87	3
161	639770.38	1138521.48	3
162	639770.44	1138521.98	3
163	639768.10	1138521.84	3
164	639768.56	1138522.28	3

Seznam souřadnic (S-JTSK):

Souřadnice pro zápis do KN

Číslo bodu	Y	X	kk
165	639767.85	1138522.22	3
166	639768.13	1138522.72	3
167	639766.35	1138522.27	3
168	639766.37	1138522.77	3
169	639761.45	1138522.54	3
170	639761.41	1138523.04	3
171	639760.06	1138522.18	3
172	639759.96	1138522.68	3
173	639758.24	1138521.96	3
174	639758.12	1138522.44	3
175	639757.74	1138521.75	3
176	639757.52	1138522.21	3
177	639756.04	1138520.81	3
178	639755.82	1138521.25	3
179	639753.80	1138519.81	3
180	639753.52	1138520.23	3
181	639753.33	1138519.35	3
182	639753.03	1138519.75	3
183	639752.55	1138518.99	3
184	639752.53	1138519.53	3
185	639750.80	1138519.41	3
186	639750.94	1138519.89	3
187	639748.73	1138520.20	3
188	639748.85	1138520.68	3
189	639747.09	1138520.41	3
190	639747.17	1138520.91	3
191	639743.43	1138521.07	3
192	639743.43	1138521.57	3
193	639742.97	1138521.00	3
194	639742.59	1138519.86	3
195	639742.10	1138519.95	3
196	639742.38	1138520.83	3
197	639741.65	1138520.85	3
198	639741.71	1138521.35	3
199	639739.11	1138521.29	3
200	639739.21	1138521.79	3
201	639736.35	1138521.88	3
202	639736.43	1138522.38	3
203	639734.19	1138522.21	3
204	639734.25	1138522.71	3
205	639732.29	1138522.45	3
206	639732.60	1138522.92	3
207	639732.10	1138522.97	3
208	639732.76	1138524.14	3
209	639732.26	1138524.22	3
210	639733.13	1138525.95	3
211	639732.63	1138526.03	3
212	639733.42	1138527.95	3
213	639732.92	1138528.05	3
214	639733.98	1138530.46	3
215	639733.48	1138530.56	3
216	639734.51	1138533.51	3
217	639734.01	1138533.61	3
218	639735.41	1138539.78	3
219	639734.91	1138539.84	3
220	639735.93	1138543.80	3
221	639735.45	1138543.96	3
222	639736.22	1138544.33	3
223	639735.76	1138544.51	3
224	639736.77	1138546.38	3
225	639736.27	1138546.42	3
226	639736.64	1138548.35	3
227	639736.14	1138548.35	3
228	639736.70	1138549.29	3
229	639736.20	1138549.33	3
230	639737.00	1138551.91	3
231	639736.50	1138551.99	3
232	639737.42	1138554.16	3
233	639736.94	1138554.26	3
234	639738.06	1138556.64	3
235	639737.58	1138556.76	3
236	639738.36	1138557.83	3
237	639737.93	1138558.16	3
238	639738.46	1138558.32	3
239	639738.10	1138559.19	3
240	639738.60	1138559.13	3
241	639738.18	1138560.07	3
242	639738.68	1138560.11	3
243	639737.99	1138560.40	3
244	639738.57	1138560.60	3
245	639738.21	1138560.86	3
246	639737.33	1138561.13	3
247	639737.21	1138560.65	3
248	639736.23	1138560.80	3
249	639736.33	1138561.29	3

Seznam souřadnic (S-JTSK):

Souřadnice pro zápis do KN

Číslo bodu	Y	X	kk
250	639739.59	1138557.66	3
251	639739.61	1138558.16	3
252	639740.94	1138557.76	3
253	639740.92	1138558.26	3
254	639742.46	1138557.74	3
255	639742.48	1138558.24	3
256	639744.37	1138557.58	3
257	639744.47	1138558.08	3
258	639745.51	1138557.25	3
259	639745.51	1138557.77	3
260	639746.22	1138557.47	3
261	639746.10	1138557.95	3
262	639749.17	1138558.10	3
263	639749.15	1138558.60	3
264	639751.06	1138557.85	3
265	639751.16	1138558.35	3
266	639752.75	1138557.45	3
267	639752.85	1138557.93	3
268	639755.52	1138556.89	3
269	639755.56	1138557.39	3
270	639758.27	1138556.85	3
271	639758.10	1138557.36	3
272	639760.03	1138561.52	3
273	639760.54	1138561.44	3
274	639758.67	1138557.39	3
275	639759.15	1138557.43	3
276	639758.89	1138556.91	3
277	639760.33	1138555.55	3
278	639759.87	1138555.35	3
279	639760.63	1138554.34	3
280	639760.13	1138554.26	3
281	639760.93	1138551.75	3
282	639760.43	1138551.75	3
283	639760.73	1138548.33	3
284	639760.23	1138548.23	3
285	639760.90	1138547.99	3
286	639760.50	1138547.69	3
287	639761.14	1138547.79	3
288	639760.92	1138547.31	3
289	639763.55	1138547.46	3
290	639763.47	1138546.96	3
291	639730.94	1138522.59	3
292	639731.04	1138523.09	3
293	639729.07	1138523.24	3
294	639729.23	1138523.72	3
295	639726.98	1138523.99	3
296	639727.16	1138524.45	3
297	639725.21	1138524.65	3
298	639725.31	1138525.15	3
299	639721.69	1138525.09	3
300	639721.77	1138525.59	3
301	639721.16	1138525.71	3
302	639719.99	1138525.31	3
303	639720.07	1138525.81	3
304	639717.15	1138525.72	3
305	639717.23	1138526.22	3
306	639714.43	1138526.10	3
307	639714.51	1138526.60	3
308	639712.60	1138526.47	3
309	639712.68	1138526.97	3
310	639710.81	1138526.63	3
311	639710.87	1138527.13	3
312	639709.10	1138526.92	3
313	639709.22	1138527.40	3
314	639707.53	1138527.40	3
315	639707.71	1138527.86	3
316	639707.11	1138527.59	3
317	639707.27	1138528.07	3
318	639702.09	1138528.56	3
319	639702.17	1138529.06	3
320	639700.91	1138529.24	3
321	639700.81	1138528.74	3
322	639696.75	1138529.68	3
323	639696.89	1138530.16	3
324	639693.85	1138530.57	3
325	639693.97	1138531.05	3
326	639693.24	1138530.66	3
327	639693.28	1138531.16	3
328	639692.45	1138530.65	3
329	639691.90	1138530.97	3
330	639692.06	1138531.45	3
331	639691.27	1138531.02	3
332	639691.25	1138531.52	3
333	639690.42	1138530.85	3
334	639690.40	1138531.35	3

Seznam souřadnic (S-JTSK):

Souřadnice pro zápis do KN

Číslo bodu	Y	X	kk
335	639689.02	1138530.98	3
336	639689.16	1138531.46	3
337	639687.88	1138531.61	3
338	639688.03	1138532.09	3
339	639686.28	1138531.75	3
340	639686.34	1138532.25	3
341	639684.65	1138532.04	3
342	639684.75	1138532.52	3
343	639682.80	1138532.51	3
344	639682.92	1138532.99	3
345	639681.53	1138532.85	3
346	639681.63	1138533.35	3
347	639692.59	1138531.15	3
348	639679.25	1138533.68	3
349	639679.17	1138533.18	3
350	639676.10	1138534.27	3
351	639676.02	1138533.77	3
352	639674.74	1138534.44	3
353	639674.70	1138533.94	3
354	639673.34	1138534.50	3
355	639673.22	1138534.02	3
356	639672.41	1138534.69	3
357	639672.19	1138534.23	3
358	639671.62	1138535.34	3
359	639671.40	1138534.88	3
360	639667.20	1138536.48	3
361	639667.12	1138535.98	3
362	639666.72	1138536.51	3
363	639666.74	1138536.01	3
364	639666.04	1138536.43	3
365	639666.04	1138535.93	3
366	639665.59	1138536.48	3
367	639665.45	1138536.00	3
368	639664.89	1138536.83	3
369	639664.63	1138536.39	3
370	639664.26	1138537.27	3
371	639663.92	1138536.91	3
372	639663.80	1138537.85	3
373	639663.38	1138537.57	3
374	639663.38	1138538.63	3
375	639662.90	1138538.47	3
376	639663.30	1138539.05	3
377	639662.80	1138539.01	3
378	639663.33	1138539.45	3
379	639662.83	1138539.53	3
380	639663.65	1138540.69	3
381	639663.15	1138540.79	3
382	639663.73	1138541.37	3
383	639663.21	1138541.29	3
384	639662.76	1138543.48	3
385	639662.40	1138543.10	3
386	639662.21	1138543.73	3
387	639662.03	1138543.27	3
388	639661.21	1138544.04	3
389	639661.11	1138543.55	3
390	639660.04	1138544.20	3
391	639659.96	1138543.70	3
392	639658.23	1138544.52	3
393	639658.13	1138544.04	3
394	639656.68	1138544.91	3
395	639656.54	1138544.43	3
396	639653.04	1138546.03	3
397	639652.90	1138545.49	3
398	639652.88	1138546.45	3
399	639652.52	1138545.84	3
400	639652.38	1138546.39	3
401	639652.35	1138547.22	3
402	639652.85	1138547.36	3
403	639652.16	1138547.57	3
404	639652.56	1138547.87	3
405	639651.76	1138547.95	3
406	639652.06	1138548.35	3
407	639650.48	1138548.72	3
408	639650.70	1138549.18	3
409	639649.73	1138548.93	3
410	639649.85	1138549.41	3
411	639646.63	1138549.54	3
412	639646.73	1138550.02	3
413	639644.76	1138550.01	3
414	639644.52	1138550.57	3
415	639644.79	1138549.59	3
416	639644.45	1138548.76	3
417	639644.25	1138550.10	3
418	639644.29	1138549.67	3
419	639644.06	1138549.12	3

Seznam souřadnic (S-JTSK):

Souřadnice pro zápis do KN

Číslo bodu	Y	X	kk
420	639643.32	1138548.95	3
421	639638.63	1138551.41	3
422	639638.59	1138550.91	3
423	639637.83	1138551.25	3
424	639638.05	1138550.79	3
425	639637.33	1138550.93	3
426	639637.65	1138550.55	3
427	639636.97	1138550.55	3
428	639637.31	1138550.17	3
429	639635.84	1138549.74	3
430	639636.06	1138549.28	3
431	639635.52	1138549.64	3
432	639635.54	1138549.12	3
433	639635.09	1138549.73	3
434	639634.95	1138549.25	3
435	639631.92	1138550.80	3
436	639631.74	1138550.34	3
437	639630.47	1138551.41	3
438	639630.29	1138550.95	3
439	639627.44	1138552.57	3
440	639627.26	1138552.11	3
441	639626.13	1138553.15	3
442	639625.91	1138552.69	3
443	639623.13	1138554.74	3
444	639622.87	1138554.32	3
445	639621.62	1138555.77	3
446	639621.36	1138555.35	3
447	639618.65	1138557.57	3
448	639618.39	1138557.13	3
449	639617.65	1138558.10	3
450	639617.39	1138557.68	3
451	639616.23	1138559.03	3
452	639615.97	1138558.61	3
453	639614.57	1138560.00	3
454	639614.33	1138559.56	3
455	639612.27	1138561.26	3
456	639612.01	1138560.82	3
457	639610.06	1138562.61	3
458	639609.78	1138562.19	3
459	639608.13	1138563.93	3
460	639607.85	1138563.51	3
461	639606.81	1138564.83	3
462	639606.53	1138564.43	3
463	639605.76	1138565.60	3
464	639605.50	1138565.16	3
465	639604.63	1138566.23	3
466	639604.09	1138566.24	3
467	639603.40	1138566.09	3
468	639602.60	1138565.64	3
469	639603.82	1138565.13	3
470	639603.59	1138565.30	3
471	639602.45	1138565.07	3
472	639602.17	1138564.20	3
473	639601.85	1138564.58	3
474	639600.56	1138562.72	3
475	639600.78	1138562.42	3
476	639600.40	1138562.09	3
477	639600.18	1138562.39	3
478	639600.07	1138562.94	3
479	639598.08	1138561.38	3
480	639598.40	1138561.00	3
481	639597.36	1138560.70	3
482	639597.59	1138560.22	3
483	639596.62	1138560.60	3
484	639596.82	1138560.12	3
485	639595.44	1138559.37	3
486	639595.80	1138559.01	3
487	639590.01	1138554.53	3
488	639590.43	1138554.23	3
489	639589.75	1138553.86	3
490	639590.19	1138553.64	3
491	639589.35	1138553.21	3
492	639589.75	1138552.91	3
493	639588.57	1138552.38	3
494	639588.91	1138552.02	3
495	639584.36	1138548.76	3
496	639584.70	1138548.38	3
497	639583.35	1138547.80	3
498	639583.73	1138547.46	3
499	639582.25	1138546.57	3
500	639582.64	1138546.26	3
501	639570.04	1138546.23	3
502	639570.36	1138545.85	3
503	639573.05	1138548.77	3
504	639573.41	1138548.41	3

Seznam souřadnic (S-JTSK):

Souřadnice pro zápis do KN			
Číslo bodu	Y	X	kk
505	639574.14	1138550.06	3
506	639574.46	1138549.62	3
507	639576.41	1138552.06	3
508	639576.62	1138551.54	3
509	639576.97	1138552.04	3
510	639577.21	1138551.54	3
511	639577.42	1138552.60	3
512	639577.84	1138552.32	3
513	639577.74	1138553.23	3
514	639578.14	1138552.92	3
515	639582.84	1138557.07	3
516	639585.31	1138559.34	3
517	639584.97	1138559.70	3
518	639587.95	1138561.84	3
519	639587.61	1138562.20	3
520	639592.29	1138565.82	3
521	639591.95	1138566.18	3
522	639594.91	1138568.20	3
523	639594.39	1138568.41	3
524	639594.30	1138568.51	3
525	639594.67	1138568.85	3
526	639594.76	1138568.75	3
527	639596.95	1138570.72	3
528	639597.21	1138570.28	3
529	639597.25	1138570.82	3
530	639597.74	1138570.70	3
531	639598.06	1138570.46	3
532	639597.39	1138570.34	3
533	639597.72	1138570.08	3
534	639597.89	1138571.07	3
535	639597.47	1138571.37	3
536	639600.88	1138573.68	3
537	639600.54	1138574.04	3
538	639601.56	1138574.36	3
539	639601.13	1138574.63	3
540	639601.11	1138574.82	3
541	639601.56	1138575.24	3
542	639601.58	1138575.06	3
543	639605.76	1138578.91	3
544	639606.10	1138578.53	3
545	639607.87	1138580.73	3
546	639608.21	1138580.35	3
547	639612.32	1138584.73	3
548	639612.11	1138585.05	3
549	639612.49	1138585.40	3
550	639612.70	1138585.07	3
551	639613.27	1138585.58	3
552	639613.61	1138585.22	3
553	639616.27	1138588.48	3
554	639616.67	1138588.16	3
555	639616.84	1138589.43	3
556	639617.22	1138589.09	3
557	639619.76	1138591.82	3
558	639620.08	1138591.44	3
559	639623.15	1138594.74	3
560	639623.52	1138594.39	3
561	639623.51	1138595.70	3
562	639624.34	1138596.49	3
563	639623.89	1138595.28	3
564	639625.29	1138595.68	3
565	639624.91	1138596.02	3
566	639625.57	1138596.15	3
567	639625.17	1138596.45	3
568	639627.33	1138598.11	3
569	639626.97	1138598.47	3
570	639629.47	1138600.10	3
571	639629.13	1138600.48	3
572	639633.56	1138603.71	3
573	639633.22	1138604.07	3
574	639636.26	1138606.39	3
575	639635.92	1138606.75	3
576	639642.62	1138612.06	3
577	639642.09	1138612.29	3
578	639641.60	1138612.84	3
579	639641.97	1138613.18	3
580	639642.48	1138612.61	3
581	639643.31	1138613.38	3
582	639643.65	1138613.02	3
583	639646.61	1138616.50	3
584	639646.97	1138616.14	3
585	639649.04	1138619.00	3
586	639649.51	1138618.76	3
587	639648.78	1138619.67	3
588	639649.18	1138620.05	3
589	639649.43	1138619.39	3

Seznam souřadnic (S-JTSK):

Souřadnice pro zápis do KN			
Číslo bodu	Y	X	kk
590	639652.30	1138621.48	3
591	639651.94	1138621.84	3
592	639654.40	1138623.61	3
593	639654.06	1138623.97	3
594	639659.59	1138628.37	3
595	639659.25	1138628.75	3
596	639663.43	1138631.75	3
597	639662.95	1138631.99	3
598	639663.53	1138632.59	3
599	639663.02	1138632.53	3
600	639662.07	1138636.96	3
601	639661.59	1138636.82	3
602	639660.80	1138641.39	3
603	639660.32	1138641.25	3
604	639660.38	1138642.71	3
605	639659.90	1138642.57	3
606	639659.80	1138644.77	3
607	639659.32	1138644.65	3
608	639659.26	1138647.09	3
609	639658.80	1138646.87	3
610	639658.47	1138648.07	3
611	639658.06	1138647.78	3
612	639657.26	1138647.99	3
613	639657.42	1138647.51	3
614	639652.61	1138646.55	3
615	639652.75	1138646.07	3
616	639651.48	1138646.27	3
617	639650.69	1138649.05	3
618	639650.40	1138650.26	3
619	639649.92	1138650.14	3
620	639650.21	1138648.93	3
621	639650.99	1138646.15	3
622	639647.24	1138645.12	3
623	639647.36	1138644.64	3
624	639643.79	1138644.24	3
625	639643.87	1138643.74	3
626	639642.42	1138644.16	3
627	639642.48	1138643.66	3
628	639641.36	1138643.98	3
629	639641.56	1138643.50	3
630	639640.64	1138643.41	3
631	639640.86	1138642.95	3
632	639635.96	1138642.14	3
633	639636.09	1138641.66	3
634	639631.74	1138641.01	3
635	639631.86	1138640.53	3
636	639628.64	1138640.27	3
637	639628.52	1138641.45	3
638	639628.66	1138641.85	3
639	639628.59	1138642.79	3
640	639628.23	1138644.33	3
641	639627.75	1138644.21	3
642	639628.09	1138642.71	3
643	639628.16	1138641.91	3
644	639627.98	1138641.30	3
645	639628.16	1138640.14	3
646	639628.49	1138639.72	3
647	639624.50	1138639.10	3
648	639623.63	1138640.45	3
649	639622.66	1138642.89	3
650	639622.17	1138642.76	3
651	639623.19	1138640.23	3
652	639624.00	1138638.96	3
653	639624.46	1138638.57	3
654	639618.97	1138637.05	3
655	639618.83	1138637.53	3
656	639613.01	1138635.38	3
657	639613.11	1138635.93	3
658	639612.66	1138637.46	3
659	639612.03	1138640.11	3
660	639611.55	1138639.98	3
661	639612.18	1138637.34	3
662	639612.63	1138635.79	3
663	639607.83	1138633.88	3
664	639607.69	1138634.36	3
665	639602.15	1138632.33	3
666	639602.01	1138632.81	3
667	639598.45	1138631.29	3
668	639598.31	1138631.77	3
669	639594.23	1138630.18	3
670	639594.32	1138630.72	3
671	639593.83	1138632.07	3
672	639592.99	1138634.89	3
673	639592.51	1138634.76	3
674	639593.35	1138631.91	3

Seznam souřadnic (S-JTSK):

Souřadnice pro zápis do KN

Číslo bodu	Y	X	kk
675	639593.84	1138630.58	3
676	639590.05	1138629.43	3
677	639590.19	1138628.95	3
678	639588.41	1138628.98	3
679	639588.04	1138630.30	3
680	639587.10	1138633.22	3
681	639586.62	1138633.08	3
682	639587.56	1138630.16	3
683	639587.93	1138628.84	3
684	639585.14	1138628.01	3
685	639588.31	1138628.43	3
686	639585.28	1138627.53	3
687	639579.66	1138625.97	3
688	639579.52	1138626.45	3
689	639577.64	1138625.42	3
690	639577.75	1138625.97	3
691	639577.41	1138627.26	3
692	639576.90	1138629.47	3
693	639576.66	1138630.09	3
694	639576.18	1138629.95	3
695	639576.42	1138629.33	3
696	639576.93	1138627.14	3
697	639577.27	1138625.83	3
698	639573.00	1138624.64	3
699	639573.14	1138624.16	3
700	639568.05	1138623.25	3
701	639567.41	1138625.00	3
702	639566.67	1138627.39	3
703	639566.19	1138627.27	3
704	639566.93	1138624.84	3
705	639567.56	1138623.12	3
706	639567.96	1138622.71	3
707	639560.30	1138620.49	3
708	639560.16	1138620.97	3
709	639554.66	1138619.05	3
710	639554.54	1138619.53	3
711	639550.78	1138618.00	3
712	639550.85	1138618.54	3
713	639550.25	1138619.85	3
714	639549.76	1138619.71	3
715	639550.37	1138618.39	3
716	639546.88	1138617.27	3
717	639546.45	1138618.41	3
718	639545.99	1138618.21	3
719	639546.36	1138617.25	3
720	639545.92	1138617.29	3
721	639546.76	1138616.71	3
722	639546.02	1138616.77	3
723	639545.43	1138616.39	3
724	639545.09	1138616.85	3
725	639544.79	1138615.76	3
726	639544.49	1138616.18	3
727	639543.40	1138615.12	3
728	639543.53	1138614.82	3
729	639543.07	1138614.62	3
730	639542.94	1138614.93	3
731	639542.97	1138615.52	3
732	639539.22	1138614.01	3
733	639539.60	1138613.62	3
734	639539.12	1138613.44	3
735	639539.77	1138612.70	3
736	639539.29	1138612.56	3
737	639540.63	1138610.36	3
738	639540.15	1138610.22	3
739	639542.13	1138605.39	3
740	639541.65	1138605.21	3
741	639542.29	1138605.01	3
742	639541.91	1138604.65	3
743	639542.64	1138604.83	3
744	639542.56	1138604.31	3
745	639543.28	1138604.94	3
746	639543.33	1138604.44	3
747	639533.48	1138611.26	3
748	639532.56	1138613.02	3
749	639533.03	1138613.20	3
750	639533.72	1138611.88	3
751	639659.60	1138649.38	3
752	639659.32	1138649.83	3
753	639665.85	1138651.59	3
754	639665.31	1138652.79	3
755	639664.81	1138654.15	3
756	639665.29	1138654.28	3
757	639665.77	1138652.97	3
758	639666.34	1138651.72	3
759	639657.99	1138648.29	3

Seznam souřadnic (S-JTSK):

Souřadnice pro zápis do KN

Číslo bodu	Y	X	kk
760	639671.37	1138652.57	3
761	639676.05	1138654.41	3
762	639676.51	1138654.02	3
763	639678.86	1138654.66	3
764	639697.04	1138659.78	3
765	639697.14	1138659.29	3
766	639701.49	1138661.00	3
767	639701.63	1138660.52	3
768	639705.67	1138662.17	3
769	639705.83	1138661.69	3
770	639706.05	1138662.32	3
771	639706.17	1138661.83	3
772	639868.05	1138487.35	3
773	639867.91	1138486.87	3
774	639875.51	1138440.96	3
775	639875.01	1138441.03	3
776	639873.56	1138432.52	3
779	639866.02	1138488.10	3
780	639865.80	1138487.65	3
781	639871.28	1138432.47	3
782	639871.34	1138432.98	3
783	639768.50	1138521.78	3
784	639759.38	1138522.10	3
785	639759.28	1138522.59	3
786	639746.89	1138557.61	3
787	639747.56	1138557.76	3
788	639733.74	1138532.06	3
789	639734.24	1138531.97	3
790	639667.73	1138536.34	3
791	639604.89	1138566.09	3
792	639667.63	1138535.85	3
793	639652.44	1138546.15	3
795	639587.71	1138629.64	3
796	639588.19	1138629.78	3
797	639593.56	1138631.33	3
798	639594.05	1138631.47	3
799	639612.35	1138636.77	3
800	639612.82	1138636.91	3
801	639623.36	1138639.96	3
802	639623.85	1138640.10	3
803	639650.62	1138647.48	3
804	639651.10	1138647.61	3
805	639567.41	1138623.52	3
806	639567.91	1138623.67	3
807	639577.11	1138626.45	3
808	639577.59	1138626.59	3
809	639546.40	1138616.74	3
810	639533.09	1138612.01	3
811	639533.57	1138612.17	3
813	639553.38	1138619.22	3
815	639661.08	1138638.58	3
816	639661.57	1138638.69	3
817	639662.25	1138634.85	3
818	639662.83	1138634.68	3
9038-193	639604.49	1138565.73	3
9038-203	639582.51	1138557.44	3
9045-8	639671.45	1138653.10	3
9046-96	639678.78	1138654.90	3
9046-97	639676.11	1138654.27	3

PŘEHLED KLADU LISTŮ





2744

2868/1

2871/5

2868/2

2863/98

6420/1

2868/17

2868/18

2868/14

2868/15

2868/8

2868/7

2868/6

2868/5

2867/3

DETAIL A

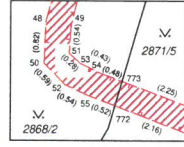

DETAIL A

2867/1

2863/3





