

VÝKAZ DOSAVADNÍHO A NOVÉHO STAVU ÚDAJŮ KATASTRU NĚMOVITOSTÍ

| Dosavadní stav | | | Nový stav | | | | | | | | | | | | | |
|-------------------------------|----------------|----------------|--------------|-------------------------------|----------------|----|--------------|------------|----------------|----------------|---------------------|--|----------------|----------------|--|------------------------|
| Označení pozemku parc. číslem | Výměra parcely | | Druh pozemku | Označení pozemku parc. číslem | Výměra parcely | | Druh pozemku | Typ stavby | Způsob využití | Způsob využití | Způsob určení výměr | Porovnání se stavem evidence právních vztahů | | | | |
| | ha | m ² | | | Způsob využití | ha | | | | | | m ² | Způsob využití | Způsob využití | Díl přechází z pozemku označeného v katastru nemovitostí | dřívější poz. evidenci |
| | | | | | | | | | | | | | ha | m ² | | |
| 988 | | | | | | | | | | | | 988 | | | | |
| 995/1 | | | | | | | | | | | | 995/1 | | | 10001 | |
| 995/4 | | | | | | | | | | | | 995/4 | | | 352 | |
| 995/10 | | | | | | | | | | | | 995/10 | | | 10001 | |
| 995/12 | | | | | | | | | | | | 995/12 | | | 10001 | |
| 995/13 | | | | | | | | | | | | 995/13 | | | 22 | |
| 995/17 | | | | | | | | | | | | 995/17 | | | 405 | |
| 995/43 | | | | | | | | | | | | 995/17 | | | 471 | |
| 1004/42 | | | | | | | | | | | | 995/43 | | | 21 | |
| 1004/43 | | | | | | | | | | | | 1004/42 | | | 22 | |
| 1004/44 | | | | | | | | | | | | 1004/43 | | | 206 | |
| 1004/45 | | | | | | | | | | | | 1004/44 | | | 405 | |
| 1004/46 | | | | | | | | | | | | 1004/45 | | | 306 | |
| 1004/47 | | | | | | | | | | | | 1004/46 | | | 571 | |
| 1017/1 | | | | | | | | | | | | 1004/47 | | | 241 | |
| 1018/1 | | | | | | | | | | | | 1017/1 | | | 21 | |
| 1025/1 | | | | | | | | | | | | 1018/1 | | | 1266 | |
| 1025/2 | | | | | | | | | | | | 1025/1 | | | 22 | |
| 1025/3 | | | | | | | | | | | | 1025/2 | | | 667 | |
| 1042/1 | | | | | | | | | | | | 1025/3 | | | 337 | |
| 1042/2 | | | | | | | | | | | | 1042/1 | | | 92 | |
| 1052 | | | | | | | | | | | | 1042/2 | | | 489 | |
| 1070 | | | | | | | | | | | | 1052 | | | 489 | |
| 1081 | | | | | | | | | | | | 1070 | | | 22 | |
| 1095 | | | | | | | | | | | | 1081 | | | 352 | |
| 1105 | | | | | | | | | | | | 1095 | | | 658 | |
| 1107/1 | | | | | | | | | | | | 1105 | | | 434 | |
| 1107/2 | | | | | | | | | | | | 1107/1 | | | 405 | |
| 1127 | | | | | | | | | | | | 1107/2 | | | 206 | |
| 1146 | | | | | | | | | | | | 1127 | | | 306 | |
| 1154 | | | | | | | | | | | | 1146 | | | 571 | |
| | | | | | | | | | | | | 1154 | | | 241 | |

| | | |
|---|--|---|
| <h2 style="margin: 0;">GEOMETRICKÝ PLÁN</h2> <h3 style="margin: 0;">pro</h3> <p style="margin: 0;">vymezení rozsahu věcného břemene k části pozemku</p> | Geometrický plán ověřil úředně oprávněný zeměměřický inženýr: | Stejnopis ověřil úředně oprávněný zeměměřický inženýr: |
| | Jméno, příjmení: X X X | Jméno, příjmení: X X X |
| | Číslo položky seznamu úředně oprávněných zeměměřických inženýrů: 2568/11 | Číslo položky seznamu úředně oprávněných zeměměřických inženýrů: 2568/11 |
| | Dne: 16.5.2019 Číslo: 222/2019 | Dne: 22.5.2019 Číslo: 236/2019 |
| | Náležitostmi a přesností odpovídá právním předpisům. | Tento stejnopis odpovídá geometrickému plánu v elektronické podobě uloženému v dokumentaci katastrálního úřadu. |
| Vyhotovitel: Gespol s.r.o. Jáchymovská 73 360 04 Karlovy Vary Číslo plánu: 694-58/2019 Okres: Vsetín Obec: Kelč Kat. území: Kelč-Nové Město Mapový list: KMD, HnM 2-8/31,32,41 Dosavadním vlastníkům pozemků byla poskytnuta možnost seznámit se v terénu s průběhem navržených nových hranic, které byly označeny předepsaným způsobem. | Katastrální úřad souhlasí s očíslováním parcel. KÚ pro Zlínský kraj Valašské Meziříčí Ing. Ivana Mikulenková PGP-594/2019-836 2019.05.22 06:56:55 CEST | |

VÝKAZ DOSAVADNÍHO A NOVÉHO STAVU ÚDAJŮ KATASTRU NEMOVITOSTÍ

| Dosavadní stav | | | | Nový stav | | | | | | | | | | | |
|-------------------------------|----------------|----------------|--------------------------------|-------------------------------|----------------|----------------|--------------------------------|------------------------------|------------------------|--|------------------------|-------------------------|--------------|--|----------------|
| Označení pozemku parc. číslem | Výměra parcely | | Druh pozemku Způsob využití | Označení pozemku parc. číslem | Výměra parcely | | Druh pozemku Způsob využití | Typ stavby Způsob využití | Způsob určení výměr | Porovnání se stavem evidence právních vztahů | | | | | Označení dluhu |
| | ha | m ² | | | ha | m ² | | | | Díl přechází z pozemku označeného v katastru nemovitostí | dřívější poz. evidenci | Číslo listu vlastnictví | Výměra dluhu | | |
| | | | ha | | | | m ² | | | | | | | | |
| 1164 | | | | | | | | | | 1164 | | 302 | | | |
| 1165/11 | | | | | | | | | | 1165/11 | | 22 | | | |
| 1165/12 | | | | | | | | | | 1165/12 | | 405 | | | |
| 1165/13 | | | | | | | | | | 1165/13 | | 206 | | | |
| 1190 | | | | | | | | | | 1190 | | 171 | | | |
| 1202 | | | | | | | | | | 1202 | | 171 | | | |
| 1207/2 | | | | | | | | | | 1207/2 | | 10001 | | | |
| 1207/13 | | | | | | | | | | 1207/13 | | 302 | | | |
| 1207/14 | | | | | | | | | | 1207/14 | | 171 | | | |
| 1207/15 | | | | | | | | | | 1207/15 | | 888 | | | |
| 1207/16 | | | | | | | | | | 1207/16 | | 888 | | | |
| 1220 | | | | | | | | | | 1220 | | 171 | | | |
| 1297/4 | | | | | | | | | | 1297/4 | | 574 | | | |
| 1297/5 | | | | | | | | | | 1297/5 | | 160 | | | |
| 1298 | | | | | | | | | | 1298 | | 10001 | | | |
| 1310/1 | | | | | | | | | | 1310/1 | | 69 | | | |
| 1329/14 | | | | | | | | | | 1329/14 | | 1383 | | | |
| 1329/57 | | | | | | | | | | 1329/57 | | 865 | | | |
| 1329/58 | | | | | | | | | | 1329/58 | | 1165 | | | |
| 1329/59 | | | | | | | | | | 1329/59 | | 303 | | | |
| 1329/60 | | | | | | | | | | 1329/60 | | 335 | | | |
| 1329/61 | | | | | | | | | | 1329/61 | | 22 | | | |
| 1332 | | | | | | | | | | 1332 | | 241 | | | |
| 1334 | | | | | | | | | | 1334 | | 1498 | | | |
| 1345 | | | | | | | | | | 1345 | | 241 | | | |
| 1346 | | | | | | | | | | 1346 | | 171 | | | |
| 1356/1 | | | | | | | | | | 1356/1 | | 909 | | | |
| 1428 | | | | | | | | | | 1428 | | 1124 | | | |
| 1429/4 | | | | | | | | | | 1429/4 | | 22 | | | |
| 1429/5 | | | | | | | | | | 1429/5 | | 107 | | | |
| 1429/6 | | | | | | | | | | 1429/6 | | 80 | | | |
| 1429/7 | | | | | | | | | | 1429/7 | | 267 | | | |
| 1430/13 | | | | | | | | | | 1430/13 | | 1541 | | | |
| 1430/14 | | | | | | | | | | 1430/14 | | 432 | | | |
| 1430/15 | | | | | | | | | | 1430/15 | | 514 | | | |
| 1432/1 | | | | | | | | | | 1432/1 | | 868 | | | |
| 1432/2 | | | | | | | | | | 1432/2 | | 318 | | | |
| 1586/1 | | | | | | | | | | 1586/1 | | 1535 | | | |
| 1586/2 | | | | | | | | | | 1586/2 | | 727 | | | |
| 1586/3 | | | | | | | | | | 1586/3 | | 22 | | | |
| 1587 | | | | | | | | | | 1587 | | 60000 | | | |
| 1589 | | | | | | | | | | 1589 | | 318 | | | |
| 1590 | | | | | | | | | | 1590 | | 318 | | | |
| 1591 | | | | | | | | | | 1591 | | 731 | | | |
| 1592 | | | | | | | | | | 1592 | | 737 | | | |
| 1593 | | | | | | | | | | 1593 | | 256 | | | |
| 1594 | | | | | | | | | | 1594 | | 243 | | | |
| 1595 | | | | | | | | | | 1595 | | 256 | | | |
| 1596 | | | | | | | | | | 1596 | | 737 | | | |
| 1597 | | | | | | | | | | 1597 | | 318 | | | |
| 1598 | | | | | | | | | | 1598 | | 243 | | | |
| 1599 | | | | | | | | | | 1599 | | 731 | | | |
| 1600 | | | | | | | | | | 1600 | | 737 | | | |
| 1601 | | | | | | | | | | 1601 | | 737 | | | |
| 1602 | | | | | | | | | | 1602 | | 737 | | | |
| 1603 | | | | | | | | | | 1603 | | 256 | | | |
| 1604 | | | | | | | | | | 1604 | | 318 | | | |
| 1605 | | | | | | | | | | 1605 | | 318 | | | |
| 1606 | | | | | | | | | | 1606 | | 243 | | | |

VÝKAZ DOSAVADNÍHO A NOVÉHO STAVU ÚDAJŮ KATASTRU NEMOVITOSTÍ

| Dosavadní stav | | | Nový stav | | | | | | | | | | | | |
|-------------------------------|----------------|----------------|--------------------------------|-------------------------------|--|------------------------|--------------------------------|------------------------------|----------------------|--|-------------|----------------|---------------|--|--|
| Označení pozemku parc. číslem | Výměra parcely | | Druh pozemku Způsob využití | Označení pozemku parc. číslem | Výměra parcely | | Druh pozemku Způsob využití | Typ stavby Způsob využití | Způsob určení výměry | Porovnání se stavem evidence právních vztahů | | | | | |
| | ha | m ² | | | Díl přechází z pozemku označeného v katastru nemovitostí | dřívější poz. evidenci | | | | Číslo listu vlastnictví | Výměra dílu | | Označení dílu | | |
| | | | | | | | | | | | ha | m ² | | | |
| 1609 | | | | | | | | | | 1609 | | 737 | | | |
| 1610 | | | | | | | | | | 1610 | | 737 | | | |
| 1611 | | | | | | | | | | 1611 | | 318 | | | |
| 1612 | | | | | | | | | | 1612 | | 622 | | | |
| 1614 | | | | | | | | | | 1614 | | 243 | | | |
| 1615 | | | | | | | | | | 1615 | | 243 | | | |
| 1616 | | | | | | | | | | 1616 | | 243 | | | |
| 1617 | | | | | | | | | | 1617 | | 243 | | | |
| 1618 | | | | | | | | | | 1618 | | 539 | | | |
| 1627 | | | | | | | | | | 1627 | | 622 | | | |
| 1628 | | | | | | | | | | 1628 | | 21 | | | |
| 1630/2 | | | | | | | | | | 1630/2 | | 21 | | | |
| 1640 | | | | | | | | | | 1640 | | 622 | | | |
| 1711/3 | | | | | | | | | | 1711/3 | | 432 | | | |
| 1711/7 | | | | | | | | | | 1711/7 | | 10001 | | | |
| 1981 | | | | | | | | | | 1981 | | 10001 | | | |
| 1987/1 | | | | | | | | | | 1987/1 | | 10001 | | | |
| 1991/1 | | | | | | | | | | 1991/1 | | 1342 | | | |
| 1991/13 | | | | | | | | | | 1991/13 | | 1342 | | | |
| 1991/14 | | | | | | | | | | 1991/14 | | 1342 | | | |
| 1991/15 | | | | | | | | | | 1991/15 | | 471 | | | |
| 1991/34 | | | | | | | | | | 1991/34 | | 1342 | | | |
| 1991/41 | | | | | | | | | | 1991/41 | | 1342 | | | |
| 1995/4 | | | | | | | | | | 1995/4 | | 10001 | | | |
| 1995/5 | | | | | | | | | | 1995/5 | | 10001 | | | |
| 1995/9 | | | | | | | | | | 1995/9 | | 10001 | | | |
| 1999 | | | | | | | | | | 1999 | | 1342 | | | |
| 2059/66 | | | | | | | | | | 2059/66 | | 22 | | | |
| 2059/67 | | | | | | | | | | 2059/67 | | 206 | | | |
| 2059/68 | | | | | | | | | | 2059/68 | | 405 | | | |
| 2065/2 | | | | | | | | | | 2065/2 | | 432 | | | |

Oprávněný : Dle právních listin

Druh věcného břemene : Dle právních listin

Seznam souřadnic (S–JTSK)
Souřadnice pro zápis do KN

Seznam souřadnic (S–JTSK)
Souřadnice pro zápis do KN

| Číslo bodu | Y | X | kód kv. | Poznámka | Číslo bodu | Y | X | kód kv. | Poznámka |
|---|-----------|------------|---------|----------|------------|-----------|------------|---------|----------|
| Katastrální území 664758 Keleč–Nové Město | | | | | 659–133 | 506211.72 | 1137416.67 | 8 | |
| 291–657 | 506487.30 | 1137416.30 | 8 | | 659–135 | 506202.65 | 1137416.70 | 8 | |
| 508–3505 | 507432.33 | 1137425.40 | 8 | | 659–137 | 506198.28 | 1137416.71 | 8 | |
| 509–619 | 507095.40 | 1137443.17 | 8 | | 659–139 | 506196.74 | 1137416.72 | 8 | |
| 658–129 | 507432.03 | 1137412.66 | 8 | | 659–141 | 506193.22 | 1137416.73 | 8 | |
| 658–246 | 507431.96 | 1137442.06 | 8 | | 659–143 | 506150.61 | 1137416.87 | 8 | |
| 659–1 | 507376.20 | 1137412.84 | 8 | | 659–145 | 506146.89 | 1137416.88 | 8 | |
| 659–3 | 507302.47 | 1137413.08 | 8 | | 659–147 | 506097.71 | 1137417.05 | 8 | |
| 659–5 | 507290.61 | 1137413.12 | 8 | | 659–149 | 506093.33 | 1137417.06 | 8 | |
| 659–7 | 507282.07 | 1137413.15 | 8 | | 659–151 | 506057.93 | 1137417.18 | 8 | |
| 659–9 | 507272.38 | 1137413.18 | 8 | | 659–153 | 506044.09 | 1137417.22 | 8 | |
| 659–11 | 507266.00 | 1137413.20 | 8 | | 659–155 | 506033.78 | 1137417.26 | 8 | |
| 659–13 | 507259.08 | 1137413.23 | 8 | | 659–157 | 506022.29 | 1137417.29 | 8 | |
| 659–15 | 507243.72 | 1137413.28 | 8 | | 659–159 | 506002.37 | 1137417.36 | 8 | |
| 659–17 | 507225.69 | 1137413.34 | 8 | | 659–161 | 505995.79 | 1137417.38 | 8 | |
| 659–19 | 507205.93 | 1137413.40 | 8 | | 659–163 | 505990.08 | 1137417.40 | 8 | |
| 659–21 | 507193.15 | 1137413.44 | 8 | | 659–165 | 505985.65 | 1137417.41 | 8 | |
| 659–23 | 507170.57 | 1137413.52 | 8 | | 659–167 | 505980.54 | 1137417.43 | 8 | |
| 659–25 | 507149.34 | 1137413.59 | 8 | | 659–169 | 505976.01 | 1137417.45 | 8 | |
| 659–27 | 507144.51 | 1137413.60 | 8 | | 659–171 | 505969.49 | 1137417.47 | 8 | |
| 659–29 | 507141.90 | 1137413.61 | 8 | | 659–173 | 505959.79 | 1137417.50 | 8 | |
| 659–30 | 507140.07 | 1137413.62 | 8 | | 659–175 | 505949.35 | 1137417.53 | 8 | |
| 659–32 | 507127.68 | 1137413.66 | 8 | | 659–177 | 505939.14 | 1137417.57 | 8 | |
| 659–34 | 507117.66 | 1137413.69 | 8 | | 659–179 | 505927.93 | 1137417.60 | 8 | |
| 659–36 | 507114.19 | 1137413.70 | 8 | | 659–181 | 505918.24 | 1137417.64 | 8 | |
| 659–37 | 507111.76 | 1137413.71 | 8 | | 659–183 | 505907.95 | 1137417.67 | 8 | |
| 659–40 | 507109.19 | 1137413.72 | 8 | | 659–185 | 505899.99 | 1137417.70 | 8 | |
| 659–41 | 507095.36 | 1137413.76 | 8 | | 659–187 | 505891.94 | 1137417.72 | 8 | |
| 659–43 | 507080.53 | 1137413.81 | 8 | | 659–189 | 505883.69 | 1137417.75 | 8 | |
| 659–45 | 507066.51 | 1137413.86 | 8 | | 659–191 | 505875.14 | 1137417.78 | 8 | |
| 659–47 | 507053.86 | 1137413.90 | 8 | | 659–193 | 505866.67 | 1137417.81 | 8 | |
| 659–49 | 507038.21 | 1137413.95 | 8 | | 659–195 | 505857.82 | 1137417.83 | 8 | |
| 659–51 | 507024.34 | 1137414.00 | 8 | | 659–197 | 505771.58 | 1137418.12 | 8 | |
| 659–53 | 506995.31 | 1137414.09 | 8 | | 659–199 | 505737.27 | 1137418.23 | 8 | |
| 659–55 | 506990.63 | 1137414.11 | 8 | | 659–201 | 505713.19 | 1137418.31 | 8 | |
| 659–57 | 506985.73 | 1137414.12 | 8 | | 659–203 | 505681.65 | 1137418.41 | 8 | |
| 659–59 | 506982.47 | 1137414.14 | 8 | | 659–205 | 505676.58 | 1137418.43 | 8 | |
| 659–61 | 506981.11 | 1137414.14 | 8 | | 659–208 | 507376.62 | 1137442.24 | 8 | |
| 659–63 | 506957.31 | 1137414.22 | 8 | | 659–210 | 507302.99 | 1137442.48 | 8 | |
| 659–65 | 506934.55 | 1137414.29 | 8 | | 659–212 | 507290.93 | 1137442.52 | 8 | |
| 659–67 | 506918.39 | 1137414.35 | 8 | | 659–214 | 507282.34 | 1137442.55 | 8 | |
| 659–69 | 506895.79 | 1137414.42 | 8 | | 659–216 | 507272.98 | 1137442.58 | 8 | |
| 659–71 | 506884.27 | 1137414.46 | 8 | | 659–218 | 507266.63 | 1137442.60 | 8 | |
| 659–80 | 506872.30 | 1137414.50 | 8 | | 659–220 | 507259.70 | 1137442.62 | 8 | |
| 659–82 | 506855.90 | 1137414.55 | 8 | | 659–222 | 507244.58 | 1137442.67 | 8 | |
| 659–84 | 506853.39 | 1137414.56 | 8 | | 659–224 | 507226.73 | 1137442.73 | 8 | |
| 659–86 | 506848.74 | 1137414.58 | 8 | | 659–226 | 507207.55 | 1137442.80 | 8 | |
| 659–88 | 506846.29 | 1137414.58 | 8 | | 659–228 | 507194.43 | 1137442.84 | 8 | |
| 659–90 | 506825.61 | 1137414.65 | 8 | | 659–230 | 507171.48 | 1137442.91 | 8 | |
| 659–91 | 506632.02 | 1137415.29 | 8 | | 659–232 | 507140.66 | 1137443.02 | 8 | |
| 659–93 | 506628.94 | 1137415.30 | 8 | | 659–235 | 507110.75 | 1137443.11 | 8 | |
| 659–95 | 506603.81 | 1137415.38 | 8 | | 659–236 | 507106.44 | 1137443.13 | 8 | |
| 659–97 | 506584.86 | 1137415.44 | 8 | | 659–238 | 507102.56 | 1137443.14 | 8 | |
| 659–99 | 506554.98 | 1137415.54 | 8 | | 659–240 | 507100.56 | 1137443.15 | 8 | |
| 659–101 | 506514.43 | 1137415.68 | 8 | | 659–244 | 507086.28 | 1137443.19 | 8 | |
| 659–103 | 506507.88 | 1137415.70 | 8 | | 659–246 | 507082.65 | 1137443.21 | 8 | |
| 659–105 | 506506.51 | 1137415.70 | 8 | | 659–248 | 507081.53 | 1137443.21 | 8 | |
| 659–107 | 506500.39 | 1137415.72 | 8 | | 659–250 | 507053.89 | 1137443.30 | 8 | |
| 659–109 | 506492.27 | 1137415.75 | 8 | | 659–252 | 507038.37 | 1137443.35 | 8 | |
| 659–111 | 506491.50 | 1137415.75 | 8 | | 659–254 | 507025.25 | 1137443.40 | 8 | |
| 659–113 | 506487.35 | 1137415.76 | 8 | | 659–256 | 506996.75 | 1137443.49 | 8 | |
| 659–114 | 506486.57 | 1137415.77 | 8 | | 659–258 | 506993.87 | 1137443.50 | 8 | |
| 659–117 | 506474.09 | 1137415.81 | 8 | | 659–260 | 506987.19 | 1137443.52 | 8 | |
| 659–119 | 506436.32 | 1137415.93 | 8 | | 659–262 | 506984.12 | 1137443.53 | 8 | |
| 659–121 | 506409.77 | 1137416.02 | 8 | | 659–264 | 506983.21 | 1137443.53 | 8 | |
| 659–123 | 506392.17 | 1137416.08 | 8 | | 659–266 | 506958.24 | 1137443.62 | 8 | |
| 659–125 | 506372.56 | 1137416.14 | 8 | | 659–267 | 506933.89 | 1137443.70 | 8 | |
| 659–127 | 506356.37 | 1137416.19 | 8 | | 659–269 | 506917.75 | 1137443.75 | 8 | |
| 659–129 | 506341.72 | 1137416.24 | 8 | | 659–271 | 506895.62 | 1137443.82 | 8 | |
| 659–131 | 506276.72 | 1137416.46 | 8 | | 659–273 | 506884.23 | 1137443.86 | 8 | |

Seznam souřadnic (S–JTSK)

Souřadnice pro zápis do KN

| Číslo bodu | Y | X | kód kv. | Poznámka |
|------------|-----------|------------|---------|----------|
| 659–275 | 506871.84 | 1137443.90 | 8 | |
| 659–277 | 506855.89 | 1137443.95 | 8 | |
| 659–279 | 506853.32 | 1137443.96 | 8 | |
| 659–281 | 506848.79 | 1137443.98 | 8 | |
| 659–283 | 506846.18 | 1137443.98 | 8 | |
| 659–285 | 506630.75 | 1137444.69 | 8 | |
| 659–287 | 506627.52 | 1137444.70 | 8 | |
| 659–289 | 506602.65 | 1137444.79 | 8 | |
| 659–291 | 506583.61 | 1137444.85 | 8 | |
| 659–293 | 506555.10 | 1137444.94 | 8 | |
| 659–295 | 506543.64 | 1137444.98 | 8 | |
| 659–297 | 506540.40 | 1137444.99 | 8 | |
| 659–299 | 506534.12 | 1137445.01 | 8 | |
| 659–301 | 506525.98 | 1137445.04 | 8 | |
| 659–302 | 506523.80 | 1137445.04 | 8 | |
| 659–303 | 506522.31 | 1137445.05 | 8 | |
| 659–306 | 506510.70 | 1137445.09 | 8 | |
| 659–308 | 506497.02 | 1137445.13 | 8 | |
| 659–310 | 506483.19 | 1137445.18 | 8 | |
| 659–312 | 506470.08 | 1137445.22 | 8 | |
| 659–314 | 506434.49 | 1137445.34 | 8 | |
| 659–316 | 506409.47 | 1137445.42 | 8 | |
| 659–318 | 506393.49 | 1137445.47 | 8 | |
| 659–320 | 506373.53 | 1137445.54 | 8 | |
| 659–322 | 506357.62 | 1137445.59 | 8 | |
| 659–324 | 506342.83 | 1137445.64 | 8 | |
| 659–326 | 506277.45 | 1137445.85 | 8 | |
| 659–327 | 506248.79 | 1137445.95 | 8 | |
| 659–329 | 506211.62 | 1137446.07 | 8 | |
| 659–331 | 506205.28 | 1137446.09 | 8 | |
| 659–333 | 506201.74 | 1137446.10 | 8 | |
| 659–335 | 506199.95 | 1137446.11 | 8 | |
| 659–337 | 506196.55 | 1137446.12 | 8 | |
| 659–339 | 506135.63 | 1137446.32 | 8 | |
| 659–341 | 506132.36 | 1137446.33 | 8 | |
| 659–343 | 506128.53 | 1137446.34 | 8 | |
| 659–345 | 506080.16 | 1137446.50 | 8 | |
| 659–347 | 506059.84 | 1137446.57 | 8 | |
| 659–349 | 506056.71 | 1137446.58 | 8 | |
| 659–351 | 506010.23 | 1137446.73 | 8 | |
| 659–353 | 506008.38 | 1137446.74 | 8 | |
| 659–355 | 506006.03 | 1137446.75 | 8 | |
| 659–357 | 506003.28 | 1137446.76 | 8 | |
| 659–359 | 505996.25 | 1137446.78 | 8 | |
| 659–361 | 505990.32 | 1137446.80 | 8 | |
| 659–363 | 505985.28 | 1137446.82 | 8 | |
| 659–365 | 505979.65 | 1137446.83 | 8 | |
| 659–367 | 505974.88 | 1137446.85 | 8 | |
| 659–369 | 505968.59 | 1137446.87 | 8 | |
| 659–371 | 505959.13 | 1137446.90 | 8 | |
| 659–373 | 505948.37 | 1137446.94 | 8 | |
| 659–375 | 505938.33 | 1137446.97 | 8 | |
| 659–377 | 505927.03 | 1137447.01 | 8 | |
| 659–379 | 505916.93 | 1137447.04 | 8 | |
| 659–381 | 505906.03 | 1137447.08 | 8 | |
| 659–383 | 505898.34 | 1137447.10 | 8 | |
| 659–385 | 505890.46 | 1137447.13 | 8 | |
| 659–387 | 505882.33 | 1137447.15 | 8 | |
| 659–389 | 505874.29 | 1137447.18 | 8 | |
| 659–391 | 505866.26 | 1137447.21 | 8 | |
| 659–393 | 505857.18 | 1137447.24 | 8 | |
| 659–395 | 505774.19 | 1137447.51 | 8 | |
| 659–397 | 505740.39 | 1137447.62 | 8 | |
| 659–399 | 505716.71 | 1137447.70 | 8 | |
| 659–401 | 505687.41 | 1137447.80 | 8 | |
| 659–403 | 505682.22 | 1137447.81 | 8 | |

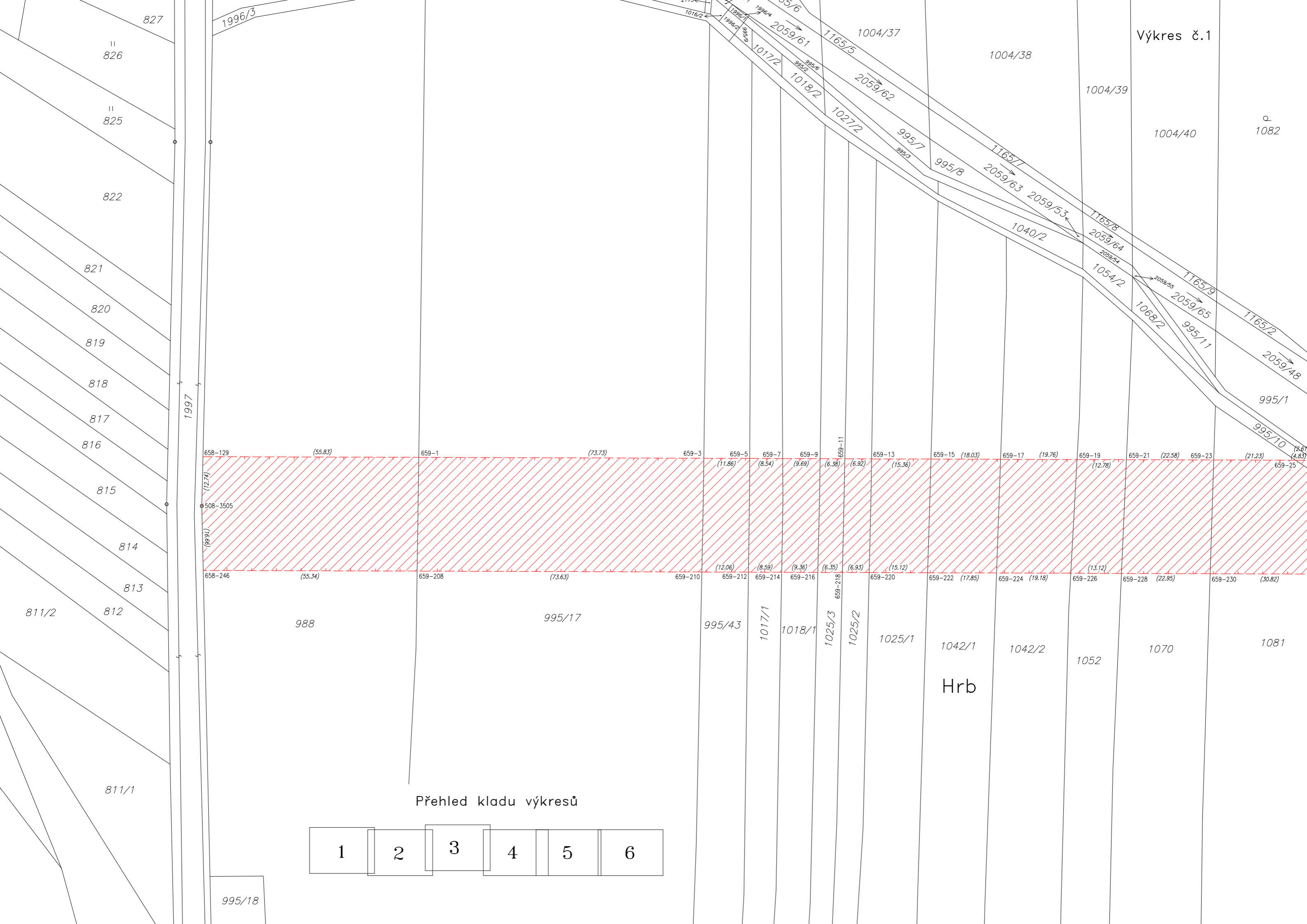

Přehled kladu výkresů

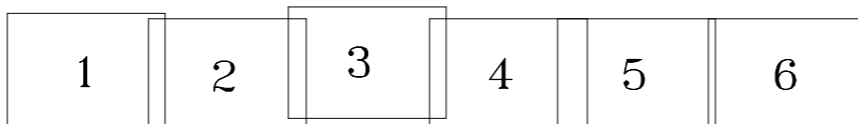

995/18

Lán

1329/43

1329/44

1329/45

1329/46

1329/47

1329/48

1329/51

1329/52

1329/53

1329/54

1329/55

1329/56

1329/57

1329/58

1329/59

1329/60

1329/61

1329/62

1329/63

1329/64

1329/65

1298

1297/5

1297/4

1329/14

1310/1

1430/18

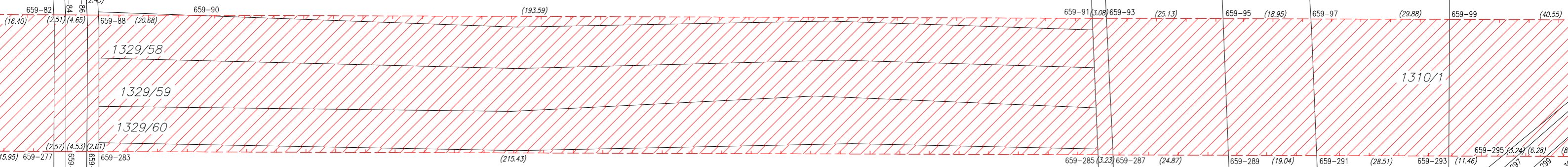

27 ○

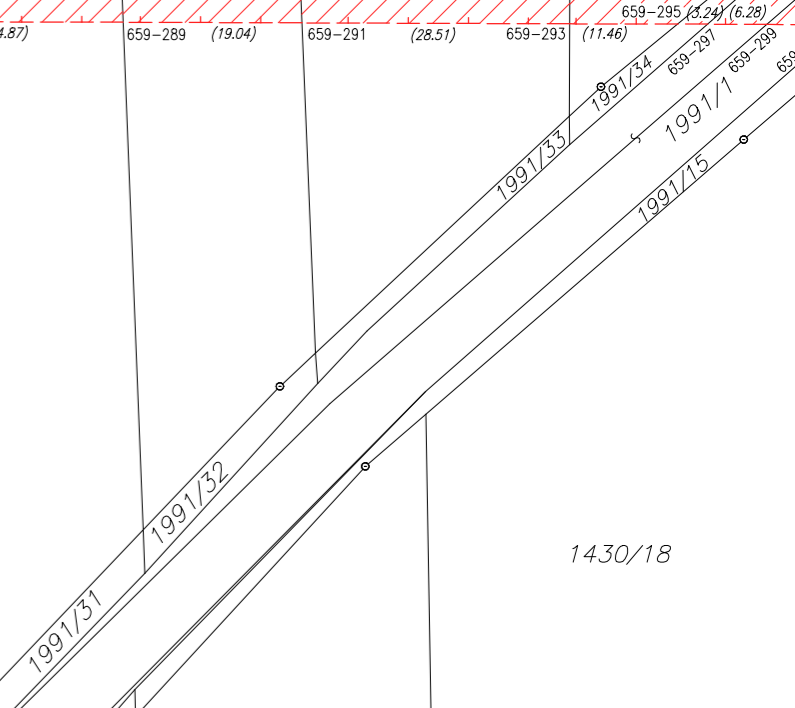

1220

659-82 (16.40)
 659-84 (2.51)
 659-86 (4.65)
 659-88 (2.45)
 659-90 (20.68)
 659-91 (3.08)
 659-93 (25.13)
 659-95 (18.95)
 659-97 (29.88)
 659-99 (40.55)
 659-277 (15.95)
 659-279 (4.53)
 659-281 (2.67)
 659-283 (215.43)
 659-285 (3.23)
 659-287 (24.87)
 659-289 (19.04)
 659-291 (28.51)
 659-293 (11.46)
 659-295 (3.24)
 659-297 (6.28)
 659-300 (8.00)

Výkres č.4

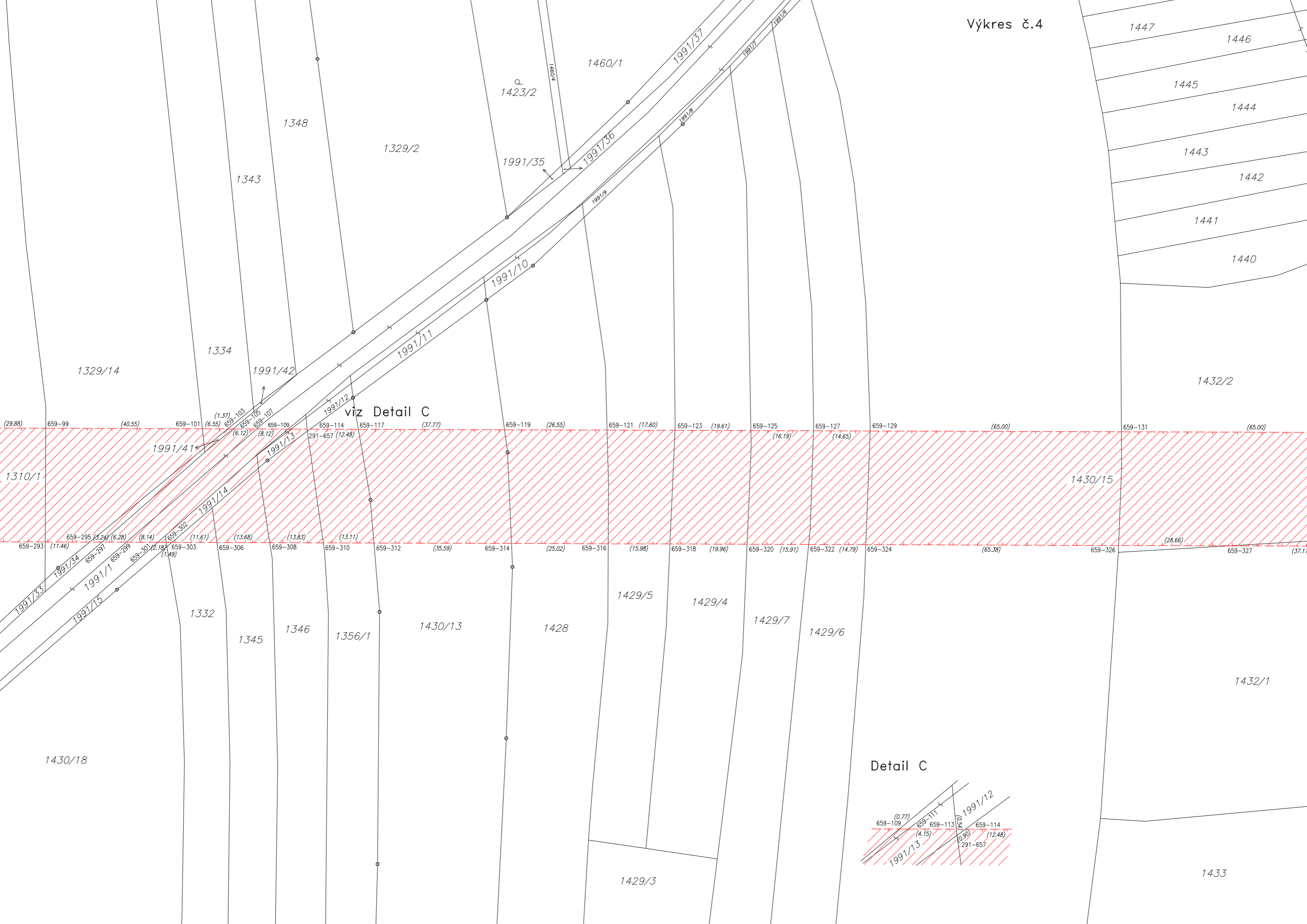

viz Detail C

Detail C

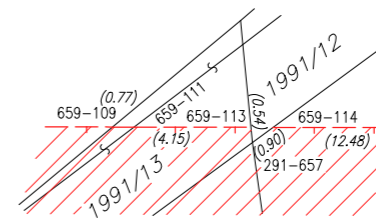

1429/3

1433

1432/1

1430/15

1432/2

1440

1441

1442

1443

1444

1445

1446

1447

1329/14

1334

1329/2

1348

1991/35

1460/1

1991/37

1343

1991/9

1991/10

1991/42

1991/11

1991/12

1991/41

1991/14

1310/1

1991/33

1991/34

1991/1

1991/15

1332

1345

1346

1356/1

1430/13

1428

1429/5

1429/4

1429/7

1429/6

1430/18

659-327 (37.17)

659-326 (28.66)

659-324 (65.38)

659-322 (14.79)

659-320 (15.91)

659-318 (19.96)

659-316 (15.98)

659-314 (25.02)

659-312 (35.59)

659-310 (13.11)

659-308 (13.83)

659-306 (13.68)

659-303 (11.61)

659-302 (1.49)

659-299 (2.18)

659-298 (7.28)

659-295 (8.24)

659-294 (6.28)

659-293 (11.46)

659-293 (11.46)

659-131 (65.00)

659-129 (65.00)

659-127 (14.65)

659-125 (16.19)

659-123 (19.61)

659-121 (17.60)

659-119 (26.55)

291-657 (12.48)

659-117 (37.77)

659-114 (6.55)

659-109 (8.12)

659-107 (8.12)

659-106 (6.12)

659-103 (1.37)

659-99 (40.55)

659-99 (29.88)

