



17

Q
18/1

293

Q
792

795

Q
18/2

Q
874

Q
828

829

831

830

833

Q
832

Q
827/1

835

827/2

(0.27)
1 (1.73)

4-16

(6.88)

3 (1.77) 5

A 6 (0.88)

(6.80)

(5.98)

(0.83)

(0.74)

(1.55)

(3.55)

(1.72)

(0.86)

(1.08)

(0.86)

396

397 (0.88)

(17.88)

(17.88)

(17.88)

396 (0.88)

(0.88)

395

(0.88)

395

(0.88)

(37.80)

2

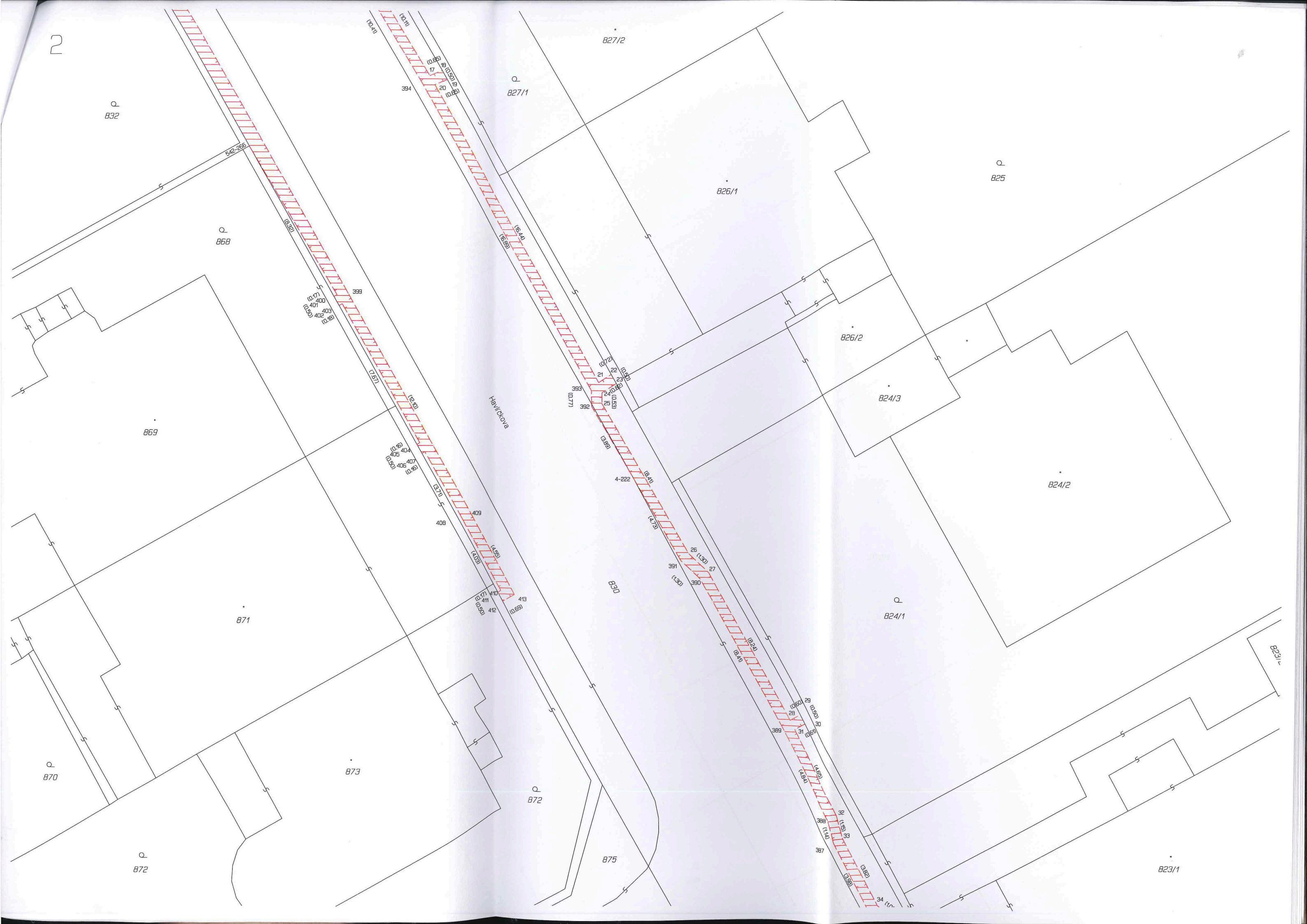

832

868

869

871

870

872

873

872

875

827/2

827/1

826/1

825

826/2

824/3

824/2

824/1

823/1

823/1

542-255

16.22

10.77
407
10.52
402
10.18

17.57

10.16
405
10.20
406
10.16

13.71

14.55

15.71
411
10.20
412
10.55

Heličková

10.77
393
10.77
392

820

4-222

14.73

11.30

10.60
28
10.30
28
10.81
31
10.81

14.55

11.41

11.41

11.41

11.41

11.41

11.41

11.41

11.41

11.41

11.41

11.41

11.41

11.41

11.41

11.41

11.41

11.41

11.41

11.41

11.41

11.41

11.41

11.41

11.41

11.41

11.41

11.41

11.41

11.41

11.41

11.41

11.41

11.41

11.41

11.41

11.41

11.41

11.41

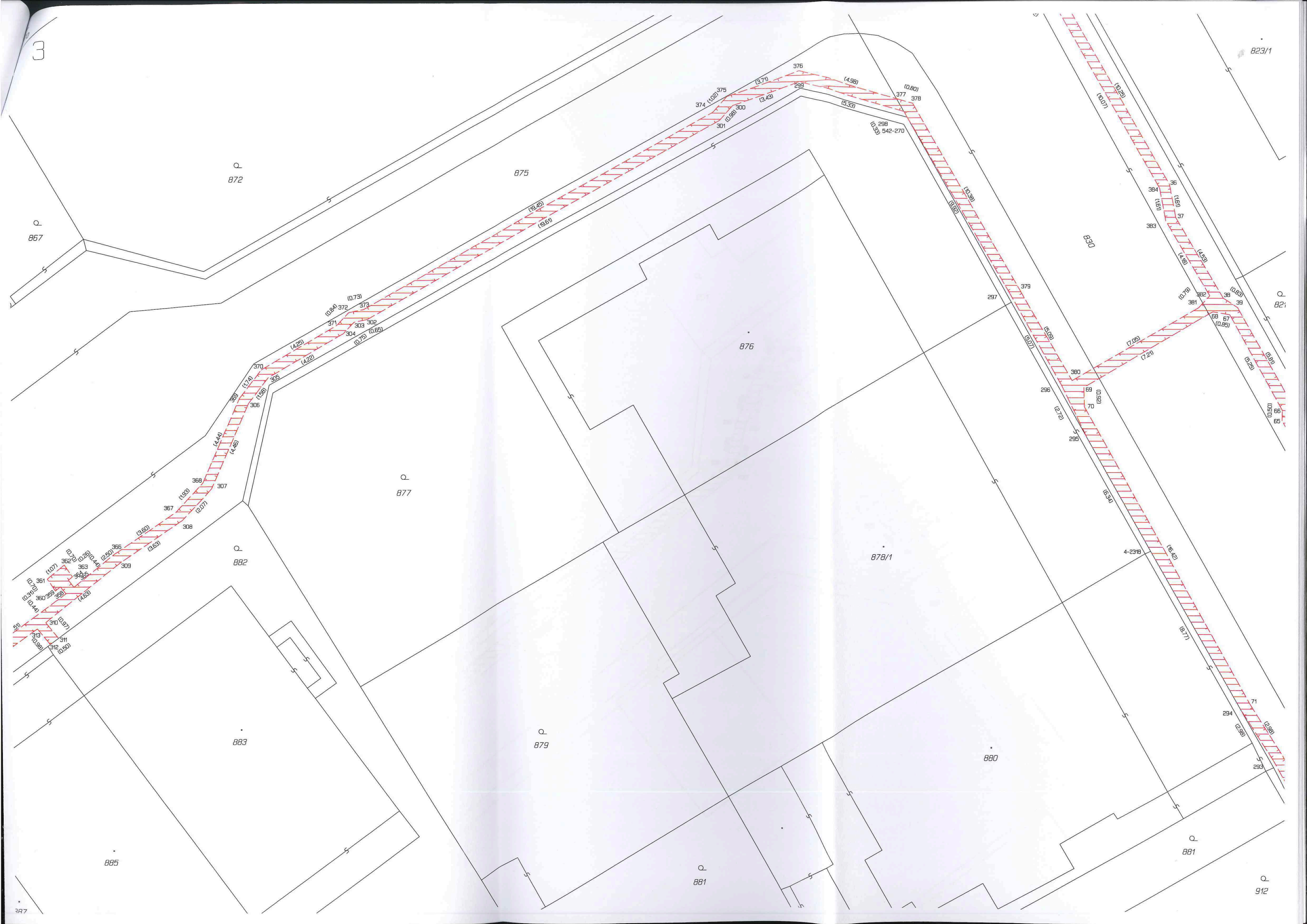

Q
872

875

876

Q
877

878/1

Q
882

883

Q
879

880

885

Q
881

Q
881

Q
912

Q
867

Q
821

830

Q
866

Q
866

Q
866

Q
866

Q
866

Q
866

Q
866

Q
866

Q
866

Q
866

Q
866

Q
866

Q
866

Q
866

Q
866

Q
866

Q
866

Q
866

Q
866

Q
866

Q
866

Q
866

Q
854/1

Q
857

856

Q
859

858

860

Q
861

862

864

875

887

Q
888

889

Q
890

Q
892



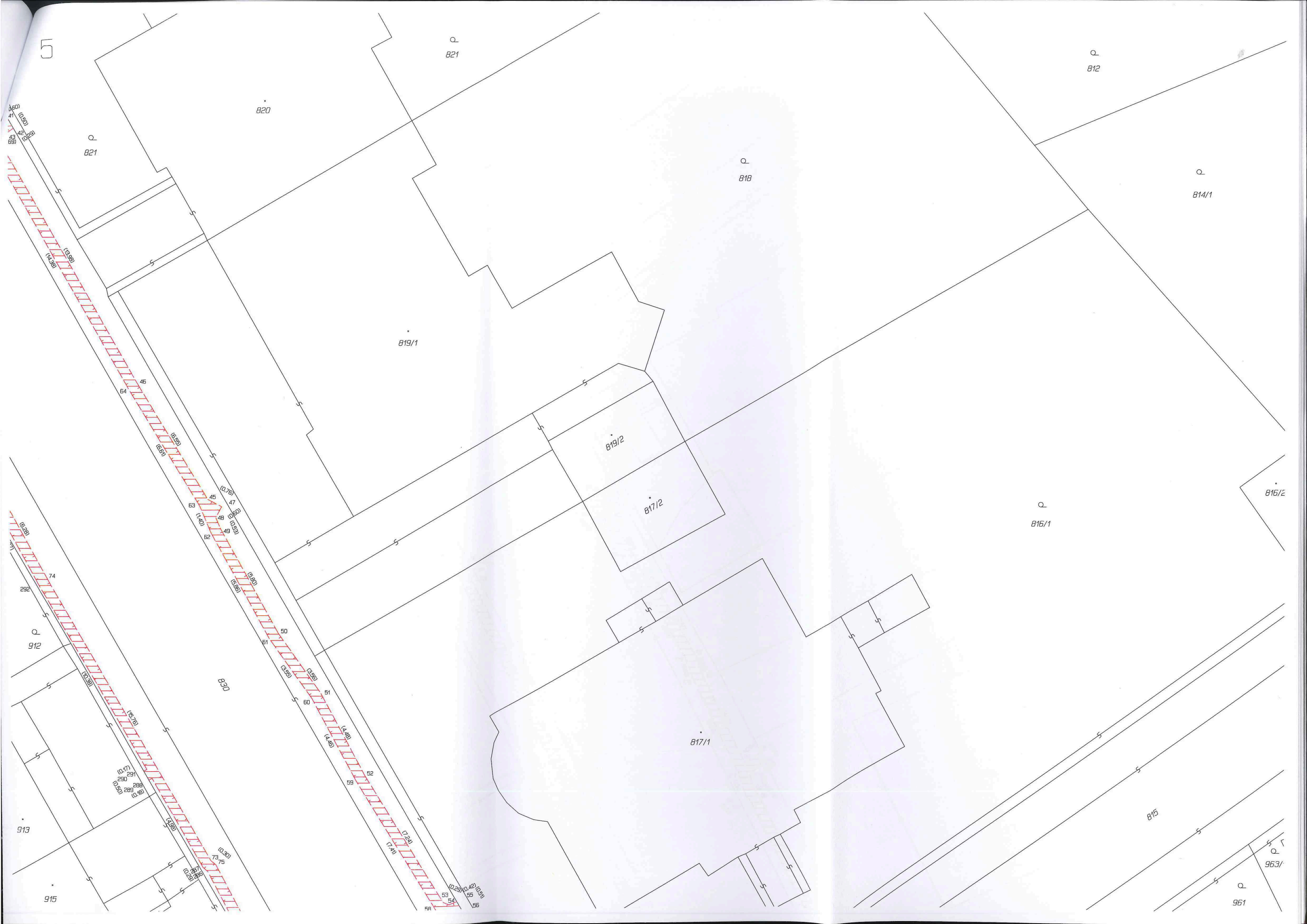



911

909

907

916

910

898

911

908

906/1

900

920

903

922/1

906/2

905

922/3

904

922/1

923

921

922/2





Q 901
902

904

Q 905

918

Q 923

924

925

Q 926

1136/1

Q 927

928

Q 930

Q 931

(1.07) 245
(1.90) 244
(2.00) 243
(1.77) 246
(0.70) 239
(0.78) 240
(0.78) 241
(2.53) 242

(8.54) 247
(8.59) 248

(1.34) 249
(1.39) 249
(1.26) 238
(1.26) 237

(0.50) 270
(1.59) 269

(4.37) 236
(4.42) 236

(1.06) 235
(1.06) 234
(0.51) 233

(0.00) 231
(0.00) 232





946

945

944

943

942

941

939/1

830

953

980

979/1

979/2

981

982

985

989/1

991/1

991/2

989/2



Q 935

940

Q 941

942

Q 939/1

Q 939/1

Q 938/1

939/2

939/2

939/3

154

131

(0.51)

(0.97)

(6.87)

(6.85)

130

151 (0.50)

152 (1.30)

153

149 (2.07)

132

133 (2.71)

985

1000/2

999

937

(6.47)

(6.44)

148

134

(0.14)

(9.41)

147 (0.50)

146 (0.48)

135

(6.88)

(6.29)

138 (0.66)

139 (0.00)

142 (0.93)

140 (0.50)

(5.95)

(5.95)

(0.50)

136

137

144 (0.92)

143

Q 1000/1

Q 1003

1001

1002

Q 1004

1136/1