

VÝKAZ DOSAVADNÍHO A NOVÉHO STAVU ÚDAJŮ KATASTRU NEMOVITOSTÍ

| Dosavadní stav | | | | Nový stav | | | | | | | | | | | | |
|----------------------------------|----------------|----------------|----------------|----------------------------------|----------------|----------------|----------------|----------------|------------------------|--|---------------------------|----------------------------|-------------|----------------|------------------|--|
| Označení pozemku parc. číslem | Výměra parcely | | Druh pozemku | Označení pozemku parc. číslem | Výměra parcely | | Druh pozemku | Typ stavby | Způsob určení výměr | Porovnání se stavem evidence právních vztahů | | | | | | |
| | ha | m ² | Způsob využití | | ha | m ² | Způsob využití | Způsob využití | | Díl přechází z pozemku označeného v | | Číslo listu vlastnictví | Výměra dílu | | Označení dílu | |
| | | | | | | | | | | katastru nemovitostí | dřívější poz. evidenci | | ha | m ² | | |
| 958/1 | | | | | | | | | | 958/1 | | | 10001 | | | |
| 961/1 | | | | | | | | | | 961/1 | | | 10001 | | | |
| 989/6 | | | | | | | | | | 989/6 | | | 10001 | | | |
| 992/1 | | | | | | | | | | 992/1 | | | 10001 | | | |
| 998/8 | | | | | | | | | | 998/8 | | | 10001 | | | |
| 1001/37 | | | | | | | | | | 1001/37 | | | 10001 | | | |
| 1001/53 | | | | | | | | | | 1001/53 | | | 10001 | | | |
| 2352/24 | | | | | | | | | | 2352/24 | | | 10001 | | | |
| 2383/2 | | | | | | | | | | 2383/2 | | | 10001 | | | |
| 2384/1 | | | | | | | | | | 2384/1 | | | 10001 | | | |
| 2384/9 | | | | | | | | | | 2384/9 | | | 10001 | | | |
| 2384/11 | | | | | | | | | | 2384/11 | | | 10001 | | | |
| 2385/7 | | | | | | | | | | 2385/7 | | | 10001 | | | |
| 2385/8 | | | | | | | | | | 2385/8 | | | 10001 | | | |

A: Druh věcného břemene: dle právních listin
Oprávněný: dle právních listin

B: Druh věcného břemene: dle právních listin
Oprávněný: dle právních listin

| GEOMETRICKÝ PLÁN pro vymezení rozsahu věcného břemene k části pozemku | Geometrický plán ověřil úředně oprávněný zeměměřický inženýr | Stejnopis ověřil úředně oprávněný zeměměřický inženýr |
|---|--|---|
| | Jméno, příjmení: Ing. Jiří Kalista | Jméno, příjmení: Ing. Jiří Kalista |
| | Číslo položky seznamu úředně oprávněných zeměměřických inženýrů: 570/1995 | Číslo položky seznamu úředně oprávněných zeměměřických inženýrů: 570/1995 |
| | Dne: 13.3.2020 Číslo: 205/2020 | Dne: 18.3.2020 Číslo: 175/2020 |
| | Náležitosti a přesnosti odpovídá právním předpisům. | Tento stejnopis odpovídá geometrickému plánu v elektronické podobě uloženému v dokumentaci katastrálního úřadu. |
| Vyhotovitel: HRDLIČKA spol.s.r.o Děčínská 361/7 470 01 Česká Lípa | Katastrální úřad souhlasí s ořizováním parcel. | Ověření stejnopisu geometrického plánu v listinné podobě. |
| Číslo plánu: 6377-192478/2019 | KÚ pro Liberecký kraj KP Jablonec nad Nisou Ing. Jana Zieglerová PGP- 346/2020-504 2020.03.18 10:42:27 CET |  |
| Okres: Jablonec nad Nisou | | |
| Obec: Jablonec nad Nisou | | |
| Kat. území: Jablonec nad Nisou | | |
| Mapový list: DKM, Liberec 2-9/41, 43 | | |
| Dosavadním vlastníkům pozemků byla poskytnuta možnost seznámit se v terénu s průběhem navrhovaných nových hranic, které byly označeny předepsaným způsobem: | | |

Seznam souřadnic (S-JTSK):

Souřadnice pro zápis do KN

| Číslo bodu | Y | X | kk | Poznámka |
|------------|-----------|-----------|----|----------|
| 182-23 | 680867.23 | 979235.98 | 3 | |
| 182-64 | 680850.26 | 979301.66 | 3 | |
| 182-395 | 680776.38 | 979320.12 | 3 | |
| 182-397 | 680772.10 | 979320.86 | 3 | |
| 182-433 | 680829.67 | 979241.84 | 3 | |
| 182-434 | 680820.02 | 979239.30 | 3 | |
| 183-199 | 680864.11 | 979247.94 | 3 | |
| 4000-708 | 680867.52 | 979234.94 | 3 | |
| 1 | 680787.41 | 979300.11 | 3 | |
| 2 | 680786.37 | 979300.34 | 3 | |
| 3 | 680785.91 | 979302.52 | 3 | |
| 4 | 680785.68 | 979302.48 | 3 | |
| 5 | 680784.82 | 979305.03 | 3 | |
| 6 | 680782.72 | 979309.20 | 3 | |
| 7 | 680779.99 | 979313.18 | 3 | |
| 8 | 680776.32 | 979317.36 | 3 | |
| 9 | 680773.94 | 979319.30 | 3 | |
| 10 | 680772.91 | 979319.83 | 3 | |
| 11 | 680788.34 | 979302.06 | 3 | |
| 12 | 680786.68 | 979305.90 | 3 | |
| 13 | 680784.43 | 979310.20 | 3 | |
| 14 | 680781.61 | 979314.44 | 3 | |
| 15 | 680777.74 | 979318.84 | 3 | |
| 16 | 680775.06 | 979321.02 | 3 | |
| 17 | 680772.01 | 979322.60 | 3 | |
| 18 | 680769.50 | 979323.35 | 3 | |
| 19 | 680769.02 | 979323.43 | 3 | |
| 20 | 680769.34 | 979327.77 | 3 | |
| 21 | 680766.84 | 979321.76 | 3 | |
| 22 | 680767.31 | 979328.07 | 3 | |
| 23 | 680828.80 | 979242.72 | 3 | |
| 24 | 680829.03 | 979241.67 | 3 | |
| 25 | 680830.78 | 979243.22 | 3 | |
| 26 | 680831.01 | 979242.19 | 3 | |
| 27 | 680821.85 | 979240.97 | 3 | |
| 28 | 680822.16 | 979239.86 | 3 | |
| 29 | 680823.82 | 979241.49 | 3 | |
| 30 | 680824.14 | 979240.38 | 3 | |
| 31 | 680820.02 | 979240.45 | 3 | |
| 32 | 680820.32 | 979239.38 | 3 | |
| 33 | 680817.14 | 979241.82 | 3 | |
| 34 | 680817.96 | 979238.76 | 3 | |
| 35 | 680902.46 | 979311.15 | 3 | |
| 36 | 680903.48 | 979311.47 | 3 | |
| 37 | 680904.37 | 979308.46 | 3 | |
| 38 | 680902.36 | 979307.87 | 3 | |
| 39 | 680902.08 | 979308.83 | 3 | |
| 52 | 680905.51 | 979536.28 | 3 | |
| 53 | 680907.32 | 979535.72 | 3 | |
| 57 | 680865.08 | 979230.86 | 3 | |
| 58 | 680865.73 | 979228.47 | 3 | |
| 59 | 680847.74 | 979302.98 | 3 | |
| 60 | 680850.52 | 979290.73 | 3 | |
| 61 | 680852.81 | 979282.22 | 3 | |
| 62 | 680856.88 | 979266.33 | 3 | |
| 63 | 680860.67 | 979252.17 | 3 | |
| 64 | 680855.15 | 979281.75 | 3 | |
| 65 | 680858.96 | 979266.87 | 3 | |
| 66 | 680862.79 | 979252.59 | 3 | |
| 67 | 680863.03 | 979251.68 | 3 | |
| 68 | 680857.10 | 979282.23 | 3 | |
| 69 | 680854.63 | 979283.75 | 3 | |
| 70 | 680856.61 | 979284.23 | 3 | |
| 71 | 680852.89 | 979290.25 | 3 | |
| 72 | 680852.39 | 979292.25 | 3 | |
| 73 | 680854.46 | 979292.75 | 3 | |
| 74 | 680848.96 | 979308.73 | 3 | |
| 75 | 680848.93 | 979307.52 | 3 | |
| 76 | 680846.82 | 979309.62 | 3 | |

Seznam souřadnic (S-JTSK):

Souřadnice pro zápis do KN

| Číslo bodu | Y | X | kk | Poznámka |
|------------|-----------|-----------|----|----------|
| 77 | 680835.95 | 979307.52 | 3 | |
| 78 | 680848.73 | 979247.88 | 3 | |
| 79 | 680830.13 | 979303.46 | 3 | |
| 80 | 680828.20 | 979301.77 | 3 | |
| 81 | 680825.80 | 979299.36 | 3 | |
| 82 | 680823.25 | 979296.98 | 3 | |
| 83 | 680809.50 | 979299.98 | 3 | |
| 84 | 680802.27 | 979300.64 | 3 | |
| 85 | 680793.72 | 979301.34 | 3 | |
| 86 | 680789.97 | 979301.75 | 3 | |
| 87 | 680846.73 | 979307.47 | 3 | |
| 88 | 680836.77 | 979305.54 | 3 | |
| 89 | 680848.21 | 979249.89 | 3 | |
| 90 | 680831.43 | 979301.82 | 3 | |
| 91 | 680829.64 | 979300.25 | 3 | |
| 92 | 680827.26 | 979297.86 | 3 | |
| 93 | 680823.87 | 979294.70 | 3 | |
| 94 | 680809.18 | 979297.92 | 3 | |
| 95 | 680802.09 | 979298.56 | 3 | |
| 96 | 680793.52 | 979299.26 | 3 | |
| 97 | 680789.67 | 979299.69 | 3 | |
| 98 | 680851.51 | 979321.61 | 3 | |
| 99 | 680851.81 | 979321.52 | 3 | |
| 100 | 680852.03 | 979323.60 | 3 | |
| 101 | 680852.33 | 979323.52 | 3 | |
| 102 | 680855.50 | 979364.85 | 3 | |
| 103 | 680854.02 | 979359.13 | 3 | |
| 104 | 680854.85 | 979342.53 | 3 | |
| 105 | 680855.41 | 979281.81 | 3 | |
| 106 | 680852.74 | 979334.59 | 3 | |
| 107 | 680849.61 | 979322.93 | 3 | |
| 108 | 680853.51 | 979357.13 | 3 | |
| 109 | 680853.27 | 979356.20 | 3 | |
| 110 | 680857.95 | 979354.95 | 3 | |
| 111 | 680855.38 | 979344.58 | 3 | |
| 112 | 680846.28 | 979344.73 | 3 | |
| 113 | 680842.51 | 979345.75 | 3 | |
| 114 | 680845.98 | 979342.67 | 3 | |
| 115 | 680841.98 | 979343.76 | 3 | |
| 116 | 680854.55 | 979333.02 | 3 | |
| 117 | 680854.78 | 979332.95 | 3 | |
| 118 | 680855.09 | 979335.01 | 3 | |
| 119 | 680855.30 | 979334.95 | 3 | |
| 120 | 680849.69 | 979304.56 | 3 | |
| 121 | 680855.25 | 979306.14 | 3 | |
| 122 | 680858.39 | 979306.97 | 3 | |
| 123 | 680859.97 | 979307.35 | 3 | |
| 124 | 680863.91 | 979308.15 | 3 | |
| 125 | 680864.91 | 979308.20 | 3 | |
| 126 | 680866.99 | 979308.11 | 3 | |
| 127 | 680875.83 | 979306.26 | 3 | |
| 128 | 680879.28 | 979306.12 | 3 | |
| 129 | 680882.11 | 979306.50 | 3 | |
| 130 | 680894.42 | 979308.78 | 3 | |
| 131 | 680850.10 | 979302.48 | 3 | |
| 132 | 680855.77 | 979304.10 | 3 | |
| 133 | 680858.95 | 979304.93 | 3 | |
| 134 | 680860.43 | 979305.29 | 3 | |
| 135 | 680864.17 | 979306.05 | 3 | |
| 136 | 680864.91 | 979306.08 | 3 | |
| 137 | 680866.73 | 979306.01 | 3 | |
| 138 | 680875.57 | 979304.16 | 3 | |
| 139 | 680879.38 | 979304.00 | 3 | |
| 140 | 680882.43 | 979304.42 | 3 | |
| 141 | 680894.91 | 979306.72 | 3 | |
| 142 | 680854.94 | 979290.75 | 3 | |
| 143 | 680854.60 | 979250.73 | 3 | |
| 144 | 680853.49 | 979250.58 | 3 | |
| 145 | 680850.91 | 979250.43 | 3 | |

Seznam souřadnic (S-JTSK):

Souřadnice pro zápis do KN

| Číslo bodu | Y | X | kk | Poznámka |
|------------|-----------|-----------|----|----------|
| 146 | 680847.79 | 979249.81 | 3 | |
| 147 | 680829.31 | 979245.00 | 3 | |
| 148 | 680822.28 | 979243.26 | 3 | |
| 149 | 680818.48 | 979242.19 | 3 | |
| 150 | 680818.12 | 979242.09 | 3 | |
| 151 | 680861.21 | 979250.14 | 3 | |
| 152 | 680854.89 | 979283.81 | 3 | |
| 153 | 680854.96 | 979248.67 | 3 | |
| 154 | 680853.69 | 979248.50 | 3 | |
| 155 | 680851.17 | 979248.35 | 3 | |
| 156 | 680848.29 | 979247.79 | 3 | |
| 157 | 680865.95 | 979232.35 | 3 | |
| 158 | 680867.40 | 979230.55 | 3 | |
| 159 | 680867.81 | 979229.03 | 3 | |
| 160 | 680868.30 | 979232.10 | 3 | |
| 161 | 680846.12 | 979359.55 | 3 | |
| 162 | 680846.65 | 979361.55 | 3 | |
| 163 | 680856.01 | 979366.84 | 3 | |
| 164 | 680852.84 | 979367.66 | 3 | |
| 165 | 680845.61 | 979371.66 | 3 | |
| 166 | 680852.08 | 979365.72 | 3 | |
| 167 | 680844.61 | 979369.86 | 3 | |
| 168 | 680859.53 | 979380.47 | 3 | |
| 169 | 680860.07 | 979382.49 | 3 | |
| 170 | 680856.62 | 979383.29 | 3 | |
| 171 | 680849.28 | 979386.51 | 3 | |
| 172 | 680855.96 | 979381.29 | 3 | |
| 173 | 680848.44 | 979384.59 | 3 | |
| 174 | 680867.64 | 979398.66 | 3 | |
| 175 | 680867.19 | 979397.13 | 3 | |
| 176 | 680866.08 | 979396.24 | 3 | |
| 177 | 680861.89 | 979380.96 | 3 | |
| 178 | 680857.85 | 979365.31 | 3 | |
| 179 | 680855.89 | 979357.74 | 3 | |
| 180 | 680860.57 | 979356.50 | 3 | |
| 181 | 680857.28 | 979343.27 | 3 | |
| 182 | 680866.15 | 979401.30 | 3 | |
| 183 | 680865.32 | 979398.40 | 3 | |
| 184 | 680864.18 | 979397.48 | 3 | |
| 185 | 680868.39 | 979398.45 | 3 | |
| 186 | 680868.97 | 979400.51 | 3 | |
| 187 | 680890.59 | 979481.04 | 3 | |
| 188 | 680893.95 | 979480.13 | 3 | |
| 189 | 680891.14 | 979483.02 | 3 | |
| 190 | 680894.45 | 979482.12 | 3 | |
| 191 | 680872.47 | 979413.57 | 3 | |
| 192 | 680896.04 | 979500.96 | 3 | |
| 193 | 680899.29 | 979500.08 | 3 | |
| 194 | 680899.49 | 979500.89 | 3 | |
| 195 | 680902.35 | 979500.20 | 3 | |
| 196 | 680901.07 | 979498.30 | 3 | |
| 197 | 680901.89 | 979498.10 | 3 | |
| 198 | 680893.67 | 979500.41 | 3 | |
| 199 | 680885.59 | 979502.37 | 3 | |
| 200 | 680885.50 | 979502.05 | 3 | |
| 201 | 680883.07 | 979502.63 | 3 | |
| 202 | 680894.21 | 979502.50 | 3 | |
| 203 | 680884.07 | 979504.95 | 3 | |
| 204 | 680883.98 | 979504.63 | 3 | |
| 205 | 680883.55 | 979504.73 | 3 | |
| 206 | 680900.26 | 979517.46 | 3 | |
| 207 | 680900.79 | 979519.45 | 3 | |
| 208 | 680903.84 | 979518.62 | 3 | |
| 209 | 680903.30 | 979516.63 | 3 | |
| 210 | 680898.73 | 979520.07 | 3 | |
| 211 | 680892.89 | 979521.74 | 3 | |
| 212 | 680899.28 | 979522.05 | 3 | |
| 213 | 680893.45 | 979523.72 | 3 | |
| 214 | 680853.20 | 979290.33 | 3 | |

Seznam souřadnic (S-JTSK):

Souřadnice pro zápis do KN

| Číslo bodu | Y | X | kk | Poznámka |
|------------|-----------|-----------|----|----------|
| 215 | 680906.15 | 979538.69 | 3 | |
| 216 | 680907.94 | 979537.99 | 3 | |
| 217 | 680852.68 | 979292.32 | 3 | |
| 218 | 680892.26 | 979306.23 | 3 | |
| 219 | 680903.83 | 979538.33 | 3 | |
| 220 | 680891.98 | 979308.33 | 3 | |
| 221 | 680909.72 | 979561.27 | 3 | |
| 222 | 680910.04 | 979562.46 | 3 | |
| 223 | 680911.56 | 979559.75 | 3 | |
| 224 | 680912.94 | 979561.73 | 3 | |
| 225 | 680912.89 | 979561.54 | 3 | |
| 226 | 680911.31 | 979564.04 | 3 | |
| 227 | 680911.00 | 979562.82 | 3 | |
| 228 | 680913.39 | 979563.49 | 3 | |
| 229 | 680913.06 | 979562.27 | 3 | |
| 230 | 680915.20 | 979560.96 | 3 | |
| 231 | 680914.68 | 979558.97 | 3 | |
| 232 | 680928.61 | 979620.22 | 3 | |
| 233 | 680920.05 | 979622.99 | 3 | |
| 234 | 680929.15 | 979622.18 | 3 | |
| 235 | 680920.61 | 979624.94 | 3 | |
| 236 | 680946.41 | 979688.17 | 3 | |
| 237 | 680946.10 | 979686.96 | 3 | |
| 238 | 680948.51 | 979687.75 | 3 | |
| 239 | 680948.19 | 979686.46 | 3 | |
| 240 | 680949.32 | 979690.21 | 3 | |
| 241 | 680946.73 | 979690.97 | 3 | |
| 242 | 680948.68 | 979688.11 | 3 | |
| 243 | 680946.13 | 979688.85 | 3 | |
| 244 | 680898.44 | 979519.03 | 3 | |
| 245 | 680895.51 | 979498.87 | 3 | |
| 246 | 680900.85 | 979497.42 | 3 | |
| 247 | 680894.87 | 979496.38 | 3 | |
| 248 | 680870.39 | 979414.17 | 3 | |
| 249 | 680888.78 | 979482.60 | 3 | |
| 250 | 680892.79 | 979496.97 | 3 | |
| 251 | 680841.24 | 979326.33 | 3 | |
| 252 | 680839.13 | 979327.10 | 3 | |
| 253 | 680837.72 | 979327.48 | 3 | |
| 254 | 680849.10 | 979320.91 | 3 | |
| 255 | 680840.50 | 979324.41 | 3 | |
| 256 | 680838.51 | 979325.14 | 3 | |
| 257 | 680837.20 | 979325.49 | 3 | |
| 258 | 680847.35 | 979313.95 | 3 | |
| 259 | 680846.86 | 979311.35 | 3 | |
| 260 | 680851.42 | 979321.25 | 3 | |
| 261 | 680849.45 | 979313.47 | 3 | |
| 262 | 680849.02 | 979311.15 | 3 | |
| 263 | 680834.14 | 979303.71 | 3 | |
| 264 | 680833.58 | 979305.86 | 3 | |
| 265 | 680790.13 | 979299.64 | 3 | |
| 266 | 680789.43 | 979301.85 | 3 | |
| 267 | 680771.57 | 979322.73 | 3 | |
| 268 | 680848.30 | 979367.81 | 3 | |
| 269 | 680848.85 | 979369.87 | 3 | |
| 270 | 680852.32 | 979382.89 | 3 | |
| 271 | 680852.87 | 979384.94 | 3 | |
| 272 | 680898.38 | 979498.09 | 3 | |
| 273 | 680898.92 | 979500.18 | 3 | |
| 274 | 680886.32 | 979502.19 | 3 | |
| 275 | 680886.82 | 979504.29 | 3 | |

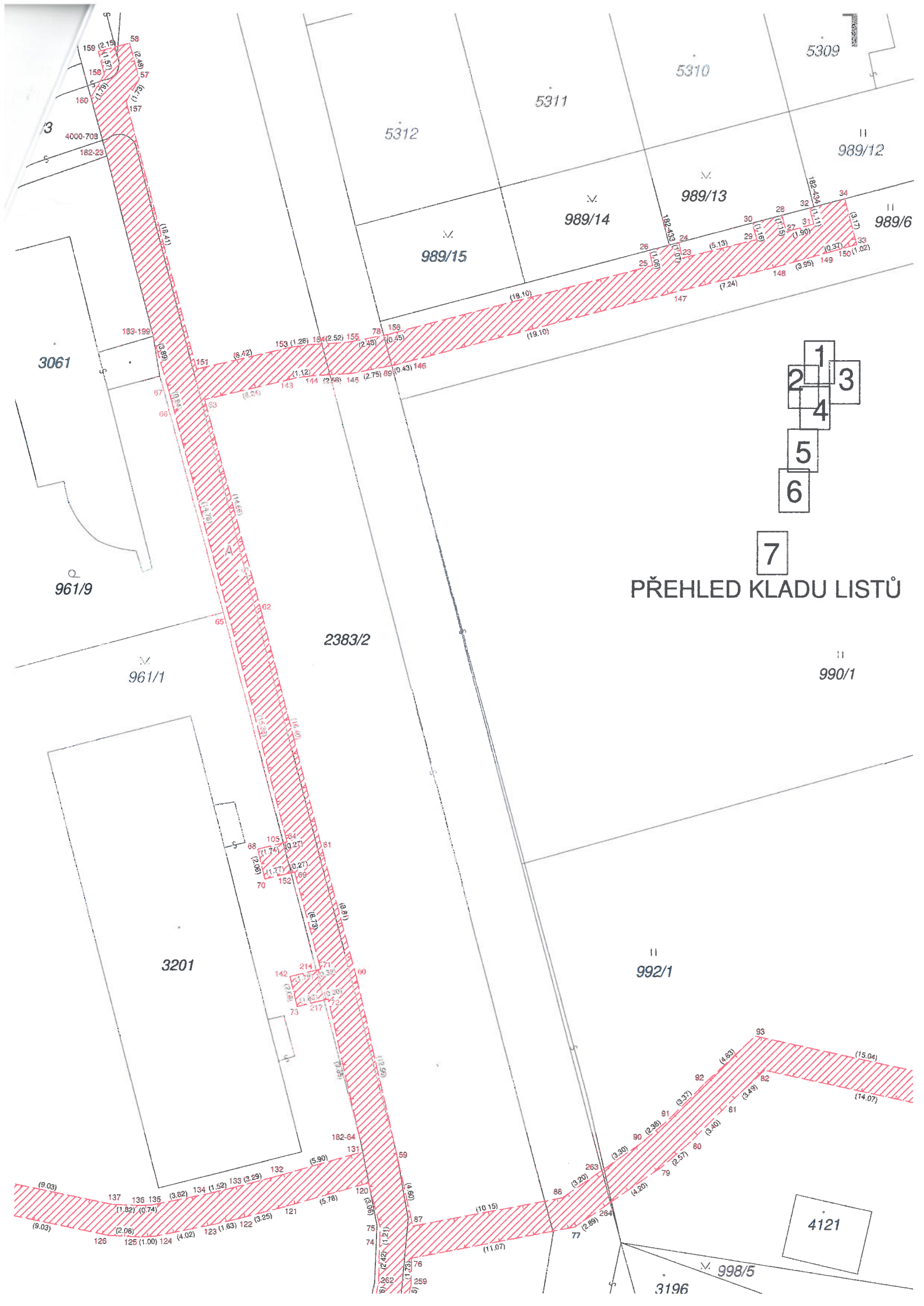

- 1
- 2
- 3
- 4
- 5
- 6
- 7

PŘEHLED Kladu LISTŮ

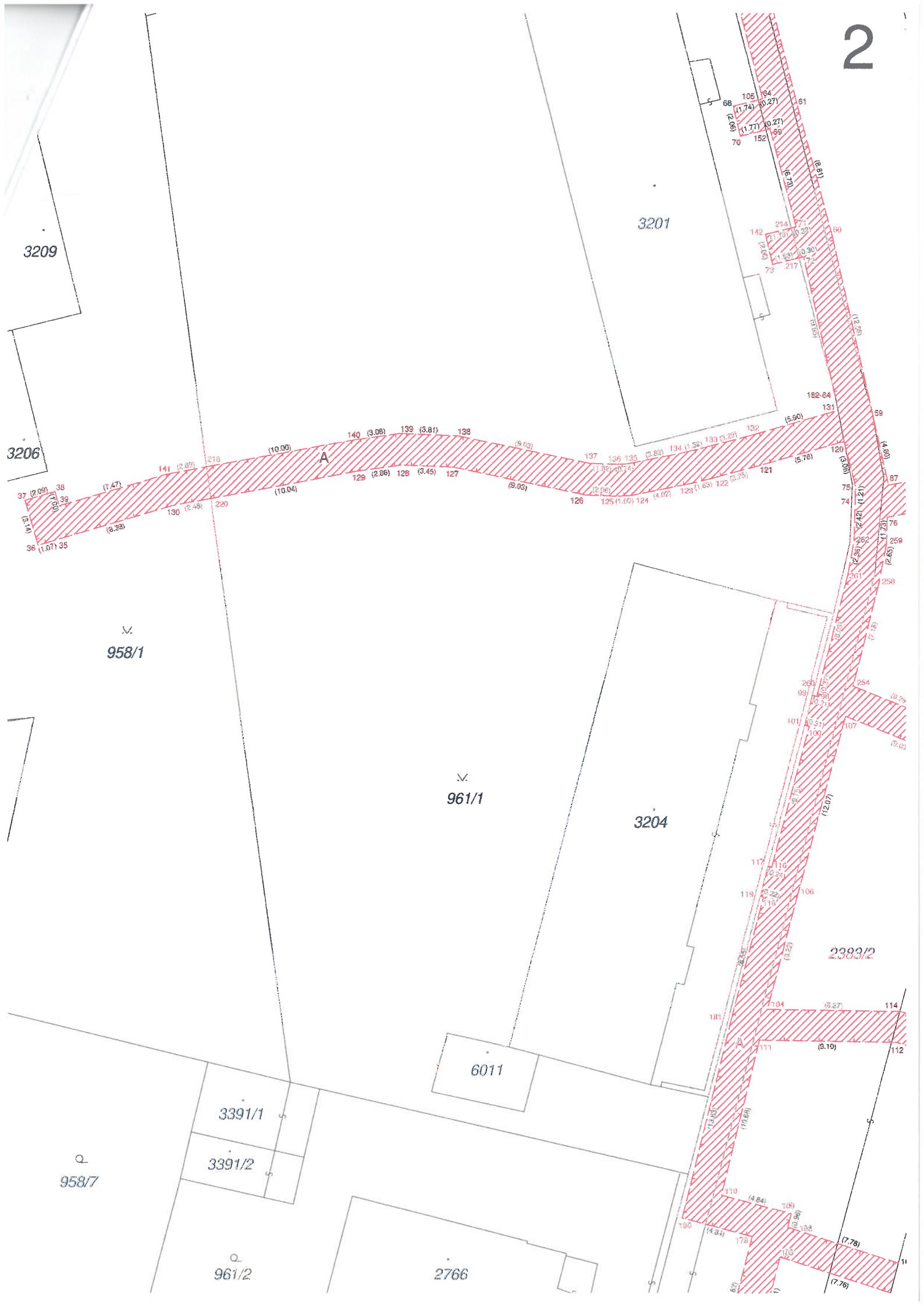

0/1

5387

1001/5

992/1

2385/7

3540

4121

3196

998/5

1001/37

5271

5270

3405

4440

5269

5268

5267

5266

5265

5264

2385/8

998/6

1001/52

1001/44

1001/50

311

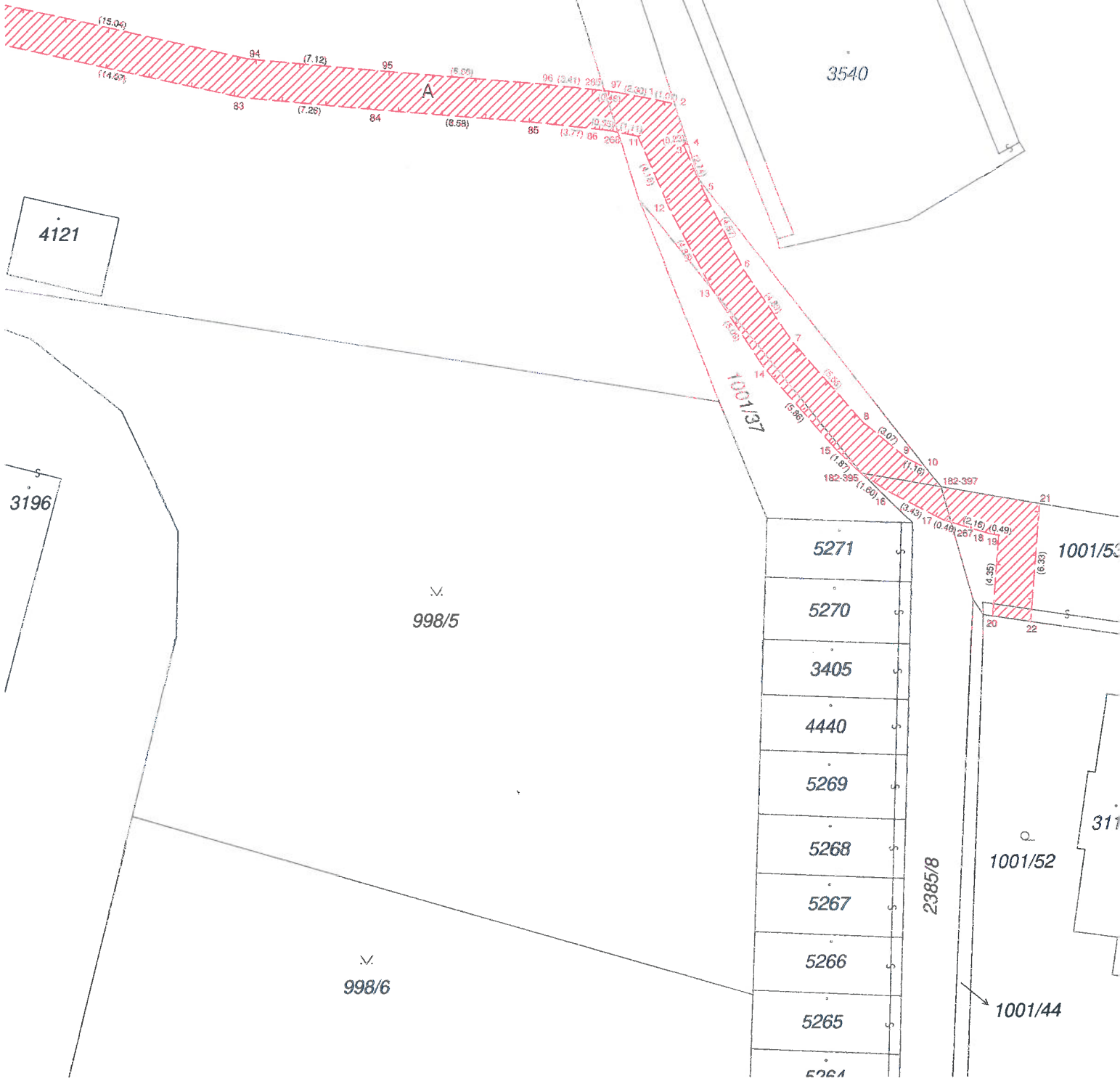

2384/2

5

3539

191 249 248

995/6

958/2

2384/9

(68.86)

(70.86)

958/13

995/4

996/3

5072

996/2

901/1

2980

188 (3.46) 187
190 (3.42) 184 249

(19.87) (14.82)

170/8

996/4

1771

5072



170/8

996/4

1771

2384/11

170/13

1724

2384/1

1932

2487

113

2384/9

170/14

150/1

150/12

1409

150/13

170/9



170/2

150/7

2966

704/3

704/4

704/5

704/6

704/7

871/1

1112

170/4

704/1

2384/9

170/1

1124

2352/17

2352/24

2352/15

2551/1

156/4

661/1

1783

7

