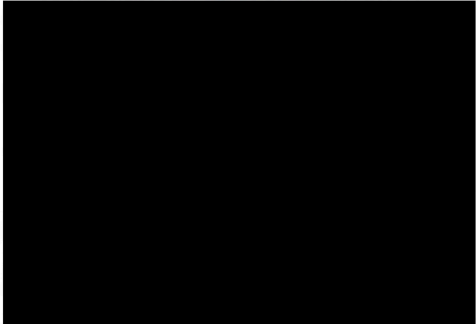

GEOMETRICKÝ PLÁN pro vymezení rozsahu věcného břemene k části pozemku	Geometrický plán ověřil úředně oprávněný zeměměřický inženýr:	Stejnopis ověřil úředně oprávněný zeměměřický inženýr:
	Jméno, příjmení: ██████████	Jméno, příjmení: ██████████
	Číslo položky seznamu úředně oprávněných zeměměřických inženýrů: 2717/2015	Číslo položky seznamu úředně oprávněných zeměměřických inženýrů: 388/95
	Dne: 2.12.2020 Číslo: 411/2020	Dne: 31.3.2021 Číslo: 1091/2021
	Náležitostmi a přesností odpovídá právním předpisům.	Tento stejnopis odpovídá geometrickému plánu v elektronické podobě uloženému v dokumentaci katastrálního úřadu.
Vyhotovitel: GK GEO2007, s.r.o. Vrchní I 691 63 Velké Němčice IČ: 27736458	Katastrální úřad souhlasí s očíslováním parcel.	Ověření stejnopisu geometrického plánu v listinné podobě.
Číslo plánu: 3247-470/2020	KÚ pro Jihomoravský kraj KP Brno-město ██████████ PGP-2340/2020-702 2020.12.07 13:37:31 CET	
Okres: Brno-město		
Obec: Brno		
Kat. území: Řečkovice		
Mapový list: Blansko 9-7/13		
Dosavadním vlastníkům pozemků byla poskytnuta možnost seznámit se v terénu s průběhem navrhovaných nových hranic, které byly označeny předepsaným způsobem:		

VÝKAZ DOSAVADNÍHO A NOVÉHO STAVU ÚDAJŮ KATASTRU NEMOVITOSTÍ

Dosavadní stav			Nový stav																	
Označení pozemku parc. číslem	Výměra parcely		Druh pozemku	Označení pozemku parc. číslem	Výměra parcely		Druh pozemku	Typ stavby	Způsob využití	Způsob využití	Způsob využití	Porovnání se stavem evidence právních vztahů								
	ha	m ²			Způsob využití	ha						m ²	Způsob využití	Způsob využití	Díl přechází z pozemku označeného v		Číslo listu vlastnictví	Výměra dílu		Označení dílu
															katastru nemovitostí	dřívější poz. evidenci		ha	m ²	
29/8												29/8		10001						
29/9												29/9		10001						
29/10												29/10		10001						
29/14												29/14		10001						
29/16												29/16		10001						
31/1												31/1		3479						
32/2												32/2		3592						
36/4												36/4		3565						
39/1												39/1		3521						
41/3												41/3		3545						
44/3												44/3		3561						
46/6												46/6		10001						
46/7												46/7		10001						
46/10												46/10		10001						
46/12												46/12		10001						
46/13												46/13		10001						
46/14												46/14		10001						
46/15												46/15		10001						
46/16												46/16		10001						
46/19												46/19		10001						
46/21												46/21		10001						
46/22												46/22		10001						
46/23												46/23		10001						
46/27												46/27		10001						
225/13												225/13		10001						
225/14												225/14		10001						
225/15												225/15		5583						
225/16												225/16		5583						
225/17												225/17		5583						
225/20												225/20		60000						
225/21												225/21		10001						
225/22												225/22		5595						
225/23												225/23		5595						
225/24												225/24		5595						
225/27												225/27		60000						
225/28												225/28		10001						
225/31												225/31		10001						
225/34												225/34		5576						
225/193												225/193		2099						
235												235		10001						
561/32												561/32		10001						
3945/24												3945/24		10001						
3953/2												3953/2		10001						
3953/5												3953/5		10001						
3953/80												3953/80		7048						
3953/83												3953/83		10001						
3953/99												3953/99		10001						
3953/100												3953/100		10001						
3954/1												3954/1		10001						
3966/2												3966/2		10001						
3966/4												3966/4		10001						
3966/5												3966/5		10001						
3966/6												3966/6		10001						
3966/7												3966/7		10001						
3966/28												3966/28		10001						
3966/29												3966/29		10001						
3966/32												3966/32		3338						
3966/39												3966/39		10001						
3966/40												3966/40		10001						
3966/41												3966/41		10001						

VÝKAZ DOSAVADNÍHO A NOVÉHO STAVU ÚDAJŮ KATASTRU NEMOVITOSTÍ

Dosavadní stav			Nový stav											
Označení pozemku parc. číslem	Výměra parcely		Druh pozemku Způsob využití	Označení pozemku parc. číslem	Výměra parcely		Druh pozemku Způsob využití	Typ stavby Způsob využití	Zpús. určení výměr	Porovnání se stavem evidence právních vztahů				
	ha	m ²			ha	m ²				Díl přechází z pozemku označeného v katastru nemovitostí	Číslo listu vlastnictví	Výměra dílu		Označení dílu
			ha				m ²							
3966/42										3966/42	10001			
3966/43										3966/43	10001			
3966/44										3966/44	10001			
3966/45										3966/45	10001			
3966/99										3966/99	10001			
3966/117										3966/117	10001			
3966/118										3966/118	6877			
3966/119										3966/119	10001			

Oprávněný: Dle listin

Druh věcného břemene: Dle listin

Seznam souřadnic (S-JTSK)
 Číslo bodu Souřadnice pro zápis do KN

	Y	X	Kód kv.
k.ú. Řečkovice (611646)			
7-268	599795.50	1154982.20	3
7-269	599794.72	1154984.58	3
146-553	599875.30	1154539.23	3
146-562	599871.81	1154557.51	3
2621-116	599866.98	1154798.73	3
2622-347	599858.88	1154752.76	6
2622-413	599876.65	1154787.19	3
2622-444	599741.75	1154711.53	6
2622-455	599781.48	1154723.62	3
2800-1074	599813.38	1154931.47	3
2800-1113	599810.37	1154939.98	6
2800-1130	599811.94	1155100.58	6
2800-1169	599895.29	1154774.49	6
2800-1170	599894.06	1154774.07	6
2800-1171	599894.86	1154774.34	6
2800-1260	599899.46	1154700.07	6
2879-152	599804.80	1155082.37	6
1	599908.88	1154577.56	3
2	599908.72	1154578.03	3
3	599908.31	1154577.41	3
4	599908.14	1154577.88	3
5	599905.80	1154576.74	3
6	599905.50	1154577.18	3
7	599905.53	1154576.34	3
8	599905.01	1154576.46	3
9	599905.78	1154574.16	3
10	599905.28	1154574.04	3
11	599906.92	1154570.87	3
12	599906.42	1154570.81	3
13	599906.78	1154569.21	3
14	599906.30	1154569.35	3
15	599905.97	1154567.66	3
16	599905.51	1154567.84	3
17	599905.64	1154566.37	3
18	599905.12	1154566.37	3
19	599907.67	1154558.71	3
20	599907.14	1154558.77	3
21	599907.48	1154558.02	3
22	599907.92	1154558.27	3
23	599911.68	1154559.95	3
24	599911.84	1154559.48	3
25	599912.24	1154560.13	3
26	599912.41	1154559.66	3
27	599911.60	1154545.69	3
28	599911.12	1154545.57	3
29	599912.32	1154540.55	3
30	599912.80	1154540.67	3
31	599912.94	1154540.19	3
32	599915.45	1154541.31	3
33	599915.61	1154540.83	3
34	599916.03	1154541.45	3
35	599916.20	1154540.98	3
36	599915.04	1154533.07	3
37	599914.56	1154532.95	3
38	599915.78	1154527.04	3
39	599916.32	1154526.94	3
40	599915.79	1154526.11	3
41	599915.47	1154526.55	3
42	599913.85	1154526.13	3
43	599914.05	1154525.67	3
44	599912.29	1154525.08	3
45	599912.63	1154524.72	3
46	599912.37	1154524.37	3
47	599911.62	1154524.21	3
48	599911.45	1154523.99	3
49	599911.73	1154523.53	3
50	599898.13	1154521.24	3

č.b.	Y	X	KK
51	599898.23	1154520.75	3
52	599893.79	1154520.35	3
53	599893.89	1154519.85	3
54	599893.66	1154519.81	3
55	599893.34	1154520.25	3
56	599892.05	1154518.02	3
57	599892.35	1154517.54	3
58	599891.49	1154517.45	3
59	599891.39	1154517.95	3
60	599878.64	1154513.80	3
61	599878.62	1154513.26	3
62	599877.91	1154513.56	3
63	599878.31	1154513.94	3
64	599876.26	1154519.86	3
65	599875.78	1154519.70	3
66	599874.14	1154526.27	3
67	599873.66	1154526.15	3
68	599873.99	1154527.11	3
69	599873.91	1154527.60	3
70	599876.29	1154528.33	3
71	599876.45	1154527.86	3
72	599876.98	1154528.02	3
73	599876.83	1154528.49	3
74	599871.99	1154538.39	3
75	599872.09	1154537.89	3
76	599871.55	1154538.03	3
77	599873.50	1154538.77	3
78	599875.91	1154539.33	3
79	599876.07	1154538.85	3
80	599875.47	1154538.71	3
81	599870.91	1154543.62	3
82	599870.43	1154543.52	3
83	599868.99	1154551.50	3
84	599868.51	1154551.40	3
85	599867.59	1154555.88	3
86	599868.10	1154555.85	3
87	599868.30	1154556.07	3
88	599867.96	1154556.49	3
89	599870.06	1154557.05	3
90	599872.37	1154557.70	3
91	599871.96	1154557.07	3
92	599872.53	1154557.23	3
93	599867.44	1154558.71	3
94	599866.94	1154558.61	3
95	599866.51	1154564.22	3
96	599866.03	1154564.10	3
97	599866.24	1154565.14	3
98	599865.80	1154564.86	3
99	599865.40	1154565.88	3
100	599865.20	1154565.38	3
101	599864.01	1154565.93	3
102	599864.09	1154565.43	3
103	599855.21	1154562.92	3
104	599855.13	1154562.36	3
105	599854.74	1154563.24	3
106	599854.32	1154562.92	3
107	599852.81	1154569.58	3
108	599852.33	1154569.44	3
109	599849.07	1154582.60	3
110	599848.57	1154582.52	3
111	599849.01	1154583.90	3
112	599848.51	1154583.92	3
113	599849.11	1154584.51	3
114	599848.63	1154584.69	3
115	599849.39	1154585.92	3
116	599849.53	1154586.14	3
117	599850.01	1154585.96	3
118	599850.04	1154586.16	3
119	599851.24	1154593.01	3
120	599850.70	1154592.83	3

č.b.	Y	X	KK	č.b.	Y	X	KK
121	599851.30	1154593.36	3	191	599930.21	1154671.15	3
122	599850.78	1154593.30	3	192	599929.73	1154670.99	3
123	599850.75	1154594.76	3	193	599928.92	1154674.50	6
124	599850.27	1154594.60	3	194	599928.44	1154674.34	6
125	599849.50	1154598.81	3	195	599928.14	1154676.53	3
126	599849.00	1154598.71	3	196	599927.76	1154676.13	3
127	599849.14	1154601.72	3	197	599927.31	1154676.83	3
128	599848.64	1154601.78	3	198	599927.29	1154676.31	3
129	599848.88	1154602.50	3	199	599925.56	1154675.79	3
130	599849.28	1154602.14	3	200	599925.40	1154676.27	3
131	599851.60	1154603.77	3	201	599921.13	1154674.62	3
132	599851.76	1154603.29	3	202	599921.27	1154674.14	3
133	599860.21	1154605.96	3	203	599919.12	1154673.67	3
134	599860.41	1154605.50	3	204	599919.10	1154674.17	3
135	599861.09	1154606.54	3	205	599918.12	1154674.29	3
136	599861.55	1154606.24	3	206	599917.88	1154673.81	3
137	599861.71	1154607.38	3	207	599917.10	1154675.46	3
138	599861.19	1154607.32	3	208	599916.64	1154675.22	3
139	599860.01	1154612.12	3	209	599916.90	1154676.40	3
140	599859.53	1154611.96	3	210	599916.38	1154676.42	3
141	599857.25	1154620.54	3	211	599918.19	1154680.19	3
142	599856.75	1154620.46	3	212	599917.71	1154680.35	3
143	599856.84	1154625.08	3	213	599921.26	1154688.33	3
144	599857.34	1154625.10	3	214	599920.68	1154688.23	3
145	599857.25	1154626.28	3	215	599920.71	1154688.98	3
146	599856.75	1154626.22	3	216	599920.41	1154688.56	3
147	599857.03	1154627.74	3	217	599915.17	1154691.04	3
148	599856.55	1154627.62	3	218	599914.81	1154690.64	3
149	599855.30	1154633.30	3	219	599914.93	1154691.53	3
150	599854.80	1154633.22	3	220	599914.41	1154691.47	3
151	599855.26	1154634.29	3	221	599915.55	1154693.91	3
152	599854.76	1154634.31	3	222	599915.03	1154693.91	3
153	599855.50	1154637.01	3	223	599915.24	1154695.04	3
154	599855.00	1154637.07	3	224	599914.82	1154694.70	3
155	599856.02	1154639.87	3	225	599914.12	1154695.65	3
156	599855.52	1154639.91	3	226	599913.98	1154695.15	3
157	599855.41	1154641.76	3	227	599909.78	1154695.67	3
158	599855.93	1154641.42	3	228	599909.68	1154695.17	3
159	599865.92	1154645.50	3	229	599904.20	1154698.34	6
160	599866.10	1154645.04	3	230	599904.39	1154697.70	6
161	599871.95	1154648.13	3	231	599903.56	1154698.65	3
162	599872.05	1154647.64	3	232	599903.36	1154698.19	3
163	599873.86	1154648.44	3	233	599900.82	1154699.70	3
164	599873.76	1154648.92	3	234	599900.62	1154699.24	3
165	599889.87	1154654.52	3	235	599899.77	1154700.21	6
166	599890.01	1154654.04	3	236	599899.57	1154699.75	6
167	599891.96	1154654.54	3	237	599899.34	1154700.41	6
168	599892.43	1154654.72	3	238	599897.69	1154701.21	3
169	599891.99	1154655.07	3	239	599897.43	1154700.79	3
170	599893.78	1154655.94	3	240	599896.69	1154702.00	3
171	599893.96	1154655.48	3	241	599896.27	1154701.70	3
172	599893.67	1154652.52	3	242	599894.59	1154708.37	6
173	599893.19	1154652.34	3	243	599894.11	1154708.22	6
174	599893.95	1154651.32	3	244	599894.34	1154709.10	3
175	599893.59	1154650.68	3	245	599893.88	1154708.92	3
176	599895.86	1154651.90	3	246	599893.81	1154710.37	3
177	599896.02	1154651.43	3	247	599893.41	1154710.03	3
178	599896.60	1154651.60	3	248	599892.74	1154711.07	3
179	599896.44	1154652.08	3	249	599892.60	1154710.57	3
180	599898.00	1154657.16	3	250	599887.30	1154710.91	3
181	599898.16	1154656.68	3	251	599887.20	1154710.41	3
182	599911.65	1154662.26	3	252	599886.92	1154711.10	3
183	599911.83	1154661.80	3	253	599886.56	1154710.72	3
184	599932.85	1154668.53	3	254	599884.66	1154715.07	3
185	599933.00	1154669.00	3	255	599884.17	1154714.92	3
186	599930.67	1154668.69	3	256	599884.46	1154715.41	3
187	599930.59	1154669.19	3	257	599884.00	1154715.23	3
188	599931.70	1154669.11	3	258	599884.17	1154716.67	3
189	599930.69	1154670.47	3	259	599883.67	1154716.51	3
190	599930.33	1154670.11	3	260	599883.70	1154723.40	3

č.b.	Y	X	KK	č.b.	Y	X	KK
261	599883.20	1154723.30	3	331	599760.46	1154728.79	6
262	599881.63	1154728.94	3	332	599762.66	1154728.78	3
263	599881.15	1154728.78	3	333	599762.62	1154728.28	3
264	599878.26	1154740.90	3	334	599770.71	1154727.60	3
265	599877.80	1154740.71	3	335	599770.51	1154727.12	3
266	599877.72	1154742.82	3	336	599771.96	1154726.60	3
267	599877.24	1154742.70	3	337	599771.70	1154726.18	3
268	599876.61	1154747.94	3	338	599773.84	1154725.69	3
269	599876.15	1154747.74	3	339	599773.66	1154725.23	3
270	599874.49	1154751.26	3	340	599775.21	1154725.25	3
271	599874.13	1154750.90	3	341	599775.07	1154724.77	3
272	599873.84	1154751.72	6	342	599778.12	1154724.55	3
273	599873.30	1154751.50	6	343	599778.02	1154724.05	3
274	599872.77	1154752.49	3	344	599780.39	1154724.22	3
275	599872.61	1154751.99	3	345	599780.87	1154724.15	6
276	599870.12	1154752.39	3	346	599780.79	1154723.67	6
277	599870.10	1154751.89	3	347	599781.56	1154724.08	3
278	599862.82	1154753.13	3	348	599781.57	1154727.54	3
279	599862.60	1154752.65	3	349	599781.13	1154727.88	3
280	599860.91	1154754.92	3	350	599781.93	1154728.29	3
281	599859.65	1154755.40	3	351	599782.03	1154727.77	3
282	599859.36	1154755.45	3	352	599785.00	1154727.41	6
283	599860.54	1154755.59	3	353	599788.67	1154726.97	3
284	599859.63	1154755.91	3	354	599788.69	1154727.47	3
285	599858.96	1154756.01	3	355	599793.82	1154727.26	6
286	599860.10	1154756.13	3	356	599795.31	1154727.85	3
287	599858.24	1154749.24	3	357	599795.65	1154727.81	6
288	599858.42	1154749.21	6	358	599795.29	1154727.35	3
289	599859.10	1154749.09	3	359	599796.77	1154727.15	3
290	599859.04	1154748.59	3	360	599796.57	1154727.69	3
291	599858.35	1154748.71	6	361	599796.79	1154727.93	3
292	599857.66	1154748.84	3	362	599797.27	1154727.71	3
293	599728.90	1154716.75	3	363	599797.33	1154728.30	6
294	599728.41	1154716.84	3	364	599796.81	1154728.15	6
295	599728.32	1154716.14	6	365	599798.64	1154740.44	6
296	599728.81	1154716.05	6	366	599798.12	1154740.28	6
297	599728.27	1154715.72	3	367	599798.17	1154740.73	3
298	599731.40	1154714.84	3	368	599799.08	1154741.50	3
299	599731.24	1154714.36	3	369	599799.24	1154740.98	3
300	599736.02	1154714.02	3	370	599800.11	1154740.89	6
301	599735.94	1154713.52	3	371	599801.34	1154741.26	6
302	599739.15	1154713.55	3	372	599806.09	1154740.76	3
303	599740.13	1154712.82	3	373	599806.14	1154741.04	6
304	599741.42	1154711.44	6	374	599806.26	1154741.82	6
305	599741.69	1154711.15	6	375	599806.76	1154741.75	6
306	599742.29	1154710.51	3	376	599806.63	1154740.97	6
307	599742.40	1154711.12	3	377	599806.59	1154740.73	3
308	599741.95	1154711.61	6	378	599806.69	1154740.20	3
309	599741.79	1154711.77	6	379	599809.97	1154740.04	3
310	599740.48	1154713.18	3	380	599809.77	1154739.58	3
311	599740.22	1154713.68	3	381	599811.89	1154738.70	3
312	599741.27	1154715.19	3	382	599811.71	1154738.22	3
313	599741.73	1154714.99	3	383	599817.56	1154737.86	3
314	599742.24	1154717.21	3	384	599817.50	1154737.36	3
315	599741.76	1154717.31	3	385	599819.33	1154737.22	3
316	599743.35	1154722.89	3	386	599820.16	1154736.60	6
317	599742.88	1154723.08	3	387	599820.79	1154736.13	3
318	599743.82	1154725.24	3	388	599820.88	1154736.69	3
319	599743.32	1154725.34	3	389	599820.24	1154737.16	6
320	599744.11	1154726.93	6	390	599819.83	1154737.47	3
321	599743.63	1154727.12	6	391	599819.09	1154737.74	3
322	599744.41	1154728.68	3	392	599819.45	1154738.02	3
323	599743.93	1154728.82	3	393	599820.40	1154739.92	3
324	599744.20	1154729.48	3	394	599819.92	1154740.06	3
325	599744.60	1154729.14	3	395	599820.48	1154741.84	3
326	599744.89	1154729.88	3	396	599820.96	1154741.72	3
327	599744.99	1154729.36	3	397	599821.52	1154744.67	3
328	599754.33	1154728.80	3	398	599821.02	1154744.75	3
329	599754.31	1154728.30	3	399	599821.69	1154746.24	3
330	599758.83	1154728.29	6	400	599821.19	1154746.34	3

č.b.	Y	X	KK	č.b.	Y	X	KK
401	599821.82	1154746.69	3	471	599885.58	1154774.30	3
402	599821.32	1154746.77	3	472	599884.85	1154778.24	3
403	599821.86	1154747.39	6	473	599884.45	1154777.84	3
404	599821.35	1154747.24	6	474	599884.07	1154777.97	3
405	599822.03	1154750.23	3	475	599884.09	1154778.49	3
406	599821.53	1154750.27	3	476	599880.23	1154776.88	3
407	599822.26	1154752.05	3	477	599879.83	1154777.02	3
408	599821.76	1154752.13	3	478	599879.61	1154777.09	3
409	599822.60	1154754.01	3	479	599880.05	1154777.35	3
410	599822.12	1154754.11	3	480	599876.20	1154787.01	3
411	599822.93	1154755.33	3	481	599873.96	1154794.24	3
412	599822.49	1154755.61	3	482	599873.71	1154794.47	3
413	599823.09	1154756.13	3	483	599869.42	1154793.33	3
414	599823.25	1154755.61	3	484	599869.57	1154792.85	3
415	599832.00	1154754.77	3	485	599868.97	1154792.62	3
416	599831.92	1154754.27	3	486	599868.83	1154793.10	3
417	599835.45	1154754.10	3	487	599867.78	1154792.91	3
418	599835.37	1154753.60	3	488	599868.08	1154792.45	3
419	599841.81	1154753.33	6	489	599864.24	1154794.85	3
420	599840.60	1154752.98	6	490	599863.76	1154795.03	3
421	599845.91	1154752.84	3	491	599864.37	1154795.89	3
422	599845.75	1154752.36	3	492	599864.71	1154795.51	3
423	599846.43	1154751.94	3	493	599866.67	1154796.69	3
424	599846.79	1154752.30	3	494	599866.31	1154797.07	3
425	599848.64	1154749.42	3	495	599866.61	1154797.50	3
426	599848.26	1154749.08	3	496	599867.13	1154797.36	3
427	599848.67	1154748.92	3	497	599866.47	1154799.31	3
428	599850.94	1154748.65	3	498	599866.94	1154799.69	3
429	599850.94	1154749.15	3	499	599866.44	1154799.59	3
430	599851.82	1154749.29	3	500	599866.01	1154802.61	3
431	599852.12	1154748.83	3	501	599865.53	1154802.45	3
432	599852.67	1154749.67	3	502	599864.96	1154805.49	3
433	599852.19	1154749.85	3	503	599864.50	1154805.29	3
434	599853.90	1154756.94	6	504	599864.60	1154806.27	3
435	599853.36	1154756.78	6	505	599864.14	1154806.08	3
436	599853.55	1154757.90	3	506	599862.39	1154811.06	3
437	599854.03	1154757.70	3	507	599861.91	1154810.88	3
438	599854.32	1154758.10	3	508	599861.72	1154813.43	6
439	599854.08	1154758.64	3	509	599861.25	1154813.29	6
440	599857.05	1154758.23	3	510	599860.97	1154816.14	3
441	599856.71	1154757.78	6	511	599860.51	1154815.92	3
442	599857.63	1154758.05	6	512	599860.81	1154816.36	6
443	599858.73	1154757.71	3	513	599860.30	1154816.21	6
444	599858.45	1154757.27	3	514	599858.90	1154819.03	3
445	599860.98	1154759.05	6	515	599858.42	1154818.83	3
446	599860.45	1154758.90	6	516	599858.75	1154820.17	3
447	599862.01	1154767.21	3	517	599858.25	1154820.07	3
448	599861.51	1154767.27	3	518	599858.36	1154821.49	3
449	599862.72	1154774.65	3	519	599857.84	1154821.47	3
450	599862.22	1154774.69	3	520	599859.95	1154830.62	3
451	599863.24	1154781.89	3	521	599859.45	1154830.70	3
452	599862.73	1154781.69	3	522	599860.46	1154834.62	3
453	599863.25	1154788.90	3	523	599859.98	1154834.76	3
454	599863.73	1154788.70	3	524	599860.73	1154835.20	3
455	599863.71	1154789.42	3	525	599860.23	1154835.30	3
456	599864.19	1154789.21	3	526	599860.70	1154835.94	3
457	599864.11	1154789.72	3	527	599860.20	1154835.88	3
458	599863.85	1154790.03	3	528	599860.34	1154837.77	3
459	599863.33	1154789.87	3	529	599859.84	1154837.77	3
460	599866.25	1154790.75	3	530	599860.49	1154838.52	3
461	599866.59	1154790.35	3	531	599860.05	1154838.82	3
462	599895.44	1154774.05	6	532	599861.24	1154839.00	3
463	599895.01	1154773.91	6	533	599860.82	1154839.32	3
464	599891.88	1154773.43	3	534	599863.45	1154846.75	3
465	599892.06	1154772.97	3	535	599862.97	1154846.87	3
466	599890.51	1154772.29	3	536	599865.32	1154854.35	3
467	599890.35	1154772.77	3	537	599866.15	1154854.01	3
468	599889.31	1154772.47	3	538	599866.73	1154853.77	3
469	599889.23	1154771.93	3	539	599866.83	1154854.27	3
470	599886.00	1154774.62	3	540	599866.25	1154854.51	3

č.b.	Y	X	KK	č.b.	Y	X	KK
541	599865.43	1154854.85	3	611	599811.35	1154963.70	3
542	599864.91	1154854.74	3	612	599811.01	1154963.30	3
543	599865.66	1154856.20	3	613	599813.10	1154961.07	3
544	599865.12	1154855.98	3	614	599812.70	1154960.75	3
545	599863.80	1154857.56	3	615	599816.92	1154957.09	3
546	599863.60	1154857.08	3	616	599816.46	1154956.85	3
547	599863.19	1154857.16	3	617	599817.89	1154951.41	3
548	599863.28	1154857.65	3	618	599817.43	1154951.15	3
549	599860.89	1154858.11	3	619	599818.52	1154950.89	3
550	599860.79	1154857.62	3	620	599818.20	1154950.51	3
551	599860.32	1154857.71	3	621	599799.07	1154972.05	6
552	599860.46	1154858.19	3	622	599798.53	1154972.00	3
553	599858.84	1154858.88	3	623	599798.80	1154972.84	6
554	599858.48	1154858.48	3	624	599799.33	1154972.85	3
555	599858.25	1154860.02	3	625	599795.05	1154985.17	3
556	599857.87	1154859.66	3	626	599794.64	1154984.81	3
557	599857.39	1154860.50	3	627	599794.39	1154985.48	3
558	599856.28	1154860.70	3	628	599794.18	1154985.57	3
559	599857.00	1154860.14	3	629	599793.78	1154985.21	3
560	599851.41	1154861.07	3	630	599790.94	1154994.01	3
561	599851.35	1154860.57	3	631	599790.48	1154993.83	3
562	599844.33	1154862.28	3	632	599789.70	1154995.69	3
563	599844.07	1154861.82	3	633	599789.56	1154994.24	3
564	599844.04	1154862.65	3	634	599789.78	1154996.80	3
565	599843.50	1154862.51	3	635	599789.30	1154996.72	3
566	599845.70	1154870.73	3	636	599789.10	1154994.74	3
567	599845.20	1154870.83	3	637	599788.64	1154994.74	3
568	599847.93	1154883.32	3	638	599788.40	1154994.24	3
569	599847.43	1154883.40	3	639	599787.90	1154995.64	3
570	599850.20	1154896.16	3	640	599787.48	1154995.36	3
571	599849.68	1154896.08	3	641	599784.87	1155001.54	6
572	599849.73	1154897.15	3	642	599784.39	1155001.37	6
573	599849.35	1154896.77	3	643	599779.91	1155009.83	6
574	599846.34	1154898.71	3	644	599779.43	1155009.67	6
575	599846.10	1154898.27	3	645	599779.18	1155010.95	6
576	599844.03	1154900.07	3	646	599778.70	1155010.79	6
577	599843.85	1154899.59	3	647	599778.63	1155011.81	3
578	599831.44	1154902.51	3	648	599778.19	1155011.55	3
579	599831.22	1154902.05	3	649	599778.27	1155012.49	6
580	599830.88	1154902.95	3	650	599777.79	1155012.32	6
581	599830.34	1154902.75	3	651	599774.06	1155020.55	3
582	599831.65	1154906.90	3	652	599773.60	1155020.33	3
583	599831.60	1154907.67	3	653	599771.13	1155027.51	3
584	599831.21	1154907.25	3	654	599770.63	1155027.43	3
585	599829.57	1154908.10	3	655	599770.71	1155028.64	3
586	599829.47	1154907.62	3	656	599771.19	1155028.26	3
587	599827.14	1154908.43	3	657	599773.10	1155029.30	3
588	599827.05	1154907.94	3	658	599773.24	1155028.82	3
589	599826.03	1154908.58	3	659	599777.68	1155030.78	3
590	599825.99	1154908.08	3	660	599777.84	1155030.30	3
591	599824.03	1154908.68	3	661	599787.76	1155034.50	3
592	599824.20	1154908.19	3	662	599787.94	1155034.04	3
593	599821.94	1154907.31	3	663	599793.39	1155036.89	3
594	599821.77	1154907.79	3	664	599793.57	1155036.43	3
595	599821.27	1154907.59	3	665	599805.27	1155041.01	3
596	599818.46	1154915.58	3	666	599805.91	1155040.71	3
597	599812.96	1154931.28	3	667	599803.85	1155045.09	3
598	599809.97	1154939.79	6	668	599804.49	1155044.79	3
599	599809.19	1154942.02	3	669	599811.99	1155047.89	3
600	599801.28	1154963.98	3	670	599812.17	1155047.43	3
601	599801.87	1154964.11	6	671	599815.13	1155048.66	3
602	599802.04	1154963.64	6	672	599814.91	1155049.10	3
603	599804.17	1154965.01	6	673	599816.27	1155049.34	3
604	599804.34	1154964.54	6	674	599816.35	1155049.81	3
605	599805.31	1154965.18	3	675	599815.86	1155049.68	3
606	599805.33	1154964.68	3	676	599815.56	1155051.70	3
607	599806.38	1154965.14	3	677	599815.22	1155051.24	3
608	599806.32	1154964.64	3	678	599814.04	1155051.85	3
609	599810.12	1154964.24	3	679	599813.88	1155051.37	3
610	599809.96	1154963.76	3	680	599813.39	1155051.67	3

č.b.	Y	X	KK	č.b.	Y	X	KK
681	599813.83	1155051.99	3	752	599821.50	1155143.38	3
682	599812.09	1155058.73	3	753	599827.22	1155151.41	3
683	599811.61	1155058.59	3	754	599826.54	1155151.27	3
684	599809.59	1155067.44	3	755	599826.20	1155152.13	6
685	599809.11	1155067.28	3	756	599825.94	1155151.70	6
686	599804.92	1155080.51	3	757	599874.35	1154794.53	6
687	599804.44	1155080.39	3	758	599873.83	1154795.05	3
688	599804.85	1155081.18	3	759	599972.79	1154677.49	6
689	599804.33	1155081.24	3	760	599972.31	1154677.32	6
690	599804.63	1155082.10	3	761	599972.88	1154676.98	3
691	599805.07	1155081.82	3	762	599972.42	1154676.70	3
692	599805.26	1155082.01	6	763	599973.63	1154676.12	3
694	599805.63	1155083.09	3	764	599973.17	1154675.90	3
695	599805.91	1155082.67	3	765	599973.99	1154674.45	3
696	599807.64	1155083.45	6	766	599973.51	1154674.33	3
697	599807.36	1155083.88	6	767	599975.12	1154670.70	3
698	599814.24	1155087.00	6	768	599974.64	1154670.54	3
699	599814.41	1155086.53	6	769	599975.77	1154668.90	3
700	599815.64	1155087.09	3	770	599975.29	1154668.78	3
701	599815.24	1155087.45	3	771	599975.88	1154668.09	3
702	599815.90	1155087.83	3	772	599975.36	1154668.25	3
703	599815.38	1155087.83	3	773	599975.01	1154667.10	3
704	599813.36	1155095.59	3	774	599974.80	1154667.02	3
705	599812.86	1155095.53	3	775	599974.60	1154667.48	3
706	599813.53	1155097.75	3	776	599972.57	1154666.11	3
707	599813.03	1155097.81	3	777	599972.36	1154666.56	3
708	599813.85	1155099.34	3	778	599971.76	1154665.78	3
709	599813.33	1155099.26	3	779	599971.54	1154666.22	3
710	599813.11	1155099.62	3	780	599970.72	1154665.15	3
711	599813.49	1155099.96	3	781	599970.46	1154665.57	3
712	599812.22	1155100.84	6				
713	599811.68	1155100.61	3				
714	599805.38	1155107.08	3				
715	599805.08	1155106.68	3				
716	599802.79	1155108.53	6				
717	599802.42	1155108.17	6				
718	599802.12	1155108.91	3				
719	599801.78	1155108.53	3				
720	599801.85	1155109.31	3				
721	599801.35	1155109.15	3				
722	599801.80	1155111.19	3				
723	599801.30	1155111.17	3				
724	599801.04	1155123.26	3				
725	599800.56	1155122.99	3				
726	599800.53	1155123.49	3				
727	599798.32	1155123.48	3				
728	599798.14	1155122.98	3				
729	599793.96	1155126.97	3				
730	599793.64	1155126.59	3				
731	599792.34	1155128.39	3				
732	599792.02	1155128.01	3				
733	599788.51	1155131.43	3				
734	599788.03	1155131.17	3				
735	599788.45	1155132.13	3				
736	599787.93	1155132.23	3				
737	599794.58	1155143.11	3				
738	599793.96	1155143.01	3				
739	599793.73	1155143.91	6				
740	599793.47	1155143.48	6				
741	599800.88	1155126.01	3				
742	599800.38	1155125.99	3				
743	599800.84	1155131.49	3				
744	599800.34	1155131.67	3				
745	599810.22	1155142.23	3				
746	599809.80	1155142.51	3				
747	599811.15	1155144.07	3				
748	599810.87	1155144.61	3				
749	599820.91	1155142.64	3				
750	599820.87	1155143.16	3				
751	599821.82	1155142.96	3				

Přehled kladů mapových listů

k.ú. Řečkovice (611646)

GP 3247-470/2020

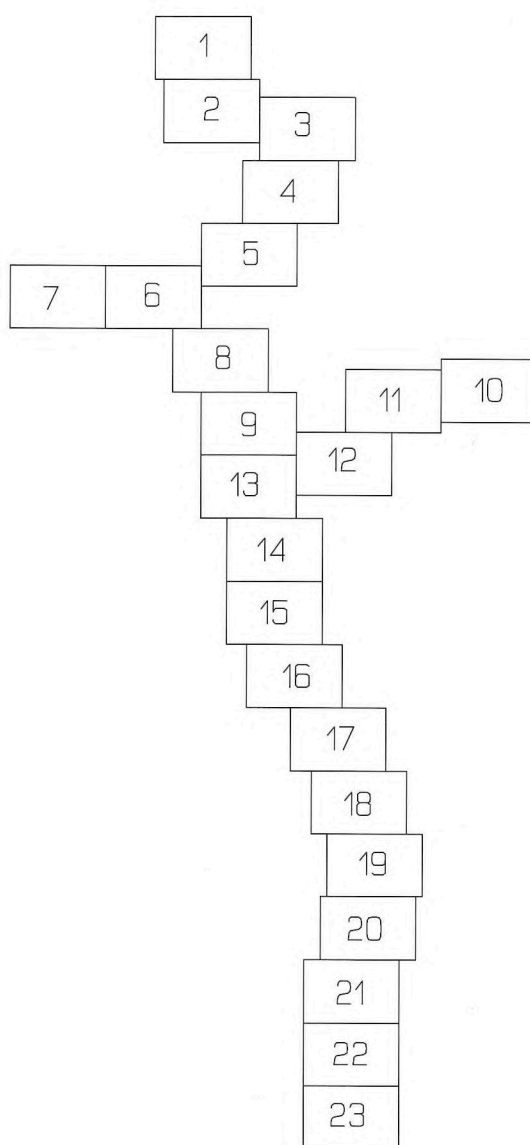

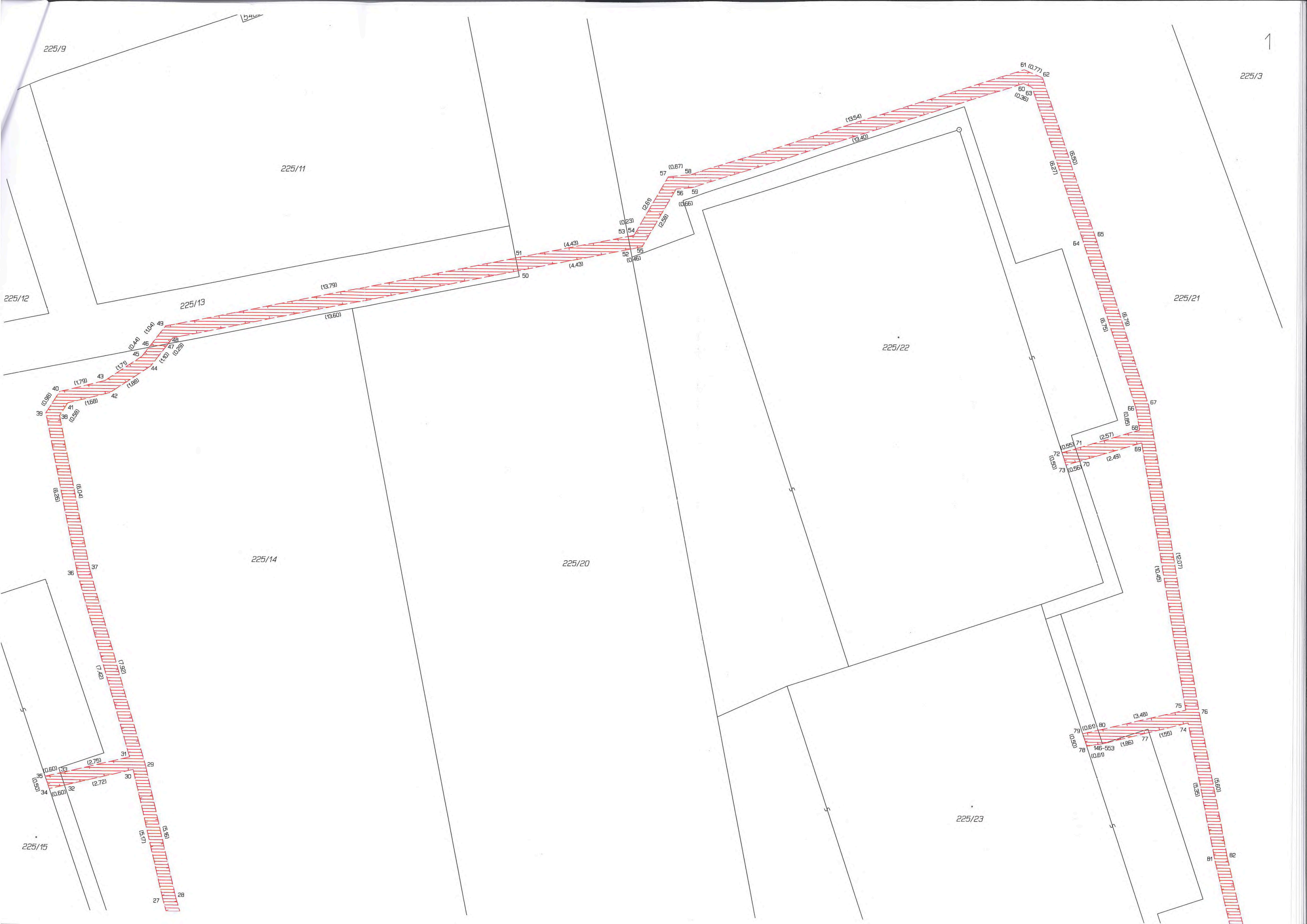

225/9

225/3

225/11

225/12

225/13

225/21

225/22

225/14

225/20

225/15

225/23

38 (0.98) 40 (1.79) 41 (0.58) 42 (1.68) 43 (1.71) 44 (1.42) 45 (0.44) 46 (1.04) 47 (0.29) 48 (0.29) 39 (0.58) 40 (1.79) 41 (0.58) 42 (1.68) 43 (1.71) 44 (1.42) 45 (0.44) 46 (1.04) 47 (0.29) 48 (0.29) 36 (1.64) 37 (1.82) 38 (0.98) 39 (0.58) 40 (1.79) 41 (0.58) 42 (1.68) 43 (1.71) 44 (1.42) 45 (0.44) 46 (1.04) 47 (0.29) 48 (0.29) 35 (0.60) 36 (1.64) 37 (1.82) 38 (0.98) 39 (0.58) 40 (1.79) 41 (0.58) 42 (1.68) 43 (1.71) 44 (1.42) 45 (0.44) 46 (1.04) 47 (0.29) 48 (0.29) 34 (0.60) 35 (0.60) 36 (1.64) 37 (1.82) 38 (0.98) 39 (0.58) 40 (1.79) 41 (0.58) 42 (1.68) 43 (1.71) 44 (1.42) 45 (0.44) 46 (1.04) 47 (0.29) 48 (0.29) 27 (1.15) 28 (0.45) 29 (2.75) 30 (2.72) 31 (2.75) 32 (0.60) 33 (0.60) 34 (0.60) 35 (0.60) 36 (1.64) 37 (1.82) 38 (0.98) 39 (0.58) 40 (1.79) 41 (0.58) 42 (1.68) 43 (1.71) 44 (1.42) 45 (0.44) 46 (1.04) 47 (0.29) 48 (0.29)

51 (4.43) 52 (0.46) 53 (0.23) 54 (2.38) 55 (4.43) 56 (0.66) 57 (2.81) 58 (0.67) 59 (0.66)

61 (13.54) 62 (0.77) 63 (0.36) 64 (6.27) 65 (6.50) 66 (6.73) 67 (6.73) 68 (6.73) 69 (2.49) 70 (2.49) 71 (2.57) 72 (0.55) 73 (0.55) 74 (3.46) 75 (1.55) 76 (1.55) 77 (1.55) 78 (0.60) 79 (0.60) 80 (0.60) 81 (1.55) 82 (1.55)

(13.79)

(13.60)

(4.43)

(0.23)

(0.46)

(2.81)

(0.66)

(13.54)

(6.40)

(0.55)

(0.55)

(2.57)

(2.49)

(0.60)

(0.60)

(1.86)

(3.46)

(1.55)

(1.55)

(1.55)

(1.55)

(1.55)

(1.55)

(1.55)

(1.55)



225/16

225/17

225/18

225/14

225/19

225/20

225/23

225/24

225/25

225/21

225/96

(13.40)

(12.57)

(4.11)

(4.19)

(18.7)

(18.7)

(1.33)

(1.52)

(1.75)

(1.70)

(1.67)

(4.46)

(3.43)

(3.43)

(5.12)

(2.44)

(0.49)

(2.59)

(2.74)

(0.59)

(0.59)

(0.88)

(8.41)

(8.41)

(4.44)

(4.57)

(3.79)

(2.17)

(2.81)

(2.28)

(5.59)

(5.57)

(0.79)

(0.30)

(1.12)

(1.39)

(1.12)

(1.39)

(0.50)

(0.50)

(0.50)

(0.50)

(0.50)

(0.50)

(0.50)

(0.50)

(0.50)

(0.50)

(0.50)

(0.50)

(0.50)

(0.50)

(0.50)

(0.50)

(0.50)

(0.50)

(0.50)

(0.50)

(0.50)

(0.50)

(0.50)

(0.50)

(0.50)

(0.50)

(0.50)

(0.50)

(0.50)

(0.50)

(0.50)

(0.50)

(0.50)

(0.50)

(0.50)

(0.50)

(0.50)

(0.50)

(0.50)

(0.50)

(0.50)

(0.50)

(0.50)

(0.50)

(0.50)

(0.50)

(0.50)

(0.50)

(0.50)

(0.50)

(0.50)

(0.50)

(0.50)

(0.50)

(0.50)

(0.50)

(0.50)

(0.50)

(0.50)

(0.50)

(0.50)

(0.50)

(0.50)

(0.50)

(0.50)

(0.50)

(0.50)

(0.50)

(0.50)

(0.50)

(0.50)

(0.50)

(0.50)

(0.50)

(0.50)

(0.50)

(0.50)

(0.50)

(0.50)

(0.50)

(0.50)

(0.50)

(0.50)

(0.50)

(0.50)

(0.50)

(0.50)

(0.50)

(0.50)

(0.50)

(0.50)

(0.50)

(0.50)

(0.50)

(0.50)

(0.50)

(0.50)

(0.50)

(0.50)

(0.50)

(0.50)

(0.50)

(0.50)

(0.50)

(0.50)

(0.50)

(0.50)

(0.50)

(0.50)

(0.50)

(0.50)

(0.50)

(0.50)

(0.50)

(0.50)

(0.50)

(0.50)

(0.50)

(0.50)

(0.50)

(0.50)

(0.50)

(0.50)

(0.50)

(0.50)

(0.50)

(0.50)

(0.50)

(0.50)

(0.50)

(0.50)

(0.50)

(0.50)

(0.50)

(0.50)

(0.50)

(0.50)

(0.50)

(0.50)

(0.50)

(0.50)

(0.50)

(0.50)

(0.50)

(0.50)

(0.50)

(0.50)

(0.50)

(0.50)

(0.50)

(0.50)

(0.50)

(0.50)

(0.50)

(0.50)

(0.50)

(0.50)

(0.50)

(0.50)

(0.50)

(0.50)

(0.50)

(0.50)

(0.50)

(0.50)

(0.50)

(0.50)

(0.50)

(0.50)

(0.50)

(0.50)

(0.50)

(0.50)

(0.50)

(0.50)

(0.50)

(0.50)

(0.50)

(0.50)

(0.50)

(0.50)

(0.50)

(0.50)

(0.50)

(0.50)

(0.50)

(0.50)

(0.50)

(0.50)

(0.50)

(0.50)

(0.50)

(0.50)

(0.50)

(0.50)

(0.50)

(0.50)

(0.50)

(0.50)

(0.50)

(0.50)

(0.50)

(0.50)

(0.50)

(0.50)

(0.50)

(0.50)

(0.50)

(0.50)

(0.50)

(0.50)

(0.50)

(0.50)

(0.50)

(0.50)

(0.50)

(0.50)

(0.50)

(0.50)

(0.50)

(0.50)

(0.50)

(0.50)

(0.50)

(0.50)

(0.50)

(0.50)

(0.50)

(0.50)

(0.50)

(0.50)

(0.50)

(0.50)

(0.50)

(0.50)

(0.50)

(0.50)

(0.50)

(0.50)

(0.50)

(0.50)

(0.50)

(0.50)

(0.50)

(0.50)

(0.50)

(0.50)

(0.50)

(0.50)

(0.50)

(0.50)

(0.50)

(0.50)

(0.50)

(0.50)

(0.50)

(0.50)

(0.50)

(0.50)

(0.50)

(0.50)

(0.50)

(0.50)

(0.50)

(0.50)

(0.50)

(0.50)

(0.50)

(0.50)

(0.50)

(0.50)

225/20

225/4

233/1

225/26

225/29

225/28



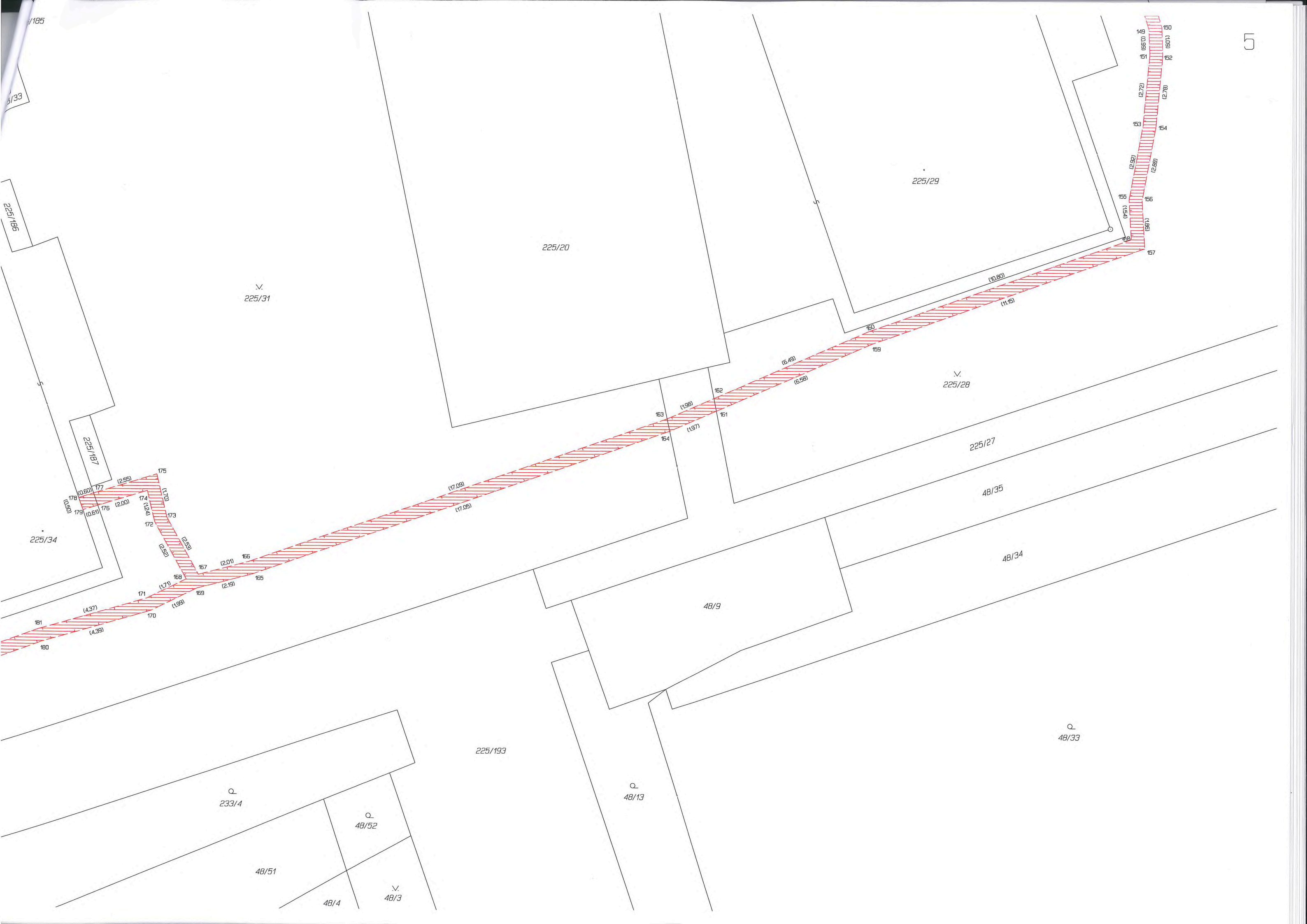

185

3/33

225/186

225/34

225/187

V.
225/31

225/20

225/29

V.
225/28

225/27

48/35

48/34

48/9

225/193

Q
48/13

Q
48/33

Q
233/4

Q
48/52

48/51

48/4

V.
48/3

149
(0.60)
150
(2.72)
151
(2.78)
152
(2.92)
153
(2.86)
154
(0.51)
155
(0.51)
156
(0.51)
157

57

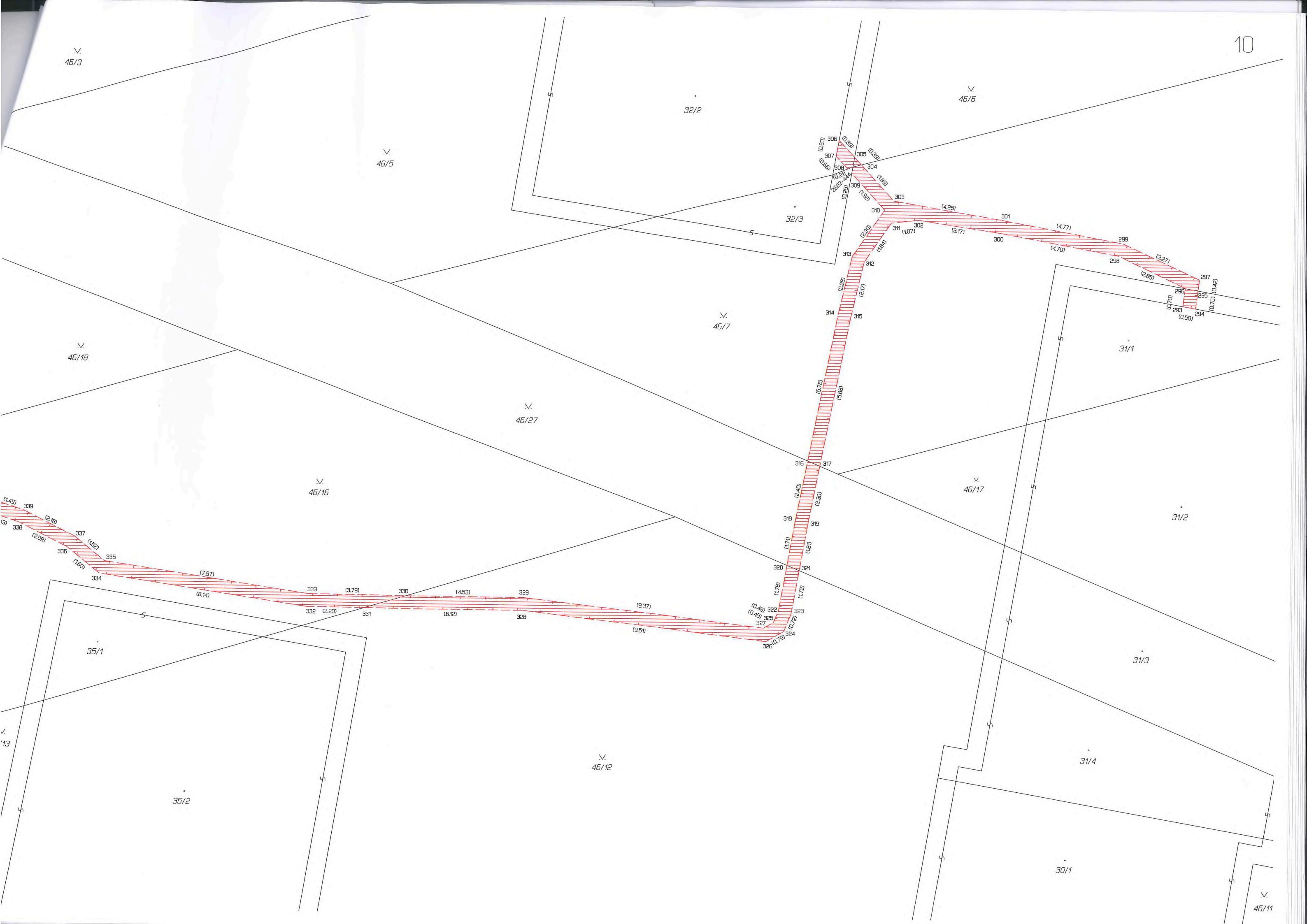

46/3

46/5

46/6

32/2

32/3

46/7

46/18

46/27

46/15

46/17

31/2

31/1

35/1

31/3

46/12

31/4

35/2

30/1

46/11

306

307

308

309

310

311

312

313

314

315

316

317

318

319

320

321

322

323

324

325

326

327

328

329

330

331

332

333

334

335

336

337

338

339

(0.63)

(0.59)

(0.59)

(0.22)

(0.22)

(1.92)

(1.84)

(2.28)

(2.17)

(2.17)

(5.78)

(5.68)

(2.40)

(2.30)

(1.77)

(1.67)

(1.78)

(1.72)

(1.72)

(0.45)

(0.45)

(3.27)

(0.79)

(1.49)

(2.16)

(2.09)

(1.50)

(7.97)

(8.14)

(3.79)

(3.79)

(4.53)

(9.37)

(9.51)

(1.89)

(1.89)

(4.25)

(3.17)

(4.77)

(4.70)

(3.27)

(2.85)

(0.70)

(0.50)

(0.70)

(0.42)

(5.78)

(5.68)

(2.40)

(2.30)

(1.77)

(1.67)

(1.78)

(1.72)

(1.72)

(0.45)

(0.45)

(3.27)

(0.79)

(1.49)

(2.16)

(2.09)

(1.50)

(7.97)

(8.14)

(3.79)

(3.79)

(4.53)

(9.37)

(9.51)

(0.59)

(0.59)

(0.59)

(0.22)

(0.22)

(1.92)

(1.84)

(2.28)

(2.17)

(2.17)

(5.78)

(5.68)

(2.40)

(2.30)

(1.77)

(1.67)

(1.78)

(1.72)

(1.72)

(0.45)

(0.45)

(3.27)

(0.79)

(1.49)

(2.16)

(2.09)

(1.50)

(7.97)

(8.14)

(3.79)

(3.79)

(4.53)

(9.37)

(9.51)

(1.89)

(1.89)

(4.25)

(3.17)

(4.77)

(4.70)

(3.27)

(2.85)

(0.70)

(0.50)

(0.70)

(0.42)

(5.78)

(5.68)

(2.40)

(2.30)

(1.77)

(1.67)

(1.78)

(1.72)

(1.72)

(0.45)

(0.45)

(3.27)

(0.79)

(1.49)

(2.16)

(2.09)

(1.50)

(7.97)

(8.14)

(3.79)

(3.79)

(4.53)

(9.37)

(9.51)

(0.59)

(0.59)

(0.59)

(0.22)

(0.22)

(1.92)

(1.84)

(2.28)

(2.17)

(2.17)

(5.78)

(5.68)

(2.40)

(2.30)

(1.77)

(1.67)

(1.78)

(1.72)

(1.72)

(0.45)

(0.45)

(3.27)

(0.79)

(1.49)

(2.16)

(2.09)

(1.50)

(7.97)

(8.14)

(3.79)

(3.79)

(4.53)

(9.37)

(9.51)

(0.59)

(0.59)

(0.59)

(0.22)

(0.22)

(1.92)

(1.84)

(2.28)

(2.17)

(2.17)

(5.78)

(5.68)

(2.40)

(2.30)

(1.77)

(1.67)

(1.78)

(1.72)

(1.72)

(0.45)

(0.45)

(3.27)

(0.79)

(1.49)

(2.16)

(2.09)

(1.50)

(7.97)

(8.14)

(3.79)

(3.79)

(4.53)

(9.37)

(9.51)

(1.89)

(1.89)

(4.25)

(3.17)

(4.77)

(4.70)

(3.27)

(2.85)

(0.70)

(0.50)

(0.70)

(0.42)

(5.78)

(5.68)

(2.40)

(2.30)

(1.77)

(1.67)

(1.78)

(1.72)

(1.72)

(0.45)

(0.45)

(3.27)

(0.79)

(1.49)

(2.16)

(2.09)

(1.50)

(7.97)

(8.14)

(3.79)

(3.79)

(4.53)

(9.37)

(9.51)

(0.59)

(0.59)

(0.59)

(0.22)

(0.22)

(1.92)

(1.84)

(2.28)

(2.17)

(2.17)

(5.78)

(5.68)

(2.40)

(2.30)

(1.77)

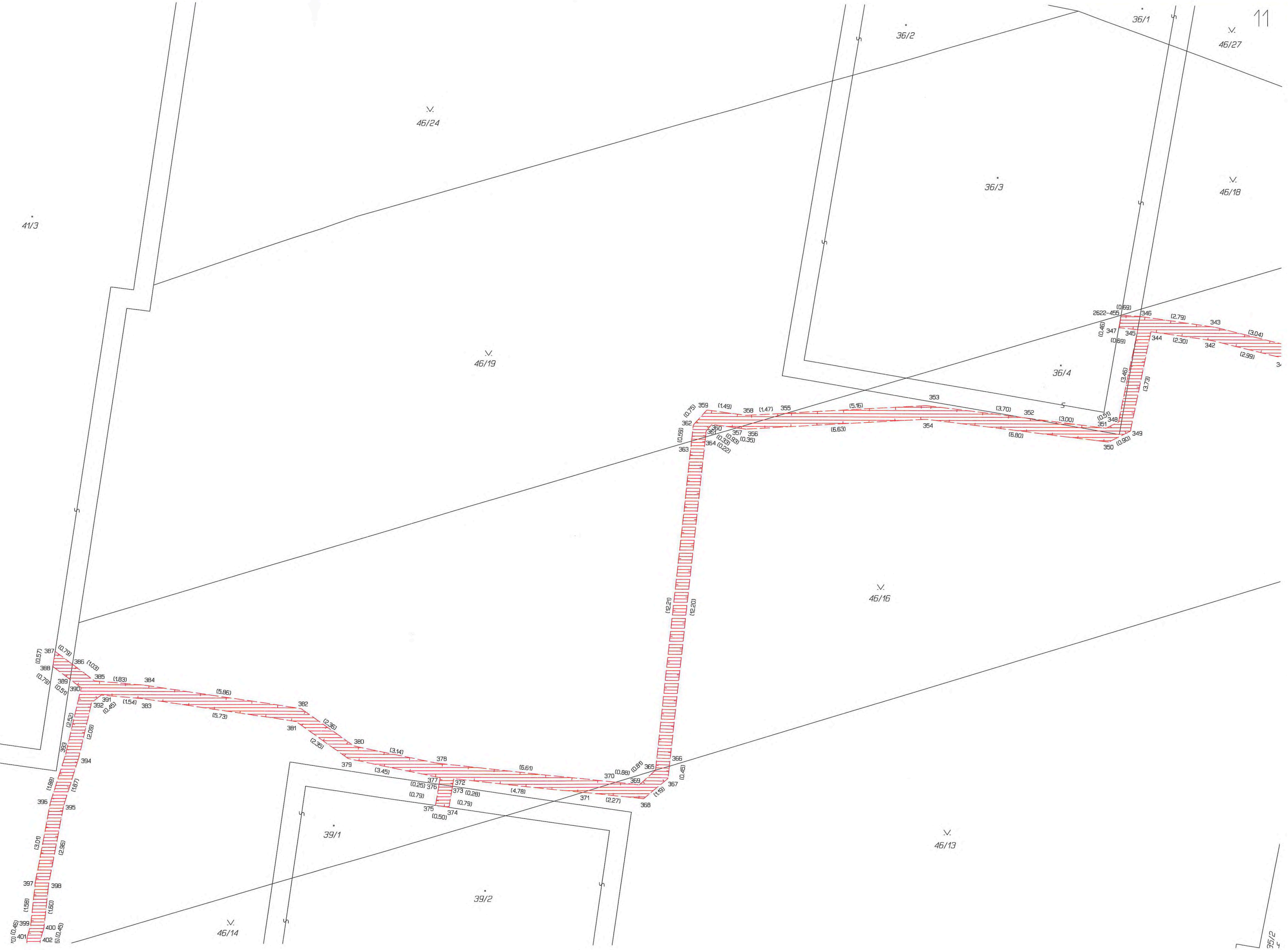

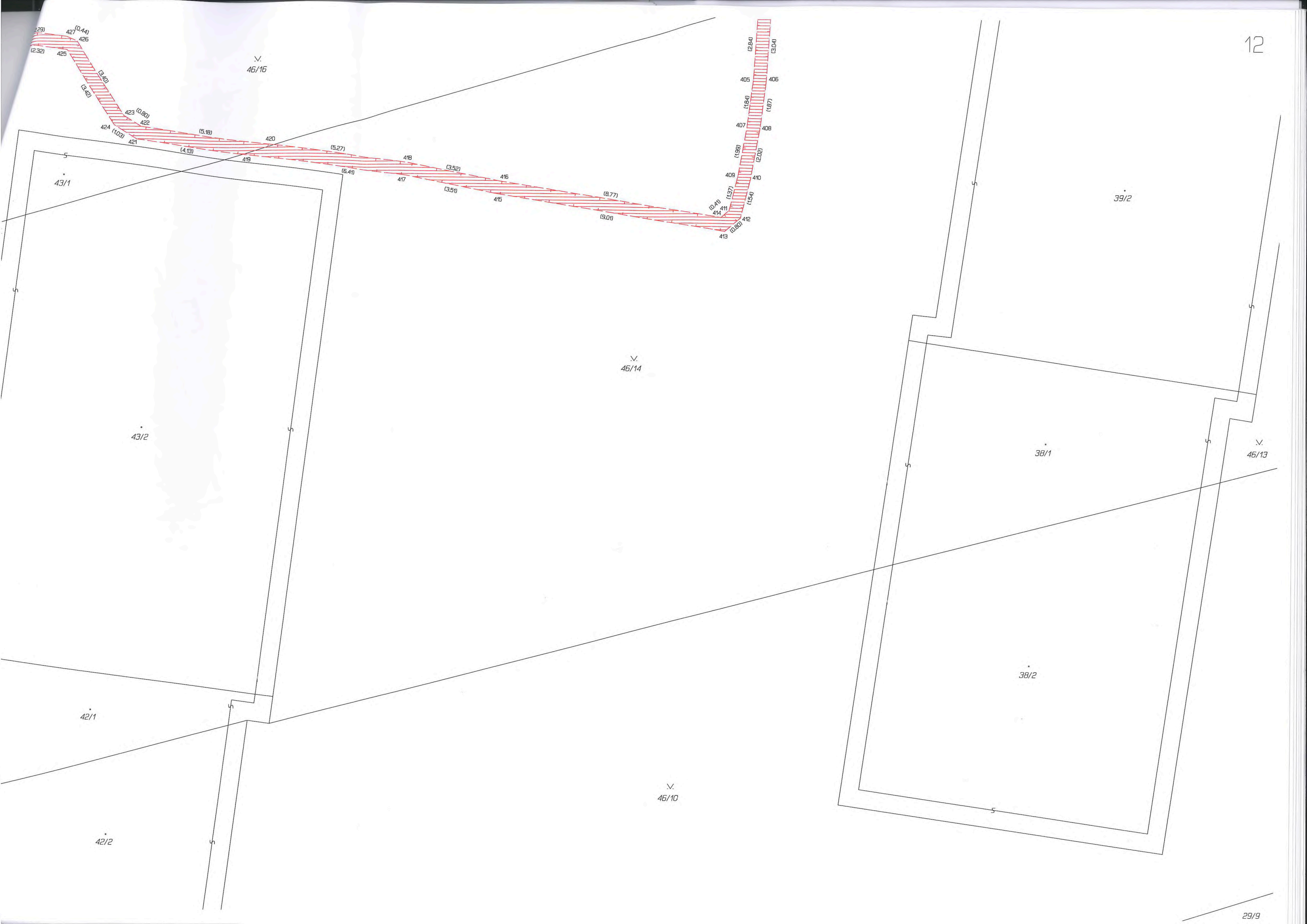

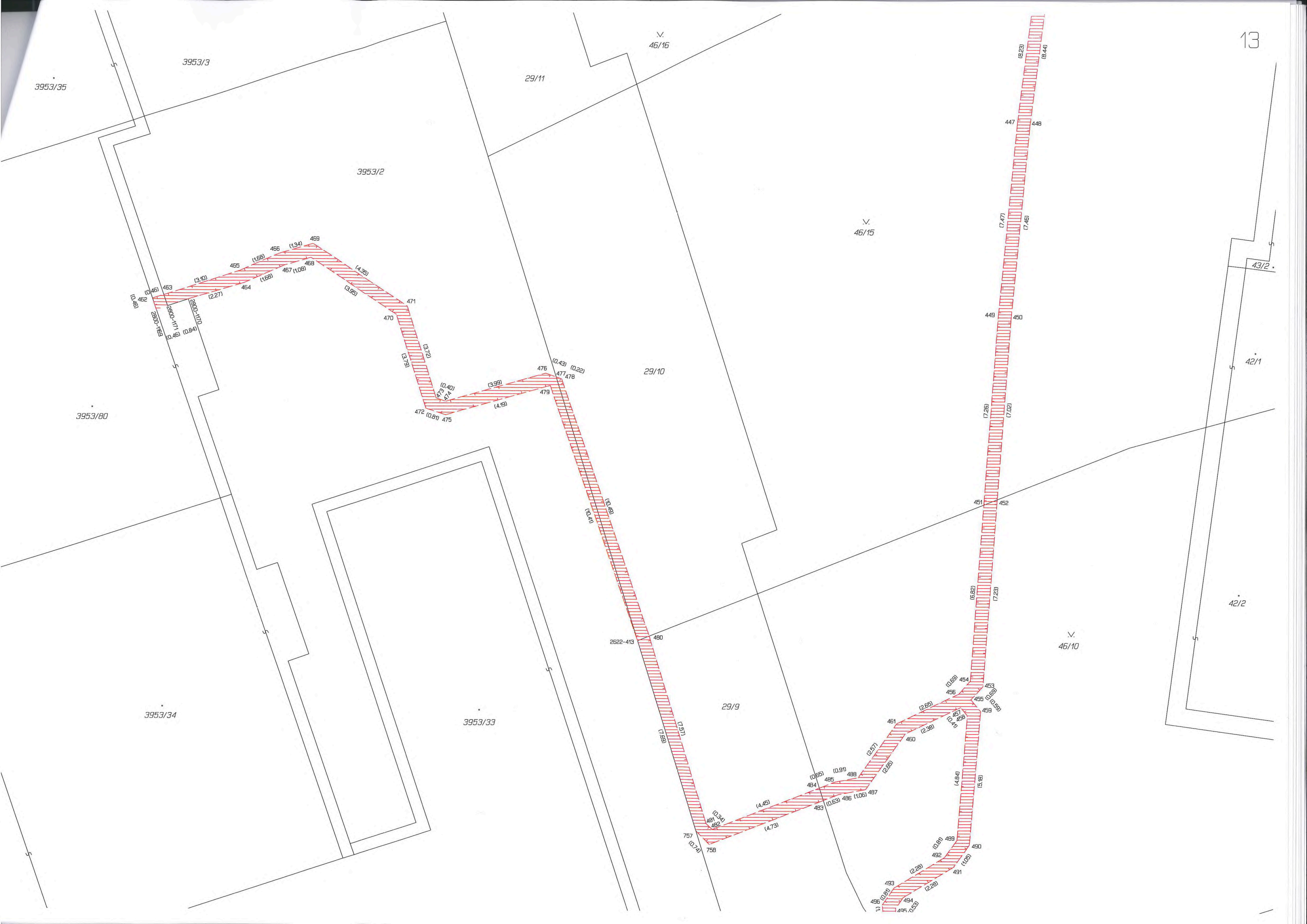

3953/35

3953/3

29/11

V.
46/16

3953/2

V.
46/15

462 (0.46) 463 (3.10) 464 (2.27) 465 (1.68) 466 (1.34) 467 (1.68) 468 (1.08) 469 (4.35) 470 (3.12) 471 (3.95) 472 (0.81) 473 (0.40) 474 (3.79) 475 (4.19) 476 (0.43) 477 (0.22) 478 (3.99) 479 (4.19)

3953/80

29/10

43/2

42/1

3953/34

3953/33

29/9

V.
46/10

42/2

2622-413

480

(6.51) (4.57)

(0.34) (0.82)

(4.45) (4.73)

(0.65) (0.91)

(0.63) (1.06)

(0.87) (2.28)

(0.53) (2.28)

(2.28) (0.61)

(4.64) (5.18)

(0.63) (2.65)

(2.38) (0.47)

(0.57) (0.59)

(0.53) (0.53)

(6.92) (7.23)

(7.26) (7.02)

(7.47) (7.46)

(8.23) (8.44)

(0.70) (0.80)

(1.57) (1.57)

(0.74) (0.74)

(4.45) (4.73)

(0.65) (0.91)

(0.63) (1.06)

(0.87) (2.28)

(0.53) (2.28)

(2.28) (0.61)

(4.64) (5.18)

(0.63) (2.65)

(2.38) (0.47)

(0.57) (0.59)

(0.53) (0.53)

(6.92) (7.23)

(7.26) (7.02)

(7.47) (7.46)

(8.23) (8.44)

(0.70) (0.80)

(1.57) (1.57)

(0.74) (0.74)

(4.45) (4.73)

(0.65) (0.91)

(0.63) (1.06)

(0.87) (2.28)

(0.53) (2.28)

(2.28) (0.61)

(4.64) (5.18)

(0.63) (2.65)

(2.38) (0.47)

(0.57) (0.59)

(0.53) (0.53)

(6.92) (7.23)

(7.26) (7.02)

(7.47) (7.46)

(8.23) (8.44)

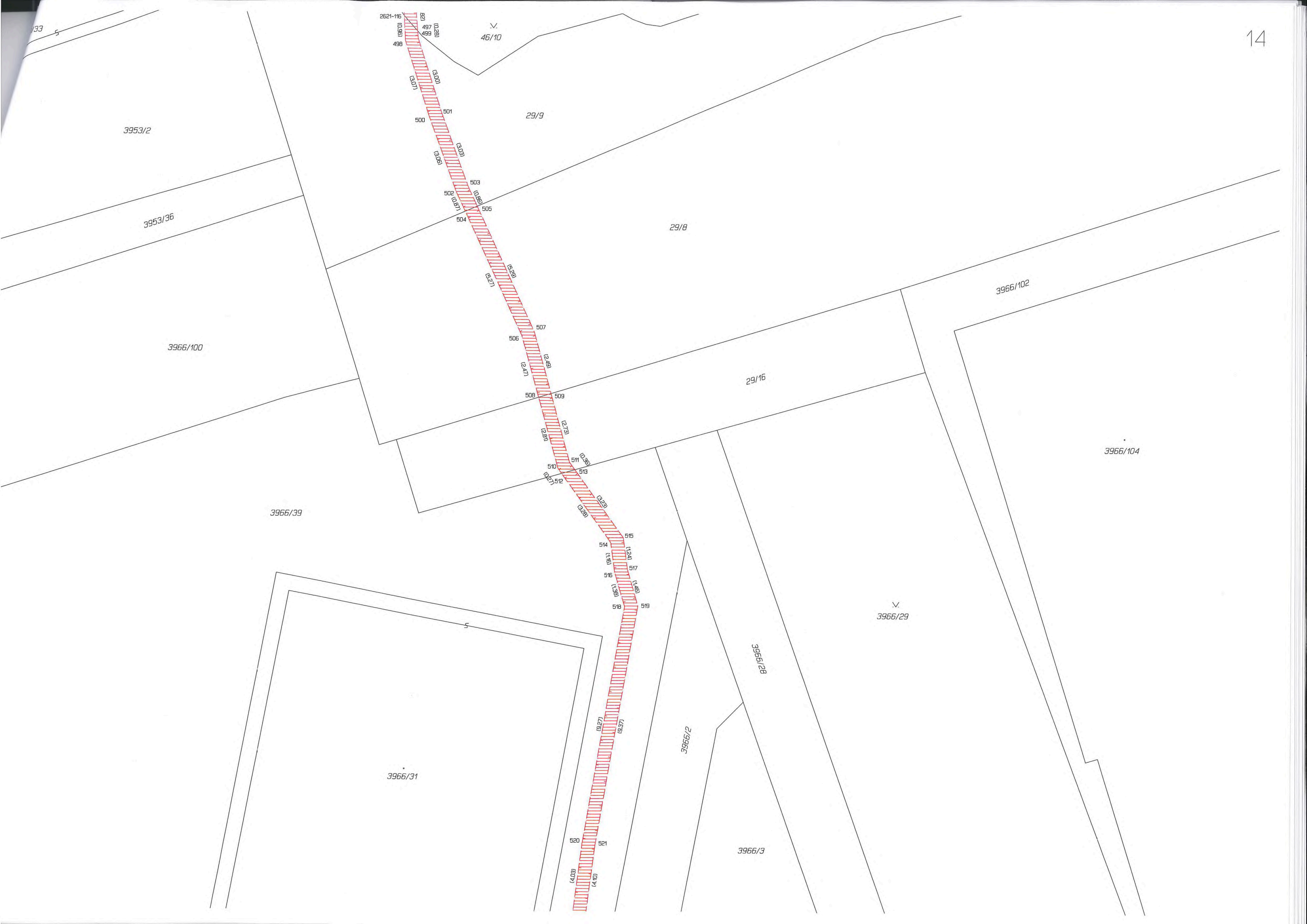

3966/104

3966/102

3966/1

3966/29

3966/28

3966/3

3966/2

3966/4

3966/33

3966/39

3966/31

3966/32





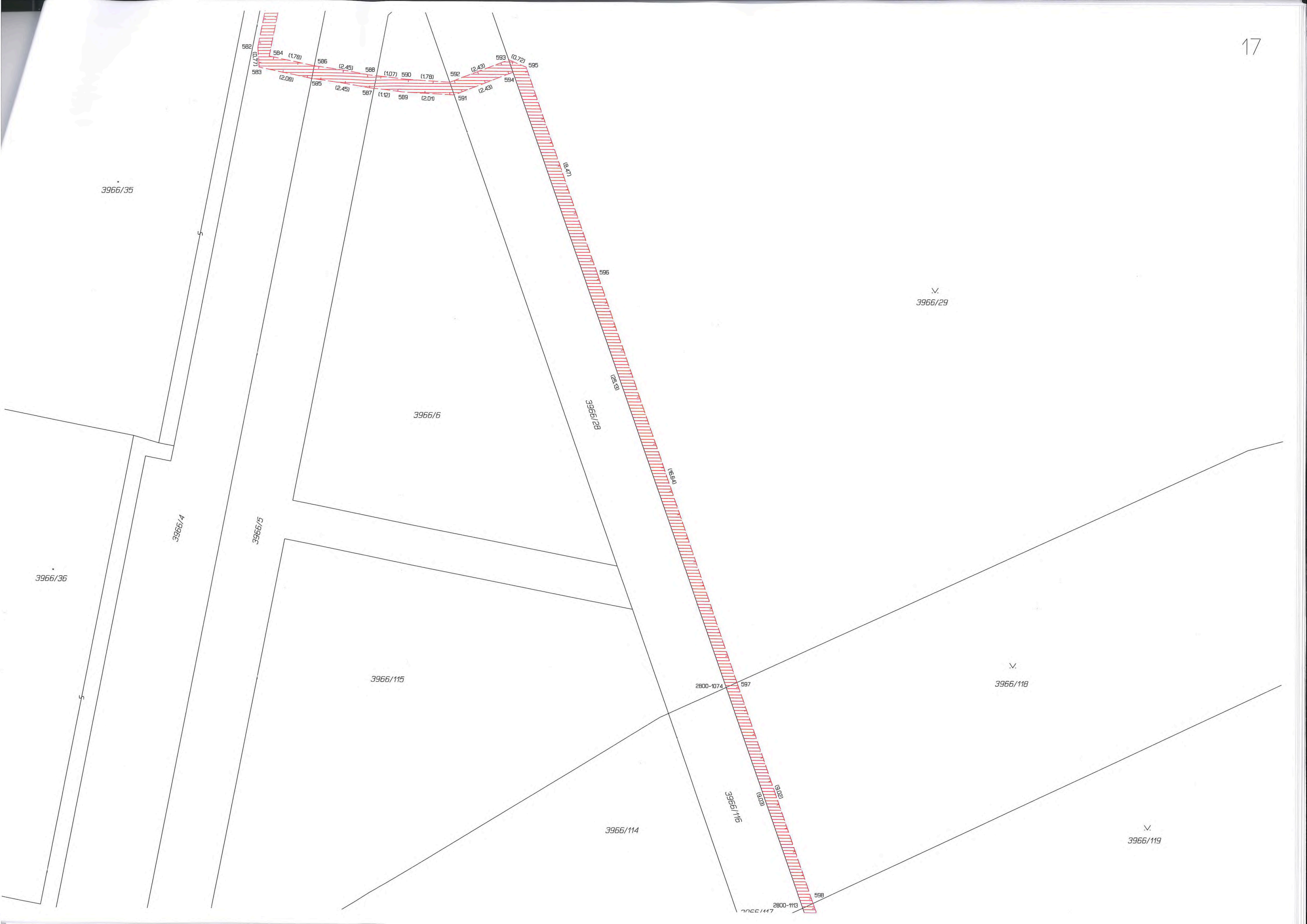

3966/35

3966/36

3966/4

3966/5

3966/6

3966/28

3966/115

3966/114

3966/118

3966/119

2800-1074

2800-113

582 (0.77) 583 (2.08) 584 (1.78) 585 (2.45) 586 (2.45) 587 (1.12) 588 (1.07) 589 (2.00) 590 (1.78) 591 (2.43) 592 (2.43) 593 (0.72) 594 595

587

596

597

598

3966/116

599

600

601

602



v.
3966/119

3966/114

3966/113

3966/37

3966/7

3966/38

599
(2.38)

(25.08)

(23.34)

3966/117

619 (0.20)

620 (1.00)

618

617 (0.82)

(5.75)

(5.75)

615

616

(3.22)

(3.41)

613

614

(3.25)

(3.75)

612 (1.15)

610

(3.75)

609

(1.34)

611

(0.98)

608

(1.00)

606

(2.47)

604

(2.47)

602

600

607 (1.08)

605 (1.15)

603

(6.42)

(6.42)

621 (0.84)

622

(0.89)

623

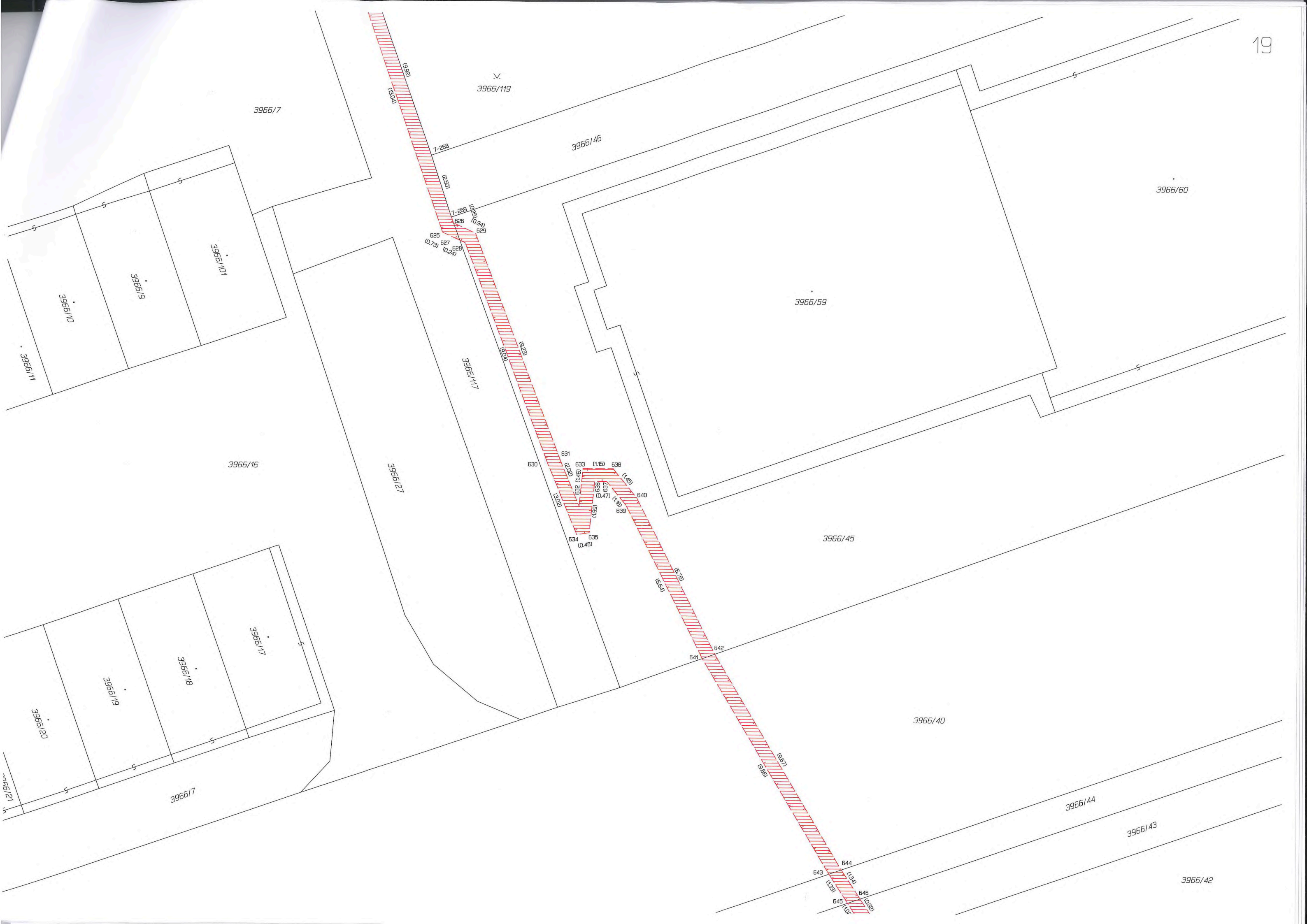

3966/7

3966/119

3966/46

3966/60

3966/101

3966/19

3966/10

3966/11

3966/59

3966/117

3966/16

3966/27

3966/45

3966/17

3966/18

3966/19

3966/20

3966/7

3966/40

3966/44

3966/43

3966/42



