

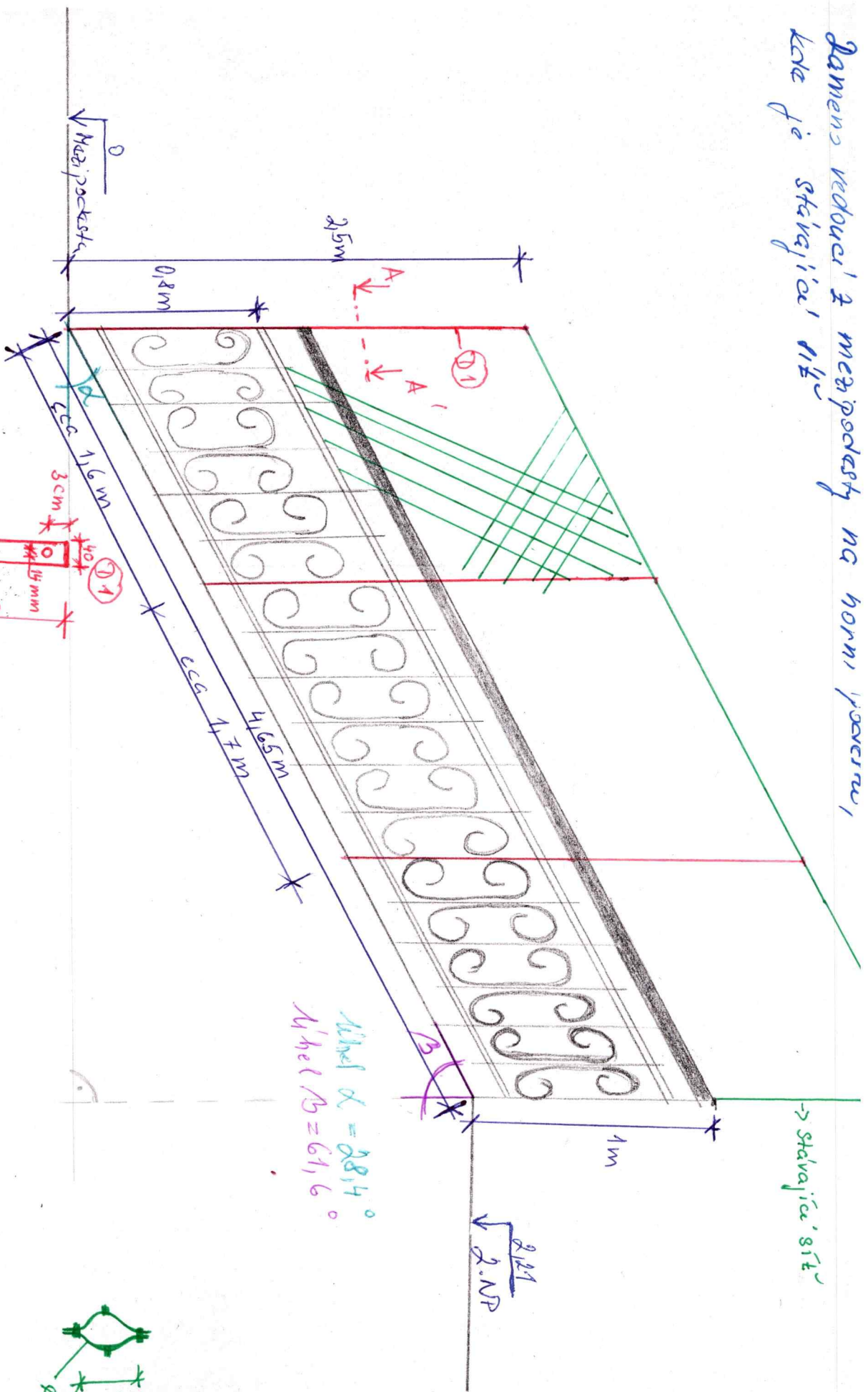

zamena veducej a mezpodesty na horni posuvnu,  
kde je stavajica' stiz'

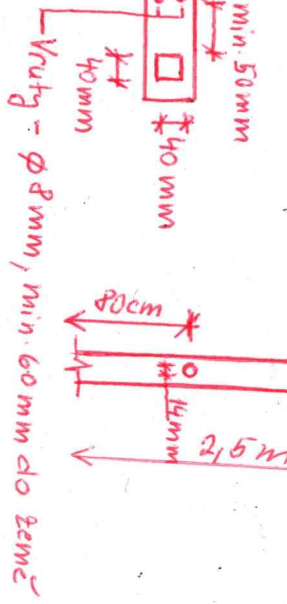

Rez A-A:  
70mm  
min. 50mm  
40mm  
40mm



⇒ 3x dvojpaek 40x40 mm

uhel  $\alpha = 28,4^\circ$   
uhel  $\beta = 61,6^\circ$

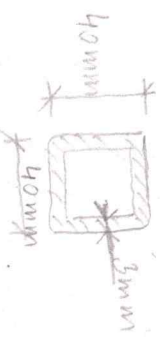
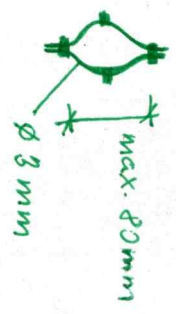

sta stenz  
skopka - 3mm

→ stava'ica' stiz'