

# VÝKAZ DOSAVADNÍHO A NOVÉHO STAVU ÚDAJŮ KATASTRU NEMOVITOSTÍ

Dosavadní stav				Nový stav											
Označení pozemku parc. číslem	Výměra parcely		Druh pozemku	Označení pozemku parc. číslem	Výměra parcely		Druh pozemku	Typ stavby	Způsob určení	Porovnání se stavem evidence právních vztahů					
	ha	m <sup>2</sup>	Způsob využití		ha	m <sup>2</sup>	Způsob využití	Způsob využití	výměr	Díl přechází z pozemku označeného v katastru nemovitostí	dřívejší poz. evidenci	číslo listu vlastníci	Výměra dílu		Označení dílu
												ha	m <sup>2</sup>		
494/1											494/1			10001	
503/2											503/2			10001	
508/1											508/1			10001	
509/45											509/45			10001	
509/46											509/46			10001	
515/13											515/13			10001	
515/33											515/33			10001	
517/32											517/32			10001	
520/6											520/6			10001	
573/1											573/1			10001	
575/3											575/3			10001	
628											628			10001	

Oprávněný : die smlouvy

Druh věcného břemene : die smlouvy

<b>GEOMETRICKÝ PLÁN pro</b> vymezení rozsahu věcného břemene k části pozemku	Geometrický plán vyřazený úředně oprávněným zeměměřičským inženýrem Jméno, příjmení: <b>Ing. Jiří Loula</b> Číslo průkazu seznamu úředně oprávněných zeměměřičských inženýrů: <b>1911/2000</b> Dne: <b>10.7.2020</b> Číslo: <b>59/2020</b>	Služebník veřejné úředně oprávněný zeměměřičský inženýr Jméno, příjmení: Číslo průkazu seznamu úředně oprávněných zeměměřičských inženýrů: Dne: Dne:
	Kancelářní úřad současně s odšlepnutím parcel <b>KÚ pro Středočeský kraj</b> <b>KP Mladá Boleslav</b> <b>PGP-1380/2020-207</b> <b>2020.07.16 08:14:21 CEST</b>	Tento stejnopis odpovídá geometrickému plánu v elektronické podobě uložení v dokumentaci katastrálního úřadu. Čtyřeri stejnopisy geometrického plánu v listinné podobě
Vyhotovitel: <span style="background-color: black; color: black;">XXXXXXXXXX</span> Úřad IČO : 124 81 831		
Číslo plánu: 1872-42/2020		
Okres: Mladá Boleslav		
Obec: Mladá Boleslav		
kát. území: Čejetice u Mladé Boleslavi		
Mapový list: Ml. Boleslav 2-6/42, 2-6/24		
Obsluhuje se v režimě pozemkové byt. poskytnuté měřičem seznámil se v terénu s průběhem současných nových hranic, které byly označeny přechodnými značkami		

# KLAD LISTŮ

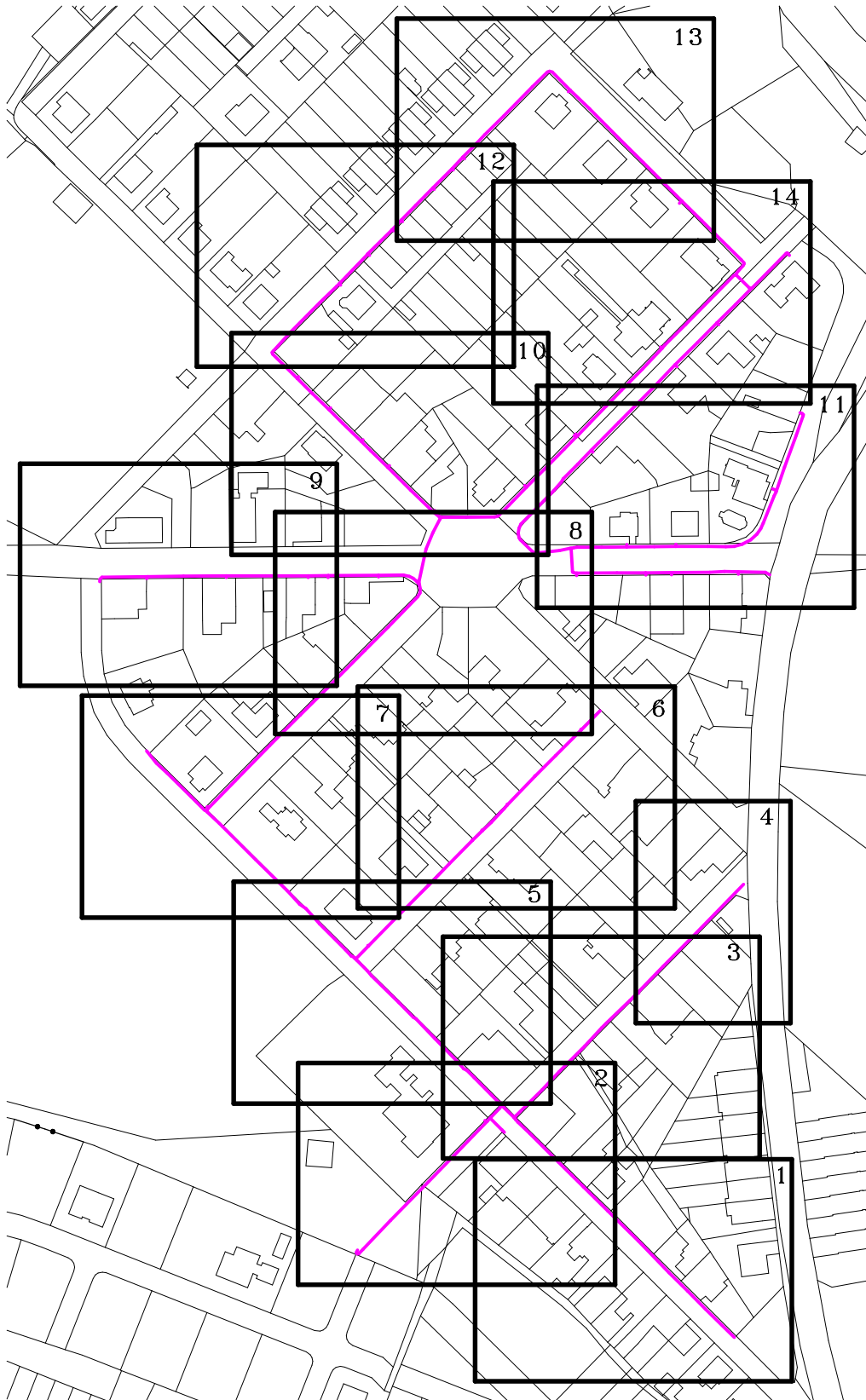



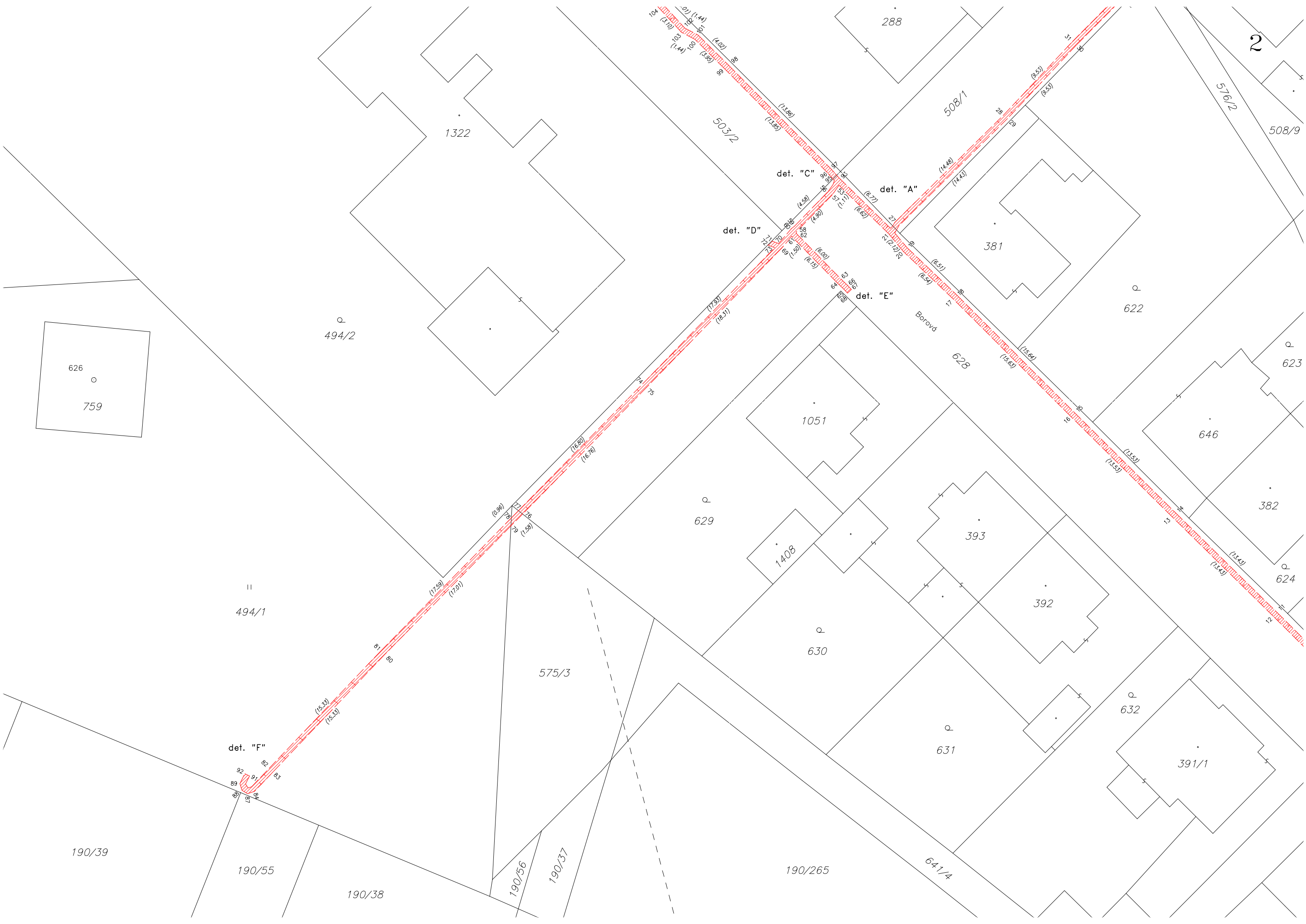

1322

288

2

503/2

508/1

508/9

576/2

det. "C"

det. "A"

381

det. "D"

det. "E"

622

494/2

626

759

623

Borova

628

646

1051

382

629

1408

393

624

392

494/1

630

575/3

632

631

391/1

190/39

190/55

190/38

190/56

190/37

190/265

641/4



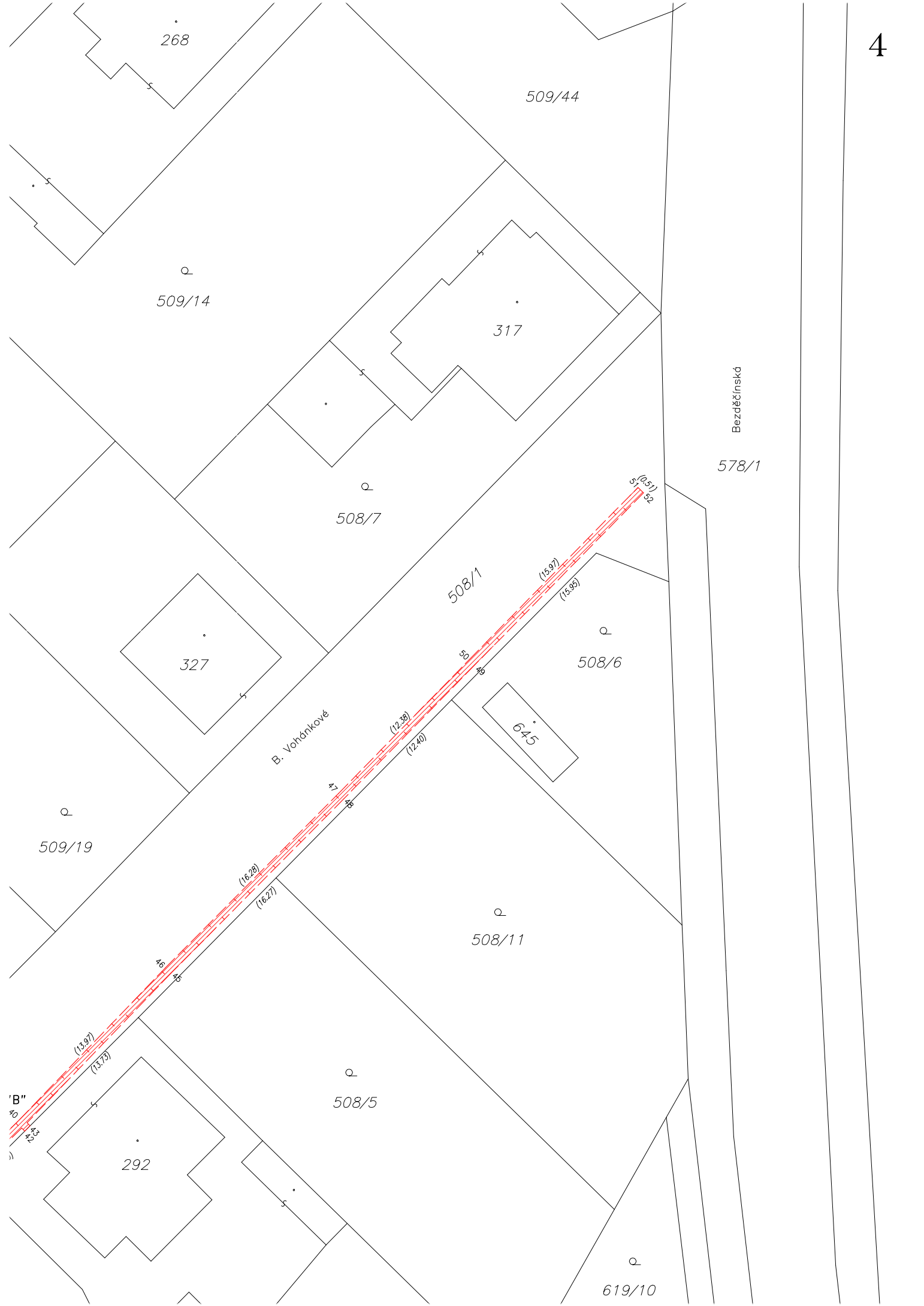



503/1

503/7

495

det. "G"

503/2

494/2

495/7

det. "H"

509/46

495/21

1322

det. "I"

286

287

495/17

272

495/16

495/3

509/2

495/2

509/21

509/49

509/35

509/36

50

30

288

508/1

503/2

det. "C"

det. "C"









506

503/4

642

1257

363

278

503/5

495/19

279

509/29

505

509/45

284

495/9

495/20

495/10

det. "M"

496

503/2

503/6

17

503/1

503/7

(0.47)  
198

(6.07)  
196

(5.73)  
197

(5.76)  
194

(13.14)  
193

(5.72)  
192

(7.00)  
193

(6.89)  
192

(7.00)  
191

(6.49)  
190

(6.69)  
189

(1.00)  
188

(1.00)  
187

(1.00)  
186

(18.19)  
185

(18.19)  
184

(17.51)  
183

(17.51)  
182

(17.51)  
181

(7.00)  
180

(7.00)  
179

(2.36)  
178

(2.36)  
177

(7.9)  
176

(7.9)  
175

(3.97)  
211

(14.09)  
210

(19.28)  
211

(19.28)  
210

(16.72)  
212

(16.72)  
213

(14.92)  
214

(14.92)  
215

(16.72)

(16.72)

(14.92)

(14.92)

(14.92)

(14.92)

(14.92)

(14.92)

(14.92)

(14.92)

(14.92)

(14.92)

(14.92)

(14.92)

(14.92)

(14.92)

(14.92)

(14.92)

(14.92)

(14.92)

(14.92)

(14.92)

(14.92)

(14.92)

(14.92)

(14.92)

(14.92)

(14.92)

Tolstého



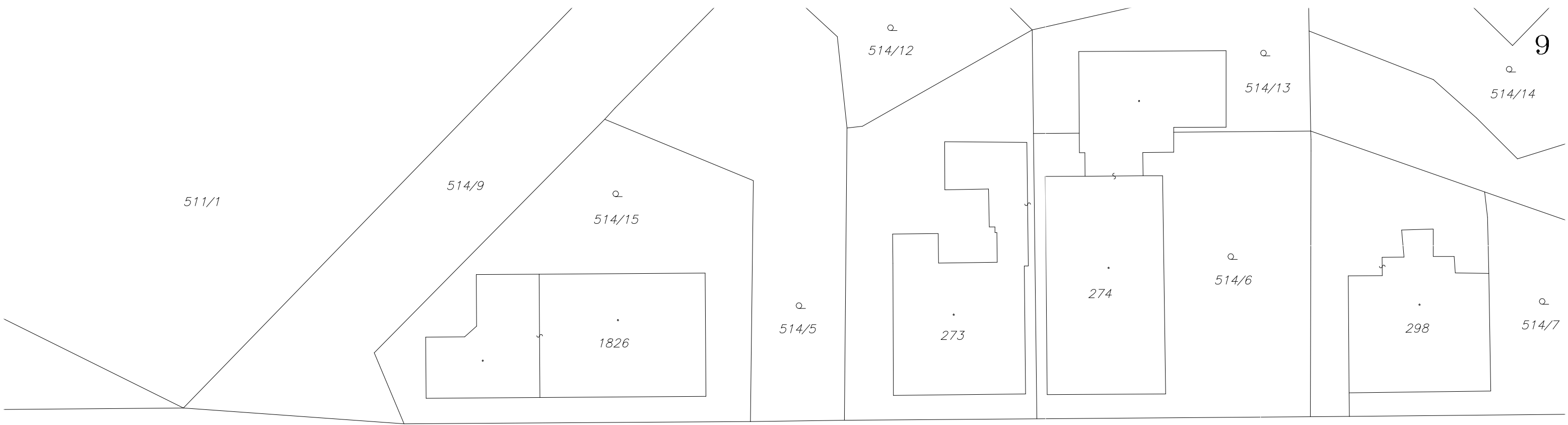





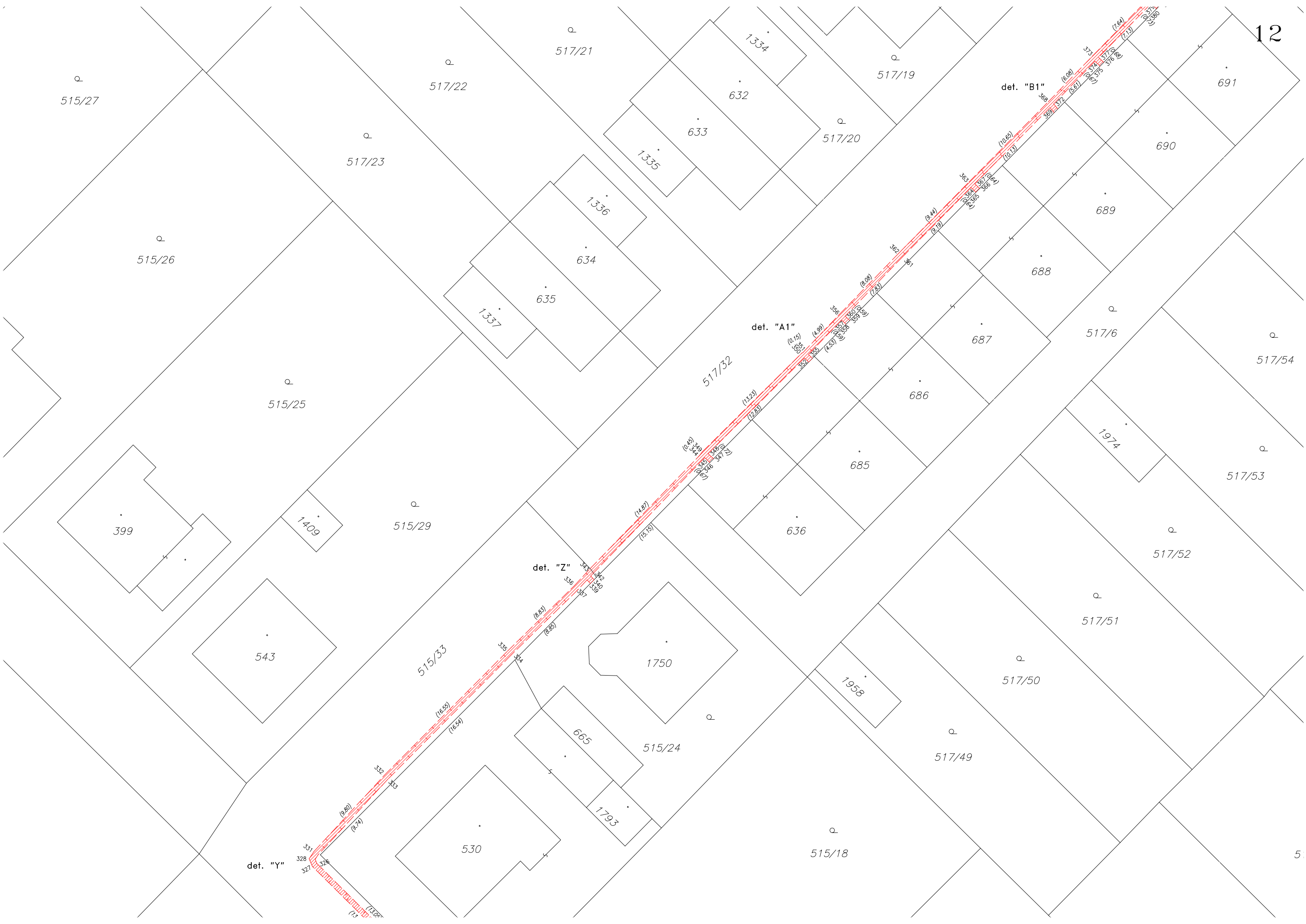

515/27

517/22

517/21

1334

517/19

det. "B1"

691

517/23

633

517/20

690

515/26

634

1335

688

515/25

635

det. "A1"

517/6

517/54

399

1409

515/29

517/32

686

1974

517/53

det. "Z"

636

517/52

543

515/33

1750

517/51

det. "Y"

530

665

515/24

517/50

1958

517/49

515/18

1793









det. "H1"

det. "I1"

det. "M1"

det. "J1"

det. "D1"

det. "K1"

det. "L1"

Na stráni



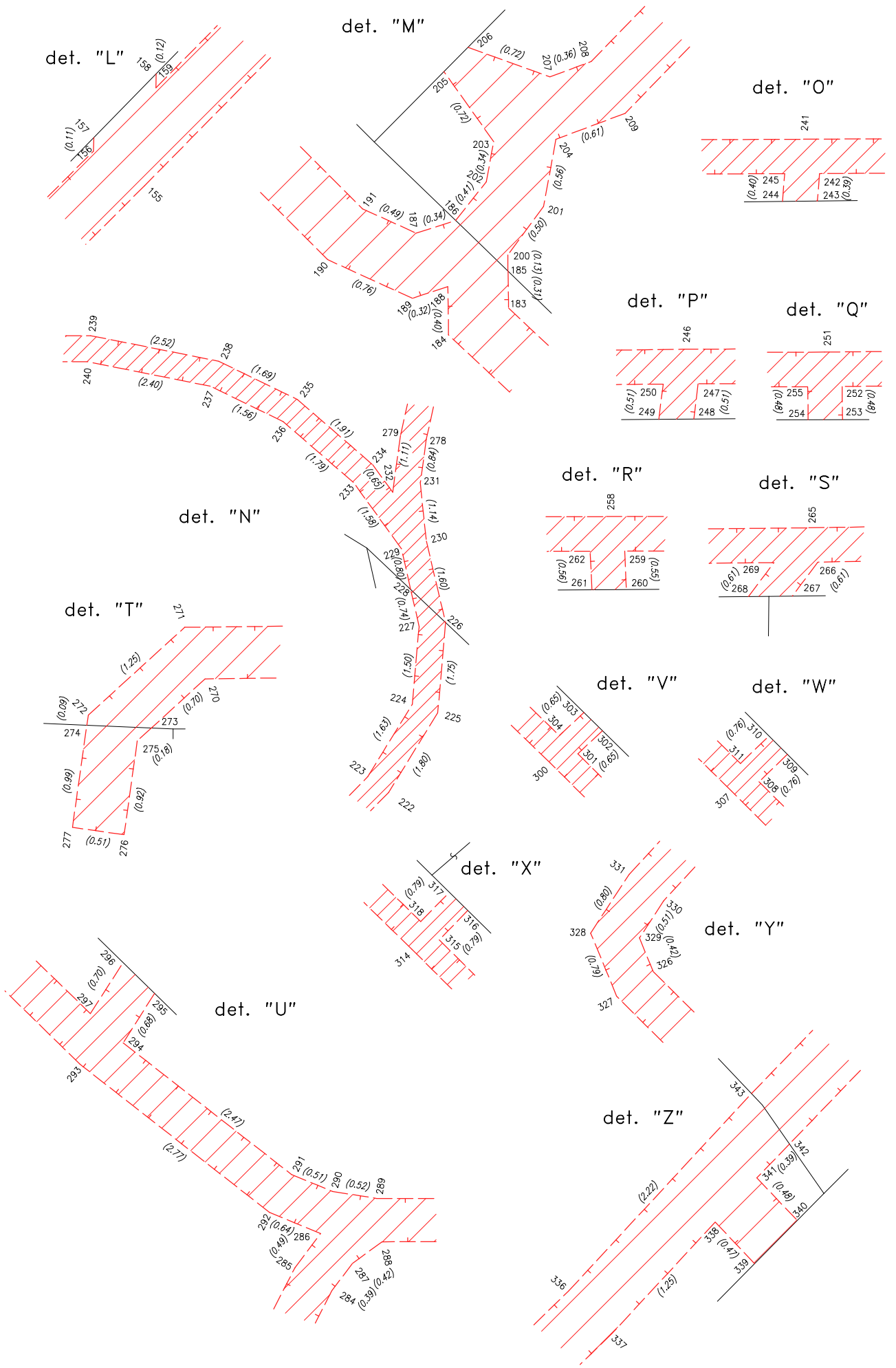

det. "A1"

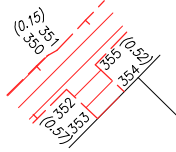

det. "B1"

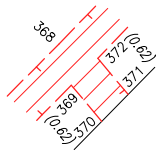

det. "C1"

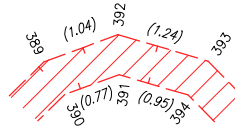

det. "D1"

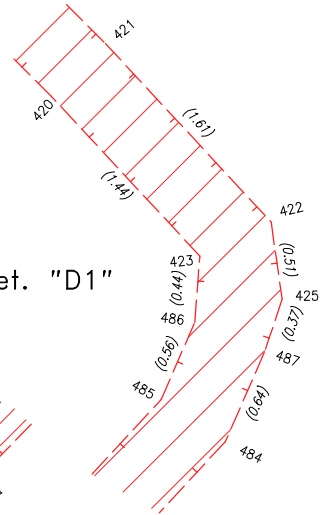

det. "E1"

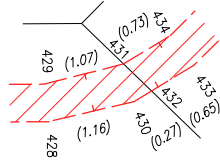

det. "F1"

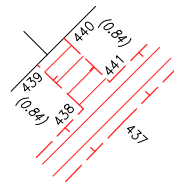

det. "H1"

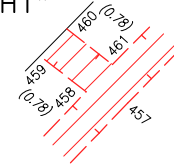

det. "J1"

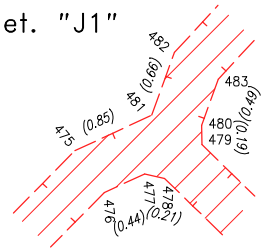

det. "G1"

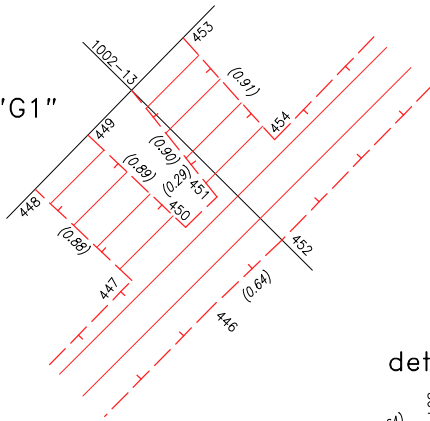

det. "I1"

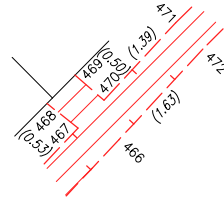

det. "M1"

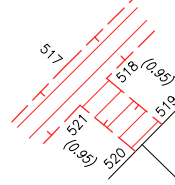

det. "N1"

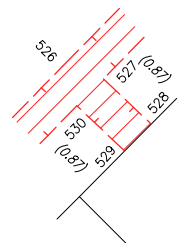

det. "L1"

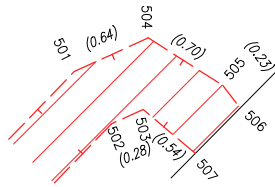

det. "K1"



det. "Q1"

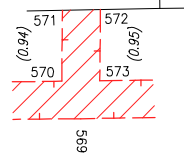

det. "P1"

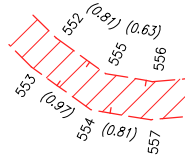

det. "R1"

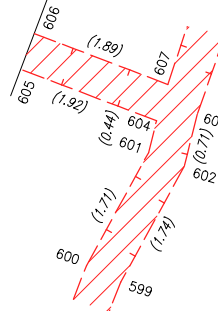

det. "S1"

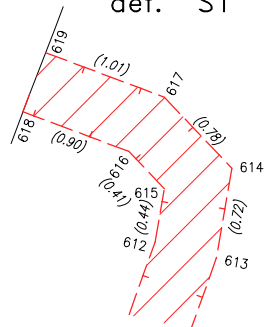

det. "U1"

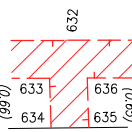

det. "V1"

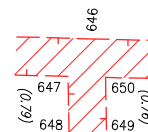

det. "T1"

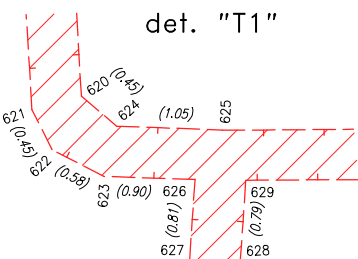

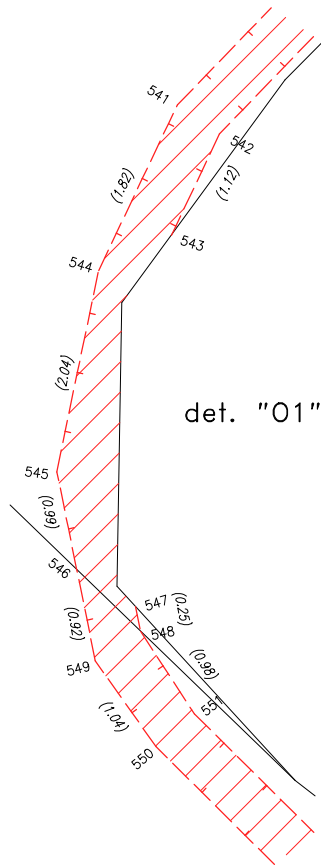

det. "01"

## Seznam souřadnic (S–JTSK)

Číslo bodu	Souřadnice pro zápis do KN			Poznámka	Číslo bodu	Souřadnice pro zápis do KN			Poznámka
	Y	X	kód kv.			Y	X	kód kv.	
1002–13	705348.42	1012850.56	3		64	705377.00	1013120.62	3	
1004–19	705272.58	1012904.87	3		65	705376.38	1013121.21	3	
1005–25	705433.48	1013053.70	3		66	705376.02	1013120.87	3	
1005–49	705415.36	1013035.30	3		67	705375.66	1013121.26	3	
1005–62	705388.04	1013007.56	3		68	705376.02	1013121.60	3	
1005–159	705397.13	1013016.81	3		69	705382.27	1013117.38	3	
1	705286.77	1013201.14	3		70	705382.54	1013116.91	3	
2	705286.41	1013200.78	3		71	705383.18	1013116.67	3	
3	705297.58	1013189.81	3		72	705383.56	1013117.06	3	
4	705297.94	1013190.17	3		73	705382.90	1013117.31	3	
5	705304.85	1013183.22	3		74	705395.39	1013130.17	3	
6	705304.49	1013182.86	3		75	705395.03	1013130.51	3	
7	705311.68	1013175.73	3		76	705406.75	1013142.49	3	
8	705312.04	1013176.09	3		77	705407.15	1013142.17	3	
9	705323.96	1013163.86	3		78	705407.82	1013142.86	3	
10	705323.60	1013163.50	3		79	705407.86	1013143.61	3	
11	705335.39	1013151.79	3		80	705419.78	1013155.75	3	
12	705335.75	1013152.15	3		81	705420.14	1013155.41	3	
13	705345.33	1013142.74	3		82	705430.71	1013166.51	3	
14	705344.97	1013142.38	3		83	705430.35	1013166.85	3	
15	705354.58	1013132.86	3		84	705432.11	1013168.71	3	
16	705354.94	1013133.22	3		85	705432.39	1013168.27	3	
17	705365.99	1013122.17	3		86	705432.72	1013168.39	3	
18	705365.65	1013121.81	3		87	705432.78	1013168.93	3	
19	705370.37	1013117.32	3		88	705433.30	1013168.61	3	
20	705370.73	1013117.66	3		89	705433.50	1013167.98	3	
21	705372.08	1013116.03	3		90	705432.96	1013168.02	3	
22	705371.54	1013115.91	3		91	705432.59	1013167.26	3	
23	705371.95	1013115.46	3		92	705433.03	1013167.04	3	
24	705371.74	1013115.25	3		93	705376.80	1013110.73	3	
25	705371.38	1013115.63	3		94	705377.04	1013110.46	3	
26	705371.15	1013115.22	3		95	705377.39	1013110.81	3	
27	705371.55	1013114.92	3		96	705377.90	1013110.23	3	
28	705361.24	1013104.75	3		97	705377.54	1013109.89	3	
29	705360.88	1013105.09	3		98	705387.28	1013100.03	3	
30	705354.36	1013098.14	3		99	705387.64	1013100.39	3	
31	705354.72	1013097.80	3		100	705390.45	1013097.61	3	
32	705344.75	1013087.77	3		101	705390.15	1013097.21	3	
33	705344.39	1013088.11	3		102	705391.42	1013096.54	3	
34	705337.88	1013081.02	3		103	705391.72	1013096.94	3	
35	705338.24	1013080.68	3		104	705393.82	1013094.66	3	
36	705336.41	1013078.88	3		105	705393.46	1013094.32	3	
37	705336.07	1013079.24	3		106	705402.50	1013084.99	3	
38	705326.86	1013070.36	3		107	705402.86	1013085.33	3	
39	705327.20	1013070.00	3		108	705410.33	1013077.61	3	
40	705324.11	1013066.94	3		109	705410.01	1013077.21	3	
41	705323.94	1013067.48	3		110	705411.06	1013076.57	3	
42	705323.74	1013067.68	3		111	705411.38	1013076.97	3	
43	705323.39	1013067.33	3		112	705416.90	1013071.31	3	
44	705323.58	1013067.12	3		113	705416.54	1013070.95	3	
45	705314.06	1013057.22	3		114	705427.20	1013060.50	3	
46	705314.42	1013056.88	3		115	705427.56	1013060.84	3	
47	705302.95	1013045.32	3		116	705429.17	1013058.90	3	
48	705302.59	1013045.68	3		117	705428.79	1013058.56	3	
49	705293.93	1013036.81	3		118	705432.95	1013054.42	3	
50	705294.29	1013036.47	3		119	705433.06	1013054.13	3	
51	705283.11	1013025.07	3		120	705434.03	1013054.09	3	
52	705282.75	1013025.43	3		121	705433.74	1013053.66	3	
53	705376.82	1013111.41	3		122	705433.28	1013053.64	3	
54	705377.26	1013110.96	3		123	705428.39	1013049.35	3	
55	705377.39	1013111.34	3		124	705428.91	1013049.17	3	
56	705377.85	1013111.99	3		125	705428.96	1013049.11	3	
57	705377.47	1013112.31	3		126	705428.61	1013048.75	3	
58	705380.88	1013115.83	3		127	705428.56	1013048.81	3	
59	705381.04	1013115.27	3		128	705420.76	1013040.79	3	
60	705381.33	1013115.51	3		129	705418.45	1013039.13	3	
61	705381.31	1013116.23	3		130	705404.86	1013025.59	3	
62	705380.85	1013115.98	3		131	705405.40	1013025.42	3	
63	705376.64	1013120.26	3		132	705405.52	1013025.30	3	

Seznam souřadnic (S-JTSK)

Číslo bodu	Souřadnice pro zápis do KN			Poznámka	Číslo bodu	Souřadnice pro zápis do KN			Poznámka
	Y	X	kód kv.			Y	X	kód kv.	
133	705405.17	1013024.95	3		202	705491.17	1012995.94	3	
134	705405.05	1013025.06	3		203	705491.10	1012995.61	3	
135	705396.96	1013017.34	3		204	705490.59	1012995.59	3	
136	705388.03	1013008.38	3		205	705491.52	1012995.03	3	
137	705384.13	1013004.58	3		206	705491.32	1012994.83	3	
138	705384.62	1013004.36	3		207	705490.64	1012995.07	3	
139	705384.72	1013004.18	3		208	705490.30	1012994.95	3	
140	705384.36	1013003.81	3		209	705490.02	1012995.37	3	
141	705384.25	1013004.00	3		210	705480.20	1012985.27	3	
142	705381.07	1013000.97	3		211	705480.56	1012984.93	3	
143	705380.71	1013001.33	3		212	705467.03	1012971.17	3	
144	705375.70	1012996.05	3		213	705466.67	1012971.53	3	
145	705376.08	1012995.71	3		214	705454.83	1012959.73	3	
146	705374.57	1012994.73	3		215	705455.19	1012959.37	3	
147	705374.99	1012994.45	3		216	705444.60	1012948.86	3	
148	705374.96	1012994.25	3		217	705444.24	1012949.22	3	
149	705374.39	1012993.66	3		218	705429.79	1012934.60	3	
150	705374.41	1012993.85	3		219	705430.15	1012934.24	3	
151	705367.76	1012986.95	3		220	705421.05	1012925.13	3	
152	705363.76	1012983.53	3		221	705420.69	1012925.49	3	
153	705355.79	1012975.44	3		222	705409.28	1012913.79	3	
154	705350.20	1012969.18	3		223	705409.68	1012913.49	3	
155	705345.86	1012965.57	3		224	705408.82	1012912.10	3	
156	705346.29	1012965.28	3		225	705408.34	1012912.26	3	
157	705346.28	1012965.17	3		226	705408.18	1012910.52	3	
158	705345.77	1012964.64	3		227	705408.69	1012910.61	3	
159	705345.77	1012964.76	3		228	705408.86	1012909.89	3	
160	705338.82	1012957.69	3		229	705409.03	1012909.11	3	
161	705338.46	1012958.05	3		230	705408.55	1012908.96	3	
162	705434.19	1013053.17	3		231	705408.67	1012907.83	3	
163	705434.47	1013053.59	3		232	705409.20	1012908.02	3	
164	705435.42	1013053.25	3		233	705409.96	1012907.83	3	
165	705435.14	1013052.83	3		234	705409.58	1012907.49	3	
166	705437.25	1013050.50	3		235	705411.03	1012906.24	3	
167	705437.61	1013050.84	3		236	705411.31	1012906.66	3	
168	705447.65	1013040.72	3		237	705412.71	1012905.98	3	
169	705447.29	1013040.38	3		238	705412.55	1012905.50	3	
170	705451.25	1013036.04	3		239	705415.02	1012905.01	3	
171	705453.18	1013034.13	3		240	705415.06	1012905.51	3	
172	705453.01	1013034.87	3		241	705424.63	1012905.06	3	
173	705455.44	1013033.13	3		242	705424.40	1012905.56	3	
174	705455.10	1013032.75	3		243	705424.43	1012905.95	3	
175	705459.87	1013027.61	3		244	705424.93	1012905.96	3	
176	705460.23	1013027.95	3		245	705424.90	1012905.56	3	
177	705472.55	1013015.79	3		246	705444.16	1012905.15	3	
178	705472.19	1013015.43	3		247	705443.94	1012905.65	3	
179	705485.04	1013002.57	3		248	705444.00	1012906.16	3	
180	705485.40	1013002.93	3		249	705444.50	1012906.16	3	
181	705486.59	1013001.77	3		250	705444.44	1012905.65	3	
182	705486.25	1013001.41	3		251	705452.01	1012905.23	3	
183	705490.98	1012996.98	3		252	705451.76	1012905.73	3	
184	705491.48	1012997.20	3		253	705451.75	1012906.21	3	
185	705490.99	1012996.67	3		254	705452.25	1012906.21	3	
186	705491.42	1012996.26	3		255	705452.26	1012905.73	3	
187	705491.74	1012996.36	3		256	705468.55	1012905.78	3	
188	705491.48	1012996.80	3		257	705468.55	1012905.28	3	
189	705491.78	1012996.90	3		258	705483.79	1012905.30	3	
190	705492.47	1012996.58	3		259	705483.53	1012905.80	3	
191	705492.19	1012996.16	3		260	705483.50	1012906.35	3	
192	705497.13	1012991.23	3		261	705484.00	1012906.36	3	
193	705497.49	1012991.59	3		262	705484.03	1012905.80	3	
194	705506.77	1012982.31	3		263	705500.39	1012905.90	3	
195	705506.43	1012981.95	3		264	705500.39	1012905.40	3	
196	705510.61	1012978.03	3		265	705514.11	1012905.63	3	
197	705510.97	1012978.37	3		266	705513.98	1012906.13	3	
198	705514.81	1012973.67	3		267	705514.35	1012906.62	3	
199	705514.45	1012973.37	3		268	705514.99	1012906.62	3	
200	705490.99	1012996.54	3		269	705514.62	1012906.14	3	
201	705490.69	1012996.14	3		270	705531.87	1012906.33	3	



## Seznam souřadnic (S–JTSK)

Číslo bodu	Souřadnice pro zápis do KN			Poznámka	Číslo bodu	Souřadnice pro zápis do KN			Poznámka
	Y	X	kód kv.			Y	X	kód kv.	
271	705532.07	1012905.83	3		340	705439.23	1012792.49	3	
272	705532.99	1012906.68	3		341	705439.56	1012792.14	3	
273	705532.39	1012906.80	3		342	705439.29	1012791.86	3	
274	705533.01	1012906.77	3		343	705439.61	1012791.45	3	
275	705532.53	1012906.92	3		344	705429.28	1012780.76	3	
276	705532.65	1012907.83	3		345	705428.78	1012780.95	3	
277	705533.15	1012907.75	3		346	705428.29	1012781.41	3	
278	705408.55	1012907.00	3		347	705427.93	1012781.06	3	
279	705409.05	1012906.92	3		348	705428.46	1012780.57	3	
280	705406.42	1012895.12	3		349	705429.01	1012780.40	3	
281	705405.94	1012895.26	3		350	705419.61	1012771.09	3	
282	705403.33	1012888.86	3		351	705419.48	1012771.01	3	
283	705403.79	1012888.66	3		352	705419.35	1012771.53	3	
284	705400.62	1012883.61	3		353	705418.94	1012771.92	3	
285	705401.04	1012883.35	3		354	705418.59	1012771.56	3	
286	705400.75	1012882.95	3		355	705418.97	1012771.20	3	
287	705400.38	1012883.30	3		356	705416.03	1012767.41	3	
288	705400.04	1012883.05	3		357	705415.84	1012767.93	3	
289	705400.10	1012882.55	3		358	705415.40	1012768.33	3	
290	705400.61	1012882.47	3		359	705415.05	1012767.97	3	
291	705401.08	1012882.27	3		360	705415.49	1012767.57	3	
292	705401.34	1012882.71	3		361	705410.04	1012761.95	3	
293	705403.52	1012881.00	3		362	705410.40	1012761.61	3	
294	705403.03	1012880.75	3		363	705403.77	1012754.89	3	
295	705402.66	1012880.18	3		364	705403.58	1012755.42	3	
296	705403.03	1012879.83	3		365	705403.11	1012755.86	3	
297	705403.41	1012880.42	3		366	705402.76	1012755.50	3	
298	705411.94	1012872.10	3		367	705403.23	1012755.06	3	
299	705412.30	1012872.46	3		368	705396.28	1012747.32	3	
300	705421.22	1012863.60	3		369	705396.11	1012747.86	3	
301	705420.69	1012863.43	3		370	705395.71	1012748.34	3	
302	705420.22	1012862.98	3		371	705395.36	1012747.98	3	
303	705420.57	1012862.63	3		372	705395.76	1012747.50	3	
304	705421.05	1012863.07	3		373	705392.05	1012742.95	3	
305	705427.47	1012856.85	3		374	705391.86	1012743.47	3	
306	705427.83	1012857.21	3		375	705391.37	1012743.93	3	
307	705431.53	1012853.53	3		376	705391.02	1012743.58	3	
308	705430.99	1012853.35	3		377	705391.51	1012743.11	3	
309	705430.45	1012852.82	3		378	705386.72	1012737.48	3	
310	705430.80	1012852.47	3		379	705386.54	1012738.00	3	
311	705431.35	1012853.00	3		380	705386.02	1012738.51	3	
312	705438.33	1012846.15	3		381	705385.67	1012738.15	3	
313	705438.69	1012846.51	3		382	705386.19	1012737.65	3	
314	705444.12	1012841.13	3		383	705383.24	1012734.61	3	
315	705443.59	1012840.95	3		384	705383.60	1012734.25	3	
316	705443.04	1012840.38	3		385	705376.29	1012727.03	3	
317	705443.40	1012840.03	3		386	705375.93	1012727.39	3	
318	705443.94	1012840.60	3		387	705364.74	1012715.94	3	
319	705450.68	1012834.01	3		388	705365.10	1012715.58	3	
320	705451.03	1012834.37	3		389	705359.24	1012709.84	3	
321	705456.37	1012829.05	3		390	705358.96	1012710.28	3	
322	705455.84	1012828.86	3		391	705358.24	1012710.01	3	
323	705455.30	1012828.27	3		392	705358.26	1012709.49	3	
324	705455.65	1012827.92	3		393	705357.07	1012709.84	3	
325	705456.20	1012828.51	3		394	705357.33	1012710.28	3	
326	705465.47	1012819.32	3		395	705350.14	1012716.88	3	
327	705465.89	1012819.60	3		396	705350.68	1012717.06	3	
328	705466.19	1012818.87	3		397	705351.16	1012717.53	3	
329	705465.63	1012818.93	3		398	705350.81	1012717.88	3	
330	705465.35	1012818.50	3		399	705350.32	1012717.41	3	
331	705465.75	1012818.20	3		400	705342.95	1012724.42	3	
332	705459.10	1012811.00	3		401	705342.61	1012724.06	3	
333	705458.74	1012811.34	3		402	705330.38	1012736.30	3	
334	705447.08	1012799.61	3		403	705330.74	1012736.66	3	
335	705447.44	1012799.25	3		404	705322.06	1012745.29	3	
336	705441.12	1012793.08	3		405	705321.70	1012744.93	3	
337	705440.76	1012793.42	3		406	705313.51	1012753.12	3	
338	705439.91	1012792.51	3		407	705313.87	1012753.48	3	
339	705439.58	1012792.85	3		408	705306.80	1012759.82	3	

## Seznam souřadnic (S–JTSK)

Číslo bodu	Souřadnice pro zápis do KN			Poznámka	Číslo bodu	Souřadnice pro zápis do KN			Poznámka
	Y	X	kód kv.			Y	X	kód kv.	
409	705307.33	1012760.01	3		479	705285.56	1012788.69	3	
410	705307.67	1012760.38	3		480	705285.57	1012788.50	3	
411	705307.32	1012760.73	3		481	705286.06	1012788.40	3	
412	705306.97	1012760.36	3		482	705285.84	1012787.78	3	
413	705299.48	1012767.78	3		483	705285.40	1012788.04	3	
414	705299.12	1012767.42	3		484	705282.92	1012785.37	3	
415	705294.00	1012772.49	3		485	705283.34	1012785.09	3	
416	705294.53	1012772.67	3		486	705283.12	1012784.58	3	
417	705295.00	1012773.16	3		487	705282.66	1012784.78	3	
418	705294.66	1012773.52	3		488	705283.61	1012790.60	3	
419	705294.18	1012773.03	3		489	705283.97	1012790.95	3	
420	705284.07	1012783.08	3		490	705280.80	1012794.05	3	
421	705283.71	1012782.74	3		491	705280.71	1012794.28	3	
422	705282.61	1012783.92	3		492	705280.85	1012794.55	3	
423	705283.09	1012784.14	3		493	705280.43	1012794.85	3	
425	705282.54	1012784.43	3		494	705280.17	1012794.33	3	
426	705390.50	1012882.51	3		495	705280.45	1012793.69	3	
427	705390.50	1012883.01	3		496	705280.16	1012793.78	3	
428	705379.56	1012882.92	3		497	705279.80	1012793.65	3	
429	705379.62	1012882.42	3		498	705279.52	1012794.07	3	
430	705378.43	1012882.65	3		499	705271.54	1012786.04	3	
431	705378.58	1012882.16	3		500	705271.90	1012785.70	3	
432	705378.20	1012882.51	3		501	705266.62	1012780.22	3	
433	705377.64	1012882.18	3		502	705266.32	1012780.64	3	
434	705377.96	1012881.78	3		503	705266.07	1012780.52	3	
435	705374.05	1012877.88	3		504	705266.03	1012779.96	3	
436	705373.69	1012878.24	3		505	705265.44	1012780.33	3	
437	705367.02	1012871.36	3		506	705265.30	1012780.51	3	
438	705367.55	1012871.19	3		507	705265.66	1012780.87	3	
439	705368.16	1012870.61	6		508	705285.97	1012800.53	3	
440	705367.81	1012870.25	6		509	705286.33	1012800.17	3	
441	705367.20	1012870.83	3		510	705293.49	1012807.21	3	
442	705360.40	1012863.96	3		511	705292.95	1012807.39	3	
443	705360.04	1012864.32	3		512	705292.39	1012807.96	3	
444	705352.22	1012856.42	3		513	705292.74	1012808.32	3	
445	705352.58	1012856.06	3		514	705293.31	1012807.75	3	
446	705347.88	1012851.99	3		515	705300.56	1012815.14	3	
447	705348.42	1012851.82	3		516	705300.92	1012814.78	3	
448	705349.06	1012851.21	3		517	705309.78	1012823.56	3	
449	705348.71	1012850.85	3		518	705309.23	1012823.72	3	
450	705348.06	1012851.46	3		519	705308.50	1012824.33	3	
451	705347.85	1012851.26	3		520	705308.85	1012824.69	3	
452	705347.42	1012851.55	3		521	705309.58	1012824.08	3	
453	705348.08	1012850.21	3		522	705317.88	1012832.73	3	
454	705347.47	1012850.88	3		523	705318.24	1012832.39	3	
455	705342.97	1012846.25	3		524	705331.63	1012845.85	3	
456	705342.61	1012846.59	3		525	705331.27	1012846.21	3	
457	705336.14	1012839.83	3		526	705342.30	1012856.70	3	
458	705336.69	1012839.69	3		527	705341.76	1012856.86	3	
459	705337.30	1012839.21	3		528	705341.13	1012857.46	3	
460	705336.95	1012838.85	3		529	705341.48	1012857.82	3	
461	705336.34	1012839.33	3		530	705342.11	1012857.22	3	
462	705330.48	1012833.33	3		531	705347.12	1012862.38	3	
463	705330.12	1012833.69	3		532	705347.48	1012862.02	3	
464	705322.09	1012825.50	3		533	705353.11	1012867.70	3	
465	705322.45	1012825.16	3		534	705352.71	1012868.02	3	
466	705314.46	1012817.41	3		535	705353.50	1012869.25	3	
467	705315.00	1012817.26	3		536	705353.90	1012868.95	3	
468	705315.41	1012816.93	3		537	705356.92	1012872.50	3	
469	705315.04	1012816.56	3		538	705356.56	1012872.84	3	
470	705314.66	1012816.89	3		539	705362.51	1012878.79	3	
471	705313.71	1012815.87	3		540	705362.87	1012878.43	3	
472	705313.35	1012816.21	3		541	705369.53	1012885.32	3	
473	705305.18	1012808.11	3		542	705369.11	1012885.60	3	
474	705305.54	1012807.75	3		543	705369.59	1012886.61	3	
475	705286.83	1012788.75	3		544	705370.31	1012886.96	3	
476	705286.53	1012789.17	3		545	705370.73	1012888.96	3	
477	705286.13	1012788.98	3		546	705370.53	1012889.93	3	
478	705285.93	1012789.03	3		547	705369.94	1012890.29	3	

## Seznam souřadnic (S–JTSK)

Číslo bodu	Souřadnice pro zápis do KN			Poznámka	Číslo bodu	Souřadnice pro zápis do KN			Poznámka
	Y	X	kód kv.			Y	X	kód kv.	
548	705369.89	1012890.54	3		617	705260.06	1012842.34	3	
549	705370.34	1012890.83	3		618	705261.18	1012842.45	3	
550	705369.74	1012891.68	3		619	705261.00	1012841.98	3	
551	705369.36	1012891.36	3		620	705349.05	1012903.85	3	
552	705364.83	1012895.86	3		621	705349.55	1012903.99	3	
553	705365.15	1012896.24	3		622	705349.35	1012904.39	3	
554	705364.37	1012896.81	3		623	705348.83	1012904.65	3	
555	705364.17	1012896.33	3		624	705348.71	1012904.15	3	
556	705363.55	1012896.44	3		625	705347.66	1012904.19	3	
557	705363.57	1012896.94	3		626	705347.93	1012904.68	3	
558	705359.91	1012896.61	3		627	705347.98	1012905.49	3	
559	705359.97	1012896.11	3		628	705347.48	1012905.48	3	
560	705354.41	1012895.46	3		629	705347.43	1012904.69	3	
561	705354.33	1012895.96	3		630	705332.13	1012904.59	3	
562	705350.33	1012894.64	3		631	705332.13	1012904.09	3	
563	705350.08	1012895.12	3		632	705320.94	1012904.08	3	
564	705349.58	1012895.05	3		633	705321.18	1012904.58	3	
565	705347.66	1012894.72	3		634	705321.16	1012905.24	3	
566	705347.70	1012894.22	3		635	705320.66	1012905.23	3	
567	705338.07	1012894.19	3		636	705320.68	1012904.58	3	
568	705338.07	1012894.69	3		637	705310.89	1012904.05	3	
569	705328.32	1012894.60	3		638	705311.14	1012904.55	3	
570	705328.57	1012894.10	3		639	705311.14	1012905.17	3	
571	705328.56	1012893.16	3		640	705310.64	1012905.17	3	
572	705328.06	1012893.15	3		641	705310.64	1012904.55	3	
573	705328.07	1012894.10	3		642	705296.09	1012904.39	3	
574	705317.62	1012893.93	3		643	705296.11	1012903.89	3	
575	705317.62	1012894.43	3		644	705290.37	1012903.55	3	
576	705309.27	1012894.37	3		645	705290.37	1012904.05	3	
577	705309.51	1012893.87	3		646	705285.03	1012903.70	3	
578	705309.50	1012893.04	3		647	705285.28	1012904.19	3	
579	705309.00	1012893.04	3		648	705285.27	1012904.98	6	
580	705309.01	1012893.87	3		649	705284.77	1012904.97	6	
581	705296.84	1012893.84	3		650	705284.78	1012904.21	3	
582	705296.84	1012894.34	3		651	705274.53	1012904.45	3	
583	705289.86	1012894.46	3		652	705274.41	1012903.95	3	
584	705289.86	1012893.96	3		653	705272.86	1012905.31	3	
585	705286.56	1012893.86	3						
586	705286.48	1012894.36	3						
587	705283.42	1012893.53	3						
588	705283.60	1012893.07	3						
589	705283.15	1012892.83	6						
590	705282.06	1012892.82	6						
591	705280.06	1012891.77	3						
592	705280.34	1012891.35	3						
593	705278.00	1012889.21	3						
594	705277.62	1012889.55	3						
595	705276.02	1012887.33	3						
596	705276.46	1012887.09	3						
597	705275.56	1012885.03	3						
598	705275.10	1012885.23	3						
599	705270.91	1012874.66	3						
600	705271.37	1012874.44	3						
601	705270.54	1012872.95	3						
602	705270.08	1012873.13	3						
603	705269.90	1012872.44	3						
604	705270.44	1012872.52	3						
605	705272.24	1012871.84	3						
606	705272.06	1012871.37	3						
607	705270.29	1012872.04	3						
608	705267.28	1012863.28	3						
609	705266.80	1012863.44	3						
610	705262.32	1012851.11	3						
611	705262.80	1012850.95	3						
612	705260.13	1012843.49	3						
613	705259.65	1012843.61	3						
614	705259.52	1012842.90	3						
615	705260.06	1012843.06	3						
616	705260.34	1012842.76	3						