



list č.1



538

526/4

115

121

107/2

107/1

114/1

114/2

559
559/1

516/9

516/1

121-1259

121-1280

516/10

211

516/8

516/3

516/7

48.61
48.63

15.73
15.63

22.49
22.75

23.93
24.00

17
18

19
20

90
91

list č.2

0.38
39
40
41
42
43
44
45
46
47
48
49
50

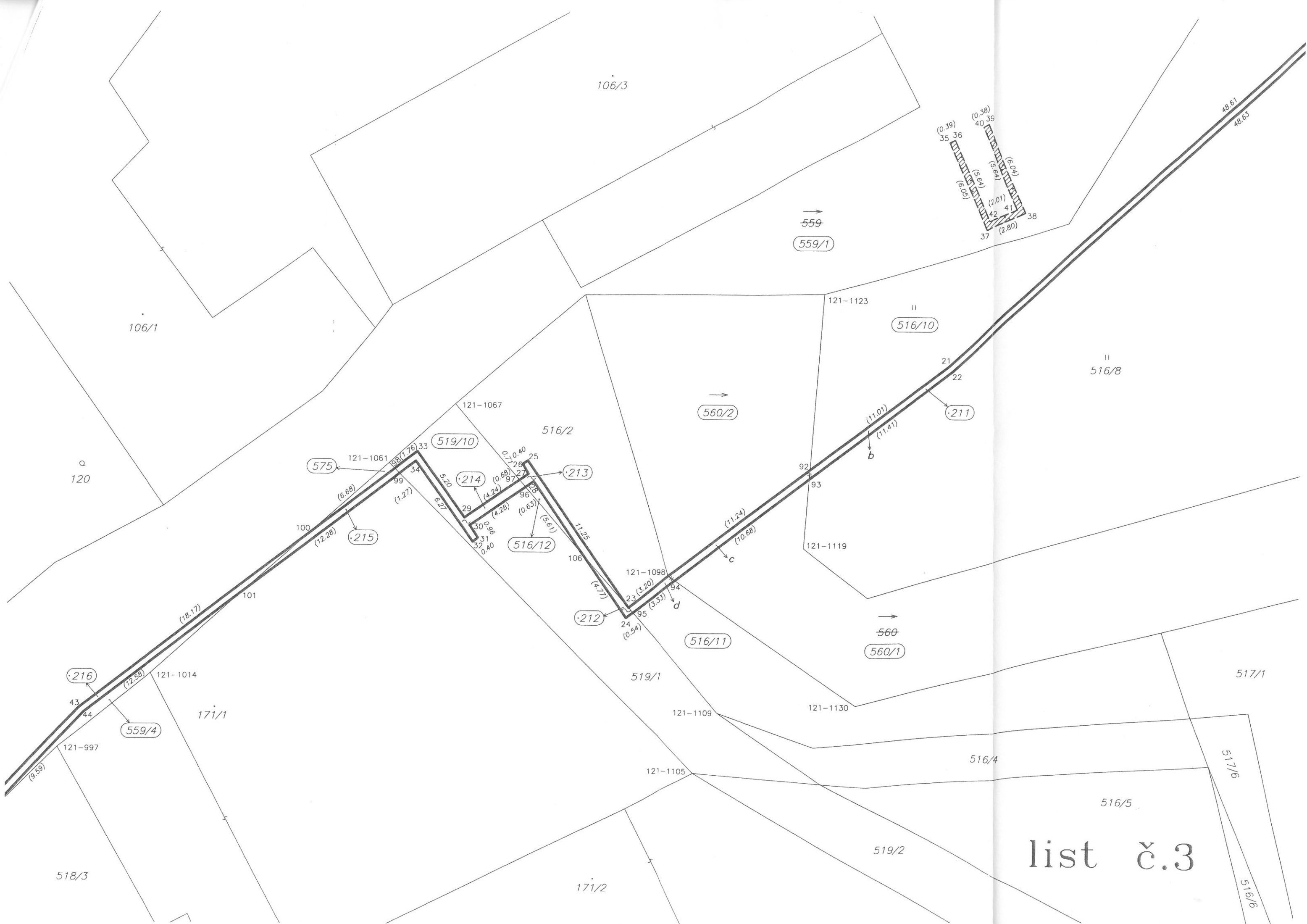

list č.3

516/6



list č.4



140

136/23

135/1

78
79

121-883

518/2

121-907

20.30
20.36

121-840

80
81

171/2

→
559

559/2

19.78
19.75

538

219

82
83

518/1

||
517/3

141

136/21

19.65
19.70

||
517/4

||
135/2

127

84
0.25
85

list č.5