

Seznam souřadnic (S–JTSK)

Seznam souřadnic (S–JTSK)

Č. bodu	Souřadnice pro zápis do KN			Poznámka	Č. bodu	Souřadnice pro zápis do KN			Poznámka
	Y	X	kód kv.			Y	X	kód kv.	
78–279	589690.69	1081797.00	4		265	589686.88	1081792.82	3	
100–187	589891.61	1081903.31	4		266	589685.67	1081795.67	3	
100–359	589783.29	1081855.91	4		267	589686.06	1081795.54	3	
100–372	589841.28	1081880.35	4		268	589686.64	1081796.27	3	
1718–15	589867.11	1081873.32	3		269	589688.36	1081794.72	3	
190	589790.75	1081707.07	3		270	589689.16	1081798.98	3	
191	589788.57	1081708.45	3		271	589690.40	1081796.92	3	
192	589791.11	1081707.55	3		272	589692.47	1081799.88	3	
193	589788.85	1081709.07	3		273	589693.31	1081797.70	3	
194	589792.51	1081709.49	3		274	589697.05	1081802.23	3	
195	589792.07	1081712.84	3		275	589698.09	1081800.17	3	
196	589793.91	1081711.39	3		276	589701.39	1081804.41	3	
197	589776.76	1081718.37	4		277	589702.37	1081802.31	3	
198	589775.24	1081719.72	4		278	589702.54	1081804.89	3	
199	589777.68	1081719.37	3		279	589703.40	1081802.75	3	
200	589776.78	1081721.39	3		280	589704.78	1081805.76	3	
201	589777.64	1081722.02	3		281	589707.40	1081804.30	3	
202	589779.22	1081720.74	3		282	589704.68	1081806.31	4	
203	589779.35	1081718.13	3		283	589706.94	1081806.83	3	
204	589781.07	1081719.66	3		284	589704.68	1081816.33	3	
205	589781.24	1081722.82	3		285	589702.35	1081815.88	4	
206	589782.82	1081721.55	3		286	589702.11	1081816.25	3	
207	589768.74	1081730.41	3		287	589702.07	1081817.92	3	
208	589767.44	1081731.97	3		288	589704.37	1081818.71	3	
209	589767.75	1081732.23	3		289	589713.56	1081822.56	3	
210	589769.17	1081730.77	3		290	589714.16	1081822.81	3	
211	589772.77	1081734.89	3		291	589715.06	1081820.67	3	
212	589771.31	1081736.31	3		292	589714.46	1081820.42	3	
213	589773.08	1081735.17	3		293	589735.30	1081831.85	3	
214	589771.70	1081736.67	3		294	589736.07	1081832.25	3	
215	589759.65	1081736.54	3		295	589736.30	1081829.75	3	
216	589758.33	1081738.08	3		296	589737.07	1081830.15	3	
217	589760.82	1081737.53	3		297	589740.13	1081834.00	3	
218	589759.40	1081738.99	3		298	589740.31	1081834.17	3	
219	589764.94	1081742.01	3		299	589741.24	1081834.48	3	
220	589763.36	1081743.29	3		300	589741.41	1081832.04	3	
221	589765.19	1081742.37	3		301	589741.51	1081832.13	3	
222	589763.53	1081743.53	3		302	589742.10	1081832.32	3	
223	589753.42	1081739.20	4		303	589745.31	1081836.42	3	
224	589751.90	1081740.56	4		304	589746.27	1081834.32	3	
225	589753.74	1081739.53	3		305	589746.70	1081837.04	3	
226	589752.30	1081740.98	3		306	589747.64	1081834.92	3	
227	589754.49	1081738.82	3		307	589747.73	1081837.49	3	
228	589753.88	1081742.19	3		308	589747.87	1081837.53	3	
229	589754.23	1081741.86	3		309	589748.47	1081835.29	3	
230	589756.53	1081741.53	3		310	589748.67	1081835.33	3	
231	589754.97	1081742.83	3		311	589749.16	1081838.18	3	
232	589759.11	1081747.44	3		312	589750.15	1081836.08	3	
233	589760.63	1081746.05	3		313	589750.41	1081838.69	3	
234	589760.83	1081746.36	3		314	589751.80	1081836.74	3	
235	589744.82	1081746.89	4		315	589751.47	1081839.10	3	
236	589743.26	1081748.28	4		316	589751.56	1081839.20	3	
237	589745.55	1081747.96	4		317	589753.68	1081837.60	3	
238	589743.68	1081748.82	3		318	589755.10	1081834.01	3	
239	589745.70	1081748.31	3		319	589753.18	1081833.27	3	
240	589743.92	1081749.38	4		320	589754.43	1081829.98	3	
241	589751.62	1081754.56	3		321	589757.07	1081828.84	3	
242	589750.02	1081755.82	3		322	589755.42	1081828.16	3	
243	589724.74	1081766.05	4		323	589752.70	1081829.28	3	
244	589723.05	1081767.78	4		324	589756.33	1081826.04	4	
245	589725.61	1081767.48	3		325	589754.43	1081825.23	4	
246	589723.83	1081768.96	3		326	589768.58	1081846.52	3	
247	589724.37	1081769.46	3		327	589769.46	1081844.38	3	
248	589730.62	1081772.90	3		328	589770.94	1081847.45	3	
249	589729.17	1081774.82	3		329	589772.33	1081845.50	3	
250	589728.93	1081774.64	3		330	589773.91	1081846.51	3	
251	589695.35	1081790.90	4		331	589772.70	1081849.18	3	
252	589693.71	1081792.36	4		332	589769.60	1081850.44	3	
253	589695.58	1081791.48	3		333	589779.68	1081854.44	3	
254	589695.04	1081794.22	3		334	589780.84	1081852.42	4	
255	589695.20	1081794.34	3		335	589790.85	1081859.00	3	
256	589695.48	1081794.71	3		336	589791.73	1081856.86	3	
257	589696.50	1081792.78	3		337	589797.90	1081859.41	3	
258	589696.64	1081792.88	3		338	589799.56	1081860.14	3	
259	589696.96	1081793.29	3		339	589796.15	1081861.19	3	
260	589701.95	1081797.50	3		340	589798.04	1081862.00	3	
261	589701.09	1081799.34	3		341	589797.99	1081862.14	4	
262	589700.82	1081799.21	3		342	589796.10	1081861.34	4	
263	589684.89	1081795.03	3		343	589800.73	1081863.13	3	
264	589686.15	1081793.07	3		344	589801.63	1081860.99	3	

Seznam souřadnic (S–JTSK)

Seznam souřadnic (S–JTSK)

Č. bodu	Souřadnice pro zápis do KN			Poznámka	Č. bodu	Souřadnice pro zápis do KN			Poznámka
	Y	X	kód kv.			Y	X	kód kv.	
345	589803.87	1081864.46	3		419	589891.05	1081903.50	4	
346	589804.79	1081862.34	3		420	589894.17	1081902.49	3	
347	589810.74	1081867.45	3		421	589895.78	1081902.92	3	
348	589811.66	1081865.33	3		422	589897.62	1081901.38	3	
349	589822.07	1081872.24	3		423	589895.51	1081900.42	3	
350	589823.09	1081872.66	3		424	589894.19	1081899.96	3	
351	589822.87	1081870.06	3		425	589894.54	1081900.20	4	
352	589824.87	1081870.90	3		426	589898.25	1081899.69	3	
353	589825.37	1081869.35	3		427	589896.03	1081898.99	3	
354	589823.43	1081868.61	3		428	589898.37	1081899.22	4	
355	589829.56	1081859.79	3		429	589896.17	1081898.46	4	
356	589827.60	1081859.13	3		430	589901.03	1081890.22	3	
357	589828.81	1081875.12	3		431	589898.85	1081889.44	3	
358	589829.71	1081873.00	3		432	589901.37	1081889.43	3	
359	589834.91	1081877.70	3		433	589899.80	1081887.19	3	
360	589835.77	1081875.56	3		434	589900.64	1081886.76	3	
361	589839.98	1081877.18	3		435	589904.49	1081887.99	3	
362	589840.83	1081877.64	3		436	589906.52	1081888.84	3	
363	589841.87	1081878.03	3		437	589903.69	1081890.17	3	
364	589842.78	1081878.46	3		438	589905.66	1081891.00	3	
365	589843.80	1081878.88	3		439	589913.75	1081894.07	3	
366	589845.10	1081879.29	3		440	589914.63	1081891.93	3	
367	589838.05	1081879.02	4		441	589925.06	1081899.09	3	
368	589846.62	1081880.15	3		442	589925.94	1081896.95	3	
369	589838.09	1081878.93	3		443	589930.56	1081901.16	3	
370	589843.91	1081881.48	4		444	589931.32	1081898.97	3	
371	589843.96	1081881.36	3		445	589931.62	1081901.64	3	
372	589844.18	1081881.43	3		446	589932.44	1081899.46	3	
373	589845.66	1081882.22	4		447	589933.07	1081902.08	3	
374	589848.08	1081883.15	3		448	589935.97	1081900.56	3	
375	589849.91	1081881.40	3		449	589935.30	1081902.70	3	
376	589847.99	1081880.65	3		450	589935.72	1081902.83	3	
377	589850.57	1081879.88	3		451	589932.43	1081904.10	3	
378	589848.67	1081879.06	3		452	589934.16	1081904.79	3	
379	589854.35	1081871.01	3		453	589935.08	1081905.05	3	
380	589852.41	1081870.31	3		454	589900.66	1081906.39	3	
381	589854.60	1081870.17	3		455	589901.92	1081904.45	3	
382	589853.20	1081867.60	4		456	589905.40	1081909.21	3	
383	589856.82	1081871.16	3		457	589906.62	1081907.23	3	
384	589857.57	1081869.48	4		458	589908.29	1081911.05	4	
385	589856.11	1081886.49	3		459	589909.66	1081909.18	3	
386	589857.01	1081884.35	3		460	589911.63	1081910.51	4	
387	589859.00	1081887.74	3		461	589911.01	1081912.89	3	
388	589859.92	1081885.62	3		462	589912.99	1081914.14	3	
389	589862.50	1081889.24	3		463	589914.75	1081912.50	3	
390	589862.43	1081886.69	3		464	589915.13	1081913.22	3	
391	589865.44	1081884.61	3		465	589916.51	1081916.83	3	
392	589863.52	1081883.89	3		466	589914.35	1081917.67	3	
393	589864.32	1081887.52	3		467	589918.34	1081921.38	3	
394	589867.49	1081891.47	3		468	589916.20	1081922.24	3	
395	589868.10	1081877.41	3		469	589866.81	1081873.63	4	
396	589866.10	1081876.89	3		470	589777.47	1081719.14	4	
397	589868.75	1081874.40	4		471	589776.14	1081720.69	4	
398	589868.90	1081874.00	4		472	589754.97	1081739.47	4	
399	589866.96	1081873.26	4		473	589752.85	1081741.41	4	
400	589866.67	1081874.11	3		474	589696.10	1081792.21	4	
401	589871.58	1081890.77	3		475	589694.57	1081793.57	4	
402	589878.76	1081893.71	3		476	589685.21	1081794.54	4	
403	589887.26	1081897.25	3		477	589698.76	1081803.09	4	
404	589876.05	1081895.10	3		478	589706.79	1081807.46	4	
405	589886.40	1081899.39	3		479	589753.16	1081828.20	4	
406	589891.96	1081901.58	3		480	589756.72	1081829.75	4	
407	589891.78	1081901.89	4		481	589766.69	1081845.71	4	
408	589890.78	1081904.21	3		482	589823.71	1081867.98	4	
409	589889.20	1081904.72	3		483	589825.61	1081868.79	4	
410	589889.03	1081904.18	4		484	589848.84	1081878.66	4	
411	589886.52	1081905.03	4		485	589850.74	1081879.47	4	
412	589887.36	1081907.24	3		486	589863.18	1081884.75	4	
413	589887.54	1081907.17	3		487	589865.08	1081885.56	4	
414	589887.68	1081907.62	3		488	589853.04	1081868.16	4	
415	589892.21	1081906.19	3		489	589857.39	1081869.89	4	
416	589892.83	1081905.35	3		490	589900.29	1081886.94	4	
417	589893.56	1081903.43	3		491	589935.82	1081901.06	4	
418	589893.89	1081902.87	3		492	589773.83	1081846.68	4	

Klad listů

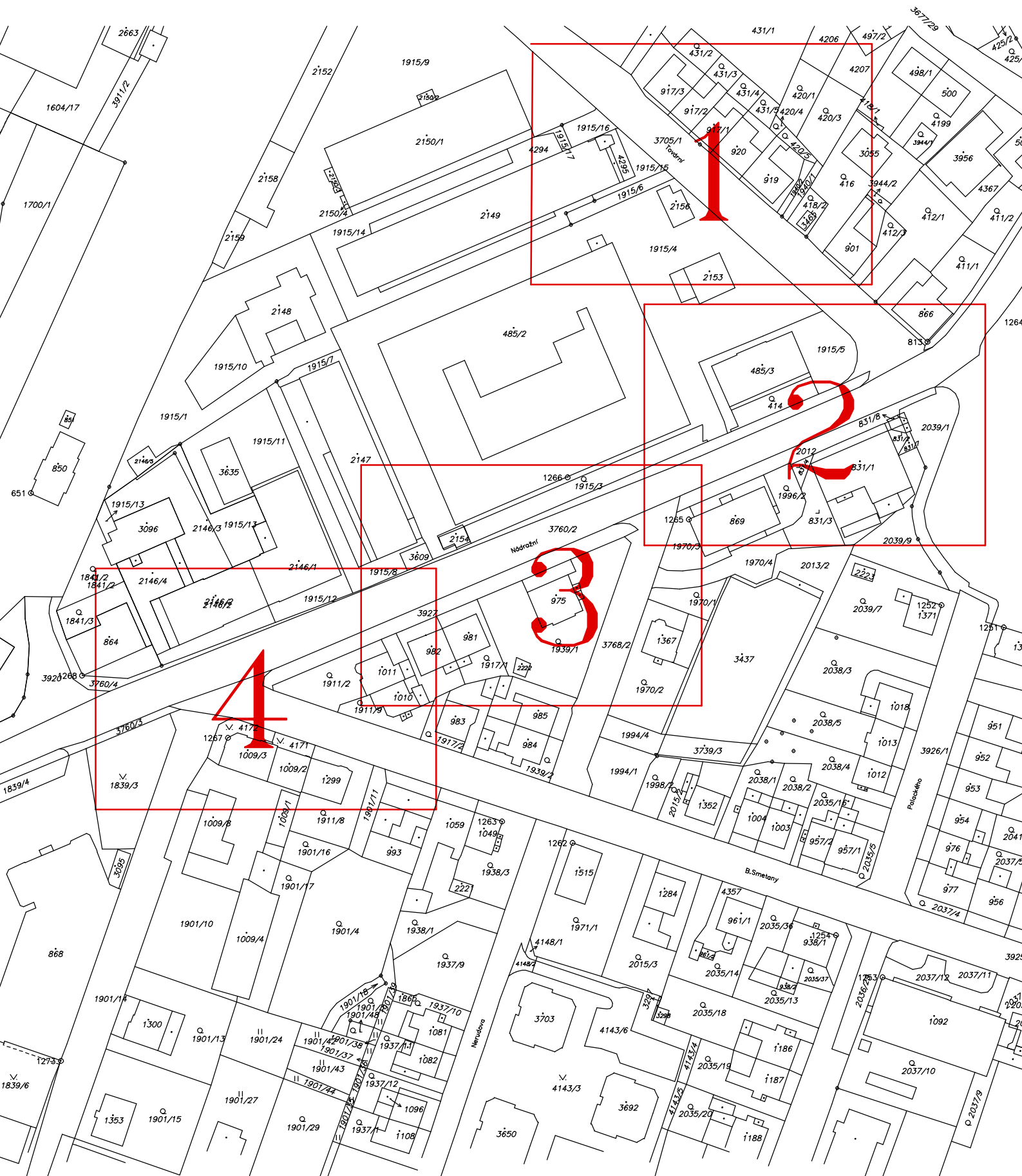

ŠĀĀĒḌ

4207

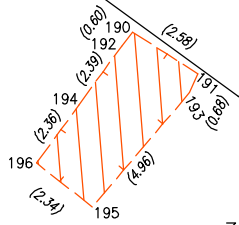

485/1

3705/1

431/2

431/3

431/4

431/5

420/1

420/3

420/4

420/5

418/1

1915/9

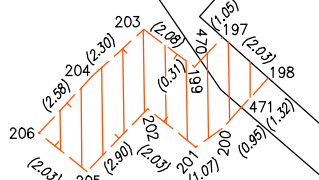

917/3

917/2

917/1

920

919

3055

1915/17

1915/16

3705/1

4295

1915/15

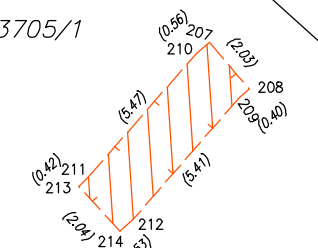

215

219

221

222

217

218

220

222

215

216

218

220

215

217

219

221

215

217

219

221

215

217

219

221

215

217

219

221

215

217

219

221

215

217

219

221

215

217

219

221

215

217

219

221

1915/6

2156

1915/4

3705/1

1940/1

3465

418/2

416

901

3944/2

2153

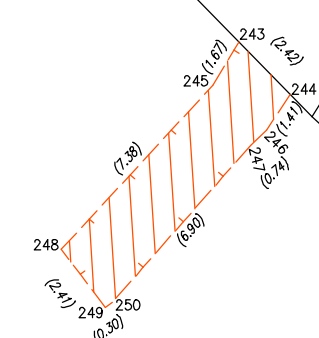

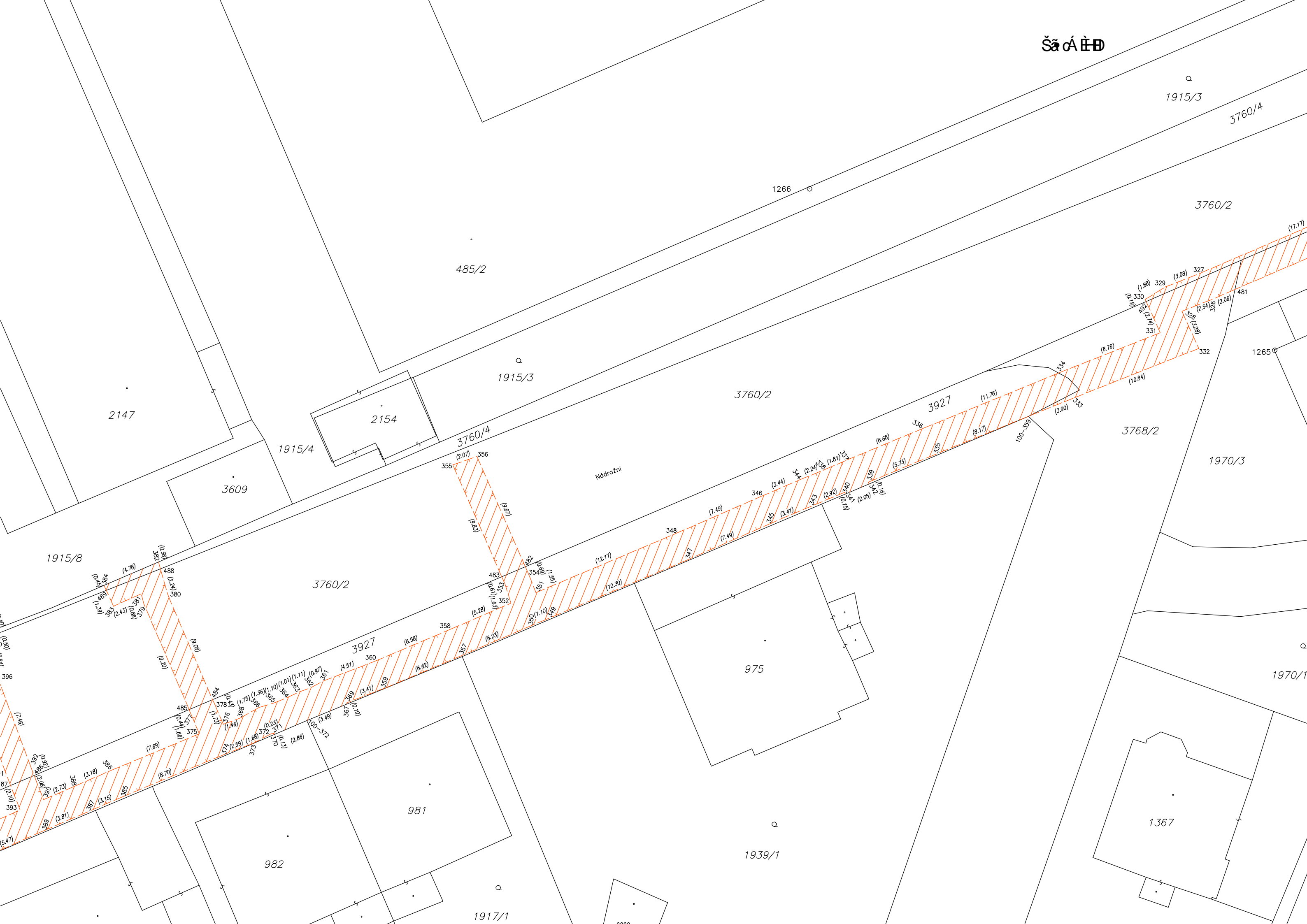

1915/3

3760/4

1266

3760/2

485/2

1915/3

327
329
330
331
332
333
334
335
336
337
338
339
340
341
342
343
344
345
346
347
348
349
350
351
352
353
354
355
356
357
358
359
360
361
362
363
364
365
366
367
368
369
370
371
372
373
374
375
376
377
378
379
380
381
382
383
384
385
386
387
388
389
390
391
392
393
394
395
396
397
398
399
400
401
402
403
404
405
406
407
408
409
410
411
412
413
414
415
416
417
418
419
420
421
422
423
424
425
426
427
428
429
430
431
432
433
434
435
436
437
438
439
440
441
442
443
444
445
446
447
448
449
450
451
452
453
454
455
456
457
458
459
460
461
462
463
464
465
466
467
468
469
470
471
472
473
474
475
476
477
478
479
480
481
482
483
484
485
486
487
488
489
490
491
492
493
494
495
496
497
498
499
500

1265

2147

2154

3760/2

1915/4

3760/4

3927

3609

3768/2

1970/3

Nádraží

1915/8

3760/2

975

3927

1970/1

981

1367

982

1939/1

1917/1

