

FORUM KARLÍN | Main floor

Hlavní podlaží

Ground clearances (světlé výšky)

Stage area 9,4 m

Main floor 10 m

Gallery 2,7 m

Foyer 2,5 m

Loading dock entrance 4,1 m

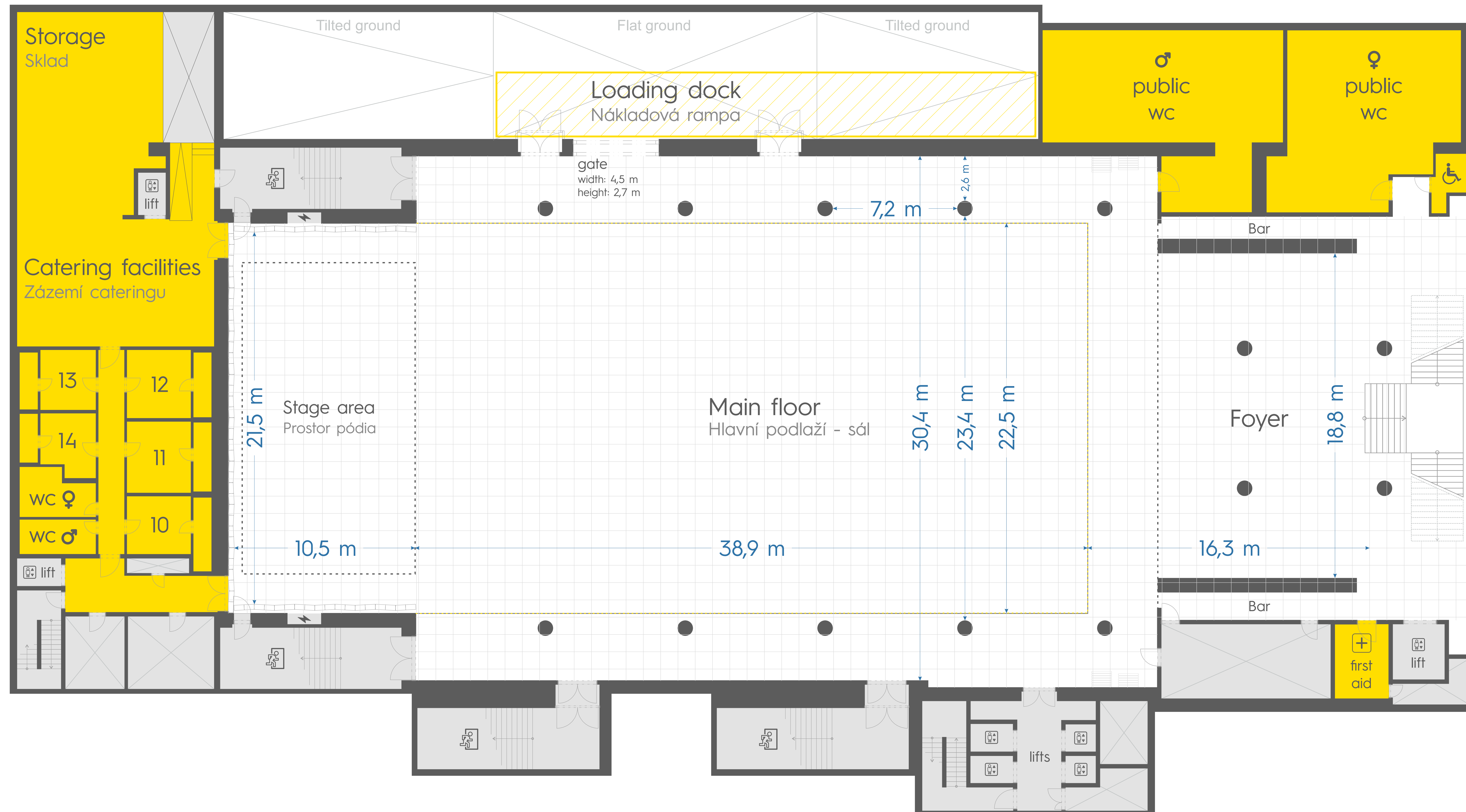

FORUM KARLÍN | 1st gallery

1. galerie

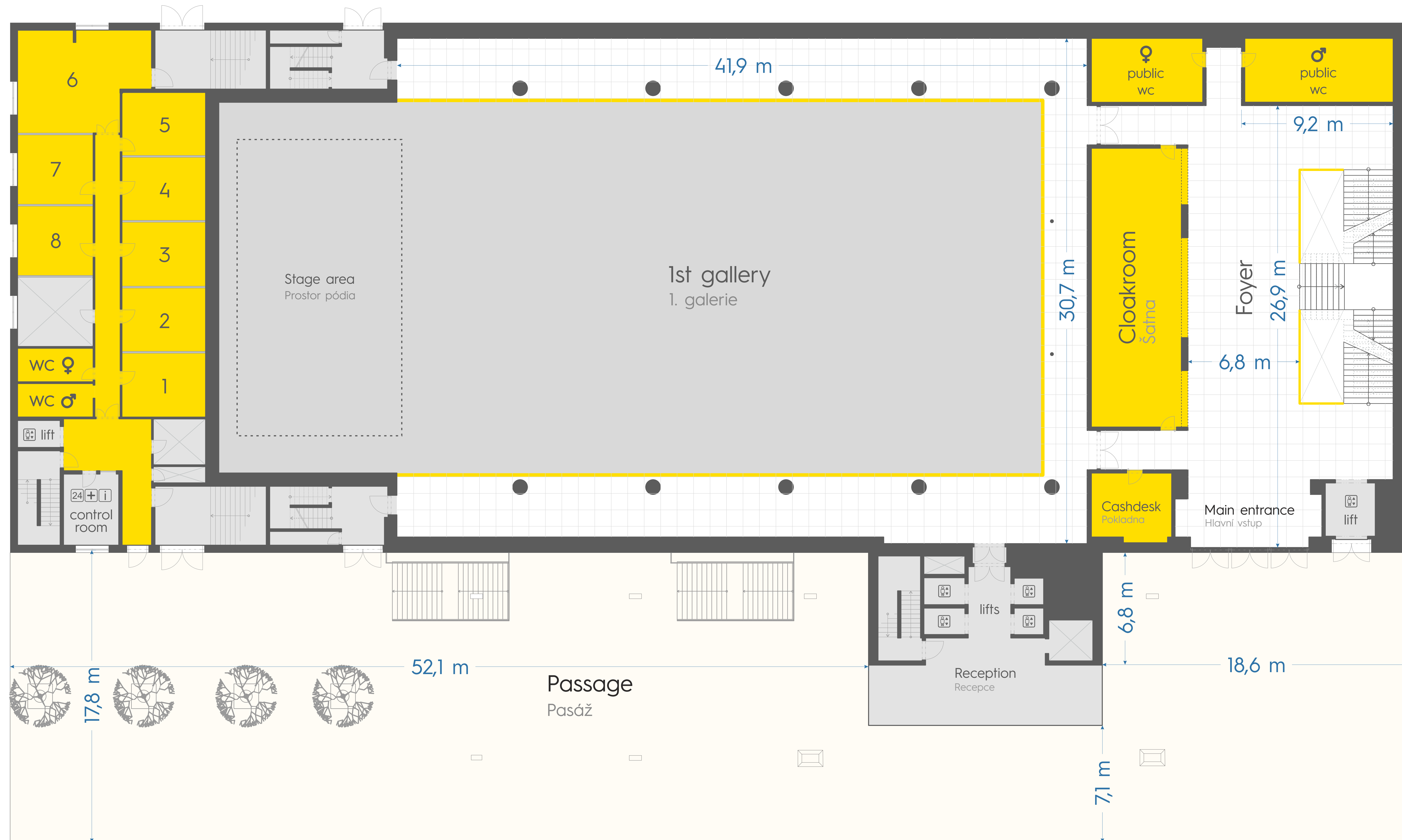

FORUM KARLÍN | 2nd gallery

2. galerie

